



NSX

31T6NG20
OG09288
00X31-T6N-G200

owners.acura.com (U.S.)
myacura.ca (Canada)

2019 Acura NSX Owner's Guide
© 2018 Honda Motor Co., Ltd. — All Rights Reserved

Printed in U.S.A.



2019
OWNER'S GUIDE

DISCLOSURES

Devices That Emit Radio Waves

Each radio frequency device installed in the vehicle conforms to the requirements and standards of the regulation listed below:

As required by the FCC:

This device complies with Part 15 of the FCC rules. Operation is subject to the following two conditions: (1) This device may not cause harmful interference, and (2) this device must accept any interference received, including interference that may cause undesired operation.

Changes or modifications not expressly approved by the party responsible for compliance could void the user's authority to operate the equipment.

As required by Industry Canada:

This device complies with Industry Canada licence-exempt RSS standard(s). Operation is subject to the following two conditions: (1) this device may not cause interference, and (2) this device must accept any interference, including interference that may cause undesired operation of the device.

Disclaimer

The information and data contained herein are believed to be accurate and reliable. American Honda Motor Co., Inc. makes no warranty of any kind and accepts no responsibility for the results obtained through application of this information.

Privacy Notice

This vehicle may share location and usage information. To manage this setting, visit www.acuralink.com/vehicle-data-choices.

Event Data Recorders

This vehicle is equipped with an event data recorder (EDR). The main purpose of an EDR is to record, in certain crash or near crash-like situations, such as an airbag deployment or hitting a road obstacle, data that will assist in understanding how a vehicle's systems performed. **The EDR is designed to record data related to vehicle dynamics and safety systems for a short period of time, typically 30 seconds or less. The EDR in this vehicle is designed to record such data as:**

- **How various systems in your vehicle were operating;**
- **Whether or not the driver and passenger safety belts were buckled/fastened;**
- **How far (if at all) the driver was depressing the accelerator and/or brake pedal; and,**
- **How fast the vehicle was traveling.**

These data can help provide a better understanding of the circumstances in which crashes and injuries occur. NOTE: EDR data are recorded by your vehicle only if a non-trivial crash situation occurs; no data are recorded by the EDR under normal driving conditions and no personal data (e.g., name, gender, age, and crash location) are recorded. However, other parties, such as law enforcement, could combine the EDR data with the type of personally identifying data routinely acquired during a crash investigation.

To read data recorded by an EDR, special equipment is required, and access to the vehicle or the EDR is needed. In addition to the vehicle manufacturer, other parties such as law enforcement that have the special equipment can read the information if they have access to the vehicle or the EDR.

The data belong to the vehicle owner and may not be accessed by anyone else except as legally required or with the permission of the vehicle owner.

Service Diagnostic Recorders

This vehicle is equipped with service-related devices that record information about powertrain performance. The data can be used to verify emissions law requirements and/or help technicians diagnose and solve service problems. It may also be combined with data from other sources for research purposes, but it remains confidential. Some diagnostic and maintenance information is uploaded to Acura upon vehicle start up.

End User License Agreement

Your vehicle comes equipped with software, which is governed by the End User License Agreement in this vehicle's Owner's Manual, and which contains a binding arbitration clause. Please refer to the End User License Agreement for the terms and conditions governing your use of the installed software, as well as the applications, services, functions, and content provided through the software. Your use of the installed software will serve as your consent to the terms and conditions of the End User License Agreement.

You may opt out of the arbitration provisions within 30 days of your initial use of the Software by sending a signed, written notice to HONDA at American Honda Motor Co., Inc. Acura Client Relations Mail Stop 100-5E-8F , 1919 Torrance Blvd. Torrance, CA 90501-2746.

INTRODUCTION

This Owner's Guide is intended to help you quickly get acquainted with your **2019 NSX**. It provides basic information and instructions on technology and convenience features, as well as emergency procedures and how to get assistance.

This guide is for vehicles sold in the United States and Canada. It covers all models, so you may find descriptions of features and equipment that are not in your vehicle. Images throughout this guide represent features and equipment that are available on some, but not all, models.

This guide is not intended to be a substitute for the Owner's Manual. Visit owners.acura.com (U.S.) or acura.ca (Canada) to view the most current Owner's Manual, Navigation Manual, Vehicle Warranty, and the tire manufacturers' warranties.

If you are the first registered owner of your vehicle, you may request a complimentary printed copy of the Owner's Manual, Navigation Manual, or Vehicle Warranty within the first six months of vehicle purchase. To request a copy, visit owners.acura.com and create or log in to your account. In Canada, please request a copy from your Acura dealer.

American Honda Motor Co., Inc. strives to be proactive in protecting our environment and natural resources. By using electronic delivery for a considerable portion of the information typically found in a vehicle Owner's Manual, we are further reducing our impact on the environment.

Acura Client Relations

Your authorized Acura dealer should be able to answer any questions you have about your vehicle. However, if you are dissatisfied with the information you receive, you can call Acura Client Relations.

Call 844-682-2872 (U.S.) or 1-888-9-ACURA-9 (Canada) or 1-844-9-MYNSX-9 (NSX specific) (Canada)

Acura Total Luxury Care Roadside Assistance

Your Acura TLC Roadside Assistance representative is here to help you 24 hours a day, 7 days a week. Under your 4-year/50,000-mile (80,000-km) warranty, the following benefits are available:

- Towing services — full cost of towing to the closest Acura dealer
- Roadside assistance — jump starting, fuel delivery, lockout, and flat tire
- Trip planning — detailed trip routing, emergency services, and more

Call (800) 594-8500 (U.S.) or (800) 565-7587 (Canada)

TABLE OF CONTENTS

VISUAL INDEX..... 1

Steering Wheel and Nearby Controls.....	1
Dashboard and Nearby Controls.....	2

SAFETY INFORMATION..... 3

Important Safety Information.....	3
Seat Belts.....	5
Airbags.....	10
Child Safety.....	20
Safety Label Locations.....	28
Reporting Safety Defects.....	29

INSTRUMENT PANEL..... 31

Malfunction Indicators.....	31
Condition Indicators.....	33
On/Off Indicators.....	35
Driver Information Interface.....	36

VEHICLE CONTROLS..... 38

Using the Remote Transmitter.....	38
Keyless Access System.....	38
Door Operation.....	40
Power Window Operation.....	42

Interior and Exterior Lights..... 44

One-Touch Turn Signal.....	47
Wiper Operation.....	47
Adjusting the Front Seats.....	49
Driving Position Memory System- If equipped.....	53
Floor Mats.....	54
Adjusting the Steering Wheel.....	55
Adjusting the Mirrors.....	55
Homelink® Universal Transceiver.....	58
Climate Control System.....	60
Front Seat Heaters- If equipped	61
Customized Features.....	62
Setting the Clock.....	63

AUDIO AND CONNECTIVITY..... 65

Basic Audio Operation.....	65
AcuraLink®	69
AcuraLink® Assist- If equipped.....	70
Apple CarPlay™	70
Android Auto™	72
Wi-Fi Connection.....	74
FM Radio.....	75

SiriusXM® - If equipped..... 76

iPod®	77
Pandora®- US models only, if equipped.....	79
USB Flash Drive.....	80
Bluetooth® Audio.....	82

BLUETOOTH® HANDSFREELINK® (HFL)..... 85

Basic HFL Operation.....	85
Pairing a Phone.....	87
Making a Call.....	89
SMS Text Messaging and E-Mail- If equipped.....	93
Siri Eyes Free™	94

NAVIGATION..... 96

Basic Navigation Operation.....	96
Entering Your Destination.....	97
Routing.....	99

DRIVING..... 102

Before Driving.....	102
Maximum Load Limit.....	104
Towing a Trailer.....	107
Towing Behind A Motorhome.....	108

Starting to Drive..... 108

Shifting.....	109
Braking.....	113
Integrated Dynamics System.....	117
Vehicle Stability Assist® (VSA®) System.....	119
Cruise Control- If equipped.....	120
Parking Sensor System- If equipped.....	123
Multi-View Rear Camera.....	124
Improving Fuel Economy and Reducing CO ₂ Emissions.....	126
Refueling.....	126

HANDLING THE UNEXPECTED..... 131

Keyless Access System Battery Strength.....	131
Jump Starting.....	131
Overheating.....	133
Emergency Engine Stop	135
Emergency Towing.....	136
Tire Pressure Monitoring System (TPMS).....	137
Fixing a Tire.....	139
Fuse Locations.....	143

MAINTENANCE.....	147	Contact Us.....	184
Safety Precautions.....	147	Warranty Coverages.....	185
Maintenance Minder™.....	148	EPA Contact Information.....	186
Under the Hood and Hatch.....	151	VOICE COMMAND INDEX.....	188
Engine Oil.....	156	Voice Portal Commands.....	188
Engine Coolant.....	162	Phone Commands.....	188
Checking the Battery.....	164	Audio Commands.....	188
Window Washer Fluid.....	164	Navigation Commands- Models	
Brake Fluid.....	165	with navigation only.....	189
Changing Wiper Blades.....	165	INDEX.....	190
Tire Information.....	168		
Tire Labeling.....	174		
DOT Tire Quality Grading.....	176		
Testing of Readiness Codes.....	178		
SPECIFICATIONS.....	180		
CLIENT INFORMATION.....	182		
Frequently Asked Questions/			
Troubleshooting.....	182		

VISUAL INDEX

Quickly locate items in the vehicle's interior.

Steering Wheel and Nearby Controls

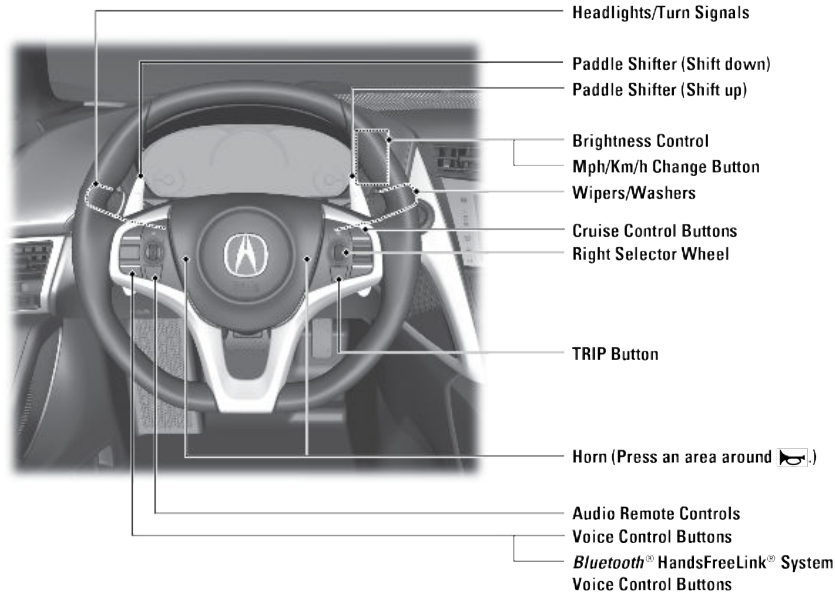

Dashboard and Nearby Controls

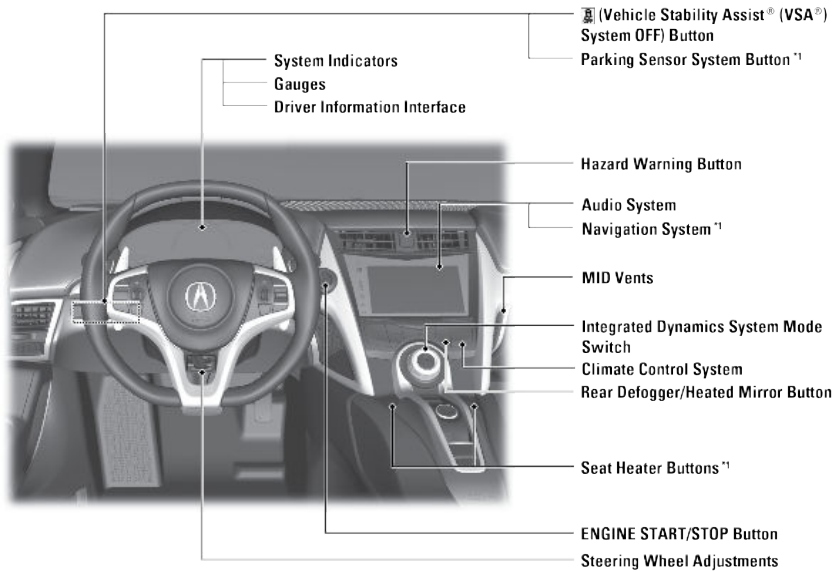

*1 - If equipped

SAFETY INFORMATION

Your safety--and the safety of others--is very important and operating this vehicle safely is an important responsibility. While we strive to help you make informed decisions about safety, it is not practical or possible to warn you about all the hazards associated with operating or maintaining your vehicle. Therefore, you must use your own good judgment.

Important Safety Information

This guide explains many of your vehicle's safety features and how to use them. Please read this information carefully. Following the instructions below will also help to keep you and your passengers safe.

■ Important Safety Precautions

- Always wear your seat belt.
- Your vehicle is not recommended for child passengers.
- Be aware of airbag hazards.
- Don't drink and drive.
- Pay appropriate attention to the task of driving safely.
- Control your speed.
- Keep your vehicle in safe condition.

Engaging in cell phone conversation or other activities that keep you from paying close attention to the road, other vehicles, and pedestrians could lead to a crash. Remember, situations can change quickly, and only you can decide when it is safe to divert some attention away from driving.

Your vehicle is not recommended for child passengers. The National Highway Traffic Safety Administration and Transport Canada recommend that all children ages 12 and under be properly restrained in a back seat. Since this vehicle does not have a back seat, we strongly recommend that you do not carry any child who is not large enough and mature enough to ride in front.

■ Safety Messages

When you see the following messages throughout this guide, pay close attention.

⚠ DANGER

You WILL be KILLED or SERIOUSLY HURT if you don't follow instructions.

⚠ WARNING

You CAN be KILLED or SERIOUSLY HURT if you don't follow instructions.

⚠ CAUTION

You CAN be HURT if you don't follow instructions.

NOTICE

This information is intended to help you avoid damage to your vehicle, other property, or the environment.

■ Carbon Monoxide Gas

The engine exhaust from this vehicle contains carbon monoxide, a colorless, odorless, and highly toxic gas. As long as you properly maintain your vehicle and follow the instructions set forth below, you will not accumulate dangerous levels of carbon monoxide gas in the vehicle interior.

Have the exhaust system inspected for leaks whenever:

- The exhaust system is making an unusual noise.
- The exhaust system may have been damaged.
- The vehicle is raised for an oil change.

⚠ WARNING

Carbon monoxide gas is toxic. Breathing it can cause unconsciousness and even kill you. Avoid any enclosed areas or activities that expose you to carbon monoxide.

An enclosed area such as a garage can quickly fill up with carbon monoxide gas. Do not run the engine with the garage door closed. Even when the garage door is open, drive out of the garage immediately after starting the engine.

Seat Belts

A seat belt is your best protection in all types of collisions. Airbags are designed to supplement seat belts, not replace them. So even though your vehicle is equipped with airbags, make sure you and your passengers always wear your seat belts and wear them properly.

■ **Lap/Shoulder Seat Belts**

Both seating positions are equipped with lap/shoulder seat belts with emergency locking retractors. In normal driving, the retractor lets you move freely while keeping some tension on the belt. During a collision or sudden stop, the retractor locks to restrain your body. The passenger's seat belt also has a lockable retractor that must be properly activated when using a forward-facing child seat, should you choose to disregard our recommendations and install one.

⚠ WARNING

Not wearing a seat belt properly increases the chance of serious injury or death in a crash, even though your vehicle has airbags.
Be sure you and your passenger always wear seat belts and wear them properly.

■ **Proper Use of Seat Belts**

Follow these guidelines for proper use:

- All occupants should sit upright, well back in the seat, and remain in the position for the duration of the trip. Slouching and leaning reduces the effectiveness of the belt and can increase the chance of serious injury in a crash.
- Never place the shoulder part of a lap/shoulder seat belt under your arm or behind your back. This could cause very serious injuries in a crash.
- Two people should never use the same seat belt. If they do, they could be very seriously injured in a crash.

- Do not put any accessories on the seat belts. Devices intended to improve comfort or reposition the shoulder part of a seat belt can reduce the protective capability and increase the chance of serious injury in a crash.
- No one should sit in a seat with an inoperative seat belt or one that does not appear to be working correctly. Using a seat belt that is not working properly may not protect the occupant in a crash. Have a dealer check the belt as soon as possible.

⚠ WARNING

Not wearing a seat belt properly increases the chance of a serious injury or death in a crash, even though your vehicle has airbags.
Be sure you and your passengers always wear seat belts and wear them properly.

■ **Seat Belt Inspection**

Regularly check the condition of your seat belts as follows:

- Pull each belt out fully and look for frays, cuts, burns, and wear.
- Check that the latch plates and buckles work smoothly and the belts retract easily. If a belt does not retract easily, cleaning the belt may correct the problem. Only use mild soap and warm water. Do not use bleach or cleaning solvents. Make sure the belt is completely dry before allowing it to retract.

Any belt that is not in good condition or working properly will not provide proper protection and should be replaced as soon as possible.

A belt that has been worn during a crash may not provide the same level of protection in a subsequent crash. Have your seat belts inspected by a dealer after any collision.

⚠ WARNING

Not checking or maintaining seat belts can result in serious injury or death if the seat belts do not work properly when needed.

Check your seat belts regularly and have any problem corrected as soon as possible.

■ Fastening a Seat Belt

Adjust your seat to the proper position and then follow the steps below:

1. Pull the seat belt out slowly.



2. Insert the latch plate into the buckle, then tug on the belt to make sure the buckle is secure. Make sure that the belt is not twisted or caught on anything.
3. Position the lap part of the belt as low as possible across your hips, then pull up on the shoulder part of the belt so the lap part fits snugly. This lets your strong pelvic bones take the force of a crash and reduces the chance of internal injuries.
4. If necessary, pull up on the belt again to remove any slack, then make sure that the belt rests across the center of your chest and over your shoulder. This spreads the forces of a crash over the strongest bones in your upper body.

To release the belt, push the red PRESS button then guide the belt by hand until it has retracted completely.

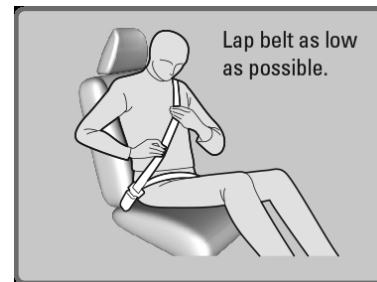
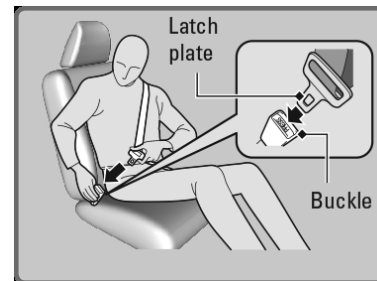

⚠ WARNING

Improperly positioning the seat belt can cause serious injury or death in a crash. Make sure all seat belts are properly positioned before driving.

Airbags

Your vehicle is equipped with several types of airbags: front airbags, front knee airbag, side airbags, and side curtain airbags.

■ Front Airbags (SRS)

The front SRS airbags inflate in a moderate-to-severe frontal collision to help protect the head and chest of the driver and/or front passenger. They are housed in the center of the steering wheel for the driver and in the dashboard for the front passenger. Both airbags are marked **SRS AIRBAG**.

SRS (Supplemental Restraint System) indicates that the airbags are designed to supplement seat belts, not replace them. Seat belts are the occupant's primary restraint system.

Driver's Knee Airbag

The driver's knee SRS airbag inflates in a moderate-to-severe frontal collision to help keep the driver in the proper position and to help maximize the benefit provided by the vehicle's other safety features.

■ Advanced Airbags

The front airbags have advanced features to help reduce the likelihood of airbag related injuries to smaller occupants.

The driver's advanced airbag system includes a seat position sensor. Based on information from this sensor and the severity of the impact, the advanced airbag system determines the optimal deployment of the driver's airbag.

The front passenger's advanced airbag system has weight sensors.

We advise against allowing a child age 12 or under to ride in the passenger's seat. However, **if you do allow a child age 12 or under to ride in the passenger's seat**, note that the system will automatically turn off the front passenger's airbag if the sensors detect that the child is approximately 65 lbs (29 kg) or less.

For the advanced airbags to work properly:

- Do not spill any liquid on or under the seats.
- Do not put any object under the passenger's seat.
- Make sure any objects are positioned properly on the floor. Improperly positioned objects can interfere with the advanced airbag sensors.
- All occupants should sit upright and wear their seat belts properly.

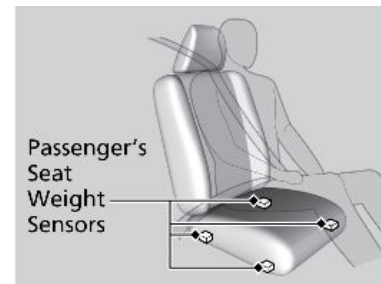

- Do not cover the passenger's side dashboard with a cloth, towel, cover, etc.

■ Side Airbags

The side airbags help protect the upper torso and pelvis of the driver or a passenger during a moderate-to-severe side impact. They are housed in the outside edge of the driver's and passenger's seat-backs. Both are marked **SIDE AIRBAG**.

■ Side Curtain Airbags

Side curtain airbags help protect the heads of the driver or a passenger during a moderate-to-severe side impact. The side curtain airbags equipped in this vehicle are also designed to help reduce the likelihood of partial and complete ejection of vehicle occupants through side windows in crashes, particularly rollover crashes.

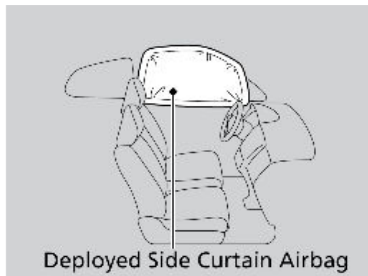
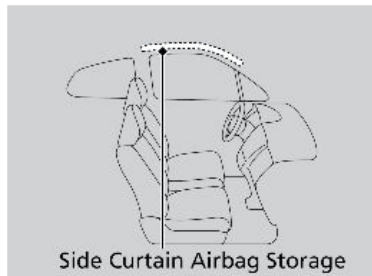

The side curtain airbags are located in the ceiling above the side windows on both sides of the vehicle.

The side curtain airbags are designed to deploy in a rollover or moderate-to-severe side impact. If the SRS control unit senses that your vehicle is about to roll over, it immediately deploys both side curtain airbags and activates both front seat belt tensioners. If the impact is on the passenger's side, the passenger's side curtain airbag will inflate even if there are no occupants on that side of the vehicle.

To get the best protection from the side curtain airbags, occupants should wear their seat belts properly and sit upright and well back in their seats.

Do not attach any objects to the side windows or roof pillars, as they can interfere with the proper operation of the side curtain airbags.

When side curtain airbags deploy in a frontal collision

One or both side curtain airbags may inflate in a moderate-to-severe angled frontal collision.

■ Important Facts About Your Airbags

Always wear your seat belt properly, sit upright, and as far back from the steering wheel as possible while allowing full control of the vehicle. A front passenger should move their seat as far back from the dashboard as possible.

Do not place hard or sharp objects between yourself and a front airbag.

Carrying hard or sharp objects on your lap, or driving with a pipe or other sharp object in your mouth, can result in injuries if your front airbag inflates.

Do not attach or place objects on the front airbag covers. Objects on the covers marked **SRS AIRBAG** could interfere with the proper operation of the airbags or be propelled inside the vehicle and hurt someone if the airbags inflate.

⚠ WARNING

An open glove box can cause serious injury to your passenger in a crash, even if the passenger is wearing the seat belt.

Always keep the glove box closed while driving.

■ Airbag System Indicators

If a problem occurs in the airbag system, the SRS indicator comes on and a message appears on the Driver Information Interface .

Supplemental Restraint System (SRS) Indicator

If the indicator comes on at any other time besides vehicle start-up or does not come on at all, have the system checked by a dealer as soon as possible. If you don't, your airbags and seat belt tensioners may not work properly when they are needed.

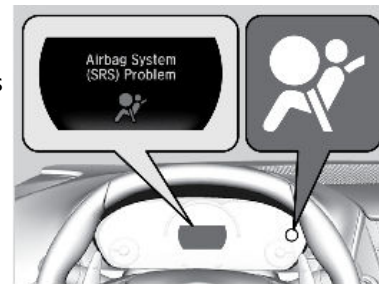
**⚠ WARNING**

Ignoring the SRS indicator can result in serious injury or death if the airbag systems or tensioners do not work properly.

Have your vehicle checked by a dealer as soon as possible if the SRS indicator alerts you to a possible problem.

Passenger Airbag Off Indicator

The indicator comes on to alert you that the passenger's front airbag has been turned off. This occurs when the passenger's weight sensors detect 65 lbs (29 kg) or less, the weight of an infant or small child, on the seat.

Your vehicle is not recommended for child passengers. Never put a rear-facing child seat in this vehicle. If you decided to disregard our recommendations and transport a small child, they should be properly restrained.

Objects placed on the seat can also cause the indicator to come on.

If the passenger's seat is empty, the indicator will not come on and, in the event of a crash, the passenger's airbag will not deploy.

If the indicator comes on with no occupant or objects in the passenger's seat, something may be interfering with the weight sensors, such as:

- An object hanging on the seat or in the seat-back pocket.
- An object pressing against the rear of the seat-back.
- The seat or seat-back is forced back against cargo on the rear trays or floor behind it.
- An object placed under the passenger's seat.



If none of these conditions exist, have your vehicle checked by a dealer as soon as possible.

The passenger airbag off indicator may come on and go off repeatedly if the total weight on the seat is near the airbag cutoff threshold.

■ Airbag System Components

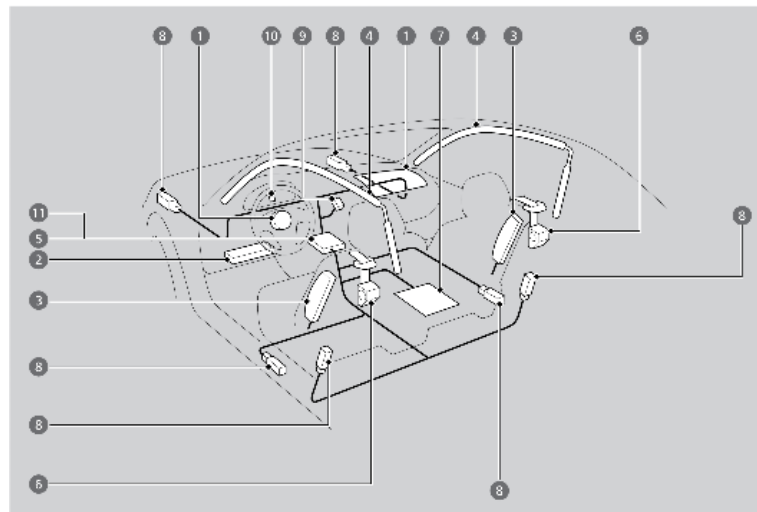

1. Two SRS (Supplemental Restraint System) front airbags. The driver's airbag is stored in the center of the steering wheel; the front passenger's airbag is stored in the dashboard. Both are marked **SRS AIRBAG**.
2. Driver's knee airbag. The knee airbag is stored under the steering column. It is marked **SRS AIRBAG**.
3. Two side airbags, one for the driver and one for a front passenger. The airbags are stored in the outer edges of the seat-backs. Both are marked **SIDE AIRBAG**.
4. Two side curtain airbags, one for each side of the vehicle. The airbags are stored in the ceiling, above the side windows. The front and rear pillars are marked **SIDE CURTAIN AIRBAG**.
5. An electronic control unit that, when the vehicle is on, continually monitors information about the various impact sensors, seat and buckle sensors, rollover sensor, airbag activators, seat belt tensioners, and other vehicle information. During a crash event the unit can record such information.
6. Automatic front seat belt tensioners. The driver's and front passenger's seat belt buckles incorporate sensors that detect whether or not the belts are fastened.
7. Weight sensors in the front passenger's seat. The front passenger's airbag will be turned off if the weight on the seat is about 65 lbs (29 kg) or less (the weight of an infant or small child).
8. Impact sensors that can detect a moderate-to-severe front or side impact.

9. An indicator on the dashboard that alerts you that the front passenger's front airbag has been turned off.
10. An indicator on the instrument panel that alerts you to a possible problem with the airbag system or seat belt tensioners.
11. A rollover sensor that can detect if your vehicle is about to roll over and signal the control unit to deploy both side curtain airbags.

■ Airbag Care

You do not need to, and should not, perform any maintenance on or replace any airbag system components yourself. However, you should have your vehicle inspected by a dealer in the following situations:

When the airbags have deployed

If an airbag has inflated, the control unit and other related parts must be replaced. Similarly, once an automatic seat belt tensioner has been activated, it must be replaced.

When the vehicle has been in a moderate-to-severe collision

Even if the airbags did not inflate, have your dealer inspect the following: the driver's seat position sensor, weight sensors in the passenger's seat, front seat belt tensioners, and each seat belt that was worn during the crash.

Do not remove or modify a front seat without first consulting a dealer

This would likely disable or affect the weight sensors in the passenger's seat. If it is necessary to remove or modify a front seat to accommodate a person with disabilities, contact an Acura NSX dealer. For U.S. vehicles, call Acura NSX Client Relations at **844-682-2872** For Canadian vehicles, call Acura Client Services at (888) 922-8729 or **1-844-9-MYNSX-9** (NSX specific).

Child Safety

Each year, many children are injured or killed in vehicle crashes because they are either unrestrained or not properly restrained. In fact, vehicle collisions are the number one cause of death of children ages 12 and under.

The National Highway Traffic Safety Administration and Transport Canada recommend that all children ages 12 and under be properly restrained in a rear seat. Some states or provinces/territories have laws restricting where children may ride.

To reduce the number of child deaths and injuries, every state, Canadian province, and territory requires that infants and children be properly restrained when they ride in a vehicle. Never put a rear-facing child seat in this vehicle.

■ Protecting Child Passengers – Important Considerations

- **Since this vehicle does not have a back seat, we recommend that you do not carry a child, age 12 or under, as a passenger.** This is because an inflating front or side airbag can injure or kill a child sitting in the passenger's seat.

- A child in the front seat is more likely to interfere with the driver's ability to safely control the vehicle.
- Any child who is too small to wear a seat belt correctly must be restrained in an approved child seat that is properly secured to the vehicle using either the lap belt portion of the lap/shoulder belt or the lower anchors of the LATCH system.
- Never hold a child on your lap because it is impossible to protect them in the event of a collision.
- Never put a seat belt over yourself and a child. During a crash, the belt would likely press deep into the child and cause serious or fatal injuries.
- Never let two children use the same seat belt. Both children could be very seriously injured in a crash.
- Do not allow children to operate the doors, windows, or seat adjustments.

- Do not leave children, pets or people needing assistance in the vehicle unattended, especially in hot weather when the inside of the vehicle can get hot enough to kill them. They could also activate vehicle controls, causing it to move unexpectedly.

⚠ WARNING

Children who are unrestrained or improperly restrained can be seriously injured or killed in a crash.

Any child too small for a seat belt should be properly restrained in a child seat. A larger child should be properly restrained with a seat belt, using a booster seat if necessary.

⚠ WARNING

Allowing a child to play with a seat belt or wrap one around their neck can result in serious injury or death.

Instruct children not to play with any seat belt and make sure any unused seat belt a child can reach is buckled, fully retracted, and locked.

■ Protecting Infants

An infant must be properly restrained in a rear-facing, reclining child seat until the infant reaches the seat manufacturer’s weight or height limit for the seat,

and the infant is at least one year old. **Because rear-facing child seats should not be used in this vehicle, you should never carry an infant in this vehicle.**

⚠ WARNING

Placing a rear-facing child seat in the passenger’s seat can result in serious injury or death during a crash.

Never install a rear-facing child seat in this vehicle.

■ Protecting Smaller Children

Since this vehicle does not have a back seat, we recommend that you do not carry a child, age 12 or under, as a passenger. This is because placing a forward-facing child seat in the passenger’s seat can be hazardous, even with advanced front airbags that automatically turn the passenger’s front airbag off.

If you choose to ignore our warnings and transport a small child in this vehicle, be sure to move the passenger seat as far to the rear as possible, and follow the instructions and guidelines in the following pages.

⚠ WARNING

Placing a forward-facing child seat in the passenger’s seat can result in serious injury or death if the front airbag inflates.

If you must place a forward-facing child seat in passenger’s seat, move the vehicle seat as far back as possible, and properly restrain the child.

■ Selecting a Child Seat

Important considerations when selecting a child seat

Make sure the child seat meets the following three requirements:

- The child seat is the correct type and size for the child.
- The child seat is the correct type for the seating position.
- The child seat is compliant with Federal Motor Vehicle Safety Standard 213 or Canadian Motor Vehicle Safety Standard 213.

■ Installing a Child Seat with a Lap/Shoulder Seat Belt

1. Move the passenger seat to the rearmost position.
2. Place the child seat on the passenger seat.
3. Route the seat belt through the child seat according to the seat manufacturer's instructions, and insert the latch plate into the buckle. Insert the latch plate fully until it clicks.

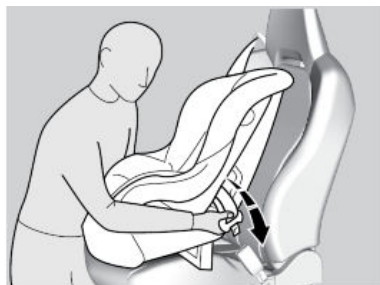

4. Slowly pull the shoulder part of the belt all the way out until it stops. This activates the lockable retractor.
5. Let the seat belt completely wind up into the retractor, then try to pull it out to make sure the retractor is locked. If you are able to pull the shoulder belt out, the lockable retractor is not activated. Pull the seat belt all the way out, and repeat steps 4 – 5.
6. Grab the shoulder part of the seat belt near the buckle, and pull up to remove any slack from the lap part of the belt. When doing this, place your weight on the child seat and push it into the vehicle seat.

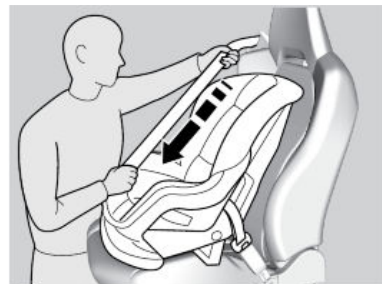

7. Make sure the child restraint system is firmly secured by rocking it forward and back, and side to side; less than one inch of movement should occur near the seat belt.

To deactivate a lockable retractor, release the buckle and allow the seat belt to wind up all the way.

■ Adding Security with a Tether

A tether anchorage point is provided behind the passenger seat. A child seat with a tether can be installed, so long as the base of the child seat is secured using a seat belt.

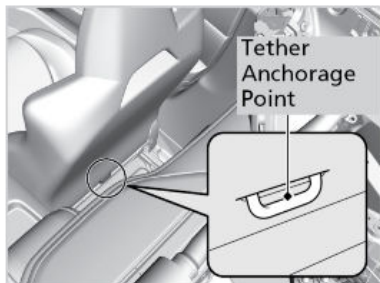
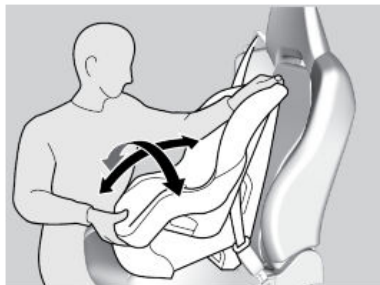

1. Move the seat forward.
2. Secure the tether strap hook onto the anchor. Make sure the strap is not twisted.
3. Tighten the tether strap as instructed by the child seat manufacturer.

4. Move the seat to the rearmost position.

Note: Always use a tether for forward facing child seats when using the seat belt or lower anchors.

■ Protecting Larger Children

Since this vehicle does not have a back seat, we recommend that you do not carry a child age 12 or under as a passenger. This is because children who have outgrown child seats are also at risk of being injured or killed by an inflating passenger's front airbag. If a larger child must ride in this vehicle, the following information may be useful when deciding when a child may ride in this vehicle, and how to properly protect the child.

Have the child sit upright and all the way back, then ensure the following:

- The child's knees bend comfortably over the edge of the seat.
- The shoulder belt crosses between the child's neck and arm.
- The lap part of the seat belt is as low as possible, touching the child's thighs.
- The child can stay seated for the whole trip.

If a lap/shoulder belt cannot be used properly, position the child in a booster seat



in the passenger's seating position. For the child's safety, check that the child meets the booster seat manufacturer's recommendations.

Some U.S. states and Canadian provinces/territories require children to use a booster seat until they reach a given age or weight (e.g., 6 years or 60 lbs). Be sure to check current laws in the state or province/territory where you intend to drive.

⚠ WARNING

Allowing a child age 12 or under to sit in the front can result in injury or death if the passenger's front airbag inflates.

If a larger child must ride in front, move the vehicle seat as far to the rear as possible, have the child sit up properly and wear the seat belt properly, using a booster seat if needed.

Safety Label Locations

Safety labels are in the locations shown. They warn you of potential hazards that can cause serious injury or death. Read these labels carefully.

If a label comes off or becomes hard to read (except for the U.S. dashboard label which may be removed by the owner), contact a dealer for a replacement.

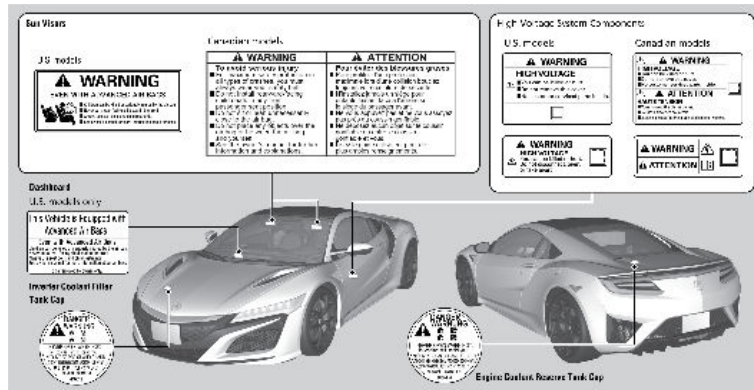

Reporting Safety Defects

In the U.S.

If you believe that your vehicle has a defect which could cause a crash or could cause injury or death, you should immediately inform the National Highway Traffic Safety Administration (NHTSA) in addition to notifying American Honda Motor Co., Inc.

If NHTSA receives similar complaints, it may open an investigation, and if it finds that a safety defect exists in a group of vehicles, it may order a recall and remedy campaign. However, NHTSA cannot become involved in individual problems between you, your dealer, or American Honda Motor Co., Inc.

To contact NHTSA, you may call the Vehicle Safety Hotline toll-free at 1-888-327-4236 (TTY: 1-800-424-9153); go to safercar.gov, or write to: Administrator, NHTSA, 1200 New Jersey Avenue, SE., Washington, DC 20590. You can also obtain other information about motor vehicle safety from safercar.gov.

In Canada

If you believe that your vehicle has a defect which could cause a crash or could cause injury or death, you should immediately inform Honda Canada, Inc., and you may also inform Transport Canada.

If Transport Canada receives similar complaints, it may open an investigation, and if it finds that a safety defect exists in a group of vehicles, it may lead to a recall and remedy campaign. However, Transport Canada cannot become involved in individual problems between you, your dealer, or Honda Canada, Inc.

To contact Transport Canada's Defect Investigations and Recalls Division, you may call 1-800-333-0510. For more information on reporting safety defects or about motor vehicle safety, go to tc.gc.ca/roadsafety.

INSTRUMENT PANEL

Learn about the indicators, gauges, and displays related to driving the vehicle.



Indicators briefly appear with each engine start and then go out. Red and amber indicators are most critical. Blue and green indicators are used for general information.

Malfunction Indicators

These are the most critical indicators. If they come on and stay lit while driving or at any other time, there may be a problem. See your dealer if necessary.



Brake system

- Brake fluid is low.
 - There is a malfunction in the brake system.
- Press the brake pedal lightly to check pedal pressure. If normal, check the brake fluid level when you stop. If abnormal, take immediate action. If necessary, downshift the transmission to slow the vehicle using engine braking. Have your vehicle repaired immediately.



Low oil pressure

Engine oil pressure is low. Stop in a safe place. Open the hood, check the oil level and add oil if necessary. If the indicator does not turn off, have your vehicle repaired immediately.



12-Volt Battery Charging system

The 12-volt battery is not charging. Turn all electrical items off, but do not turn the vehicle off to prevent further battery discharge. Have your vehicle repaired immediately.



Supplemental Restraint System (SRS)

There is a problem with one of the airbag systems or seat belt tensioners.



Keyless Access System

There is a problem with the system.



Malfunction Indication Lamp (check engine light)

The emissions control system may have a problem, or the fuel cap is missing or loose. If the indicator blinks, a misfire in the engine's cylinders is detected. Stop in a safe place and wait for the engine to cool down.



Anti-lock Brake System (ABS)

There is a problem with the anti-lock brake system. Your vehicle still has normal braking ability, but no anti-lock function.



Low Tire Pressure / Tire Pressure Monitoring System (TPMS)

- Blinks and remains on:
- Have your vehicle checked by a dealer. If the vehicle is fitted with a compact spare, get your regular tire repaired or replaced and put back on your vehicle as soon as you can.



Vehicle Stability Assist® (VSA®) System

There is a problem with the VSA® or hill start assist system.



Electric Power Steering (EPS)

There is a problem with the system. Stop the vehicle in a safe place, and restart the engine.

Condition Indicators

These indicators may require you to perform an action.

BRAKE
us

Canada



Parking Brake

Release the parking brake before driving. You will hear a beep if you drive with it not fully released.



Low Fuel

Refuel as soon as possible. If the indicator blinks, there is a problem with the fuel gauge. See your dealer.



Low Tire Pressure / Tire Pressure Monitoring System (TPMS)

- Comes on while driving:
Stop in a safe place, check tire pressures, and inflate tire(s) if necessary.



System Message

When a condition or malfunction indicator comes on, a message also appears on the multi-information display (MID). Check the display for more information.



Immobilizer

Your key or remote transmitter cannot be recognized by the vehicle. If the indicator blinks, you may not be able to start the engine. Turn the vehicle off, and then on again. If it continues to blink, there may be a problem with the system. See your dealer.

On/Off Indicators

These indicators remind you when an item is on or off.



VSA® off



VSA® engaged (blinks)

LKAS

LKAS on



Turn signals/hazards on



Fog lights*¹ on



High beams on



Exterior lights on

*1 - If equipped

Driver Information Interface

Consists of several displays that provide you with useful information.

Main Displays

Roll the multi-function steering wheel controls to change the display.

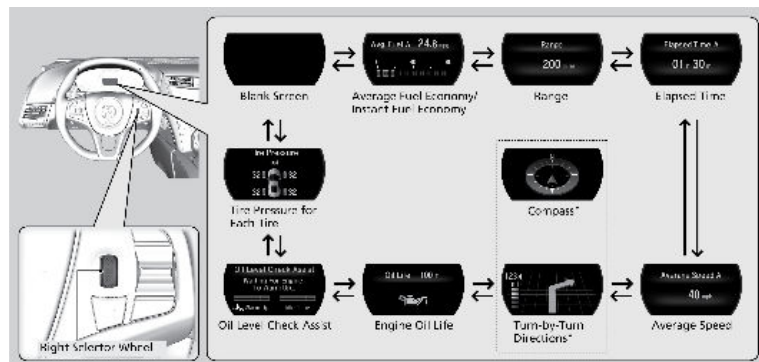

* Not available on all models

Lower Displays

Press the **TRIP** button to change the display.

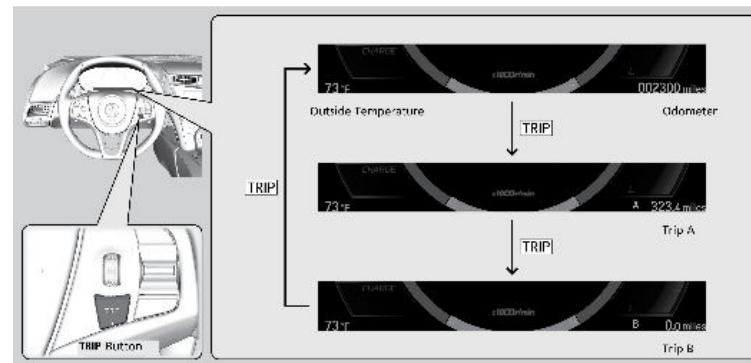

VEHICLE CONTROLS

Learn about the various controls necessary for operating and driving the vehicle.

Using the Remote Transmitter

Use the remote transmitter to lock or unlock the doors and hatch.

Note: Leaving the remote transmitter in the vehicle can result in theft or accidental movement of the vehicle. Always take it with you whenever you leave the vehicle unattended.



Keyless Access System

When you carry the remote transmitter (for example, in a pocket or purse) and it is outside the vehicle and within range (about 32 inches or 80 cm), the outer door handles automatically pop in/out and you can lock or unlock the doors, and open the hatch without handling the transmitter.

■ Unlocking/Locking the Doors

To unlock: Grab the driver's door handle to unlock the driver's door. Grab the front passenger's door handle to unlock all the doors and the hatch. You can customize this feature's behavior.

To lock: Press the door lock button on either front door handle. If the remote transmitter is inside the vehicle, the doors will not lock.

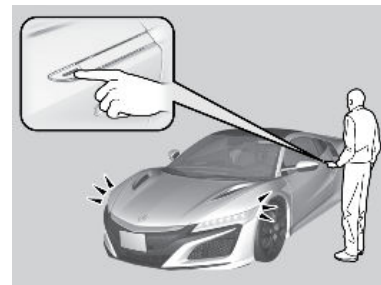
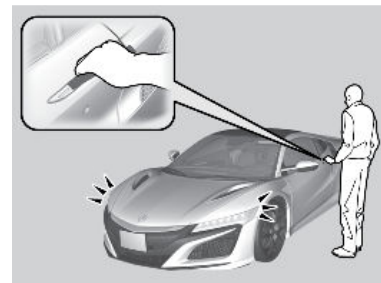

■ Customizing Door Lock and Unlock Settings

Customize the auto door lock and door unlock settings to your preference. Begin with the vehicle off.

1. Press the **Display/Information** button to get to the HOME screen.
2. From the HOME screen, select **Vehicle Settings**.
3. Select **Vehicle**.
4. Select **Door Setup**.
5. Select **Auto Door Lock** or **Auto Door Unlock** to customize.

Door Operation

Use several methods to lock or unlock the doors.

■ Using the Lock Tab

To unlock: When you unlock either front door using the lock tab, the specific door (driver's or passenger's) unlocks.

To lock: When you lock the door using the lock tab on the driver's door, all the other doors and the hatch lock at the same time. When you lock the door using the lock tab on the front passenger's door, only that door locks.

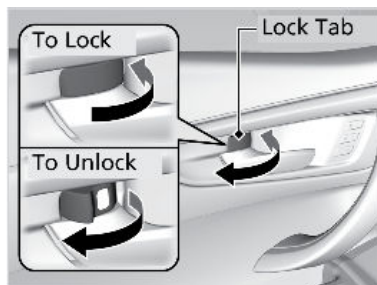

■ Using the Front Door Inner Handle

Pull the front door inner handle. The door unlocks and opens in one motion. Unlocking and opening the driver's door from the inner handle unlocks all other doors.

Do not pull a front door inner handle while the vehicle is moving.

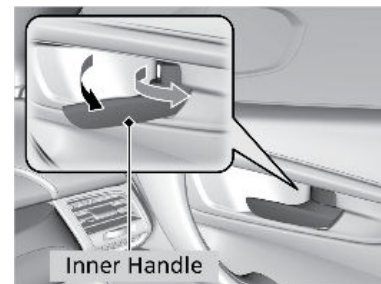

■ Using the Master Door Lock Switch

To unlock: Press the unlock side of the switch to unlock all doors and the hatch.

To lock: Press the lock side of the switch to lock all doors and the hatch.

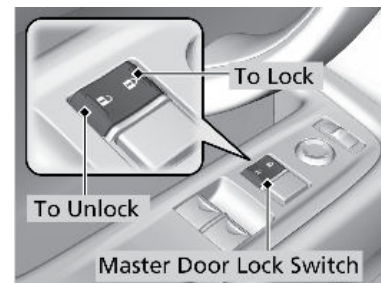

■ Childproof Door Locks

The childproof door locks prevent the rear doors from being opened from the inside regardless of the position of the lock tab.

Slide the lever in the rear door to the lock position, and close the door.

Open the door using the outer door handle.

Note: To open the door from the inside when the childproof door lock is on, put the lock tab in the unlock position, lower the rear window, put your hand out of the window, and pull the outside door handle.

■ Using the Hatch Release Button

Press the hatch release button on the driver's door to unlock and open the hatch.

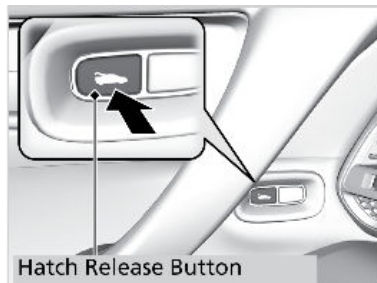

Power Window Operation

The power windows can be opened and closed by using the switches on the doors when the vehicle is on. The switches on the driver's side can be used to open and close all the windows.

■ Automatic Operation

To open: Push the switch down firmly.

To close: Pull the switch up firmly.

The window opens or closes completely. To stop the window at any time, push or pull the switch again briefly.

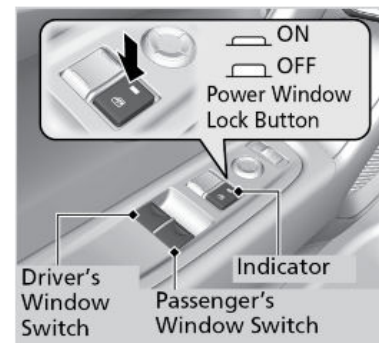

■ Manual Operation

To open: Push the switch down lightly.

To close: Pull the switch up lightly.

Release the switch when the windows reach the desired position.

■ Power Window Lock

Push in the power window lock button so only the driver's window can be operated.

⚠ WARNING

Closing a power window on someone's hands or fingers can cause serious injury.

Make sure your passengers are away from the windows before closing them.

Interior and Exterior Lights

Operate interior and exterior lights when the vehicle is on or off.

■ Brightness Control

Adjust instrument panel brightness when the vehicle is on.

To brighten: Press the + button.

To dim: Press the - button.

A beep sounds when the brightness reaches its minimum or maximum.

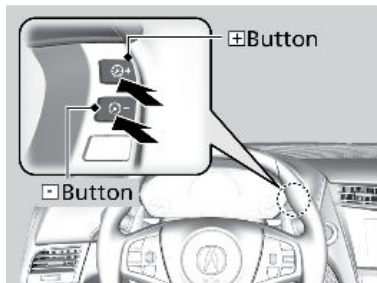

■ Interior Lights

Change the interior light settings using the switches on the ceiling.

ON position: Interior lights remain on.

Door-activated position: Interior lights come on when any of the doors are opened, the driver's door is unlocked, or the vehicle is turned off.

OFF position: Interior lights remain off.

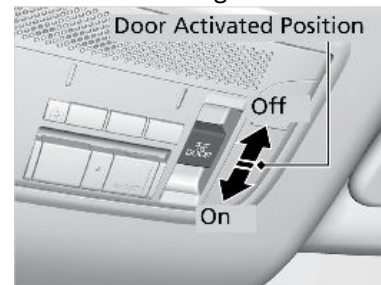

■ Map Lights

Press the map lights to turn on or off.

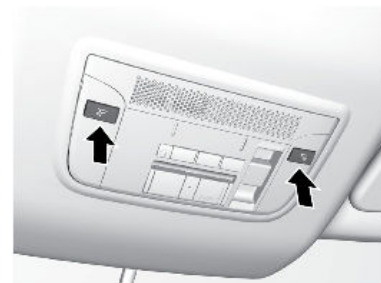

■ Exterior Lights

Rotate the switches on the lever to operate the exterior lights. Push the lever forward to turn on the high beams. Return the lever to its original position for low beams.

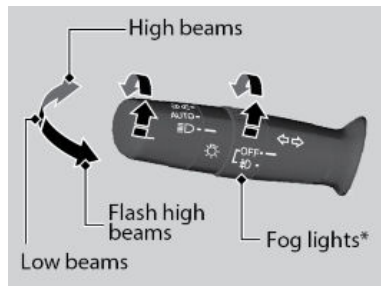

OFF: All exterior lights are off.

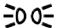
 Turn on exterior lights except headlights.

AUTO: Turn on the automatic lighting feature. Headlights turn on or off depending on ambient brightness when the vehicle is on. Headlights automatically come on after the wipers are engaged for a certain time. The headlights come on when you unlock a door in dark areas with the headlight switch in AUTO.

 Turn on all exterior lights including headlights.

 Turn fog lights*¹ on or off.

**1 - If equipped*

One-Touch Turn Signal

Use this quick and convenient method to signal a lane change.

Lightly push the turn signal lever up or down for a three-blink sequence.

For a continuous signal, push the lever up or down until it locks into place.

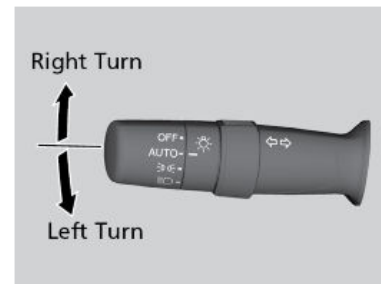

Wiper Operation

The windshield wipers and washers can be used when the vehicle is on.

■ Front Wipers

Move the wiper lever up or down to the desired position.

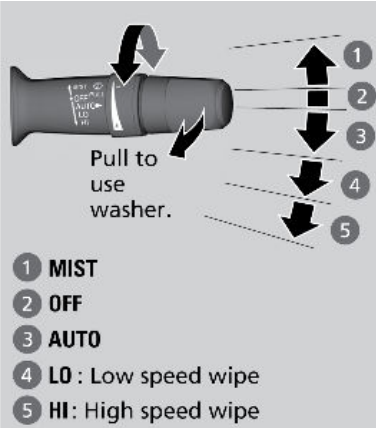

■ Headlight Integration with Wipers

When the headlights are in the **AUTO** position, they automatically turn on when the front wipers operate several times within a certain interval. The headlights turn off shortly after the wipers are turned off or if there is enough ambient light.

■ Intermittent (INT) Wipers

When you move the lever to the **INT** position, the wipers operate based on the delay adjustment.
Rotate the adjustment ring to adjust the wiper delay.

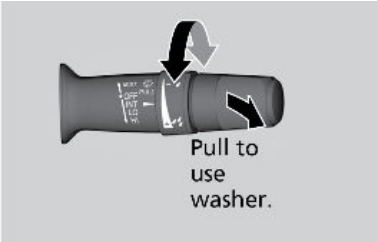

Adjusting the Front Seats

Adjust the driver's seat as far back as possible while allowing you to maintain full control of the vehicle. You should be able to sit upright and well back in the seat, adequately press the pedals without leaning forward, and grip the steering wheel comfortably. The passenger's seat should be adjusted so that it is as far back from the front airbag in the dashboard as possible.

The National Highway Traffic Safety Administration and Transport Canada recommends that drivers allow at least 10 inches (25 cm) between the center of the steering wheel and the chest.



Front Power Seat(s)^{*1}



Front Manual Seat(s)^{*1}

^{*1} - If equipped



Lumbar Support Adjustment Switch^{*1}

Press the top: To move the lumbar support up.

Press the bottom: To move the lumbar support down.

Press the front: To increase the entire lumbar support.

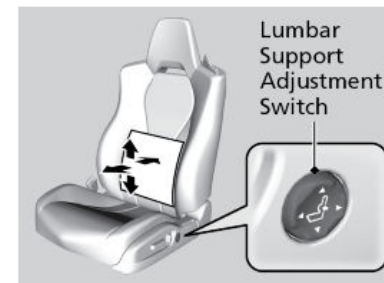

Press the rear: To decrease the entire lumbar support.

⚠ WARNING

Sitting too close to a front airbag can result in serious injury or death if the front airbags inflate.
Always sit as far back from the front airbags as possible while maintaining control of the vehicle.

⚠ WARNING

Reclining the seat-back too far can result in serious injury or death in a crash.
Adjust the seat-back to an upright position, and sit well back in the seat.

⚠ WARNING

Sitting improperly or out of position can result in serious injury or death in a crash.
Always sit upright, well back in the seat, with your feet on the floor.

**1 - If equipped*

Driving Position Memory System^{*1}

You can store two driver's seat (except for power lumbar), and door mirror positions with the driving position memory system.

When you unlock and open the driver's door with a remote transmitter, or keyless access system, door mirrors adjust to one of the two preset positions and the seat adjusts to retracted positions of one of the two preset positions automatically.

The seat will move to the stored position when you set the power mode to ACCESSORY.



**1 - If equipped*

Storing a Position in Memory

1. Adjust the seat, to your preferred positions.
2. Press SET.
3. Press and hold memory button 1 or 2 within 5 seconds of pressing the SET button.

You will hear two beeps when the memory is set.

4. Press one of the memory buttons to recall previously stored positions.

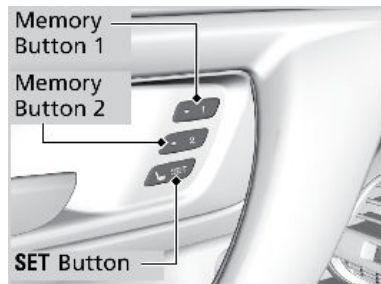

Floor Mats

Do not put additional floor mats on top of the anchored mats.

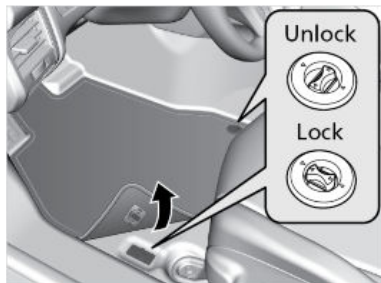

Adjusting the Steering Wheel

The steering wheel height and distance from your body can be adjusted so that you can comfortably grip the steering wheel in an appropriate driving posture.

1. Push down the steering wheel adjustment lever.
2. Move the steering wheel up, down, in, or out.
3. Pull up on the steering wheel adjustment lever to lock the steering wheel in position.

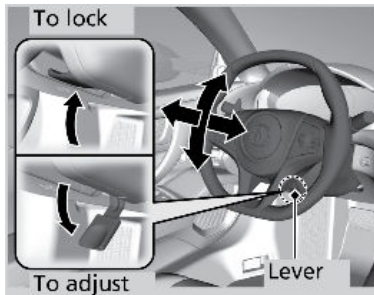
**⚠ WARNING**

Adjusting the steering wheel position while driving may cause you to lose control of the vehicle and be seriously injured in a crash.

Adjust the steering wheel only when the vehicle is stopped.

Adjusting the Mirrors

Adjust the angle of the mirrors for the best visibility when you are sitting in the correct driving position.

■ Automatic Dimming Rearview Mirror

When driving after dark, the automatic dimming function reduces glare in the rearview mirror from headlights behind you. This cannot be turned off. This function cancels when the shift lever is in Reverse (R).

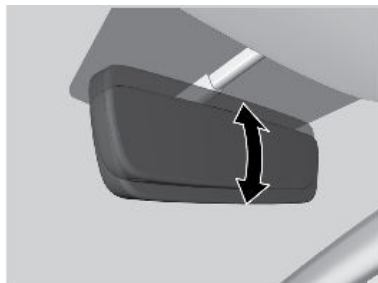

■ Power Door Mirrors

Adjust the power door mirrors when the vehicle is on.

L/R selector switch: Select the left or right mirror.

After adjusting the mirror, return the switch to the center position.

Mirror position adjustment switch: Press the switch left, right, up, or down to move the mirror.

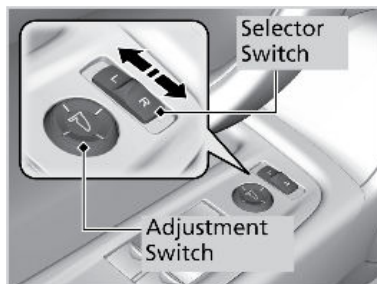

■ Reverse Tilt Door Mirrors

To activate this feature, set the power mode to ON and slide the selector switch to the left or right side. If activated, either side door mirror can tilt downward when you shift to Reverse (R) to improve visibility on the selected side of the vehicle when reversing. The mirror returns to its original position when you shift out of Reverse.

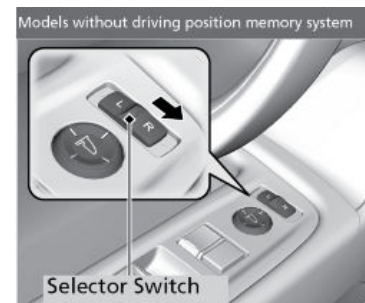
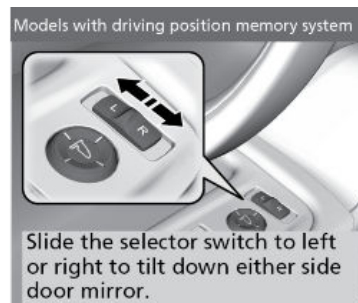

Homelink® Universal Transceiver

Program your vehicle to operate up to three remote-controlled devices around your home—such as garage doors, lighting, or home security systems—using the buttons on the ceiling.

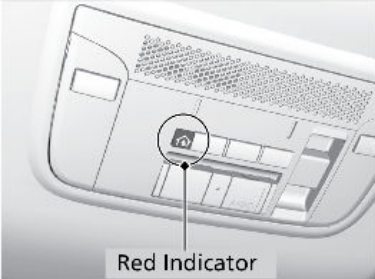

■ Training a Button

Park near the system you want to program, and follow the instructions in the flowchart below.

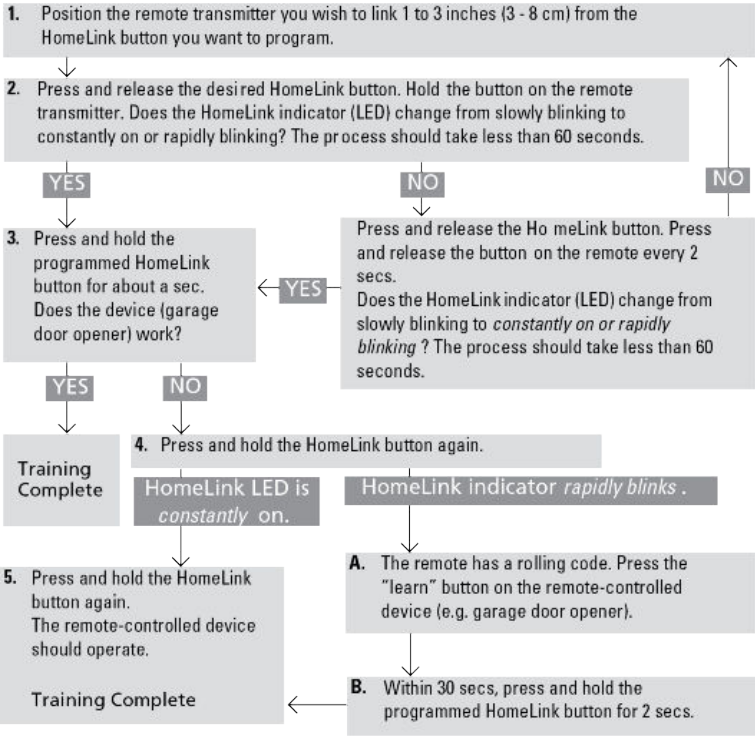

To retrain a button or erase codes, see the Owner's Manual at owners.acura.com (U.S.) or www.acura.ca (Canada). If you need help, call HomeLink at (800) 355-3515 or visit www.homelink.com.

Climate Control System

The automatic climate control system maintains the interior temperature you select. The system also selects the proper mix of heated or cooled air that raises or lowers the interior temperature to your preference as quickly as possible.

■ Front Operation - Climate Control System

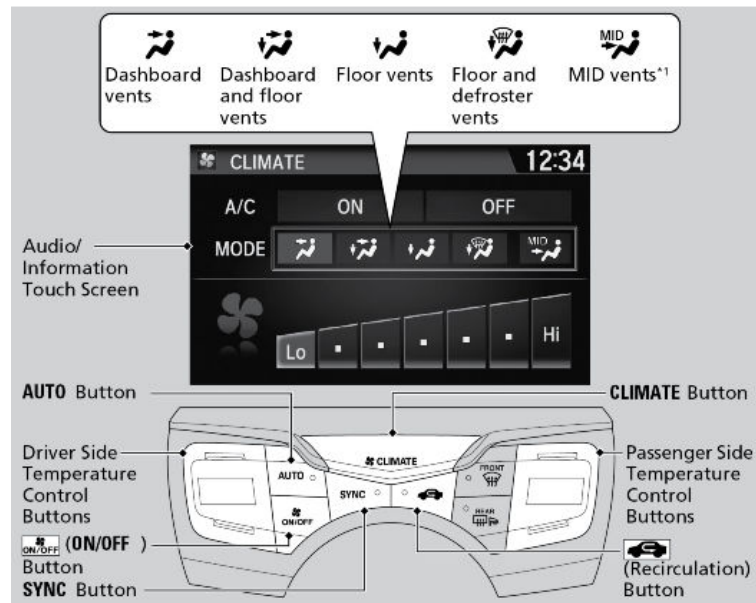

Front Seat Heaters*1

Quickly warm the front seats when the vehicle is on.

Press the seat heater *1 button to cycle through settings.

*1 - If equipped

- Once - The HI setting (three indicators on)
- Twice - The MID setting (two indicators on)
- Three times - The LO setting (one indicator on)
- Four times - The OFF setting (no indicators on)

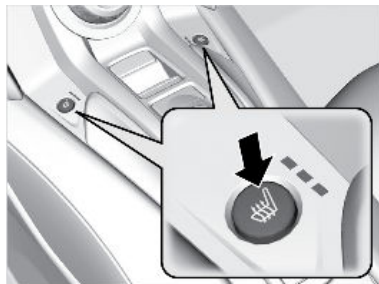

⚠ WARNING

Heat-induced burns are possible when using seat heaters.

Persons with a diminished ability to sense temperature (e.g., persons with diabetes, lower-limb nerve damage, or paralysis) or with sensitive skin should not use the seat heaters.

Customized Features

When you customize settings, make sure that the vehicle is at a complete stop and shift to Park (P).

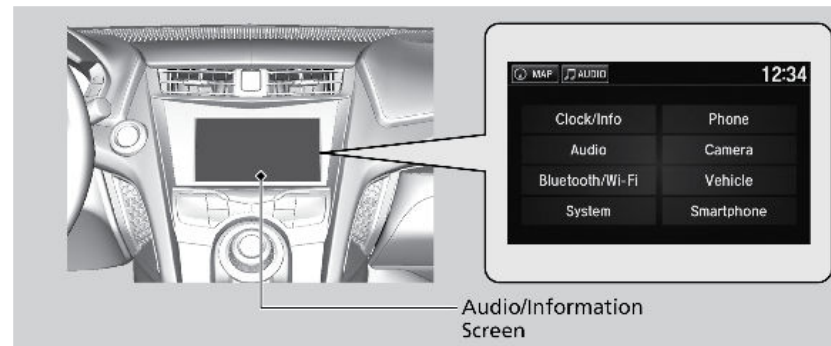

■ How to Change a Setting

Setting the Clock

On vehicles with navigation, the time is automatically set using GPS signals.

On vehicles without navigation and if the Automatic Date & Time feature has been turned off, use the following steps to adjust the time in the clock display.

Using the **Settings** menu on the audio/information screen.

1. Select **Settings**.
2. Select **Clock/Info**.
3. Select **Clock Adjustment**.
4. Select the up arrow or the down arrow to change the hour.
5. Select the up arrow or the down arrow to change the minute.
6. Select **OK**.



AUDIO AND CONNECTIVITY

Learn how to operate the vehicle's audio system.

Basic Audio Operation

Connect audio devices and operate buttons and displays for the audio system.

■ USB Port

Install the iPod® USB connector or the USB flash drive to the USB port.

In the glove box

The USB port (1.0A) is for playing audio files on a USB flash drive and connecting a cellular phone and charging device.

In the console compartment

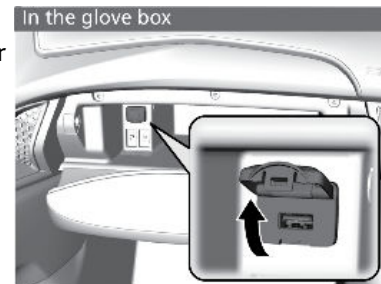

The USB port (1.5A) is for charging devices, playing audio files and connecting compatible phones with Apple CarPlay™ or Android Auto™.

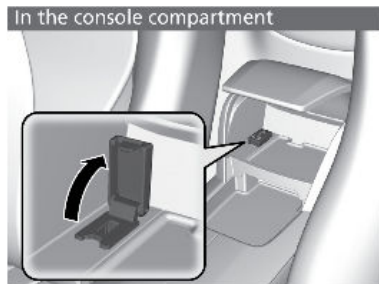

Tip: To prevent any potential issues, be sure to use an Apple MFi Certified Lightning Connector for Apple CarPlay™ or a USB cable certified by USB-IF to be compliant with USB 2.0 Standard for Android Auto™.

■ Accessory Power Socket

The accessory power socket can be used when the power mode is in ACCESSORY or ON.

Open the cover to use it.

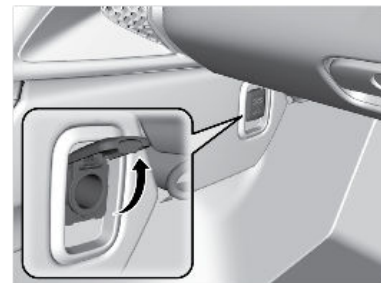

NOTICE

Do not insert an automotive type cigarette lighter element. This can overheat the power socket.

■ Audio Remote Controls

You can operate certain functions of the audio system using the steering wheel controls.

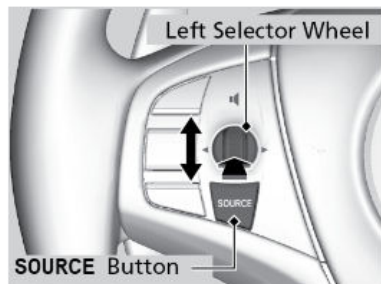

- Left Selector Wheel:** Roll up/down to adjust the volume.
Push to mute. Push again to unmute.
Move left/right to change presets, tracks, albums, or folders.
- SOURCE Button:** Press to cycle through the available audio modes.

■ Adjusting the Sound

1. Select Home.
2. Select Audio.
3. Select Menu.
4. Select Sound.

Select a tab from the following choices:

- BAS-TRE: Bass, Treble
- FAD-BAL: Fader, Balance
- CTR^{*1}-SUBW: Center^{*1}, Subwoofer
- SVC-Neural^{*1}: Speed Volume Compensation, DTS Neural Surround™



AcuraLink®

A subscription-based service that provides convenient features such as voice communication in case of emergency, online security, one-on-one operator assistance, and the transmission of important messages regarding your vehicle's status.

To subscribe to AcuraLink®, or to get more information about all of its features, contact an authorized Acura NSX dealer, or visit owners.acura.com (U.S.) or acura.ca (Canada).

■ AcuraLink® Connection

^{*1} - If equipped

1. Open the cover attached to the ceiling console.
 2. Press the ASSIST button.
- You are connected to the AcuraLink operator.

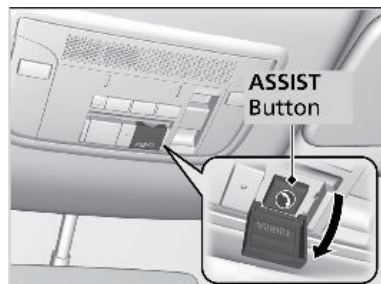

AcuraLink® Assist*¹

If your vehicle's airbags deploy or if the unit detects that the vehicle is severely impacted, your vehicle automatically attempts to connect to an operator. Your phone must be paired to the system and have good cellular connection. Visit owners.acura.com (U.S.) or www.acura.ca/owners/acuralink (Canada) for more information.



Apple CarPlay™

Connect an Apple CarPlay™-compatible iPhone® to the system via the USB port, you can use the audio/information screen, instead of the iPhone® display, to make a phone call, listen to music, view maps (navigation), and access messages.

*1 - If equipped

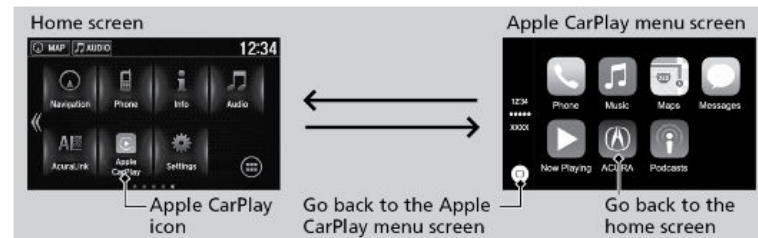

Phone: Access the contact list, make phone calls, or listen to voice mail.

Messages: Check and reply to text messages, or have messages read to you.

Music: Play music stored on your iPhone®.

Maps: Display Apple Maps and use the navigation function just as you would on your iPhone®.

Models with navigation system

Only one navigation system (pre-installed navigation or Apple CarPlay™) can give directions at a time. When you are using one system, directions to any prior destination set on the other system will be canceled, and the system you are currently using will direct you to your destination.

Depending on use, Apple CarPlay™ can share certain vehicle information (e.g., vehicle location, speed, and other operating conditions) with the connected iPhone®. See Apple's privacy policy for details regarding Apple's use and handling of data uploaded by Apple CarPlay™. Use of Apple CarPlay™ is at user's own risk.

Android Auto™

When you connect an Android phone to the audio system via the USB, Android Auto™ is automatically initiated. When connected via Android Auto™, you can use the audio/information screen to access the Phone, Google Maps (Navigation), Google Play Music, and Google Now functions. When you first use Android Auto™, a tutorial will appear on the screen. We recommend that you complete this tutorial while safely parked before using Android Auto™.

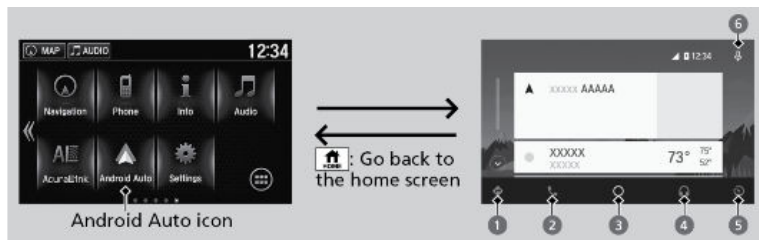

and is subject to agreement to the Apple CarPlay™ terms of use, which are included as part of the Apple iOS terms of use. Apple CarPlay™ vehicle integration is provided "as is," and Acura cannot guarantee Apple CarPlay™ operability or functionality now or in the future due to, among other conditions, changes in Apple CarPlay™ software/Apple iOS, service interruptions, or incompatibility or obsolescence of vehicle-integrated hardware or software. See dealer for details. Only use Apple CarPlay™ when conditions allow you to do so safely. See your Owner's Manual at owners.acura.com (U.S.) or www.acura.ca (Canada) for further license and warranty terms.

1. **Maps (Navigation):** Display Google Maps and use the navigation function just as you would with your Android phone. When the vehicle is in motion, it is not possible to make keyboard entries. Stop the vehicle in a safe location to undertake a search or provide other inputs.

Models with navigation system

Only one navigation system (pre-installed navigation or Android Auto™) can give directions at a time. When you are using one system, directions to any prior destination set on the other system will be canceled, and the system you are currently using will direct you to your destination. The audio/Information screen shows you turn-by-turn driving directions to your destination.

2. **Phone (Communication):** Make and receive phone calls as well as listen to voicemail.
3. **Google Now (Home screen):** Display useful information organized by Android Auto™ into simple cards that appear just when they're needed.
4. **Music and audio:** Play Google Play Music and music apps that are compatible with Android Auto™. To switch between music apps, press this icon.
5. **Go back to the Home Screen**
6. **Voice:** Operate Android Auto™ with your voice.

Wi-Fi Connection

You can connect the audio system to the Internet using Wi-Fi and browse websites or use online services on the audio/information screen. If your phone has wireless hotspot capabilities, the system can be tethered to the phone. Use the following steps to setup.

- 1. Press the Home button.
- 2. Select Settings.
- 3. Select Bluetooth/Wi-Fi.
- 4. Select the Wi-Fi tab.

Depending on use, Android Auto can share certain vehicle information (e.g., vehicle location, speed, and other operating conditions) with Google and its service providers. See Google privacy policy for details regarding Google's use and handling of data uploaded by Android Auto. Use of Android Auto is at user's own risk, and is subject to agreement to the Android Auto terms of use, which are presented to the user when the Android Auto application is downloaded to the user's Android phone. Android Auto vehicle integration is provided "as is," and Acura cannot guarantee Android Auto operability or functionality now or in the future due to, among other conditions, changes in Android Auto software/Android operating system, service interruptions, or incompatibility or obsolescence of vehicle-integrated hardware or software. See dealer for details. Only use Android Auto when conditions allow you to do so safely. See your Owner's Manual at owners.acura.com (U.S.) or acura.ca (Canada) for further license and warranty terms.

- 5. Select Wi-Fi On/Off Status, then On.
- 6. Select Wi-Fi Device List.
Make sure your phone's Wi-Fi setting is in access point (tethering) mode.
Select the phone you want to connect to the system.
If you do not find the phone you want to connect in the list, select Scan.



- 7. Select Connect.
If needed, enter a password for your phone and select OK.
When the connection is successful, the Wi-Fi icon is displayed on the top of the screen.
- 8. Press the Home button to go back to the home screen.

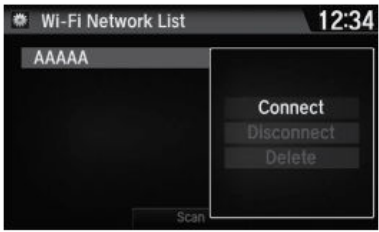

FM Radio

Play FM radio.

SiriusXM® *1

Available on a subscription basis only. For more information or to subscribe, contact your dealer, or visit www.sirius.com/subscribe-now (U.S.) or www.sirius.ca/subscribe-now (Canada).

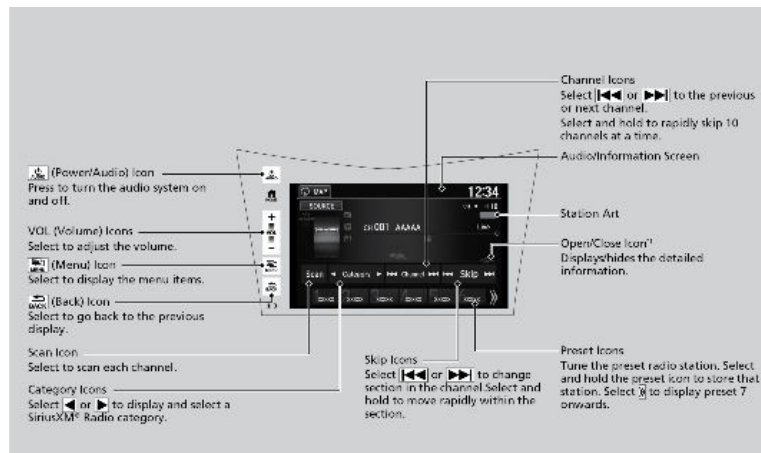

*1: Some or all of the lists may not be displayed.

* Not available on all models

iPod®

Play and operate an iPod®*14 through the vehicle's audio system. Connect your device to the USB port (see USB Port).

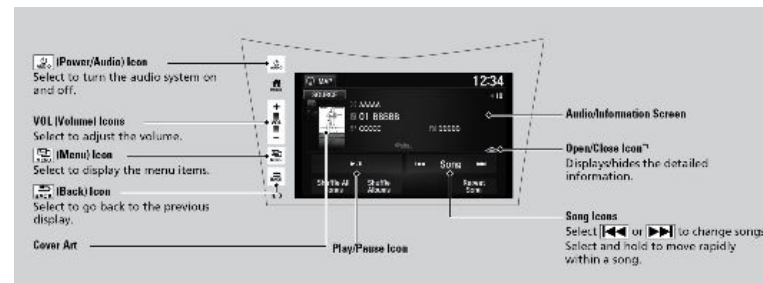

*1: Some or all of the lists may not be displayed.

■ Searching for Music

*14 - iPod and iPhone are trademarks of Apple, Inc.

1. Select Menu and select Music Search.
2. Select the items on that menu.

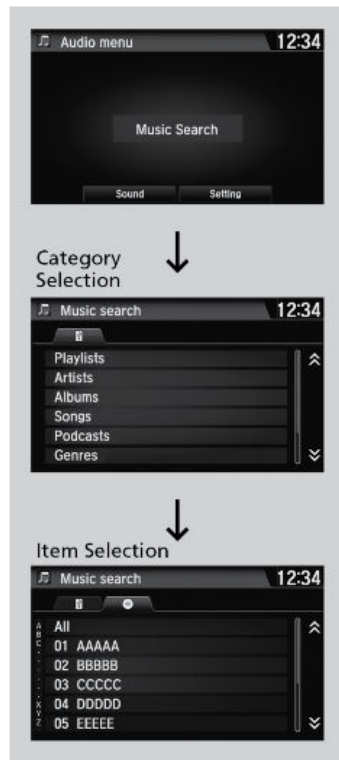

Pandora®*13

Your audio system allows you to listen to music from the Pandora® app on a compatible smartphone. This function is available when the phone is paired and connected to the vehicle's *Bluetooth®* HandsFreeLink® system, or with an iPhone®, you can connect using your USB cable to the USB port.

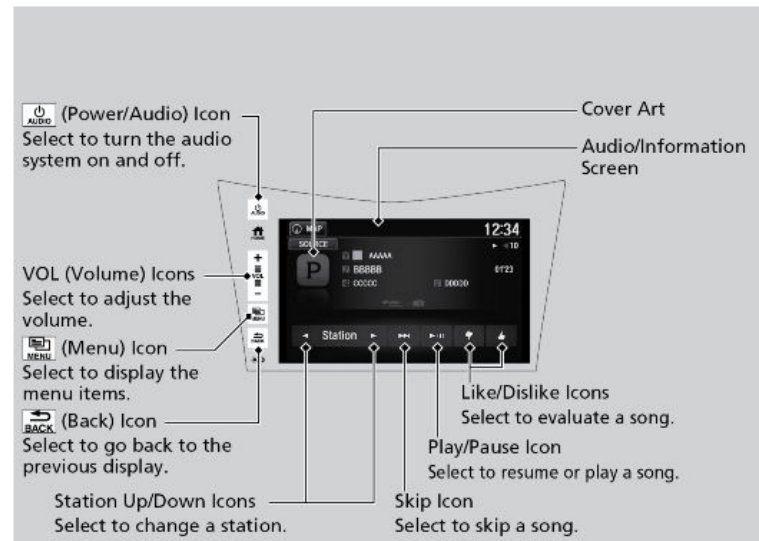

*1: Available only on U.S. models.

*13 - US models only, if equipped

USB Flash Drive

Your audio system reads and plays sound files on a USB flash drive in either MP3, WMA, or AAC*1 format. Connect your USB flash drive to the USB port .

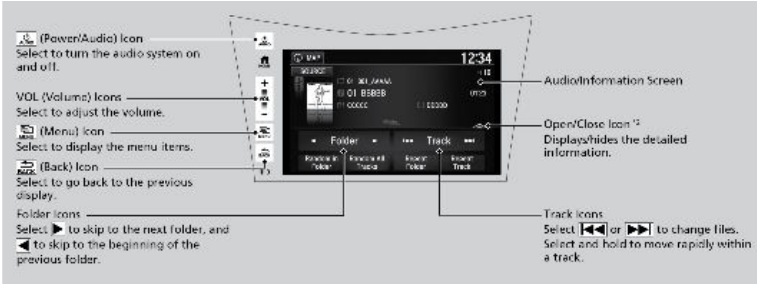

*1:Only AAC format files recorded with iTunes are playable on this unit.
*2:Some or all of the lists may not be displayed.

■ Searching for Music

Applicable laws may prohibit the operation of handheld electronic devices while operating a vehicle. Launch streaming audio on your phone only when it is safe to do so.
*1 - If equipped

1. Select Menu and select Music Search.
2. Select a folder.
3. Select a track.



Bluetooth® Audio

Play streaming or stored audio from your compatible phone when it is paired to *Bluetooth® HandsFreeLink®* (see Pairing a Phone). Visit *handsfreelink.com* (US) to check phone compatibility. Canada customers can phone (855)-490-7351 for any HandsFreeLink® related inquiry. Standard data rates apply with your phone service provider.

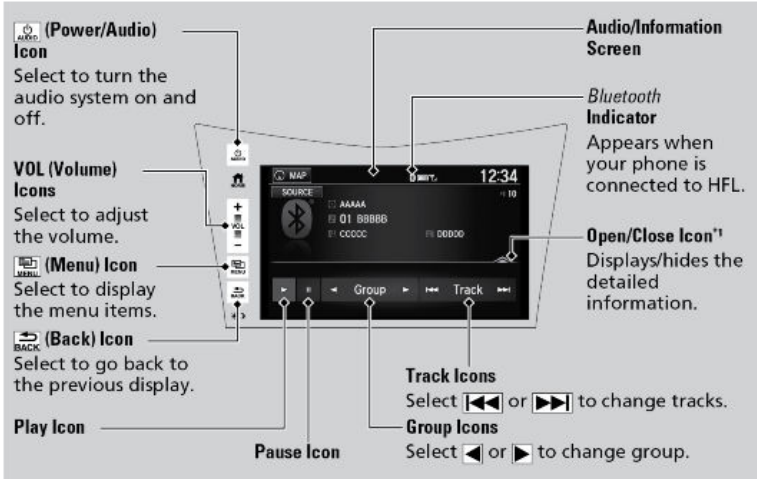

*1: Depending on the *Bluetooth®* device you connect, some or all of the lists may not be displayed.

■ Searching for Music

Applicable laws may prohibit the operation of handheld electronic devices while operating a vehicle. Launch streaming audio on your phone only when safe to do so.

1. Select Menu.
2. Select Music Search.
3. Select a search category (e.g., Albums).
4. Select an item.

The selection begins playing.

Note:

- Make sure the volume on your phone is properly adjusted.
- You may need to enable additional settings on your phone for playback.
- The resume/pause function and remote audio controls are not supported on all phones.

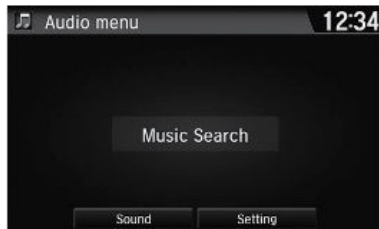

BLUETOOTH® HANDSFREELINK® (HFL)

Learn how to operate the vehicle's hands-free calling system.

Basic HFL Operation

Make and receive phone calls using the vehicle's audio system, without handling your phone. Visit handsfreelink.com (US) to check phone compatibility. Canada customers can phone (855)-490-7351 for any HandsFreeLink® related inquiry.

To reduce the potential for driver distraction, certain manual functions may be inoperable or grayed out while the vehicle is moving. Voice commands are always available.

■ HFL Displays and Controls

Use the controls to enter information and make selections.

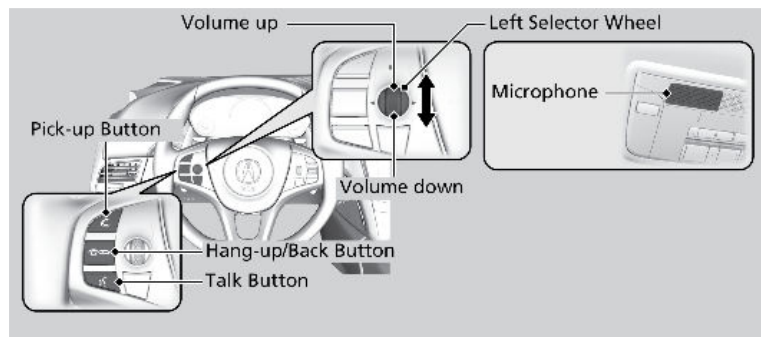

- Pick-up button:** Press to go to the Speed Dial/Call History on the driver information interface, or to answer an incoming call.
- Hang-up/back button:** Press to end a call, go back to the previous command, cancel a command, or clear the phone information on the driver information interface.
- Talk button:** Press to access Voice Portal.
- Left selector wheel:** Move to the right or left to select the Speed Dial or Call History on the driver information interface. Roll up or down to select an item displayed on the Speed Dial/Call History display. Push to call a number listed in the selected item on the Speed Dial/Call History display.

■ Talk Button Tips

When using the Talk button, wait for the beep before saying a command. The system recognizes .

When using the Talk button, wait for the beep before saying a command. The system recognizes only the commands in the Voice Command Index (see page 143).

- To bypass the system prompts, simply press the Talk button again to say your command.
- Speak in a clear, natural voice.
- Reduce all background noise.
- Adjust the dashboard and side vents away from the microphone in the ceiling. Fan speed may be temporarily reduced during voice recognition operation.
- Close the windows and moonroof.

Pairing a Phone

To use hands-free phone and streaming audio functions, you must first pair your phone to the system. This can only be done when the vehicle is stopped. If there is an active connection to Apple CarPlay™ (see Apple CarPlay) or Android Auto™ (see Android Auto), pairing of additional Bluetooth-compatible devices is unavailable and Add Bluetooth Device is grayed out from the Bluetooth Device List screen.

■ Pairing the First Phone

1. Select Phone.
2. Select Yes.
3. Make sure your phone is in search or discoverable mode, then select Continue.

HFL automatically searches for a Bluetooth® device.

4. Select your phone when it appears on the list.

If your phone does not appear, you can select Refresh to search again.

If your phone still does not appear, select Phone Not Found and search for Bluetooth® devices using your phone. From your phone, search for HandsFreeLink®.



5. The system gives you a pairing code on the audio/information screen.

Confirm if the pairing code on the screen and your phone match.

This may vary by phone.



Making a Call

You can make calls by inputting any phone number, or by using the imported phonebook, call history, speed dial entries, or redial.

■ Dialing a Number

1. Go to the Phone menu screen.
2. Select Dial.
3. Select a number.

Use the keyboard on the touch screen for entering numbers.

4. Select Dial.

Dialing starts automatically



Applicable laws may prohibit the operation of handheld electronic devices while operating a vehicle.

■ Using the Phonebook

1. Go to the Phone menu screen.
2. Select Phonebook.
3. Select a name.

You can also search by letter. Select Search.

Use the keyboard on the touch screen for entering a name. If multiple numbers exist, select a number.

4. Select a number.

Dialing starts automatically.



■ Storing Speed Dial Entries

Store up to 20 numbers for quick dialing. To store a speed dial number:

1. Go to the Phone menu screen.

2. Select Speed Dial.

3. Select New Entry.

From Import from Call History:

Select a number from the call history.

From Manual Input:

Input the number manually.

From Import from Phonebook:

Select a number from the connected cell phone's imported phonebook.

4. When the speed dial is successfully stored, you are asked to create a voice tag for the number. Select Yes or No.

5. Select Record, or use the Talk button and follow the prompts to complete the voice tag.

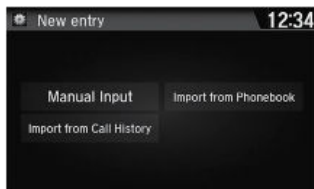

■ Using Speed Dial

Make calls quickly using stored speed dial entries or call history numbers.

1. Go to the Phone menu screen.

2. Select Speed Dial.

3. Select a number.

Dialing starts automatically.

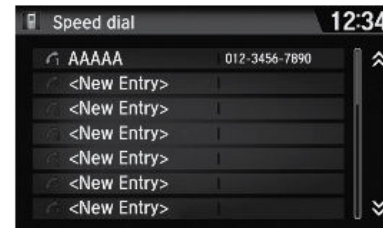

SMS Text Messaging and E-Mail*1

Certain phones can receive and send text messages and e-mails while paired and linked. Standard message rates apply. This feature is limited while the vehicle is moving. Visit handsfreelink.com (US) (U.S.) to check phone compatibility. Canada customers can phone (855)-490-7351 for any HandsFreeLink® related inquiry.

*1 - If equipped

1. A pop-up appears and notifies you of a new text or e-mail message.
2. Select Read to listen to the message.
The text or e-mail message is displayed. The system automatically starts reading out the message.
3. To discontinue the message read-out, select Stop.

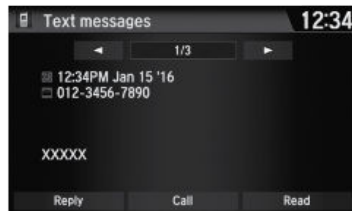
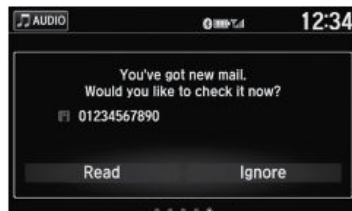

Siri Eyes Free™

You can talk to Siri using the Talk button on the steering wheel when your compatible iPhone® is paired to *Bluetooth®* HandsFreeLink®.

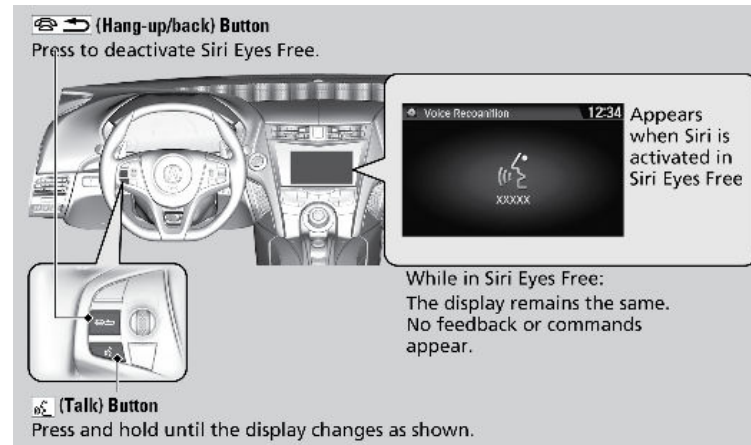

You can talk to Siri using the Talk button on the steering wheel when your iPhone® is paired to the *Bluetooth®* HandsFreeLink®.

NAVIGATION

Learn how to enter a destination and operate the navigation system ^{*1}.

Basic Navigation Operation

A real-time navigation uses GPS and a map database to show your current location and help guide you to a desired destination. You can operate the system using voice commands or the system controls.

To reduce the potential of driver distraction, certain manual functions may be inoperable or grayed out while the vehicle is moving. Voice commands are always available.

Steering Wheel Controls

Use the steering wheel controls to give voice commands.

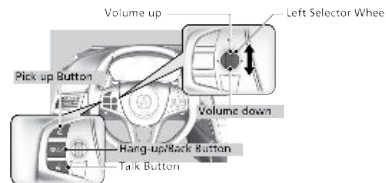

Talk Button Tips

The system recognizes .

- To bypass the system prompts, simply press the Talk button again to say your command.

**1 - If equipped*

- Speak in a clear, natural voice.
- Reduce all background noise.
- Adjust the dashboard vents away from the microphone in the ceiling.
- Close the windows.

System Guidance Volume

1. Press the Home button.
2. Select Settings.
3. Select System.
4. Select the Sound/Beep tab.

Navigation Display and Controls

Touch icons on the screen to enter information and make selections.

Entering Your Destination

There are several methods to enter a destination.

Home Address

Store your home address in the system so you can easily route to it.

1. Select Map.
2. Select the search icon.
3. Select Menu.
4. Select Set Home Location.
5. Select an option.

Select Use Current Location to set home location.

Select Enter My Address or Recently Found, proceed to steps 3 and 4.

6. Select the home location.
7. Select Select.

■ Street Address



1. Select Map.
2. Select the Search icon.
3. Select Address.
4. Enter an address.



Routing

■ Map Legend

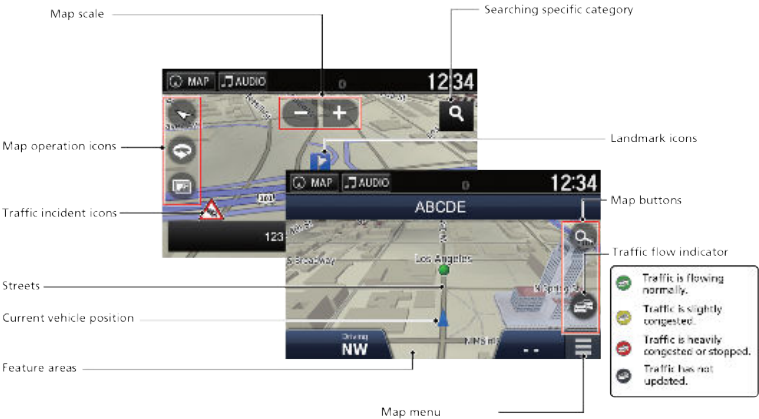

⚠ WARNING

Using the navigation system while driving can take your attention away from the road, causing a crash in which you could be seriously injured or killed.
Operate system controls only when the conditions permit you to safely do so.

■ AcuraLink Real Time Traffic™*13*16

**13 - US models only, if equipped
16 - Requires an AcuraLink® subscription

1. Select the Map icon.
2. Select Back.
3. Select Settings.
4. Select Traffic.
5. Select an option.

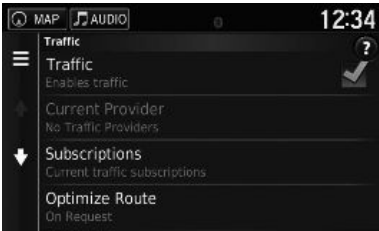

DRIVING

Learn about preparation for driving, as well as other features.

Before Driving

Check the following items before you begin driving.

■ Exterior Checks

- Make sure there are no obstructions on the windows, door mirrors, exterior lights, or other parts of the vehicle.
- Remove any frost, snow, or ice.
- Make sure the hood is securely closed.
- Heat from the engine and exhaust can ignite flammable materials left under the hood, causing a fire. If you've parked your vehicle for an extended period, inspect and remove any debris that may have collected, such as dried grass and leaves that have fallen or have been carried in for use as a nest by a small animal. Also check under the hood for leftover flammable materials after you or someone else has performed maintenance on your vehicle.
- Make sure the tires are in good condition.
- Check the front bumper ducts and side intercooler ducts for mud, leaves, and road debris that could build up and prevent proper cooling performance.

- Make sure there are no people or objects behind or around the vehicle.

NOTICE

If the doors are frozen shut, use warm water around the door edges to melt any ice. Do not try to force them open, as this can damage the rubber trim around the doors. When done, wipe dry to avoid further freezing.

■ Interior Checks

- Store or secure all items on board properly.
- Do not pile items higher than the seat height.
- Do not place anything in the front seat footwells. Make sure to secure the floor mats.
- If you have any animals on board, do not let them move freely in the vehicle.
- Securely close and lock all doors and the hatch.
- Adjust your seating position, mirrors, and steering wheel properly.
- Make sure items placed on the floor behind the front seats cannot roll under the seats.
- Everyone in the vehicle must fasten their seat belt.
- Make sure that the indicators in the instrument panel come on when you start the vehicle, and go off soon after.

In addition:

- During the first 600 miles (1,000 km) of operation, avoid sudden acceleration or full throttle operation so as to not damage the engine or powertrain.
- Avoid hard braking for the first 200 miles (300 km). You should also follow this when the brake pads are replaced.

Maximum Load Limit

Carrying too much cargo or improperly storing it can affect your vehicle’s handling, stability, stopping distance, and tires, and make it unsafe. See the Tire and Loading Information label on the driver’s doorjamb.

■ Maximum Load For Your Vehicle

The maximum load for your vehicle type is:

- 507 lbs (230 kg).

The maximum load for the cargo area is:

- 100 lbs (45 kg).

Label Example



TIRE AND LOADING INFORMATION

SEATING CAPACITY | TOTAL X | FRONT X | REAR X

The combined weight of occupants and cargo should never exceed XXXkg or XXXlbs.

TIRE	SIZE	COLD TIRE PRESSURE	SEE OWNER'S MANUAL FOR ADDITIONAL INFORMATION
FRONT	XXXX/XXXXX XXX	XXXKPA, XXPSI	
REAR		XXXKPA, XXPSI	
SPARE	XXXX/XXXXX XXXX	XXXKPA, XXPSI	

This figure includes the total weight of all occupants, cargo, and accessories, and the tongue load if you are towing a trailer. Below are the steps for determining the correct load limit:

1. Locate the statement “The combined weight of occupants and cargo should never exceed XXX kg or XXX lbs.” on your vehicle’s placard.
2. Determine the combined weight of the driver and passengers that will be riding in your vehicle.
3. Subtract the combined weight of the driver and passengers from XXX kg or XXX lbs.

4. The resulting figure equals the available amount of cargo and luggage load capacity. For example, if the “XXX” amount equals 1,400 lbs. (635 kg) and there will be five 150 lbs. passengers in your vehicle, the amount of available cargo and luggage load capacity is 650 lbs. (1,400 - 750 (5 x 150) = 650 lbs.).
5. Determine the combined weight of luggage and cargo being loaded on the vehicle. That weight may not safely exceed the available cargo and luggage load capacity calculated in step 4.
6. If your vehicle will be towing a trailer, load from your trailer will be transferred to your vehicle. Consult the Owner’s Manual to determine how this reduces the available cargo and luggage load capacity of your vehicle.

WARNING

Overloading or improper loading can affect handling and stability and cause a crash in which you can be hurt or killed.

Follow all load limits and other loading guidelines in this guide.

In addition, the total weight of the vehicle, all occupants, accessories, cargo, and trailer tongue load must not exceed the Gross Vehicle Weight Rating (GVWR) or the Gross Axle Weight Rating (GAWR). Both are on a label on the driver’s doorjamb.

Load Limits Example

Example1



Max Load
507 lbs
(230 kg)



Passenger Weight
150 lbs x 1 + 257 lbs = 407 lbs
(68 kg x 1 + 117 kg = 185 kg)

Maximum Cargo
Weight
100 lbs
(45 kg)

Example2



Max Load
507 lbs
(230 kg)



Passenger Weight
150 lbs x 2 + 107 lbs = 407 lbs
(68 kg x 2 + 49 kg = 185 kg)

Maximum Cargo
Weight
100 lbs
(45 kg)

The headlight aim on your vehicle was set by the factory, and does not need to be adjusted. However, if you regularly carry heavy items in the cargo area or tow a trailer, have the aiming readjusted at your dealer or by a qualified technician.

Towing a Trailer

Your vehicle is not designed to tow a trailer. Attempting to do so can void your vehicle warranties.

Towing Behind A Motorhome

Your vehicle is not designed to be towed behind a motorhome. If your vehicle needs to be towed in an emergency, refer to Emergency Towing.

Starting to Drive

Turn on the vehicle and start the engine to begin driving.

■ Changing the Power Mode

Accessory or On mode: Press the **ENGINE START/STOP** button once without pressing the brake pedal for Accessory mode. Press it again for On mode.

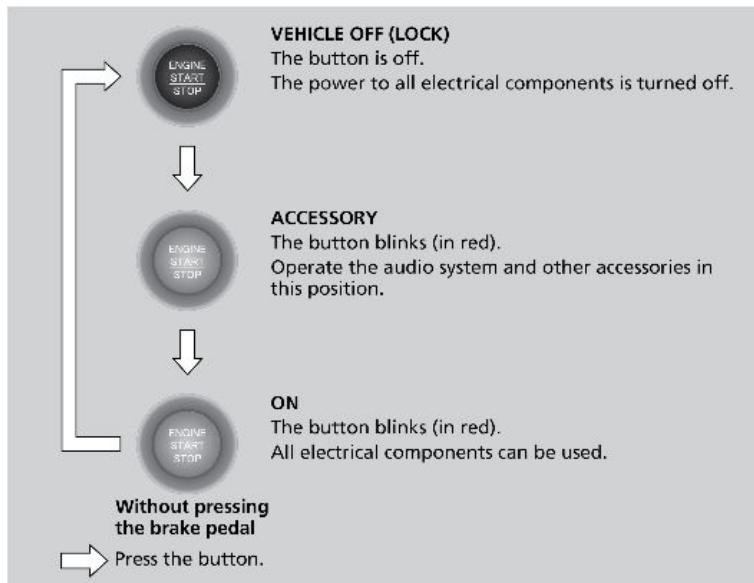

Shifting

Change the gear position based on your driving needs.

■ Paddle Shifters

Use the paddle shifters to change gears without removing your hands from the steering wheel.

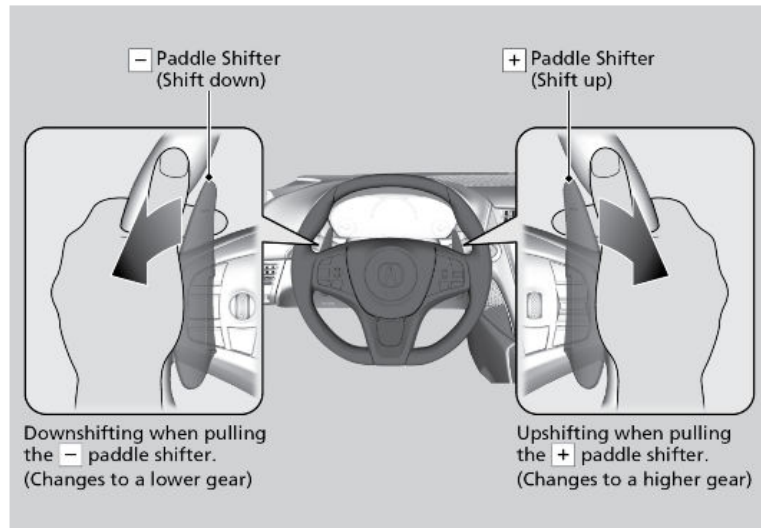

■ Electronic Gear Selector

Select the vehicle's gear using a simple button interface. Apply the brake pedal and select a gear.

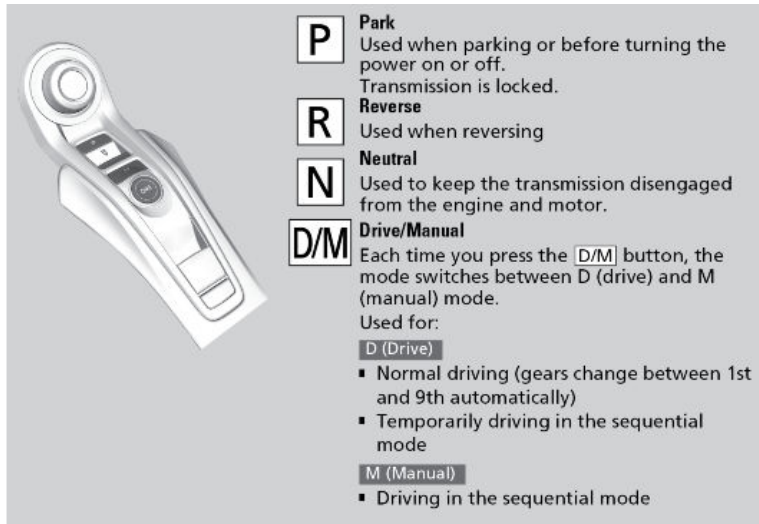

Park (P): Press the (P) button to put the vehicle in Park.

Reverse (R): Pull back the (R) button to put the vehicle in Reverse.

Neutral (N): Press the (N) button to put the vehicle in Neutral. Transmission is not locked.

Drive/Manual: Press the (D) button to put the vehicle in Drive. Release the electric parking brake to begin driving. Each time you press the D/M button, the mode switches between D (drive) and M (manual) mode.

D (Drive)

- Normal driving (gears change between 1st and 9th automatically)
- Temporarily driving in the sequential mode

M (Manual)

- Driving in the sequential mode

In freezing or sub-freezing conditions, the electronic gear selector response may be slow. Always apply the brake pedal before shifting into Park **(P)**, and confirm that **(P)** is shown on the gear position indicator before releasing the brake.

⚠ WARNING

The vehicle can roll away if left unattended without confirming that Park **(P)** is engaged. Always keep your foot on the brake pedal until you have confirmed that **(P)** is shown on the gear position indicator.

NOTICE

When you change from **D** to **R** and vice versa, or want to change to Park **(P)**, come to a complete stop and keep the brake pedal applied. Operating the gear buttons before the vehicle has come to a complete standstill can damage the transmission.

Car wash mode

Follow the procedure below to use a conveyor-style car wash where you or an attendant do not remain in the vehicle. Make sure the wiper lever is in the OFF position. You should inform the car wash attendant of this procedure.

1. When the engine is running, apply the brake pedal, select Neutral **(N)**, then release the brake pedal.
2. Press and hold Neutral **(N)** for two seconds. This puts the vehicle into car wash mode.
3. Within five seconds press the ENGINE START/STOP button.

If the **ENGINE START/STOP** button is pressed while the vehicle is in car wash mode, the power mode will change to **ACCESSORY**. After 15 minutes, the gear position changes to Park and the power mode changes to OFF.

Braking

Slow down or stop your vehicle, and keep it from moving when parked.

■ Foot Brake

Press the brake pedal to slow down or stop your vehicle from moving.

Your vehicle is equipped with disc brakes at all four wheels. A vacuum power assist helps reduce the effort needed on the brake pedal. The brake assist system increases the stopping force when you depress the brake pedal hard in an emergency situation. The anti-lock brake system (ABS) helps you retain steering control when braking very hard.

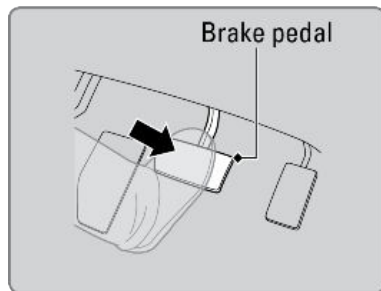

■ Electric Parking Brake

To apply

The electric parking brake can be applied any time the vehicle has battery, no matter which power mode the vehicle is in.

Pull the electric parking brake switch gently and securely. The parking brake indicator comes on.



To release

The power mode must be in the ON position to release the electric parking brake.



1. Depress the brake pedal.
2. Press the electric parking brake switch.
The parking brake indicator goes off.

■ Automatic Brake Hold

Keeps the brake applied after releasing the brake pedal until the accelerator pedal is pressed. You can use this system while the vehicle is temporarily stopped, like at traffic lights and in heavy traffic.

■ Turning on the system



Automatic Brake Hold Button

Fasten your seat belt properly, then start the power system. Press the automatic brake hold button.

- The automatic brake hold system indicator comes on. The system is turned on.

■ Activating the system



Brake Pedal

Depress the brake pedal to come to a complete stop. The transmission must be in **[D/M]** or **[N]**.

- The automatic brake hold indicator comes on. Braking is kept for up to 10 minutes.
- Release the brake pedal after the automatic brake hold indicator comes on.

■ Canceling the system



Accelerator Pedal

Depress the accelerator pedal while the transmission is in **[D/M]** or **[R]**. The system is canceled and the vehicle starts to move.

- The automatic brake hold indicator goes off. The system continues to be on.

■ Brake Assist System

During hard or emergency braking, the system increases braking force. The brake pedal may move slightly or make a noise; this is normal. Continue to hold the brake pedal firmly down.

■ Anti-Lock Brake System (ABS)

During hard or emergency braking, the system rapidly pumps the brakes to prevent wheel lockup and help you maintain steering control. Do not pump the brake pedal, rather continue to hold it firmly down.

The electronic brake distribution (EBD) system, which is part of the ABS, also balances the front-to-rear braking distribution according to vehicle loading.

When ABS activates, you may notice vibrations through the brake pedal or the vehicle body, the brake pedal depressing further than usual, or hear a motor noise from the engine compartment. These are all normal.

NOTICE

The ABS may not function correctly if you use an incorrect tire type and size.

Integrated Dynamics System

Constantly controls your vehicle's engine, transmission, High Voltage battery, EPS, dampers, brakes, VSA® and SH-AWD® according to the mode you select. You can choose between four modes, QUIET mode, SPORT mode, SPORT+ mode and TRACK mode by turning the switch on the center console. Current mode is displayed on the Driver Information Interface, and each mode will appear differently.

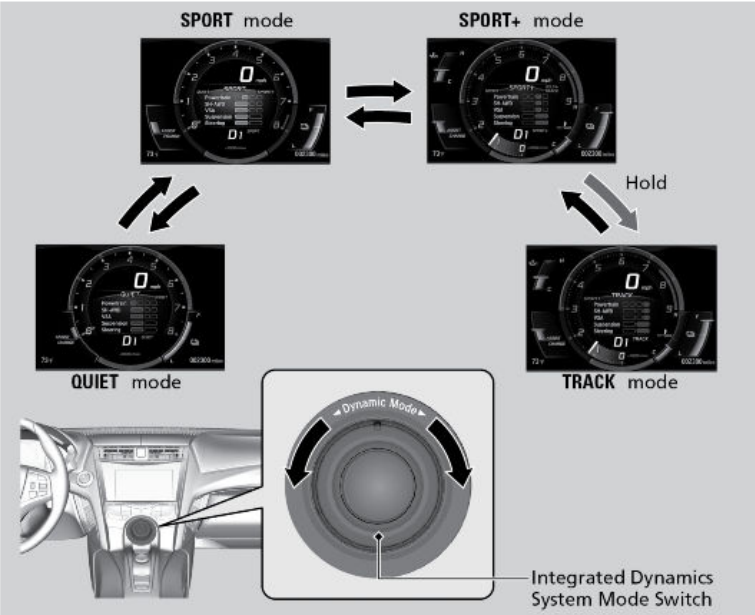

Vehicle Stability Assist® (VSA®) System

Helps to stabilize the vehicle during cornering if the vehicle turns more or less than what was intended. It assists in maintaining traction on slippery surfaces by regulating engine output and selectively applying the brakes. VSA is also known as Electronic Stability Control (ESC).

■ Turning VSA On or Off

This button is on the driver side control panel.

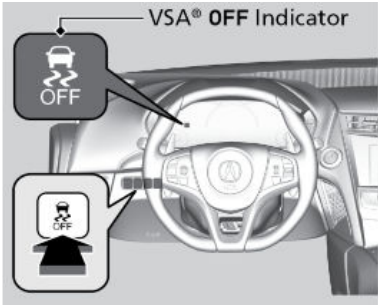

Cruise Control*¹

Maintain a constant vehicle speed without having to keep your foot on the accelerator pedal. Use cruise control on freeways or open roads where you can travel at a constant speed with little acceleration or deceleration.

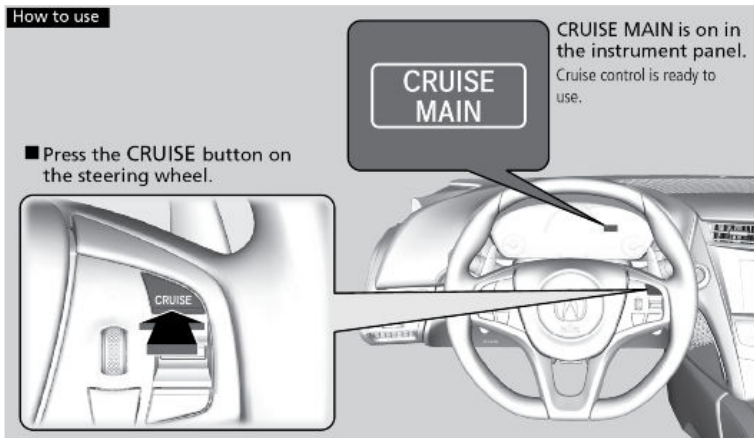

■ Activating and Setting the Vehicle Speed

1. Press the CRUISE button. The CRUISE MAIN indicator appears.
2. Accelerate to the desired speed (above 25 mph/ 40 km/h). Take your foot off the pedal and press the RES/+ /SET/- button to set the speed. The CRUISE CONTROL indicator appears.

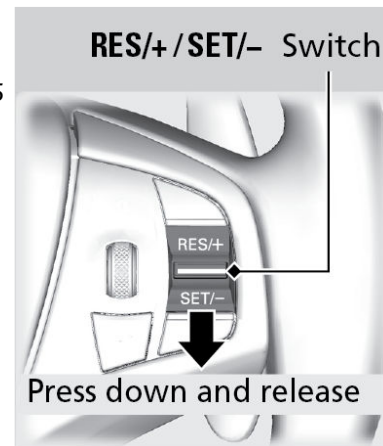

**1 - If equipped*

■ Adjusting the Vehicle Speed

Press the RES/+ button to increase speed or the -/SET button to decrease speed.

Each time you press the button, the vehicle speed is increased or decreased by about 1 mph (1.6 km/h). If you keep the button pressed, the vehicle speed increases or decreases until you release it.

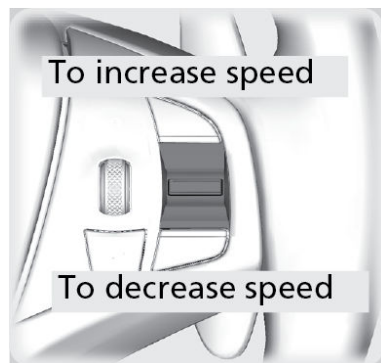

■ Canceling Cruise Control

Press the CANCEL button, the MAIN button or the brake pedal. The CRUISE CONTROL indicator goes off.

After cruise control has been canceled, you can still resume the prior set speed by pressing the RES/+ button while driving at a speed of at least 25 mph (40 km/h).

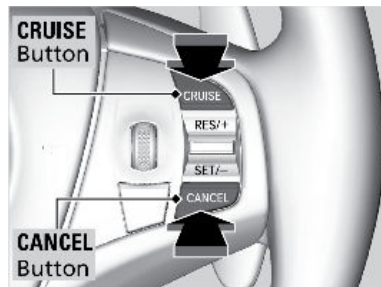

Press CRUISE to turn the system off.

⚠ WARNING

Improper use of cruise control can lead to a crash. Use cruise control only when traveling on open highways in good weather.

Parking Sensor System*¹

The corner and center sensors monitor obstacles near your vehicle. The beeper and audio/information screen let you know the approximate distance between your vehicle and the obstacle.

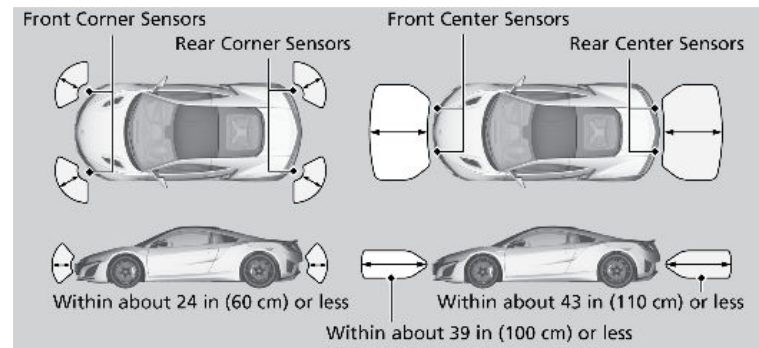

*1 - If equipped

■ Turning the System On or Off

Press the parking sensor button to turn the system on or off. The indicator light appears on the button when the system is on.

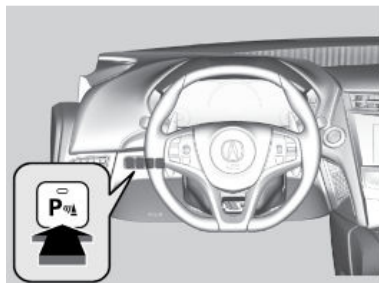

Multi-View Rear Camera

When you shift into Reverse (R), a real-time image of the area behind your vehicle is shown in the upper display, along with helpful parking guidelines.

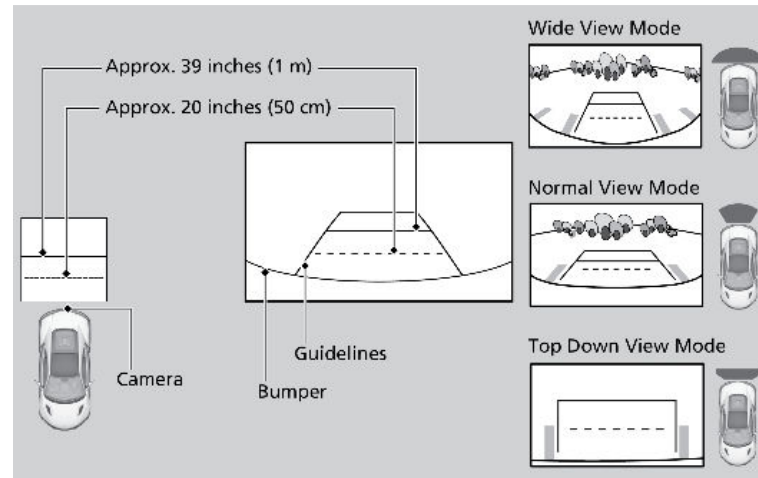

■ Changing Settings

Turn the guidelines on or off.

1. Select Settings.
2. Select Camera.
3. Select Rear Camera.
4. Select Default, Fixed Guideline or Dynamic Guideline.

The rear camera view is restricted. You cannot see the corner ends of the bumper or what is underneath the bumper. Its unique lens also makes objects appear closer or farther than they actually are.

Visually confirm that it is safe to drive before backing up. Certain conditions (such as weather, lightning, and high temperatures) may also restrict the rear view. Do not rely on the rearview display, which does not give you all the information about conditions at the rear of your vehicle.

Improving Fuel Economy and Reducing CO₂ Emissions

Achieving fuel economy and reducing CO₂ emissions is dependent on several factors, including driving conditions, load weight, idling time, driving habits, and vehicle condition. Depending on these and other factors, you may not achieve the rated fuel economy of this vehicle.

Refueling

Use the proper fuel and refueling procedure to ensure the best performance and safety of your vehicle.

■ Fuel Information

Use of unleaded gasoline of 91 octane or higher is recommended.

- Acura recommends TOP TIER Detergent Gasoline where available.
- Do NOT use gasoline containing more than 15% ethanol.
- Do NOT use gasoline containing methanol.

- Do NOT use gasoline containing MMT.

NOTICE

We recommend quality gasoline containing detergent additives that help prevent fuel system and engine deposits. In addition, in order to maintain good performance, fuel economy, and emissions control, we strongly recommend the use of gasoline that does NOT contain harmful manganese-based fuel additives such as MMT, if such gasoline is available.

■ How to Refuel

1. Stop your vehicle with the service station pump on the left side of the vehicle in the rear.
2. Turn off the power system.
3. Press the fuel fill door release button.

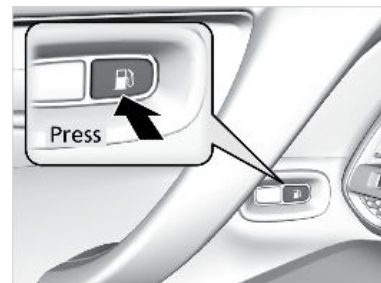

- Place the end of the filler nozzle on the lower part of filler opening, then insert it slowly and fully.

Make sure that the end of the filler nozzle goes down along with the filler pipe.

Keep the filler nozzle level.

When the tank is full, the filler nozzle will click off automatically.

After filling, wait about five seconds before removing the filler nozzle.

- Shut the fuel fill door by hand.

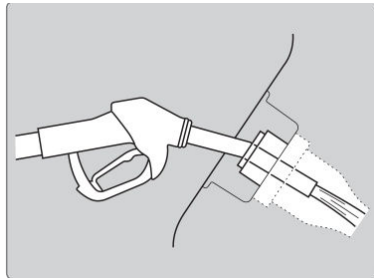

⚠ WARNING

Gasoline is highly flammable and explosive. You can be burned or seriously injured when handling fuel.

- Stop the engine, and keep heat, sparks, and flame away.
- Handle fuel only outdoors.
- Wipe up spills immediately.

Refueling from a Portable Fuel Container

If you need to refuel your vehicle from a portable fuel container, use the funnel provided with your vehicle.

- Turn off the power system.

- Press the fuel fill door release button. The fuel fill door opens.
- Place the end of the funnel on the lower part of filler opening, then insert it slowly and fully. Remove the funnel
- Place the end of the funnel on the lower part of the filler opening, then insert it slowly and fully. Make sure that the end of the funnel goes down along with the filler pipe.

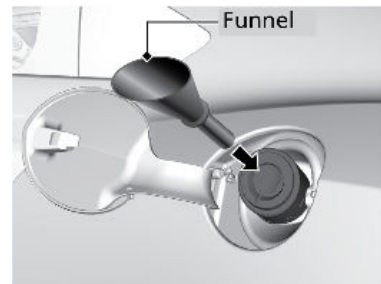

- Fill the tank with fuel from the portable fuel container. Pour fuel carefully so you do not spill any.
- Remove the funnel from the filler neck. Wipe up any fuel from the funnel before storing it.
- Shut the fuel fill door by hand.

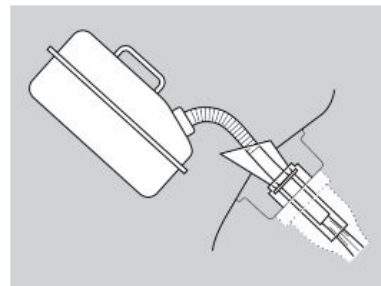

NOTICE

Do not insert the nozzle of a portable fuel container or any funnel other than the one provided with your vehicle. Doing so can damage the fuel system. Do not try to pry open or push open the sealed fuel tank with foreign objects. This can damage the fuel system and its seal.

HANDLING THE UNEXPECTED

Learn about what to do in critical or emergency situations.

Keyless Access System Battery Strength

If the battery life in your remote transmitter is weak, a message appears in the driver information interface with information on how to start the engine.

1. Touch the back of the remote transmitter to the ENGINE START/STOP button while the indicator is flashing.
2. With the brake pedal pressed, press the ENGINE START/STOP button within 10 seconds.

When you carry the remote transmitter (for example, in a pocket or purse) and it is outside the vehicle and within range (about 32 inches or 80 cm), you can lock or unlock the doors and the hatch without handling the transmitter.

Jump Starting

Turn off the power to electric devices, such as audio and lights. Turn off the power mode, then open the hood.

1. Remove the maintenance cover. Open the terminal cover on your vehicle's 12-volt battery positive (+) terminal.
2. Connect the first jumper cable to your vehicle's 12-volt battery (+) terminal.

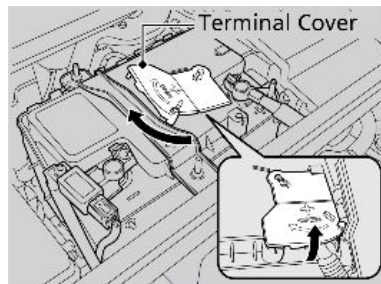

3. Connect the other end of the first jumper cable to the booster battery (+) terminal. Use a 12-volt booster battery only.

When using an automotive battery charger, select a charging voltage lower than 15 volts. Check the charger manual for the proper setting.

4. Connect the second jumper cable to the booster battery (-) terminal.

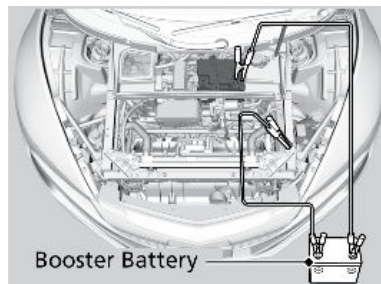

5. Connect the other end of the second jumper cable to the engine hanger as shown. Do not connect this jumper cable to any other part.
6. If your vehicle is connected to another vehicle, start the assisting vehicle's engine and increase its rpm slightly.
7. Attempt to start your vehicle's engine. If it turns over slowly, make sure that the jumper cables have good metal-to-metal contact.

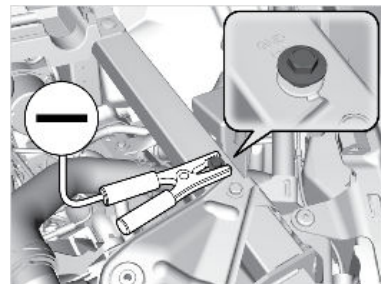

⚠ WARNING

A battery can explode if you do not follow the correct procedure, seriously injuring anyone nearby.

Keep all sparks, open flames, and smoking materials away from the battery.

Overheating

Signs your engine is overheating:

- The temperature gauge needle is at the H mark
- The engine suddenly loses power
- Steam or spray comes out from under the hood

First thing to do:

1. Immediately park the vehicle in a safe place. Turn off all accessories and turn on the hazard warning lights.
2. If no steam or spray is present: Keep the vehicle running and open the hatch (See Under the Hood).
If steam or spray is present: Turn off the power system and wait until it subsides. Then, open the hatch (See Under the Hood).
3. Check that the cooling fan is operating and stop the engine once the temperature gauge needle goes down. If the cooling fan is not operating, immediately stop the engine.
4. Once the engine has cooled down, inspect the coolant level and check the cooling system components for leaks. If the coolant level in the reserve tank is low, add coolant until it reaches the MAX mark. If there is no coolant in the reserve tank, make sure the radiator is cool, then cover the radiator cap with a heavy cloth and open the cap. If necessary, add coolant up to the base of the filler neck, and put the cap back on.

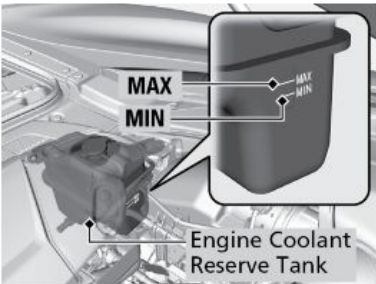

Once the engine has cooled sufficiently, restart it and check the temperature gauge. If the temperature needle has gone down, resume driving. If it has not gone down, contact a dealer for repairs.

⚠ WARNING

Steam and spray from an overheated engine can seriously scald you.
Do not open the hood if steam is coming out.

⚠ WARNING

Removing the radiator cap while the engine is hot can cause the coolant to spray out, seriously scalding you.
Always let the engine and radiator cool down before removing the radiator cap.

NOTICE

Continuing to drive with the temperature gauge needle at the H mark may damage the engine.

Emergency Engine Stop

The ENGINE START/STOP button may be used to stop the engine due to an emergency situation even while driving. If you must stop the engine, choose one of the following operations:

- Press and hold the ENGINE START/STOP button for two seconds, **or**
- Firmly press the ENGINE START/STOP button three times.

The steering wheel will not lock. However, because turning off the power system disables the power assist the power system provides to the steering and braking systems, it will require significantly more physical effort and time to steer and slow the vehicle. Use both feet on the brake pedal to slow down the vehicle and stop immediately in a safe place.

The gear position automatically changes to Park (P) after the vehicle comes to a complete stop. Then, the power mode changes to VEHICLE OFF.

NOTICE

Do not press the button while driving unless it is absolutely necessary for the engine to be switched off.

Emergency Towing

Call a professional towing service if you need to tow your vehicle.

Flat bed equipment: The operator loads your vehicle on the back of a truck. **This is the only way to transport your vehicle.** Any other towing method will damage the vehicle's drive system.

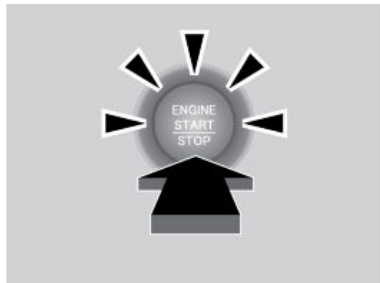

NOTICE

Trying to lift or tow your vehicle by the bumpers will cause serious damage. The bumpers are not designed to support the vehicle's weight.

Improper towing such as towing behind a motorhome or other motor vehicle can damage the transmission.

Tire Pressure Monitoring System (TPMS)

Monitors the tire pressure while you are driving.

If your vehicle's tire pressure becomes significantly low, the Low Tire Pressure/TPMS indicator comes on and a message appears on the driver information interface. The specific tire with low pressure is displayed.

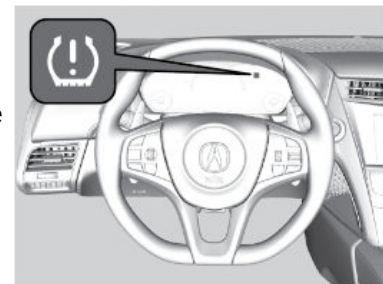

■ What to Do

Stop your vehicle in safe place. Check the tire pressure and adjust the pressure to the specified level. The specified tire pressure is on a label on the driver's doorjamb.

■ Tire Pressure Monitoring System (TPMS) - Required Federal Explanation

U.S. models

Each tire, including the spare (if provided), should be checked monthly when cold and inflated to the inflation pressure recommended by the vehicle manufacturer on the vehicle placard or tire inflation pressure label.

(If your vehicle has tires of a different size than the size indicated on the vehicle placard or tire inflation pressure label, you should determine the proper tire inflation pressure for those tires.)

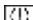
As an added safety feature, your vehicle has been equipped with a tire pressure monitoring system (TPMS) that illuminates a low tire pressure telltale  when one or more of your tires is significantly under-inflated.

Accordingly, when the low tire pressure telltale illuminates, you should stop and check your tires as soon as possible, and inflate them to the proper pressure.

Driving on a significantly under-inflated tire causes the tire to overheat and can lead to tire failure. Under-inflation also reduces fuel efficiency and tire tread life, and may affect the vehicle's handling and stopping ability.

Please note that the TPMS is not a substitute for proper tire maintenance, and it is the driver's responsibility to maintain correct tire pressure, even if under-inflation has not reached the level to trigger illumination of the TPMS low tire pressure telltale.

Your vehicle has also been equipped with a TPMS malfunction indicator to indicate when the system is not operating properly. The TPMS malfunction

indicator is combined with the low tire pressure telltale. When the system detects a malfunction, the telltale will flash for approximately one minute and then remain continuously illuminated. This sequence will continue upon subsequent vehicle start-ups as long as the malfunction exists.

When the malfunction indicator is illuminated, the system may not be able to detect or signal low tire pressure as intended.

TPMS malfunctions may occur for a variety of reasons, including the installation of replacement or alternate tires or wheels on the vehicle that prevent the TPMS from functioning properly.

Always check the TPMS malfunction telltale after replacing one or more tires or wheels on your vehicle to ensure that the replacement or alternate tires and wheels allow the TPMS to continue to function properly.

Fixing a Tire

If a tire goes flat while driving, grasp the steering wheel firmly and brake gradually to reduce speed. Then stop in a safe place.

■ Getting Ready to Temporarily Repair the Flat Tire

If the tire has a large cut or is otherwise severely damaged, you will need to have the vehicle towed. If the tire only has a small puncture, from a nail for instance (do not remove the nail), you can use the temporary tire repair kit so that you can drive to the nearest service station for a more permanent repair.

1. Park the vehicle on a firm, level and non-slippery surface, and apply the parking brake.
2. Change the gear position to Park (P).
3. Turn the hazard warning lights and set the power mode to VEHICLE OFF (LOCK).
4. Open the hatch

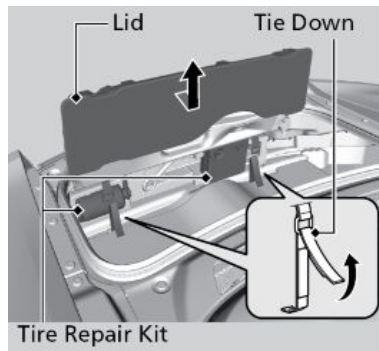

5. Loosen tool box tie downs, then remove tool box lid.
6. Take the kit out of the case.
7. Place the kit face up, on flat ground near the flat tire, and away from traffic.
Do not place the kit on its side.

Injecting Sealant and Air

1. Remove the valve cap from the tire valve stem.

2. Remove the sealant/air hose from the packaging.
3. Attach the sealant/air hose onto the tire valve stem. Screw it until it is tight.
4. Plug in the compressor to the accessory power socket.
5. Start the engine. Keep the engine running while injecting sealant and air.
6. Turn the selector switch to REPAIR (for U.S. models) or SEALANT/AIR or PRODUIT ANTIFUITE/AIR (for Canadian models).
7. Press the inflator switch to turn on the compressor
8. After the air pressure reaches 32 psi (220 kPa), turn off the kit.
9. Unplug the power plug from the accessory power socket.
10. Unscrew the sealant/air hose from the tire valve stem. Reinstall the valve cap.
11. Press the pressure relief button until the gauge returns to (0 kPa).

12. Apply the repair notification label to the flat surface of the wheel.

⚠ WARNING

Tire sealant contains substances that are harmful and can be fatal if swallowed. If accidentally swallowed, do not induce vomiting. Drink plenty of water and get medical attention immediately. For skin or eye contact, flush with cool water and get medical attention if necessary.

⚠ WARNING

Running the engine with the vehicle in an enclosed or even partly enclosed area can cause a rapid build-up of toxic carbon monoxide. Breathing this colorless, odorless gas can cause unconsciousness and even death. Only run the engine to power the air compressor with the vehicle outdoors.

■ Handling of the Jack

Your vehicle has jacking points as shown. When replacing your tires, consult an authorized Acura NSX dealer.

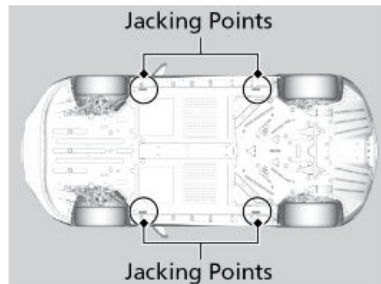
**Fuse Locations**

If any electrical devices are not working, turn the vehicle off and check to see if any applicable fuse is blown. Fuse locations are shown on the fuse box cover. Locate the fuse in question by the fuse number and box cover number. Refer to the Owner's Manual at owners.acura.com for a complete fuse chart.

■ Engine Compartment Fuse Boxes**Fuse Box A**

Located near the radiator. Push the tabs to open the box.

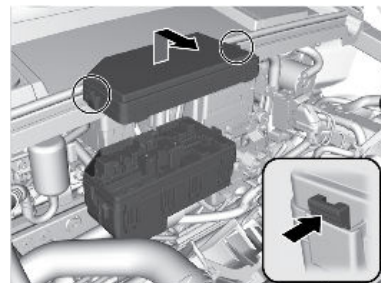

Fuse Box B

Located near the 12-volt battery. Remove the maintenance cover, then push the tabs to open the box.

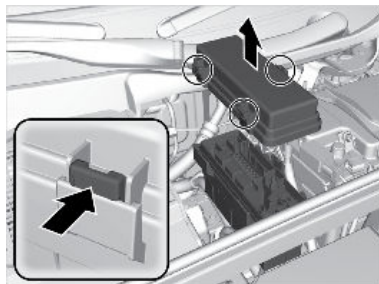
**Interior Fuse Box****Driver's Side Interior Fuse Box**

Located under the driver's side dashboard.

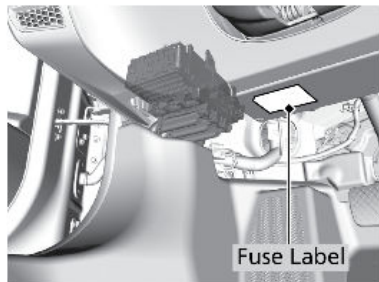
**Passenger's Side Interior Fuse Box**

Located inside the passenger's side under cover. Remove the clips using a Phillips-head screwdriver, then open the under cover.

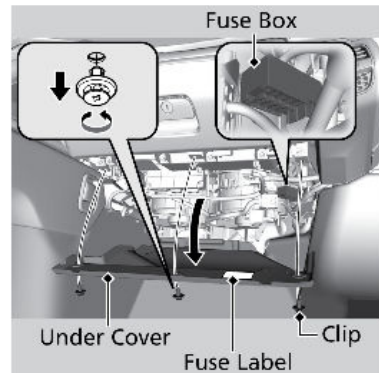
**Rear Side Interior Fuse Box**

Located near the rear center speaker. Fuse locations are shown on the hood fuse box A cover. Have an authorized Acura NSX dealer inspect and replace the fuse.

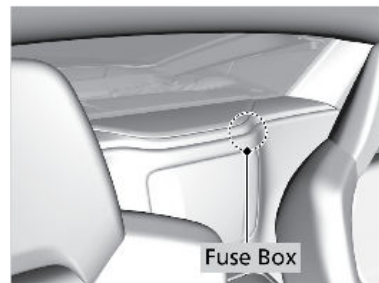

■ Inspecting and Changing Fuses

1. Turn off the vehicle, including all lights and accessories.
2. Remove the fuse box cover.
3. Check the large fuse in the hood.

If the fuse is blown, use a Phillips-head screwdriver to remove the screws and replace the fuse with a new one. Reinstall the screws.

4. Inspect the small fuses in the hood and the vehicle interior.

If there is a burned out fuse, remove it with the fuse puller and replace it with a new one.

NOTICE

Replacing a fuse with one that has a higher rating greatly increases the chances of damaging the electrical system.

MAINTENANCE

Learn about basic maintenance that you can perform on the vehicle yourself, as well as information about how to best maintain the vehicle.

Safety Precautions

Some of the most important safety precautions are listed below however, we cannot warn you of every conceivable hazard that can arise in performing maintenance. Only you can decide whether or not you should perform a given task.

■ Maintenance Safety

- To reduce the possibility of fire or explosion, keep cigarettes, sparks, and flames away from the battery and all fuel-related parts.
- Never leave rags, towels, or other flammable objects under the hood. Heat from the engine and exhaust can ignite them, causing a fire.
- To clean parts, use a commercially available degreaser or parts cleaner, not gasoline.
- Wear eye protection and protective clothing when working with the battery or compressed air.
- Do not run the engine in confined spaces where carbon monoxide gas can accumulate.

■ Vehicle Safety

- The vehicle must be stationary and parked on level ground with the parking brake set and the engine off.
- Be aware that hot parts can burn you.
- Be aware that moving parts can injure you.

⚠ WARNING

Improperly maintaining this vehicle or failing to correct a problem before driving can cause a crash in which you can be seriously hurt or killed.

Always follow the inspection and maintenance recommendations according to the schedules in this guide.

⚠ WARNING

Failure to properly follow maintenance instructions and precautions can cause you to be seriously hurt or killed.

Always follow the procedures and precautions in this guide.

Maintenance Minder™

When maintenance is due, the system message indicator comes on and a message appears on the display every time you turn the vehicle on. The messages notify you when to change the engine oil, or when to bring your vehicle to a dealer for indicated maintenance services. Roll the right selector wheel on the steering wheel to change displays.

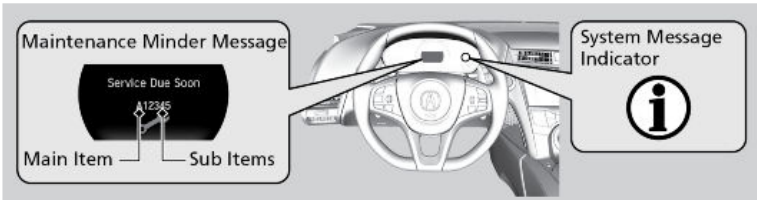

- Independent of the Maintenance Minder information, replace the brake fluid every 3 years.
- Independent of the Maintenance Minder information, adjust the valves during services A, B, 1, 2, or 3 if they are noisy.
- Inspect direct injection + port injection fuel system every 3 years or service item B is indicated.
- Inspect tire condition every 3,100 miles (5,000 km).

Maintenance, replacement, or repair of emissions control devices and systems may be done by any automotive repair establishment or individuals using parts that are certified to EPA standards.

According to state and federal regulations, failure to perform maintenance on the maintenance main items marked with # will not void your emissions warranties. However, all maintenance services should be performed in accordance with the intervals indicated by the driver information interface.

■ Maintenance Minder Service Codes

These codes indicate what services are due on your vehicle.

CODE	Maintenance Main Items
A	<ul style="list-style-type: none">• Replace engine oil *1
B	<ul style="list-style-type: none">• Replace engine oil *1 and oil filter• Inspect front and rear brakes• Check expiration date for temporary tire repair kit bottle• Inspect tie rod ends, steering gearbox, and boots• Inspect suspension components• Inspect driveshaft boots• Inspect brake hoses and lines (Including ABS/VSA®)• Inspect all fluid levels and condition of fluids• Inspect exhaust system #• Inspect fuel lines and connections #• Inspect direct injection + port injection fuel system

*1: If a message **SERVICE** does not appear more than 12 months after the display is reset, change the engine oil every year.
#: See information on maintenance and emissions warranty.

CODE	Maintenance Sub Items
1	<ul style="list-style-type: none">• Inspect tire condition
2	<ul style="list-style-type: none">• Replace air cleaner element *2• Replace dust and pollen filters *3
3	<ul style="list-style-type: none">• Replace transmission fluid *4• Replace clutch fluid *4
4	<ul style="list-style-type: none">• Replace spark plugs• Inspect valve clearance• Inspect Active Exhaust Valve function• Replace Intake Sound Control
5	<ul style="list-style-type: none">• Replace engine coolant
6	<ul style="list-style-type: none">• Replace Twin Motor Unit fluid *5

*2: If you drive in dusty conditions, replace the air cleaner element every 15,000 miles (24,000 km).
*3: If you drive primarily in urban areas that have high concentrations of soot in the air from industry and from diesel-powered vehicles, replace the dust and pollen filters every 15,000 miles (24,000 km) or every year.
*4: Driving in mountainous areas at very low vehicle speeds results in higher transmission temperature. This requires transmission fluid and clutch fluid changes more frequently than recommended by the Maintenance Minder. If you regularly drive your vehicle under this condition, have the transmission fluid and clutch fluid changed every 20,000 miles (32,000 km).
*5: Driving in mountainous areas at very low vehicle speeds results in higher level of mechanical (Shear) stress to fluid. This requires Twin Motor Unit fluid changes more frequently than recommended by the Maintenance Minder. If you regularly drive your vehicle under these conditions, have the Twin Motor Unit fluid changed at 7,500 miles (12,000 km), then every 15,000 miles (24,000 km).

Under the Hood and Hatch

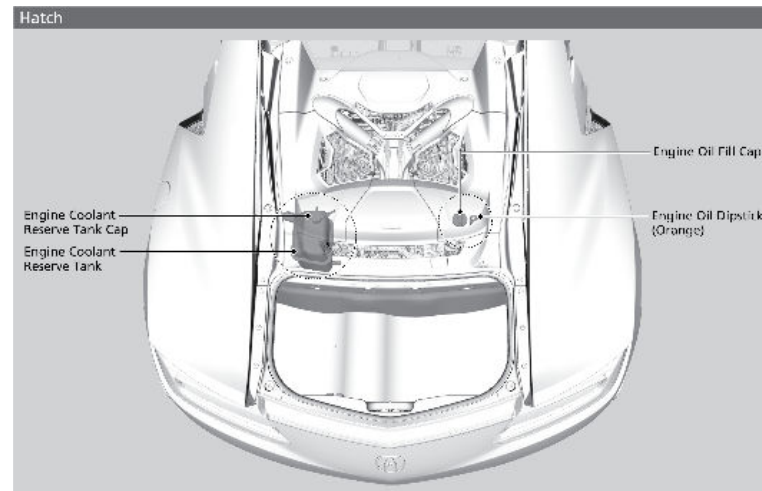
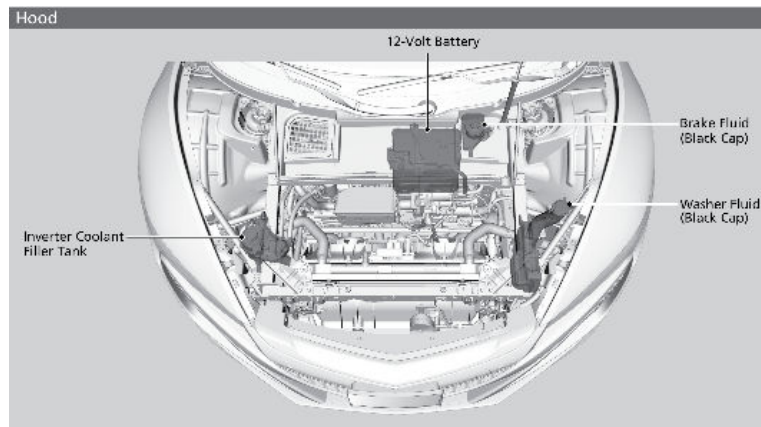

■ Opening the Hood

1. Park the vehicle on a level surface and set the parking brake.
2. Pull the hood release handle under the lower left corner of the dashboard.

3. Pull the hood latch lever in the center of the hood to release the lock mechanism, and open the hood.

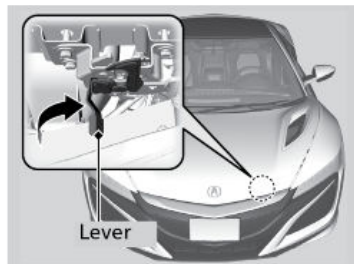
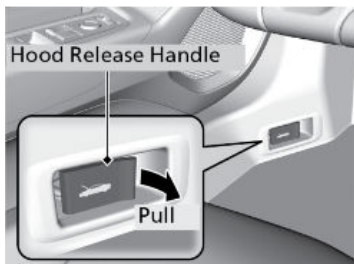

4. Lift the hood up most of the way. The hydraulic supports lift it up the rest of the way and hold it up.

Lower the hood, to approximately 12 inches (30 cm) and press firmly down with your hands. Make sure both right and left latches are firmly locked in place.



NOTICE

Do not open the hood when the wiper arms are raised. The hood will strike the wipers, and may damage either the hood or the wipers.

■ Engine Compartment Cover

The component parts in the engine compartment are protected by a cover. You may need to remove the cover when you perform certain maintenance work.

Starting at either side, lift the outermost edge of the engine compartment cover. Pull up on the cover, and remove it from the pins. Move towards the opposite side while applying uniform upward pressure.

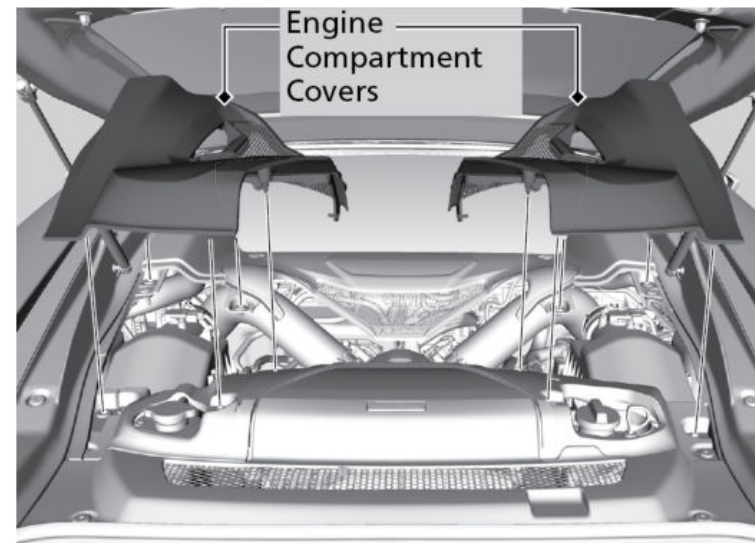

Engine Oil

Park the vehicle on level ground. Wait approximately three minutes after turning the engine off before you check the oil.

■ Checking the Oil

We recommend that you check the engine oil level every time you refuel.

1. Bring up the **Oil Level Check Assist** display on the Driver Information Interface.



2. Warm up the engine until all the bars in the **Warm Up** gauge light up.

3. When the bars turn green, park the vehicle on level ground and select Park (P).



4. Allow the engine to continue idling until all the bars in the **Idle Time** gauge in the engine **Oil Level Check Assist** display light up. Do not depress the accelerator pedal while the engine is idling, as this will reset the **Idle Time**.



5. When all the bars in the Idle Time gauge light up, **Ready To Check Oil Level** message appears.
6. Change the display in the Driver Information Interface to any display other than the **Oil Level Check Assist** display.
7. Change the power mode to VEHICLE OFF.



8. Open the hatch. (See Opening the Hood) Remove the right engine compartment cover. Remove the dipstick (orange).
9. Wipe the dipstick with a clean cloth or paper towel.
10. Insert the dipstick all the way back into its hole.
11. Remove the dipstick again, and check the level. It should be between the upper and lower marks.
Add oil if necessary.
12. After checking the engine oil level, make sure to select a display other than the **Oil Level Check Assist** display.

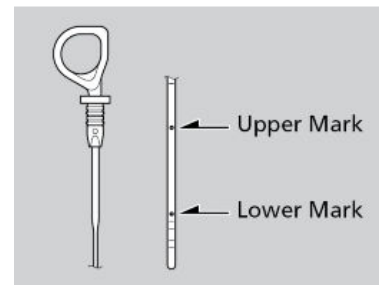
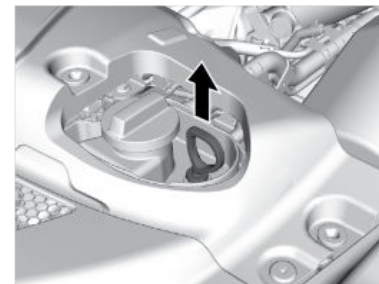

- Recommended Engine Oil
 - Genuine Acura Motor Oil

- Acura NSX specifications require full synthetic, 0W-40 motor oil such as Ultimate Full Synthetic Motor Oil, Type 3, 0W-40, available at your authorized Acura NSX dealer. Contact your authorized Acura NSX dealer for more details.

This seal indicates the oil is energy conserving and that it meets the American Petroleum Institute's latest requirements. Use **Genuine Acura Motor Oil** or another commercial engine oil of suitable viscosity for the ambient temperature.

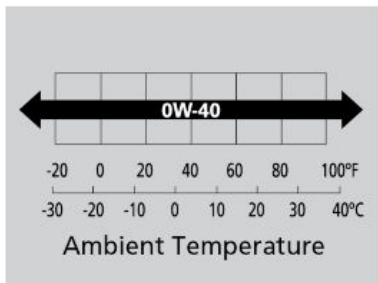

■ Adding Oil

1. Unscrew and remove the engine oil fill cap.
2. Add oil slowly.
3. Reinstall the engine oil fill cap and tighten it securely.

4. Wait for three minutes and recheck the engine oil dipstick.

NOTICE

Do not fill the engine oil above the upper mark. Overfilling the engine oil can result in leaks and engine damage.

■ Resetting the Engine Oil Life

If you change or replace the vehicle's engine oil yourself, you must reset the engine oil life.

Models with Driver Information Interface

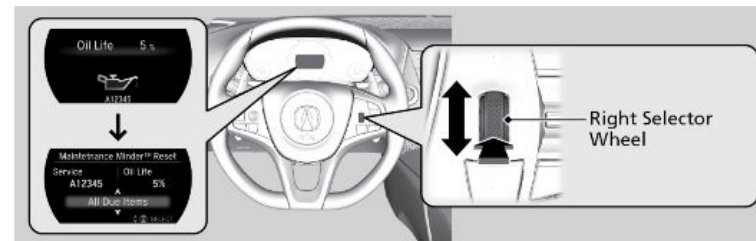

Using the Audio/Information Screen

1. Set the power mode to ON.
2. Select **Home** on the audio/information screen.
3. Select **Settings**.

4. Select **Vehicle**, then **Maintenance Info**.
5. Select **Reset**.

To cancel the oil life reset mode, select **Cancel**.

NOTICE

Failure to reset the engine oil life after a maintenance service results in the system showing incorrect maintenance intervals, which can lead to serious mechanical problems.

Engine Coolant

Park the vehicle on level ground. Check the reserve tank and the coolant level in the radiator. **Use Acura Long Life Antifreeze/Coolant Type 2**

■ Checking the Reserve Tank

1. Open the hatch. (See Opening the Hood)
Remove the left engine compartment cover. Check the amount of coolant in the reserve tank.
2. If the coolant level is below the MIN mark, add the specified coolant until it reaches the MAX mark.

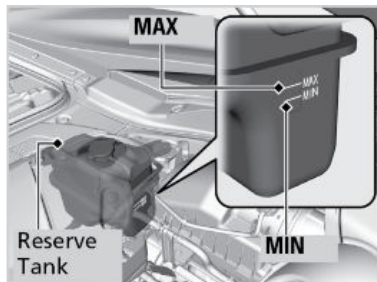

3. Inspect the cooling system for leaks.

NOTICE

For vehicles used in temperatures below -31°F (-35°C), change the coolant from the standard 50:50 antifreeze:water mix to one with added antifreeze. Consult a dealer for more information.

■ Adding Coolant

1. Make sure the engine and radiator are cool.
2. Turn the radiator cap 1/8 turn counterclockwise and relieve any pressure in the coolant system.
3. Push down and turn the radiator cap counterclockwise to remove it.
4. The coolant level should be up to the base of the filler neck. Add coolant if it is low.
5. Put the radiator cap back on, and tighten it fully.

⚠ WARNING

Removing the radiator cap while the engine is hot can cause the coolant to spray out, seriously scalding you.

Always let the engine and radiator cool down before removing the radiator cap.

NOTICE

Pour the fluid slowly and carefully so you do not spill any. Clean up any spills immediately; they can damage components in the engine compartment.

Checking the Battery

The battery condition is monitored by the sensor on the negative terminal. If there is a problem with the sensor, a warning message appears on the Driver Information Interface Have your vehicle checked by a dealer.

⚠ WARNING

The battery gives off explosive hydrogen gas during normal operation. A spark or flame can cause the battery to explode with enough force to kill or seriously hurt you.

When conducting any battery maintenance, wear protective clothing and a face shield, or have a skilled technician do it.

WARNING: Battery posts, terminals, and related accessories contain lead and lead compounds. **Wash your hands after handling.**

Charging the AGM Battery

AGM labeled batteries, like those installed in your vehicle, require a compatible charger to be properly charged. Damage to the battery can result if the battery is charged improperly or with the wrong equipment. For more information on how to charge your vehicle's AGM battery, consult a dealer.

Window Washer Fluid

Check the amount of window washer fluid by looking at the reservoir. Fill the reservoir if it is low. Pour the washer fluid carefully. Do not overflow the reservoir.

If the washer fluid is low, a message appears on the Driver Information Interface.

Brake Fluid

The fluid level should be between the MIN and MAX marks on the side of the tank. We recommend using **Acura Heavy Duty Brake Fluid DOT 4**.

Pour the fluid carefully.

If the fluid level is at or below the MIN mark, have a dealer inspect for leaks or worn brake pads as soon as possible.

NOTICE

Brake fluid marked DOT 5 is not compatible with your vehicle's braking system and can cause extensive damage.

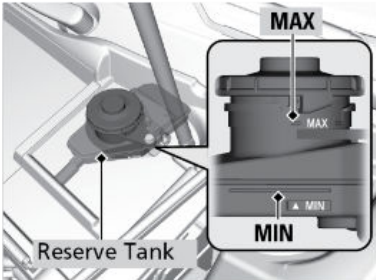

Changing Wiper Blades

If the wiper blades leave streaks across the windshield, try cleaning them first with a paper towel or soft cloth and wiper fluid. If the wiper blade rubber has deteriorated, you should change the wiper blades.

- 1. Set the power mode to VEHICLE OFF(LOCK).

2. While holding the wiper switch in the MIST position, set the power mode to ON, then to VEHICLE OFF. Both wiper arms are now set to the service position.

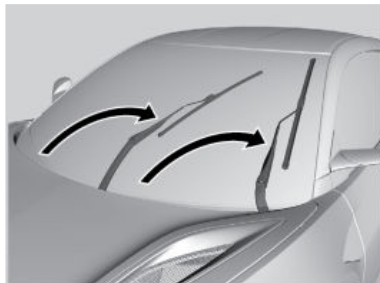

3. Lift the driver side wiper arm first, then the passenger side.

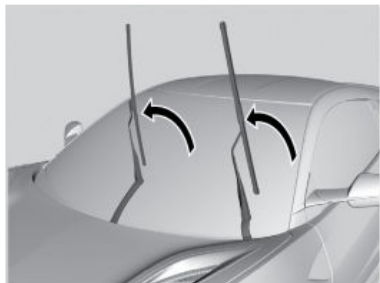

4. Press and hold the tab, then slide the holder off the wiper arm.

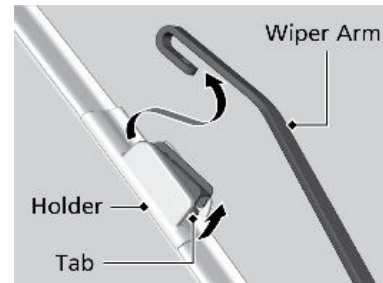

5. Pull the end of the wiper blade in the direction of the arrow in the image until it unfastens from the holder's end cap. Pull the wiper blade to the opposite direction to slide it out from its holder.

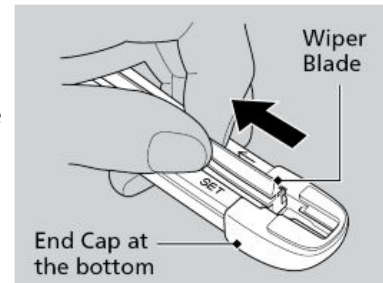

6. Insert the flat side of the new wiper blade onto the bottom part of the holder. Insert the blade all the way.
7. Install the end of the wiper blade into the end cap.
8. Slide the wiper holder onto the wiper arm securely.
9. Lower the passenger side wiper arm first, then the driver side.
10. Set the power mode to ON and hold the wiper switch in the MIST positions until both wiper arms return to the standard position.

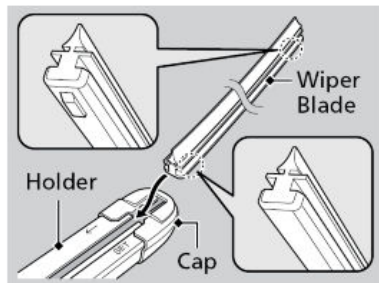

NOTICE

Avoid dropping the wiper arm, as it may damage the windshield.

Tire Information

To safely operate your vehicle, your tires must be of the proper type and size, in good condition with adequate tread, and properly inflated.

■ Inflation Guidelines

- Properly inflated tires provide the best combination of handling, tread life, and comfort. Refer to the driver's doorjamb label or the specifications see SPECIFICATIONS for the specified pressure.

- Underinflated tires wear unevenly, adversely affect handling and fuel economy, and are more likely to fail from overheating.
- Overinflated tires make your vehicle ride harshly, are more prone to road hazards, and wear unevenly.
- Every day before you drive, look at each of the tires. If one looks lower than the others, check the pressure with a tire gauge.
- Measure the air pressure when tires are cold. This means the vehicle has been parked for at least 3 hours, or driven less than 1 mile (1.6 km). If necessary, add or release air until the specified pressure is reached. If checked when hot, tire pressure can be as much as 4-6 psi (30-40 kPa, 0.3-0.4 kgf/cm²) higher than checked when cold.
- At least once a month or before long trips, use a gauge to measure the pressure in all tires, including the spare^{*1}. Even tires in good condition can lose 1-2 psi (10-20 kPa, 0.1-0.2 kgf/cm²) per month.

■ Inspection Guidelines

Every time you inflate the tires, check for the following:

- Any damage to tires, including bumps, bulges, cuts, splits, or cracks in the side or tread. Remove any foreign objects and inspect for air leaks. Replace tires if you see fabric or cord.
- Uneven or excessive tread wear. Have a dealer check the wheel alignment.
- Cracks or other damage around the valve stems.

^{*1} - If equipped

■ Wear Indicators

The groove where the wear indicator is located is 1/16 inch (1.6 mm) shallower than elsewhere on the tire. If the tread has worn so low that the indicator is exposed, replace the tire. Worn out tires have poor traction on wet roads.

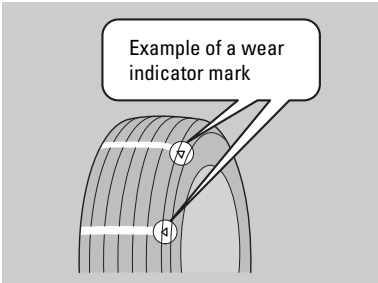

⚠ WARNING

Using tires that are excessively worn or improperly inflated can cause a crash in which you can be seriously hurt or killed. Follow all instructions in the owner's manual regarding tire inflation and maintenance.

■ Tire and Loading Information Label

The label attached to the driver's doorjamb provides necessary tire and loading information.

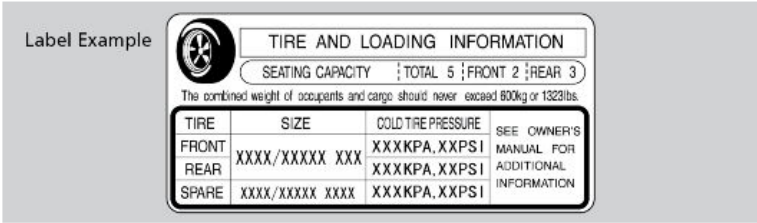

1. The number of people your vehicle can carry.
2. The total weight your vehicle can carry. Do not exceed this weight.
3. The original tire sizes for front, rear, and spare.
4. The proper cold tire pressure for front, rear, and spare.

■ Tire and Wheel Replacement

Replace your tires with radials of the same size, load range, speed rating, and maximum cold tires pressure rating (as shown on the tires' sidewall). Using tires of a different size or construction can cause certain vehicle systems to work incorrectly. It is best to replace all four tires at the same time. If that isn't possible, replace the front or rear tires in pairs.

If you change or replace a wheel, make sure that the wheel’s specifications match those of the original wheels. Only use TPMS-specified wheels approved for your vehicle.

⚠ WARNING

Installing improper tires on your vehicle can affect handling and stability. This can cause a crash in which you can be seriously hurt or killed. Always use the size and type of tires recommended in the Owner’s Manual.

■ **Tire Service Life**

The life of your tires is dependent on many factors, including driving habits, road conditions, vehicle loading, inflation pressure, maintenance history, speed, and environmental conditions (even when the tires are not in use). In addition to regular inspections and inflation pressure maintenance, it is recommended that you have annual inspections performed once the tires reach five years old. All tires, including the spare, should be removed from service after 10 years from the date of manufacture, regardless of their condition or state of wear.

■ **Winter Tires**

If driving on snowy or frozen roads, mount all season tires marked “M+S”, snow tires, or tire chains; reduce speed and maintain sufficient distance between vehicles when driving. For winter tires, select the size and load ranges that are the same as the original tires, and mount them to all four wheels.

■ **Tire Chains**

Install tire chains on the rear tires only. Because your vehicle has limited tire clearance, we strongly recommend using the following chains:
Models with 295/30R19 winter tires:
Cable type: Auto-Trac 232405
Models with 305/30R20 winter tires:
Cable type: K-Summit K-44
Mount chains as tightly as you can and make sure that they do not touch the brake lines or suspension.

NOTICE

Traction devices that are the wrong size or improperly installed can damage your vehicle’s brake lines, suspension, body, and wheels. Stop driving if they are hitting any part of the vehicle.

⚠ WARNING

Using the wrong chains, or not properly installing chains, can damage the brake lines and cause a crash in which you can be seriously injured or killed. Follow all instructions in this guide regarding the selection and use of tire chains.

Tire Labeling

The tires that came on your vehicle have a number of markings. Those you should be aware of are described below.

Here is an example of what each marking means:

P245/40R19 98W

- P: tire type (passenger vehicle)
- 245: tire width in millimeters
- 40: aspect ratio (tire section height as a percentage of its width)
- R: tire construction code (radial)
- 19: rim diameter in inches
- 98: load index (code indicating maximum load tire can carry)
- W: speed symbol (code indicating maximum speed rating)

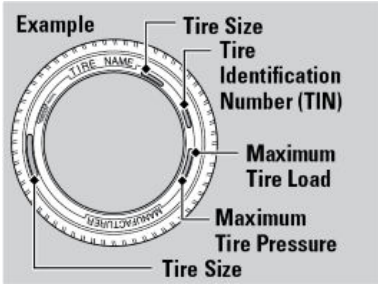

Tire Identification Number (TIN)

The tire identification number (TIN) is a group of numbers and letters that look like the following example. The TIN is located on the sidewall of the tire.

DOT B97R FW6X 2209

DOT: This indicates that the tire meets all requirements of the U.S. Department of Transportation.
B97R: Manufacturer's identification mark.
FW6X: Tire type code.
22 09: Date of manufacture.
22: Year
09: Week

Glossary of Tire Terminology

- Cold Tire Pressure** – The tire air pressure when the vehicle has been parked for at least three hours or driven less than 1 mile (1.6 km).
- Load Rating** – The maximum load that a tire is rated to carry for a given inflation pressure.
- Maximum Inflation Pressure** – The maximum tire air pressure that the tire can hold.
- Maximum Load Rating** – The load rating for a tire at the maximum permissible inflation pressure for that tire.
- Recommended Inflation Pressure** – The cold tire inflation pressure recommended by the manufacturer.
- Treadwear Indicators (TWI)** – The projections within the principal grooves designed to give a visual indication of the degrees of wear of the tread.

DOT Tire Quality Grading

The tires on your vehicle meet all U.S. Federal Safety Requirements. All tires are also graded for treadwear, traction, and temperature performance according to Department of Transportation (DOT) standards. These gradings are explained below.

■ Uniform Tire Quality Grading

Quality grades can be found where applicable on the tire sidewall between tread shoulder and maximum section width.

For example:

Treadwear 200

Traction AA

Temperature A

All passenger car tires must conform to Federal Safety Requirements in addition to these grades.

■ Treadwear

The treadwear grade is a comparative rating based on the wear rate of the tire when tested under controlled conditions on a specified government test course. For example, a tire graded 150 would wear one and one-half (1 1/2) times as well on the government course as a tire graded 100. The relative performance of tires depends upon the actual conditions of their use, however, and may depart

significantly from the norm due to variations in driving habits, service practices, and differences in road characteristics and climate.

■ Traction

The traction grades, from highest to lowest, are AA, A, B, and C. Those grades represent the tire’s ability to stop on wet pavement as measured under controlled conditions on specified government test surfaces of asphalt and concrete. A tire marked C may have poor traction performance.

WARNING: The traction grade assigned to this tire is based on straight-ahead braking traction tests, and does not include acceleration, cornering, hydroplaning, or peak traction characteristics.

■ Temperature

The temperature grades are A (the highest), B, and C, representing the tire’s resistance to the generation of heat and its ability to dissipate heat when tested under controlled conditions on a specified indoor laboratory test wheel. Sustained high temperature can cause the material of the tire to degenerate and reduce tire life, and excessive temperature can lead to sudden tire failure. The grade C corresponds to a level of performance which all passenger car tire must meet under the Federal Motor Vehicle Safety Standard No. 109. Grades B and A represent higher levels of performance on the laboratory test wheel than the minimum required by law.

WARNING: The temperature grade for this tire is established for a tire that is properly inflated and not overloaded. Excessive speed, underinflation, or

excessive loading, either separately or in combination, can cause heat buildup and possible tire failure.

Testing of Readiness Codes

Your vehicle has readiness codes as part of the onboard self-diagnostic system. Some states use these codes for testing to verify whether your vehicle's emissions components are working properly. The codes may not be read if you go through the testing just after the battery has gone dead or been disconnected.

To check if they are set, set the power mode to ON without starting the engine. The malfunction indicator lamp will come on for several seconds. If it goes off, the readiness codes are set. If it blinks five times, the readiness codes are not set.

If you are required to have your vehicle tested before the readiness codes are set, prepare the vehicle for retesting by doing the following:

1. Fill the gas tank to approximately 3/4 full.
2. Park the vehicle and leave the power system off for 6 hours or more.
3. Make sure the ambient temperature is between 40°F and 95°F (4°C and 35°C).
4. Start the engine without touching the accelerator pedal, and let it idle for 20 seconds.
5. Keep the vehicle in PARK (P). Increase the engine speed to 2,000 rpm, and hold it there for about 3 minutes.
6. Let the engine idle with your foot off the accelerator for 20 seconds.

7. Select a nearby, lightly traveled major highway where you can maintain a speed of 50 mph (80 km/h) for at least 20 minutes. Drive on the highway in DRIVE (D) with SPORT mode. Do not use cruise control.
8. Drive in city or suburban traffic for at least 10 minutes. When traffic conditions allow, let the vehicle coast for several seconds without using the accelerator pedal or the brake pedal.
9. Park the vehicle and leave the power system off for 40 minutes.

The readiness codes are erased when the battery is disconnected. The codes are set again only after several days of driving under a variety of conditions.

If a testing facility determines that the readiness codes are not set, you may be requested to return at a later date to complete the test or see your dealer.

SPECIFICATIONS

Vehicle Specifications	
Model	Acura HX
No. of Passengers	
Front	2
Rear	0
Total	2
Weights	
Gross Vehicle Weight Rating	U.S.: 4,497 lb (2,043 kg) Canada: 2,043 kg
Gross Axle Weight Rating (Front)	U.S.: 1,335 lbs (605 kg) Canada: 605 kg
Gross Axle Weight Rating (Rear)	U.S.: 2,845 lb (1,290 kg) Canada: 1,290 kg
Air Conditioning	
Refrigerant Type	HFC - 342 (R-134a)
Charge Quantity	16.0 - 17.8 oz (455 - 505 g)
Lubricant Type	ISO-CL 11
Quantity	3.72 - 4.23 fl oz (110 - 125 mL)

Engine Specifications	
Displacement	218 cu-in (3,592 cm³)
Spark Plugs	NGK SL-2KAR37S

Fuel	
Type	Unleaded premium gasoline, Pump octane number 87 or higher
Fuel Tank Capacity	15.8 US gal (59.0 L)

Washer Fluid	
Tank Capacity	2.5 US qt (2.0 L)

Brake Fluid	
Specified	Acura Heavy Duty Brake Fluid DOT 4

Dual Clutch Transmission Fluid	
Clutch	
Specified	Acura Automatic Transmission Fluid ATF DW-1
Capacity	Change 2.75 US qt (2.6 L)
Transmission	
Specified	Acura Gear Oil GO-Type 2.0
Capacity	Change 4.88 US qt (4.6 L)

Twin Motor Unit Fluid	
Specified	
Acura Automatic Transmission Fluid ATF DW-1	
Capacity	Change 2.36 US qt (2.2 L)
Engine Oil	
Recommended	
Ultimate Full Synthetic Motor Oil Type3, 0W-40	
Change 7.7 US qt (7.3 L)	
Capacity	Change including filter 8.5 US qt (7.9 L)
Engine Coolant	
Specified	
Acura Long Life Antifreeze/Coolant Type2	
Ratio 50/50 with distilled water	
4.1 US gal (15.5 L)	
Capacity	Change including the remaining 4.24 US gal (16.0 L) in the reserve tank and heater

Inverter Coolant	
Specified	
Acura Long Life Antifreeze/Coolant Type2	
Ratio 50/50 with distilled water	
0.50 US gal (1.90 L)	
Capacity	Change including the remaining 0.17 US gal (0.65 L) in the reserve tank

Tire	
Regular	Size
	Front 275x35ZRR19 (82H)
	Rear 305x35ZRR20 (83H)
Regular	Pressure (psi/kPa [kgf/cm²])
	Front 32 (220) [14.2]
	Rear 32 (220) [12.2]
Wheel Size	Front 19 X 8 1/2J
	Rear 20 X 11J

Light Bulbs

Headlights (Low Beam)	LED
Headlights (High Beam)	LED
Front Turn Signal/Parking Lights	LED
Front Side Marker Lights	LED
Side Turn Signal Lights (on Door Mirrors)	LED
Daytime Running Lights	LED
Rear Turn Signal Lights	LED
Brake/Tail lights	LED
Rear Side Marker Lights	LED
Taillights	LED
Backup Lights	LED
Rear License Plate Lights	LED
High-Mount Brake Light	LED
Interior Lights	
Map Lights	LED
Ambient Lights	LED
Door Courtesy Lights	LED
Glove Box Light	LED
Trunk Light	LED

CLIENT INFORMATION

Learn about information specific to you as an Acura client and how to get help.

Frequently Asked Questions/Troubleshooting

Below are some frequently asked questions and troubleshooting items that you may have about the vehicle.

Q: How do I set the vehicle clock?

A: For vehicles without navigation, see Setting the Clock. For vehicles with navigation, the time is automatically set using GPS signals.

Q: Why doesn't the vehicle start when I press the ENGINE START/STOP button?

A: The brake pedal must be pressed to start the vehicle.

Q: What is the AUTO setting on my headlight lever?

A: When in the AUTO position, the vehicle's exterior lights will automatically turn on or off depending on the ambient lighting.

Q: Why won't the driver's door unlock when I grab the door handle, even though the keyless access remote is within range?

A: If you pull the handle too quickly, the system may not have time to confirm the door is unlocked. Wait to hear a beep to confirm the door is unlocked. If you are wearing gloves, the system may be slow to respond.

Q: After my battery was disconnected or went dead, the audio system is asking for a code. Where do I find this?

A: In most cases, you do not need to enter a code. Turn on the vehicle, then press and hold the audio power button until the system reactivates.

Q: Why can't I operate Pandora® through the audio system?

A: Audio may be streaming through *Bluetooth*® Audio. Make sure Pandora® mode is selected and the phone cable is properly connected to the USB adapter. Some phones may prompt you to "Allow" a connection.

Q: Is my phone compatible with *Bluetooth*® features? How do I pair my phone?

A: U.S. customers can check phone compatibility and get more information by visiting *handsfreelink.com*. Canada customers can phone (855)-490-7351 for any HandsFreeLink® related inquiry. For pairing instructions, see Pairing a Phone .

Q: Every time I press the Talk button, the system gives me voice prompts *1. Can I turn these off?

A: You can press the Talk button a second time to interrupt the guidance. Or, you can turn guidance on or off permanently via System settings. See Voice Portal Commands.

Q: The amber indicator with a tire and an exclamation mark is on. What do I do?

*1 - If equipped

A: Either your tire pressure is low or you recently filled a tire. See Tire Pressure Monitoring System (TPMS).

Contact Us

Acura dealer personnel are trained professionals. They should be able to answer all your questions. If you encounter a problem that your dealership does not solve to your satisfaction, please discuss it with the dealership’s Service Manager or General Manager. If you are dissatisfied with the decision made by the dealership’s management, contact Acura Client Relations.

U.S. owners

American Honda Motor Co., Inc.	Torrance, CA 90501-2746
Acura Client Relations	Tel: 844-682-2872
Mail Stop 100-5E-8F	Fax: (310) 783-3535
1919 Torrance Blvd.	Twitter: Twitter.com/AcuraClientCare

Canadian owners

Honda Canada, Inc.	Fax: 1-877-939-0909
Acura Client Services	Please contact the NSX Concierge at nsx_concierge@acura.ca should you have any questions regarding the product, the purchase process or are interested in participating in customer
180 Honda Blvd.	
Markham, ON L6C 0H9	
Tel: 1-888-9-ACURA-9 or 1-844-9-MYNSX-9 (NSX specific)	

appreciation events offered by Acura Canada.

In Puerto Rico and the U.S. Virgin Islands

Bella International
P.O. Box 190816
San Juan, PR 00919-0816
Tel: (787) 620-7546

When you call or write, please be provide the following information:

- | | |
|--|--|
| • Vehicle Identification Number | • A detailed description of the problem |
| • Date of purchase | • Name of the dealer who sold the vehicle to you |
| • Odometer reading of your vehicle | |
| • Your name, address, and telephone number | |

Warranty Coverages

Below is a brief summary of the warranties covering your new vehicle.

New Vehicle Limited Warranty: Covers your new vehicle, except for the emissions control system and accessories, against defects in materials and workmanship.

Emissions Control Systems Defects Warranty and Emissions Performance Warranty: Covers your vehicle’s emissions control systems. Time, mileage, and coverage are conditional.

Seat Belt Limited Warranty: Covers seat belts that fail to function properly.

Rust Perforation Limited Warranty: Covers all exterior body panels that rust through from the inside.

Accessory Limited Warranty: Covers Acura accessories.

Replacement Parts Limited Warranty: Covers all Acura replacement parts against defects in materials and workmanship.

Replacement Battery Limited Warranty: Provides prorated coverage for a replacement battery purchased from an Acura dealer.

Replacement Muffler Lifetime Limited Warranty: Covers a replacement muffler for the duration of the ownership.

Restrictions and exclusions apply to all these warranties. See the Warranty Information booklet or visit www.owners.acura.com (U.S.) or www.myacura.ca (Canada) for complete descriptions of each warranty, including time, mileage, and other conditional limitations.

Your vehicle's original tires are covered by their manufacturer. Tire warranty information can be found at owners.acura.com (U.S.) or www.myacura.ca (Canada).

EPA Contact Information

An owner may obtain further information concerning emission warranties or report violations of the term of the emission warranties by contacting:

U.S. Environmental Protection Agency
Office of Transportation and Air Quality

Compliance Division, Light-Duty Vehicles Group
Attn: Warranty Complaints
2000 Traverwood Drive
Ann Arbor, MI 48105
Email: complianceinfo@epa.gov

VOICE COMMAND INDEX

Learn about the available voice commands to help you operate the vehicle. The system recognizes only those commands shown here. Press the TALK button before you say a command.

Voice Portal Commands

When you press the TALK button, the Voice Portal screen appears. Say one of the options, and follow the system prompts.

- Phone
- Audio
- Navigation^{*2}

Phone Commands

The system accepts these commands on most screens.

- Dial by number
- Redial
- Back
- Call <Your Contact Name>
- Dial <Your Contact Name>

Audio Commands

The system accepts these commands on the dedicated screen for the voice recognition of the audio.

^{*2} - Models with navigation only

- Tune to FM <87.7 - 107.9>
- SiriusXM channel (0-999)
- SiriusXM (0-999)
- Play Artist <Artist>
- Play Album <Album>
- Play Song <Song>
- Play Playlist <Playlist>
- List Playlist <Playlist>

Navigation Commands^{*2}

When you press the Talk button and say “*Navigation*,” you can say one of the options below. Follow the system prompts.

- Address (English Only)^{*13}
- Place Name (English Only)^{*13}
- Find Nearest
- Go Home
- Previous Destination
- Back
- Cancel

^{*2} - Models with navigation only

^{*13} - US models only, if equipped

INDEX

AcuraLink.....	69, 70	Dialing a Number.....	89
AcuraLink Assist.....	70	Making a Call.....	89
Airbags.....	10–12, 14, 17, 19	Pairing a Phone.....	87
Advanced Airbags.....	11	SMS Text Messaging and E-Mail.....	93
Airbag Care.....	19	Using Speed Dial.....	93
Airbag System Components.....	17	Using the Phonebook.....	90
Airbag System Indicators.....	14	Braking.....	113, 114, 116, 117
Front Airbags.....	10	Anti-Lock Brake System (ABS).....	117
Side Airbags.....	12	Brake Assist System.....	116
Side Curtain Airbags.....	12	Foot Brake.....	114
Audio and Connectivity.....	65–84	Parking Brake.....	114
Adjusting the Sound.....	68	Brightness Control.....	44
Android Auto.....	72	Carbon Monoxide Gas.....	5
Apple CarPlay.....	70	Child Safety.....	20, 24, 26, 41
Bluetooth Audio.....	82	Child Seat with lap/shoulder belt.....	24
FM/AM Radio.....	75	Child seat with Tether.....	26
iPod.....	77	Childproof Door Locks.....	41
SiriusXM Radio.....	76	Selecting a Child Seat.....	24
USB Flash Drive.....	80	Climate Control System.....	60, 61
USB Port.....	65	Heated Seats.....	61
Bluetooth Handsfreelink		Clock.....	63
(HFL).....	87, 89, 90, 93	Contact Us.....	184

Cruise Control.....	120	Immobilizer.....	33
Customized Features.....	62	Instrument Panel Indicators.....	31–37
Doors.....	40, 41	Jump Starting.....	131
Front Door Inner Handle.....	40	Keyless Access System.....	38
Lock Tab.....	40	Lights.....	44, 45
Master Door Lock Switch.....	41	Interior Lights.....	44, 45
Engine.....	135, 155	Maintenance.....	147–179
Emergency Engine Stop.....	135	Battery.....	164
Engine Compartment Cover.....	155	Brake Fluid.....	165
Floor Mats.....	54	Engine Oil.....	156
Frequently Asked Questions/ Troubleshooting.....	182	Maintenance Minder.....	148
Fuel.....	126	Opening the Hood.....	153
Fuel Information.....	126	Under the Hood.....	151
Refueling.....	126	Window Washer Fluid.....	164
Fuses.....	143, 146	Wiper Blades.....	165
Changing.....	146	Mirrors.....	55–57
Location.....	143	Door Mirrors.....	56
Gear Selection.....	109	Reverse Tilt Down Mirrors.....	57
Shifting.....	109	Multi-View Rear Camera.....	124
Headlights.....	46, 48	Navigation.....	96–101
Headlight-Wiper Integration.....	48	Home Address.....	97
HFL.....	85–95	Map Legend.....	99
HomeLink Universal Transceiver.....	58	Routing.....	99
		Steering Wheel Controls.....	96

Street Address.....	98	Tire and Wheel Replacement.....	171
Traffic.....	100	Tire Chains.....	173
Overheating.....	133	Tire Identification Number (TIN).....	175
Parking Sensor System.....	123	Tire Information.....	168
Power Outlets 12-Volt.....	66	Tire Labeling.....	174
Readiness Codes.....	178	Tire Pressure Monitoring System (TPMS).....	137
Safety.....	3–30	Tire Quality Grading.....	176
Reporting Safety Defects.....	29	Tire Service Life.....	172
Safety Label Locations.....	28	Tire Terminology.....	175
Seat Belts.....	5–8	Wear Indicators.....	170
Fastening a Seat Belt.....	8	Winter Tires.....	172
Inspection.....	7	Towing.....	107, 136
Lap/Shoulder Belts.....	6	Emergency Towing.....	136
Proper Use.....	6	Towing a Trailer.....	107
Seating.....	49, 53	Turn Signals.....	47
Driver Seat.....	49	Vehicle Stability Assist System (VSA).....	119
Driving Position Memory System.....	53	Voice Command Index.....	188, 189
Specifications.....	180, 181	Warranty.....	185
Light Bulbs.....	180, 181	Warranty Coverages.....	185
Steering Wheel Adjusting.....	55	Window.....	42
Tires.....	137, 139, 168, 170–176	Power Windows.....	42
Flat Tire.....	139	Wipers.....	47, 48
Tire and Loading Information Label.....	170	Intermittent Wipers.....	48

DISCLOSURES

California Proposition 65 Warning

 **WARNING:** Operating, servicing and maintaining a passenger vehicle or off-highway motor vehicle can expose you to chemicals including engine exhaust, carbon monoxide, phthalates, and lead, which are known to the State of California to cause cancer and birth defects or other reproductive harm. To minimize exposure, avoid breathing exhaust, do not idle the engine except as necessary, service your vehicle in a well-ventilated area and wear gloves or wash your hands frequently when servicing your vehicle. For more information go to www.p65Warnings.ca.gov/passenger-vehicle.

California Perchlorate Contamination Prevention Act

The airbags, seat belt tensioners, and CR-type batteries in this vehicle may contain perchlorate materials-special handling may apply. See www.dtsc.ca.gov/hazardouswaste/perchlorate/ for more information.