



INSTALLATION INSTRUCTIONS

Accessory
ARMREST WITH STORAGE COMPARTMENT
P/N 08U89-SCV-180

Application
2003 ELEMENT

Publications No.
All 24275-27678
Issue Date
AUG 2004

PARTS LIST

Armrest box

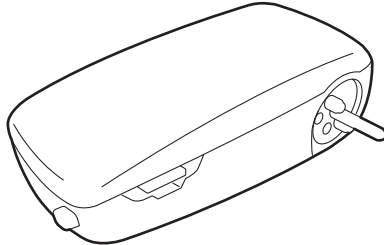

Base



2 Socket bolts



Owner's Manual

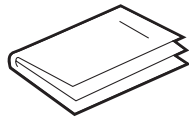

TOOLS REQUIRED

Ratchet
10 mm and 17 mm Sockets
5 mm Hex wrench
Torque wrench
Utility knife
Tape measure
Felt-tip pen

INSTALLATION

NOTE: Be careful not to damage the seat-back when installing the armrest console.

If the vehicle is equipped with an armrest, continue with step 1, otherwise go to step 5.

1. Zip open the armrest cover on the existing driver's seat, and turn over the cover as shown.

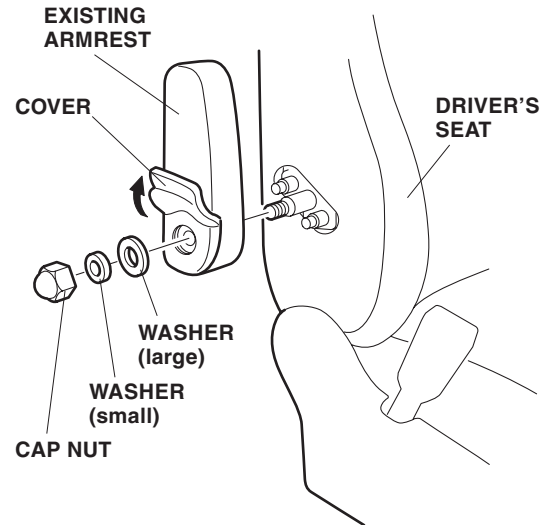

2. Remove the cap nut, small washer and large washer that secures the existing armrest, and remove the armrest.

- Remove the base (two bolts). Set the armrest and the base with bolts aside; they will not be reused.

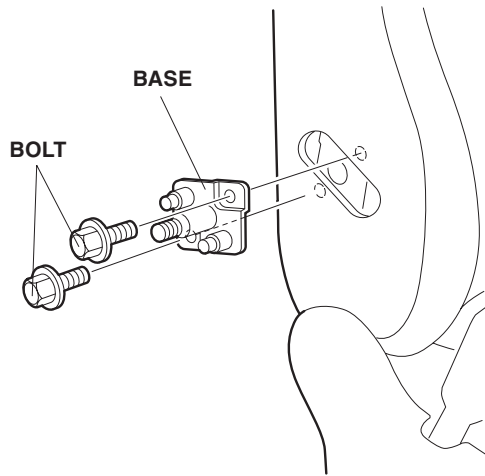

- Using a tape measure and a felt-tip pen, measure and mark the seat-back cover in the area shown. Cut out the marked area from the seat-back cover with a utility knife, then go to step 7.

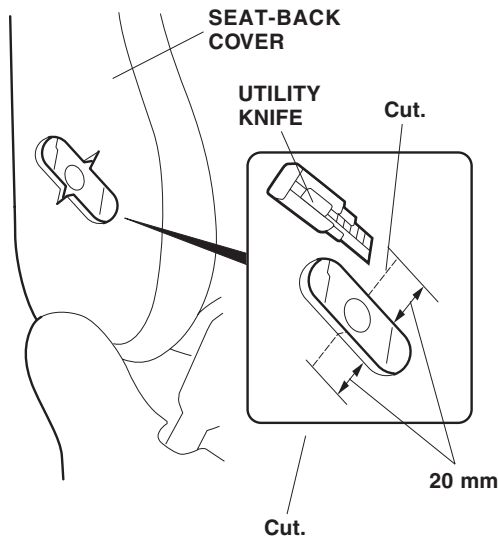

- Using a felt-tip pen and tape measure, measure and mark the seat-back cover as shown. Push in on the mark, and confirm that the mark is centered over the hole in seat base.

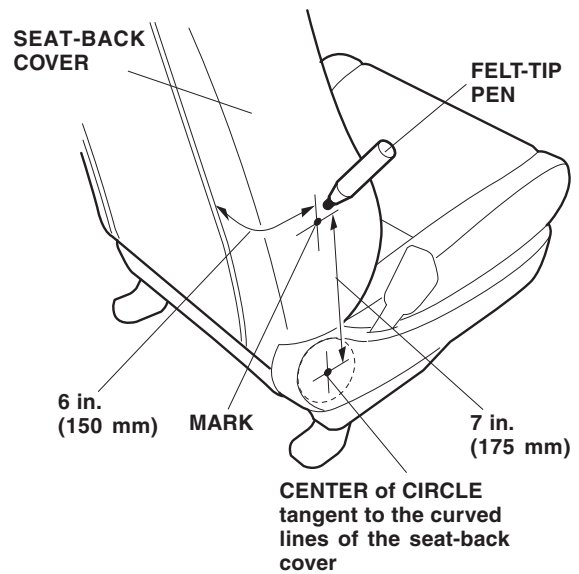

- Using a utility knife, make two 3 in. (70 mm) cuts in the seat-back cover through the mark at a right angle to each other as shown. Using these 3 in. (70 mm) cuts as a guide, cut out the marked area from the seat urethane to expose the seat base.

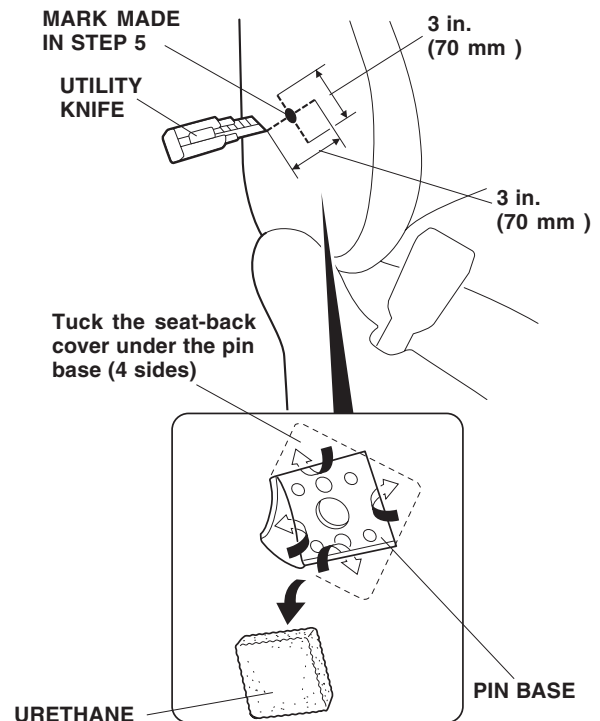

7. Get the new base from the kit, and position it on the pin base of the seat. Install the two socket bolts. Torque the socket bolts to 10-12 N·m (7-9 lb·ft).

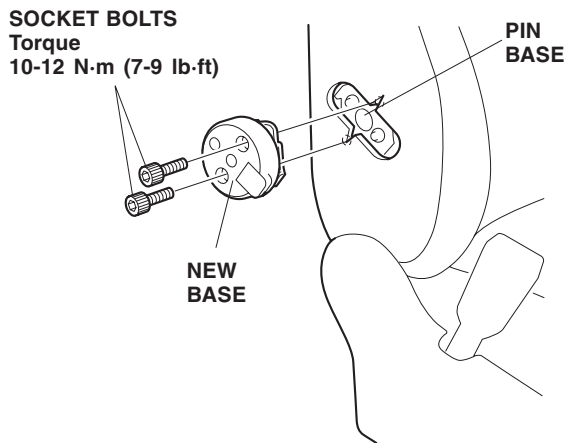

8. Insert the armrest into the holes in the base and push on it until it clicks into position. The white recessed portion of the push knob should be visible.

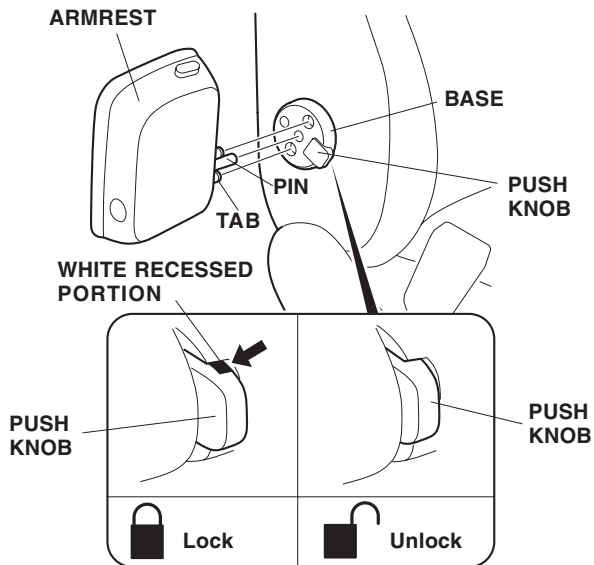

9. Check that the armrest operates properly by moving it up and down with your hand.
10. To release the armrest press on the push knob and pull out on the armrest.