

Dash View/ Need to Know

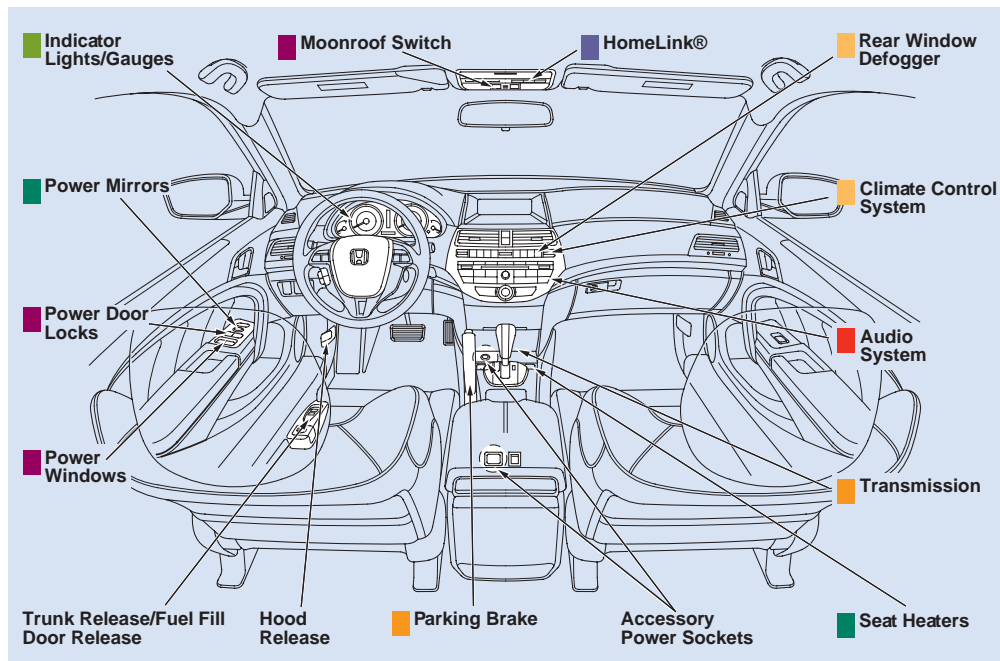

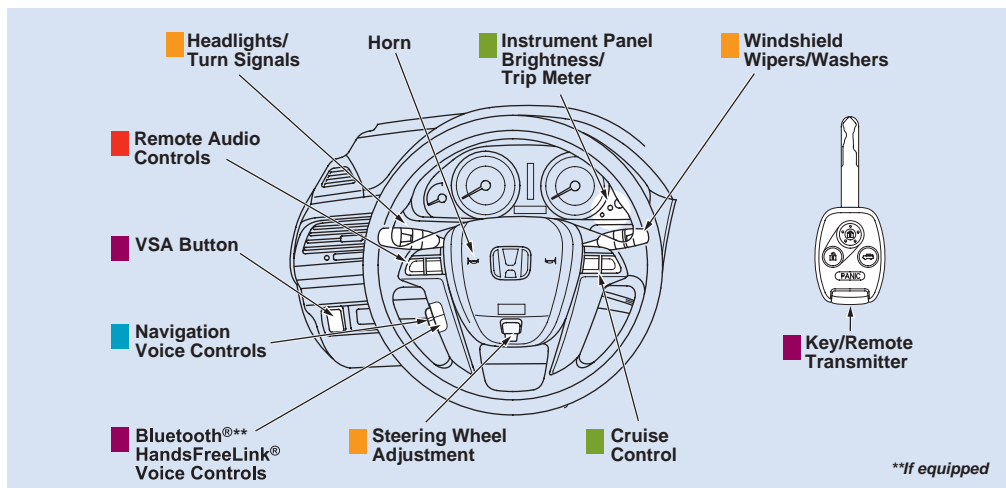

Things You Need to Know

- See *About This Quick Start Guide* on the rear cover.
- See the owner's manual for detailed information and instructions marked with an asterisk (*).
- Always check tire pressures when the tires are cold.
- Tire Pressure Monitoring System (TPMS) indicators.
- The malfunction indicator lamp may come on if the gas cap is not tightened at least 1 click.
- Location of the hood release lever (see Dash View).

*** Check the owner's manual for additional information and instructions.**

Dash View/
Need to Know

Inst Panel/TPMS/ Cruise/Compass

Message in the Information Display

Check Fuel Cap: Fuel cap is missing or not properly tightened. Check that the fuel cap is installed and tightened at least one click.

Temperature Gauge: If the pointer is in the red zone, turn off the engine immediately, or as soon as safely possible*.

Instrument Panel Indicators

Indicators should go out shortly after starting the engine. If an indicator stays on or comes on while driving, follow the instructions in the description.

- Red indicators are critical and require immediate attention.
- Amber indicators are urgent and require attention as soon as possible.
- Blue and green indicators are used for general information.



Charging system indicator:

Battery is not being charged; see dealer as soon as possible.



Low oil pressure indicator: Low oil pressure; turn the engine off as soon as safely possible.



Security system indicator: Blinks when the security system is armed.

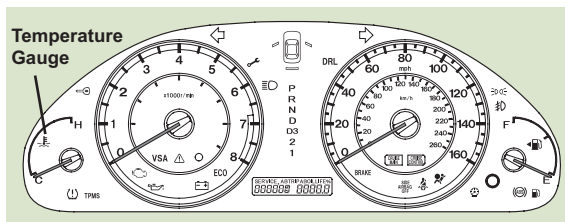

Supplemental restraint system (SRS) indicator: SRS malfunction; see dealer as soon as possible.*



Seat belt reminder light: Fasten seat belts.



Parking brake and brake system indicator:

Parking brake on, low brake fluid level.



Door and trunk open monitor: Comes on if the trunk lid is left open. Will go out after about 3 minutes, even if the lid is not closed.



Malfunction indicator lamp (CHECK engine light): Engine or emissions system malfunction; have dealer inspect the vehicle.



Maintenance minder indicator: A scheduled maintenance is due; stays on if maintenance is past due.



Fuel gauge/low fuel indicator

Note: It is important to see the Instruments and Controls section in the owner's manual.



Low tire pressure indicator: One or more of the vehicle's tires is significantly under-inflated. Stop, inspect all tires, and add air as required.

TPMS

Tire pressure monitoring system (TPMS) indicator: TPMS malfunction; have dealer inspect the vehicle.



Side airbag cutoff indicator*: Passenger's side airbag is off and will not deploy during a crash.



Passenger airbag cutoff indicator*: Passenger's front airbag is off and will not deploy during a crash.



Anti-lock brake system (ABS) indicator: ABS malfunction; see your dealer as soon as possible.



Vehicle stability assist (VSA®) activation indicator: A reminder that the VSA is turned off. Flashes when VSA is active.

VSA

Vehicle stability assist (VSA) system indicator*: Possible VSA system problem.

DRL

Daytime running lights (DRL) indicator



Immobilizer system indicator: Flashes if an improperly coded key is used in the ignition switch.



Cruise main indicator: Cruise control is on and is waiting to be set.



Cruise control indicator: Cruise control is set.



Lights on indicator: Indicates parking lights or headlights are on.



ECO indicator (V6 models with automatic transmission): Comes on when the engine is performing at its most economical level.



Turn signal/hazard warning indicators



Fog lights on indicator (if equipped)



High beam indicator



Outside temperature indicator (if equipped)/odometer: Displays outside temperature or odometer when Select/Reset knob is pressed.

** Check the owner's manual for additional information and instructions.*

Information Display*

Your vehicle displays engine oil life and maintenance service items on the information display; see your owner's manual for details.

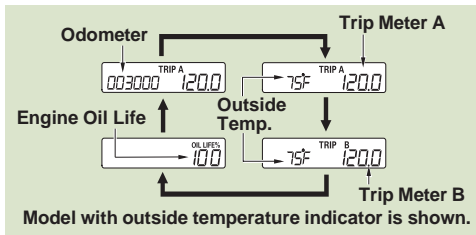

The display can be changed using the Select/Reset knob on the dash. The display can also be customized to show:

Odometer: Total number of miles driven.

Trip Meter (A & B): Number of miles driven for Trip A or Trip B since last reset.

Outside Temperature: Outside temperature.

Check Fuel Cap: The fuel cap is loose or missing.

The following Maintenance Minder items are also displayed:

Engine Oil Life: Remaining engine oil life.

Maintenance Service Items: Three types of messages appear in the display: service due soon, service due now, and service past due.

Low Tire Pressure/TPMS Indicator*



When the indicator comes on, one or more tires are significantly under-inflated. You should stop and check your tires as soon as possible and, if needed, inflate them to the proper pressure as indicated on the tire information placard, located on the driver's doorjamb.

Tip: Tire pressure varies by temperature and other conditions.

- Check the air pressure when the tires are cold. This means the vehicle has been parked for at least 3 hours or driven less than 1 mile.
- The indicator may come on when you first start your vehicle, then go off when friction raises the tire temperature. Even if the indicator goes off, always check the pressure and adjust as required.

Cruise Control

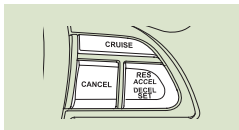

Cruise control master button: Turns the cruise control system on (CRUISE MAIN indicator lit) and off. It does not set the cruise control.

Set/Decel button: Sets cruise control (CRUISE CONTROL indicator lit) if speed is above 25 mph, or decreases the set speed if cruise control is set.

Res/Accel button: Resumes set speed if the cruise control was canceled, or increases set speed if cruise control is set.

Cancel button: Cancels cruise control. It does not turn off the cruise control system. You can resume a set speed if the cruise control was canceled. You can also cancel the cruise control by tapping the brake pedal.

Setting the Clock (without Navigation)

1. With the ignition ON (II), press the CLOCK button until you hear a beep.
2. Press and hold the H button (Preset 4) to set the hour.
3. Press and hold the M button (Preset 5) to set the minutes.
4. Press the CLOCK button again.

Note: On vehicles with navigation, the clock is set automatically by the navigation system.

Compass Operation (EX-L, EX-L V6 w/o Navi)

Your vehicle is equipped with a self-calibrating compass system. Overall operation of this system can be affected when you drive:

- Near power lines or stations
- Across bridges
- Through tunnels
- Over railroad crossings
- Past large vehicles
- Near large objects that can cause a magnetic disturbance.

It can also be affected by accessories such as antennas and roof racks that are mounted by magnets.

Compass Zone Selection

In most areas, there is a variation between magnetic north and true north. Zone selection is required so the compass can compensate for this variation. See the owner's manual for zone selection information.

Calibration

At times, the compass may need to be manually calibrated after exposure to a strong magnetic field. If the compass seems to be continuously showing the wrong direction and is not self-calibrating, or if the compass display is blinking with the CAL indicator on, follow the calibration procedure found in the owner's manual.

** Check the owner's manual for additional information and instructions.*

Inst Panel/TPMS/
Cruise/Compass

Driver Controls

Headlights/Turn Signals Lever

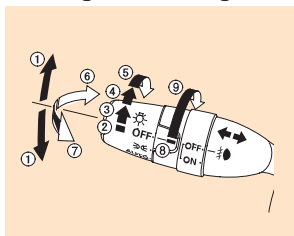

1. Turn signal
2. Off
3. Parking/indicator lights
4. AUTO (if equipped)
5. Headlights
6. High beams
7. Flash high beams
8. Fog lights OFF (if equipped)
9. Fog lights ON (if equipped)

Auto Lighting Off

The headlights, all exterior lights and all the instrument panel lights turn off within 15 seconds after you remove the key and close the driver's door.

Auto Lighting On (EX-L, EX-L V6 models)

Turns on the headlights and all other exterior lights when low ambient lighting is detected.

Parking Brake

To release, pull up slightly, push button, and lower completely.

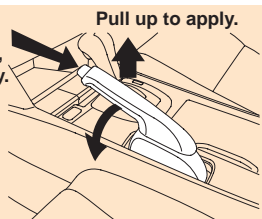

Note: If you start to drive with the parking brake applied, a beep sounds.

Windshield Wipers/Washers Lever

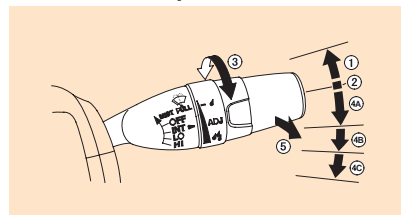

1. **MIST**
2. **OFF**
3. **ADJ ring:** Rotate to adjust wiper interval speed.
4. **Wiper ON:** Push the lever down:
 - a. **INT** (1st detent): Wipers operate intermittently.
 - b. **LO** (2nd detent): Long sweep intervals.
 - c. **HI** (3rd detent): Short sweep intervals.
5. **Wiper and Washer ON:** Pull back and hold to clean the front windshield.

Automatic Transmission

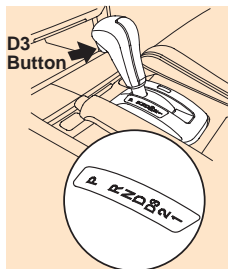

- P Park:** Transmission is locked.
- R Reverse**
- N Neutral:** Transmission is **not** locked; use brake pedal or parking brake.
- D Drive:** Normal driving.
- D3 Third:** 1st three gears only.
- 2 Second:** Transmission is locked in 2nd gear.
- 1 First:** Transmission is locked in 1st gear.

Tip: The ignition must be ON (II) and the brake pedal pressed to shift out of Park.

Manual Transmission

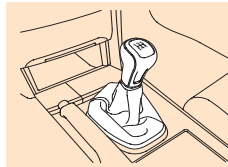

The vehicle is equipped with a clutch interlock switch. Push the clutch pedal all the way down when starting the engine.

Tilt/Telescopic Steering Wheel

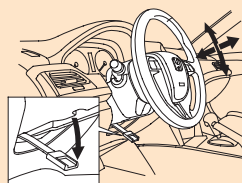

Adjust the steering wheel (up, down, in or out) to the desired position.

Pull the lever underside the steering column toward you. **Push** the lever to fully lock it in place.

Power Mirrors

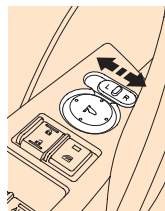

1. With the ignition ON (II), move the switch to L (driver's side) or R (passenger's side).
2. Push the edge of the switch to adjust the mirror right, left, up, or down.
3. When finished, move the switch back to the center (off) position.

Tip: If equipped, the outside mirror heaters can be turned on by pressing the heated mirror button.

** Check the owner's manual for additional information and instructions.*

Driver Controls

Locks/Windows/ VSA®/Moonroof

Key/Remote Transmitter

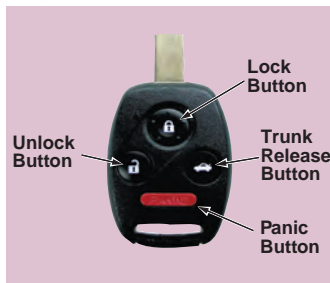

Unlock button: Press once to unlock the driver's door. Press again to unlock the passenger's door. Continue to hold the button on the second press to open the windows and moonroof; release the button to stop.

Tip: If you do not open a door within 30 seconds, the doors relock.

Lock button: Press to lock both doors. Press again and a beep verifies that the doors are locked.

Tip: The doors will not lock if any door is not fully closed or the key is in the ignition. The beep will not sound if both doors, the hood, and the trunk are not fully closed.

Trunk release button: Press and hold until the trunk opens.

Panic button: Press and hold for two seconds to turn on. Press any button on the remote transmitter or turn the ignition to ON (II) to turn off. The panic mode turns off automatically after 30 seconds.

Tip: The panic mode will not work if the ignition is in ON (II).

Power Door Locks with Auto Window Open and Close Feature

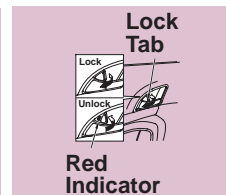
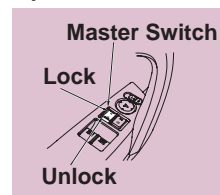

- The master lock switch locks and unlocks both doors.
- Pull back on the driver's door lock tab to lock both doors. Push forward on the tab to unlock only the driver's door. The lock tab on the passenger's door locks and unlocks only that door.

Unlock: To unlock only the driver's door from outside, turn the key to the right and release. To unlock the passenger's door, turn the key again. Continue to hold the key on the second turn to open the windows and moonroof; release to stop.

Lock: To lock both doors from outside, turn the key to the left and release. Turn the key again and hold to close the windows and moonroof; release to stop.

Power Windows

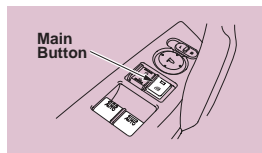

Tip: The power windows can be operated for 10 minutes after the ignition is turned off. This is cancelled by opening either door.

- The driver's and passenger's (if equipped) windows have an Auto Down and Auto Up function. Push the switch firmly down to the second detent and release it to fully lower the window. Pull the switch firmly back and release it to fully raise the window. The first detent is used to open or close the window to the desired position.
- The main button controls power to the passenger's window. Push down on the button and the passenger's window cannot be opened or closed. The button's indicator will come on.

Moonroof (if equipped)

- **Open:** Pull back fully, then release (auto open), or until the desired position is reached.
- **Close:** Push forward fully, then release (auto close) or until the desired position is reached.
- **Tilt:** Push up on the middle of the switch until the desired position is reached.



Tip: The moonroof operates for 10 minutes after the ignition switch is turned off. This is cancelled by opening any door.

*** Check the owner's manual for additional information and instructions.**

Locks/Windows/
VSA®/Moonroof

Seats

Power Front Seats (if equipped)

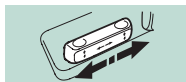
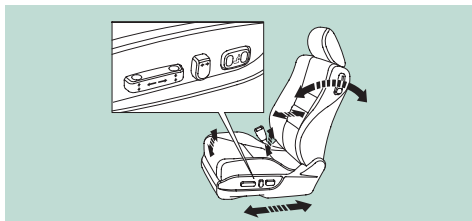

- **Driver's and passenger's seat:** Moves the seat forward and backward.



- **Driver's and passenger's seat:** Adjusts the seat-back angle forward or backward.

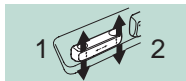

- **Driver's seat only:** 1 moves the front of the seat up or down. 2 raises or lowers the whole seat.

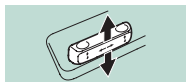

- **Driver's seat only:** Adjusts the whole seat up and forward or down and back.



- **Driver's Power Lumbar (if equipped):** Press either side of the bar to increase or decrease lumbar support.

Driver's Seat Height Adjustment (if equipped)

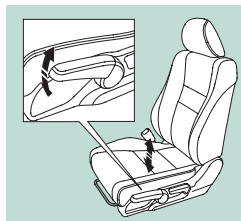

- Pull up and release the lever repeatedly to raise the seat to the desired height.
- Push down and release the lever repeatedly to lower the seat to the desired height.

Manual Seat Adjustment



- Pull up on the bar under the seat cushion's front edge to move the seat forward and backward. Release the bar to lock the seat into position.

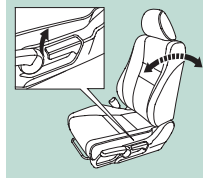

- Pull up on the lever on the outside of the seat to change the angle of the seat-back. Release the lever to lock the seat-back into position.

Folding Rear Seat

The back of the rear seat folds down, giving you direct access to the trunk. The seat-back can be released from inside the trunk.

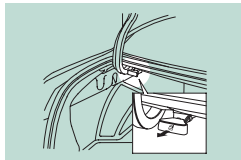

1. Pull the release handle, located inside the trunk on the driver's side.
2. Fully lower the rear headrests.
3. From inside the vehicle, pull forward on the rear seat-back.
4. To lock the seat-back upright, push it firmly against the trunk panel. Make sure it is latched in place by pulling on the top of the seat.

Tip: When storing cargo, you can move the rear center shoulder belt out of the way by removing the belt from the guide.

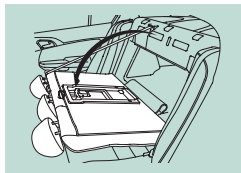

Seat Heaters (if equipped)

Push the right of the switch (HI indicator lit) to heat up the seat. After the seat reaches a comfortable temperature, set the heat to low by pushing the left of the switch (LO indicator lit).

- In HI, the heater turns off when the seat gets warm, and turns back on after the seat temperature drops. It continues to cycle as long as you leave it set on HI.
- In LO, the heater runs continuously. It does not cycle with temperature changes.

Note: Because of sensors for the side airbag system, there is no heater in the passenger's seat-back. Only the seat bottom contains a heater.

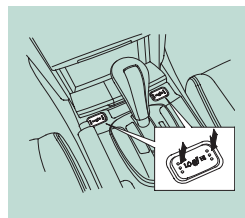

Tip: The seat heater switches do not turn off automatically when the ignition is turned off. The seat heaters will come back on when the ignition is turned to ON (II) unless the seat heater switches are turned off.

** Check the owner's manual for additional information and instructions.*

Climate Control

Climate Control System

LX and EX

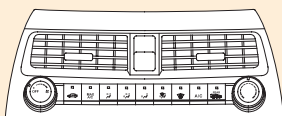

EX-L and all V6 (non-navigation)

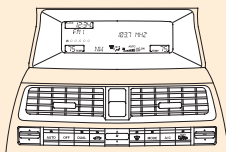

EX-L and all V6 (with navigation)

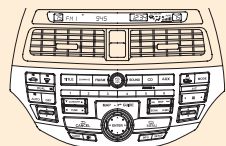

Refer to Navigation for picture of climate control system integrated with the navigation system.

Using Manual Controls

Note: Control operations are described. Check your vehicle for the types of controls used.

Air conditioning (A/C) button: Turns the A/C on (indicator lit) and off.

Temperature control dial/switch: Selects the desired temperature.

Fan Control dial/switch: Changes the fan speed. Turn to OFF to turn the system off (for vehicles with AUTO A/C, press the OFF button). To keep stale air and mustiness from collecting, you should have the fan running at all times.

MAX A/C (LX-S and EX) Recirculated A/C comes from the dashboard vents for maximum cooling.



Airflow comes from the dashboard vents.



Airflow is divided between the dashboard and floor vents.



Airflow comes from the floor vents.



Airflow is divided between the floor and windshield (defroster) vents.



Airflow comes from the windshield (defroster) vents.

Recirculation button: Changes between recirculation (indicator lit) mode (inside air) and fresh air mode (outside air).

Defroster button: Turns the defroster on (indicator lit) and off to clear the windshield of fog or frost.

Tip: If there is frost on the windows, select Recirculation mode. If the windows are fogged, select Fresh Air mode.

Rear window defogger button: Turns the defogger on (indicator lit) and off to clear the rear window of fog or frost.

Tip: The top part of the rear window is the radio antenna; it may take longer for that part to clear.

AUTO button: Turns on the automatic climate control system, which regulates the interior temperature, mode controls, and fan speed. "AUTO" is not displayed when the system is in semiautomatic mode. If you press the mode and/or fan control buttons while in AUTO mode, the system is changed to semiautomatic mode. The system no longer controls the mode controls and fan speed.

On models with navigation – In auto mode, the system regulates each temperature based on information from a sunlight sensor and the navigation global positioning system (GPS). If one side of the vehicle is getting direct sunlight, the system will adjust that side to a lower temperature.

Tip: When you set the temperature to its lower limit (LO) or its upper limit (HI), the system runs at full cooling or heating capacity. It does not regulate the interior temperature or fan speed.

Dual Mode Temperature Controls (if equipped)

DUAL button: Allows for independent driver's and passenger's side temperature control. When selected, the indicator in the button is lit. Press again to return temperature control to the driver side control. The indicator will turn off.

Note: When defroster mode is selected, dual mode function is cancelled.

OFF button: Completely turns off the climate control system.

** Check the owner's manual for additional information and instructions.*

Audio

Audio System

LX Models

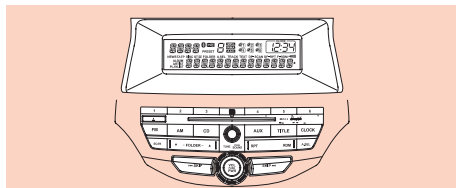

EX, EX-L Models (EX-L model shown)

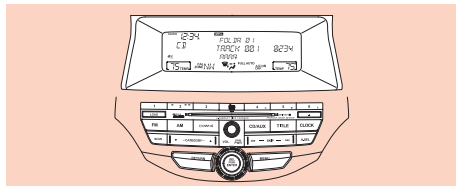

With Navigation

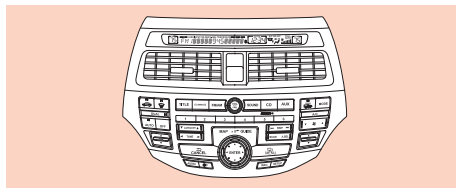

Audio Controls

Note: Control operations are described. Check your vehicle for the types of controls used.

TUNE/Selector knob/bar:

Changes the radio station.

AM/FM/XM buttons:

Selects AM, FM1, FM2, XM1, or XM2 (if equipped).

Preset buttons:

Selects the desired station stored in a band (AM/FM1/FM2/XM1/XM2). To store a station, press and hold the desired preset button until you hear a beep, then release.

SKIP buttons/bar:

Seeks upward (>>) or downward (<<) to find the next station with a strong signal.

A.SEL button/bar:

Turns on AUTO SELECT – this scans the AM and FM bands and stores the strongest stations in the preset buttons of each band.

Tip: You will not lose your selected presets. They will come back when you turn off AUTO SELECT.

CD (CD/AUX) button:

Selects the CD changer.

Audio Display

Audio information is shown in the center display.

(EX, EX-L display shown) (Navigation display shown)

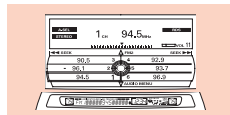
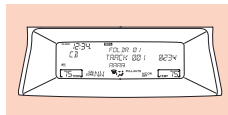

Note: With headlights on, the instrument panel brightness control knob can be used to adjust audio illumination.

Selector Knob/Interface Dial (if equipped)

Most audio system functions can be controlled by standard controls. You can access some audio and navigation functions by using the selector knob/interface dial on the audio system. Press ENTER to select an item.

Selector Knob

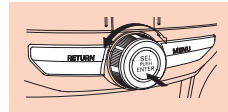

Interface Dial

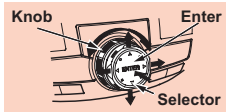

Interface Dial (models with Navigation)

The dial consists of:

- KNOB: Turns left and right to scroll through the display items and adjust the levels.
- SELECTOR (ENTER): Use to select items.

SOUND Adjustment

Sound level adjustment is accessed by pressing the SOUND button. On EX and EX-L models, the selector knob (non-navigation models) can be used. For these models, do this:

1. Press and release the MENU button.
2. Turn the selector knob to move to any of these settings: BASS TREBLE FADER BALANCE SUBW (EX-L only) SVC CLOCK ADJUST (on 6-CD system, this is accessed by the MENU button).
3. Press the selector knob to choose the desired setting.
4. Turn the selector knob to adjust the setting up or down.
5. Press MENU to return to the original display.

Using the Remote Audio Controls

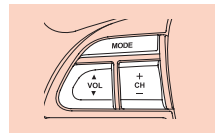

VOL buttons: Adjusts the volume.

MODE button: Changes the system to the next mode: AM/FM1/FM2/CD/XM1/XM2.

CH buttons

Radio:

- Press and release to change to the next or previous preset station.
- Press and hold until you hear a beep. The next station (+ or -) is selected.

CD: Skips to the beginning of the next track or the start of the current track.

*** Check the owner's manual for additional information and instructions.**

Auxiliary Input Jack

The auxiliary input jack is located inside the center console compartment. It will accept auxiliary input from standard audio accessories (3.5mm stereo mini-plug). To use, connect a compatible audio unit to the jack. To use a connected compatible accessory unit, press the AUX or CD/AUX button.

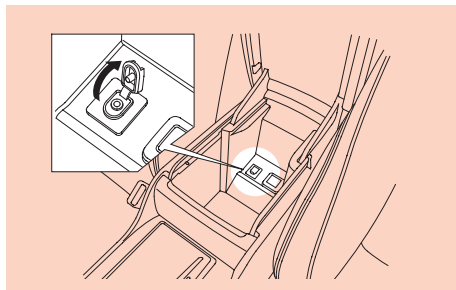

Radio Data System (RDS)

When an RDS radio station is selected, the station frequency and name are displayed. Otherwise, only the frequency is displayed.

Program Service (PS) Name Display: When selected, the name of the selected RDS station is displayed. To turn ON or OFF, press and release the TITLE button. "PS ON" or "PS OFF" appears in the display.

When either FM band is selected, RDS program category can be selected, using either side (▲ or ▼) of the CATEGORY (models with XM)/ FOLDER (models without XM) bar to display and select an RDS group. See the owner's manual for the principal RDS categories.

RDS Search: Press and release either side of the SKIP bar to search up and down for the next RDS station in your selected category with a strong signal. If ALL is selected, all RDS stations will be searched.

RDS SCAN: Press and release the SCAN button to sample all available RDS stations in your selected RDS category. If ALL is selected, all available RDS stations will be scanned. Press the button again when a desired station is reached.

Note: RDS Search and SCAN features function with the PS name display on or off.

Disc Player Controls

Note:

- Control operations for all trim levels are described. Check your vehicle for the types of controls used.
- Files in MP3/WMA mode are the equivalent of tracks in CD mode.

LX and EX Models

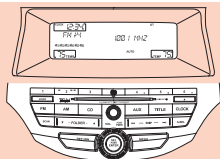

EX-L and All V6 Models (without navigation system)

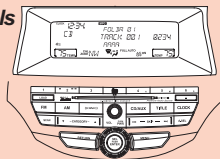

With Navigation

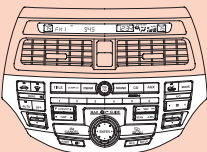

LOAD button: Loads a CD in the selected or next available slot.

Eject button: Ejects the disc currently selected.

SKIP bar: Press and release ►| to skip forward to the next track, or ◀|◀ to skip backward to the beginning of the current track. Press and hold either side to move rapidly within a track.

FOLDER bar (non-XM)/CATEGORY bar (XM equipped) (MP3, WMA Mode): Press (▲) to skip to the beginning of the next folder, or (▼) to skip to the beginning of the previous folder.

Press the MENU button to select the following items:

DISC REPEAT:** Turn the selector knob to PLAY MODE, and press ENTER. Select REPEAT DISC to continuously replay the current disc.

REPEAT (Track or File):** Turn the selector knob to PLAY MODE, and press ENTER. Select REPEAT ONE TRK to continuously replay a track (files in WMA or MP3 mode).

FOLDER REPEAT (MP3, WMA Mode):** Turn the selector knob to PLAY MODE, and press ENTER. Select REPEAT ONE FLD to replay in order all files in a selected folder, in recorded order.

RANDOM (within a disc):** Turn the selector knob to PLAY MODE, and press ENTER. Select RANDOM IN DISC to play all the tracks on a disc in random order.

(continued on next page)

****Models with Navigation:** Use the interface dial to access PLAY MODE, then select the adjustment to be made.

*** Check the owner's manual for additional information and instructions.**

Disc Player Controls *(continued)*

FOLDER RANDOM (MP3, WMA Mode):** Turn the selector knob to PLAY MODE, and press ENTER. Select RANDOM IN FLD to play all files in a selected folder in random order.

SCAN TRACK/DISC:** Turn the selector knob to PLAY MODE, and press ENTER. Select SCAN TRK to hear 10-second samples of each track/file of each disc in recorded order. Select SCAN DISC to hear 10-second samples of the first track/file of each disc.

FOLDER SCAN (MP3, WMA Mode):** Turn the selector knob to PLAY MODE, and press ENTER. Select SCAN FLD to sample 10 seconds of the first file of each folder.

TITLE button: Press to display information about tracks (CD mode), files or folders (MP3/WMA format).

****Models with Navigation:** Use the interface dial to access PLAY MODE, then select the adjustment to be made.

Playing Discs

To load a single CD in the player:

Press the LOAD button, then insert the CD halfway into the CD slot. The drive pulls it in the rest of the way. It takes a few seconds for the CD to load.

To remove a CD:

1. Press the Eject button.
2. Remove the CD as it comes out.

To load multiple CDs in the 6-CD changer:

1. Press and hold LOAD button until the system beeps.
2. When "LOAD" is displayed, insert a CD into CD slot.
3. When "LOAD" is displayed again, insert the next CD.
4. Repeat until all six positions are loaded.

Tip: If you are not loading CDs into all six positions, press the CD button after the last CD is loaded, or wait 10 seconds and the system stops the load operation.

To remove multiple CDs in the 6-CD changer:

1. Press and hold the Eject button until system beeps.
2. Remove the CDs as they come out.

Tip: If you eject the disc, but do not remove it, the system automatically reloads it after 10 seconds.

Play Mode

Press the TITLE button; the following is displayed:

- CD text data: Album, artist, track name.
- MP3 or WMA format: Folder, file name, artist, album, and track tag.

Models with Navigation: Use the interface dial to access PLAY MODE, then select the adjustment to be made.



Changing Folders, Tracks/Files (MP3 and WMA modes)

1. The selector knob can be used to select a folder or track/file on the list.
2. Press ENTER (push in the selector knob). The display changes to a three-folder list.



3. Turn the knob to scroll to a desired folder, then press ENTER. The display changes to a three-track list. Turn the knob to scroll to a desired track, then press ENTER.

Select Repeat, Random, or Scan Modes

To select any of these modes:

1. Press the MENU button to display menu selections.
2. Turn the selector knob to display PLAY MODE, and press ENTER.



3. Turn the selector knob to the desired mode, and press ENTER.

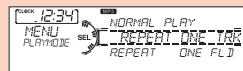

To turn off any of these features:

1. Press the MENU button, select PLAY MODE, and press ENTER.
2. Select NORMAL PLAY, and press ENTER.

*** Check the owner's manual for additional information and instructions.**

Audio

HFL/ HomeLink®

Bluetooth® HandsFreeLink® (Navi models)

Your vehicle is equipped with Bluetooth HandsFreeLink (HFL). HFL uses Bluetooth technology to link your cell phone to your vehicle, and you can place and receive calls through the audio system. To use this feature, you need a Bluetooth-compatible cell phone with the hands-free profile. For more information (including pairing information), and a list of compatible cell phones, visit handsfreelink.honda.com, or call (888) 528-7876.

Tip: The maximum range between your phone and the vehicle is 30 feet.

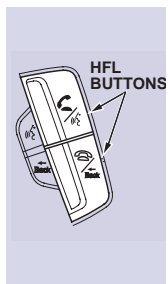

HFL TALK button: Activates HFL (audio system mutes). Press and release the button, wait for a beep, then give a voice command in a clear, natural speaking voice (without pause). If a voice command is not given within 3 seconds, the system times out (two beeps).

HFL BACK button: Use to end a call, to go back to the previous command, or to cancel an operation.

HFL Display

When operating HFL, the following appears in the main and center displays.



Using Voice Control

- If HFL does not recognize a command, its response is "Pardon, please repeat."
- To hear a list of available options at any time, say "HandsFree help."
- Many commands can be spoken together. For example, you can say "Dial 123-456-7891."
- To skip a voice prompt, press the HFL TALK button while HFL is speaking. HFL is then ready for your next command.
- To end a command sequence, press and hold the HFL BACK button, or press the HFL TALK button and say "Cancel." The next time you press the HFL TALK button, HFL begins from the main menu.
- Make sure that the airflow from the A/C vents does not interfere with the system microphone in the ceiling console.
- Close the windows/moonroof.
- If the microphone picks up other voices or if you don't speak clearly, the system may not understand your command.

Pairing Your Phone

Your Bluetooth-compatible phone must be paired to HFL before you can make and receive hands-free calls. To confirm that your phone is Bluetooth-compatible, visit handsfreelink.honda.com or call (888) 528-7876. Your phone retailer should also be able to confirm if your phone is Bluetooth-compatible.

Making a Call

You can make calls using a phone number, a name stored in your HFL phone book, or redialing the last number called. You can talk up to 30 minutes after removing the key from the ignition switch. Remember to press the HFL TALK button prior to each command.

Note: *HFL cannot dial a name stored in your phone.*

You say: "Call/Dial"

HFL responds: "What name or number would you like to call/dial?"

You say: "123 456 7890."

HFL responds: "123 456 7890?"

You say: "Yes" or "Call/Dial"

HFL responds: "Calling/Dialing."

Tip: *To redial the last number called, say "Redial" or press and hold the HFL TALK button.*

Receiving a Call

To answer a call, press the HFL TALK button. This button also activates the Call Waiting function on your phone. To decline a call, press the HFL BACK button.

Transferring a Call

You can transfer your call from HFL to your phone, and vice versa. In either case, press and release the HFL TALK button, then say "Transfer."

Import Phone book Feature (With Navigation)

The cellular phone book option allows you to store up to 1,000 names and 10,000 phone numbers in the HFL phone book from your cellular phone book. Using HFL, you can then automatically dial any name or number in the phone book. Not all phones have this capability. For more information, visit handsfreelink.honda.com, or call (888) 528-7876.

*** Check the owner's manual for additional information and instructions.**

Using the Phone Book

The HFL phone book can store up to 50 names and numbers. These can be any type of numbers. For example, a phone number can be stored and used for dialing, or an account number can be stored and used during a call with an automated system.

Tip: *HFL allows you to send numbers or names during a call; this is useful when you call a menu-driven phone system. You can also program account numbers into the HFL phone book for easy retrieval. To activate this command, say "Send." After HFL responds, say the designated name or number.*

Note: For *, say "Star" and for #, say "Pound."

Phone Book Access

You say: "Phone book"

HFL responds: "Phone book options are store, edit, delete, receive contact, and list."

Storing to the Phone Book

You say: "Store"

HFL responds: "What name would you like to store?"

You say: "Joe/Account number"

HFL responds: "What is the number for Joe/Account number?"

You say: "123 456 7891"

HFL responds: "123 456 7891. Say 'Enter,' or continue to add numbers."

You say: "Enter"

HFL responds: "Joe/Account number has been stored. Returning to the main menu."

Editing the Phone Book

You say: "Edit"

HFL responds: "What name would you like to edit?"

You say: "Joe"

HFL responds: "What is the new number for Joe?"

You say: "987 654 3210"

HFL responds: "987 654 3210. Say 'Enter,' or continue to add numbers."

You say: "Enter"

HFL responds: "The number has been changed. Returning to the main menu."

Deleting from the Phone Book

You say: "Delete"

HFL responds: "What name would you like to delete?"

You say: "Joe"

HFL responds: "Would you like to delete Joe?"

You say: "Yes"

HFL responds: "The name has been deleted. Returning to the main menu."

Selecting from your Phone Book List

You say: "List"

HFL responds: "Joe...Tim...Lisa"

You say: "Call"

HFL responds: "Would you like to call Lisa?"

You say: "Yes"

HFL responds: "Calling"

HomeLink® (if equipped)

The HomeLink® Universal Transceiver built into your vehicle can be programmed to operate up to three remote controlled devices around your home, such as garage doors, lighting, or home security systems.

Training a Button

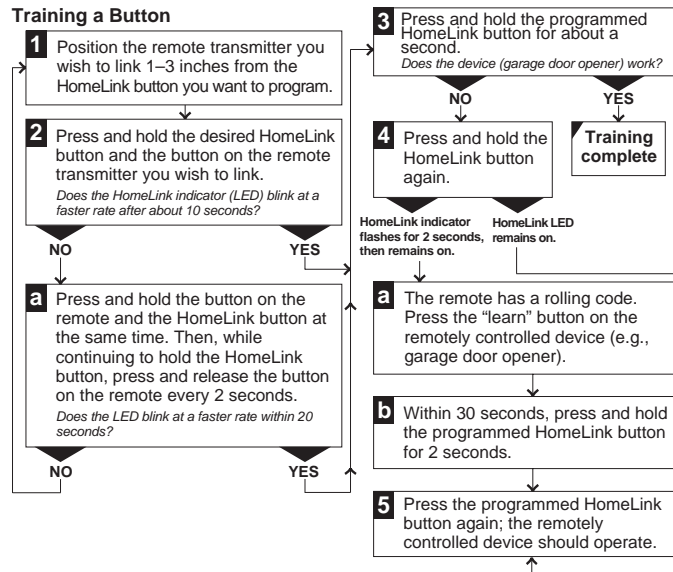

Retraining a Button

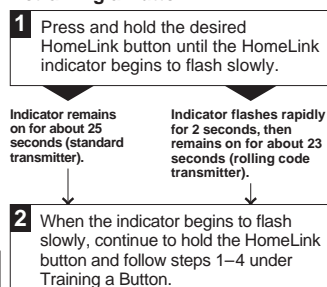

Erasing Codes

To erase codes stored in all buttons, press and hold the two outer buttons until the HomeLink indicator begins to flash (about 10 to 20 seconds), then release the buttons.
You should erase all three codes before selling the vehicle.

If you have any problems programming HomeLink, see the owner's manual included with the device you are trying to program, or call HomeLink at 1-800-355-3515 or go online to www.homelink.com.

*** Check the owner's manual for additional information and instructions.**

HFL/
HomeLink®

Navigation/ Voice Control

Navigation System

See the navigation system manual for more information.

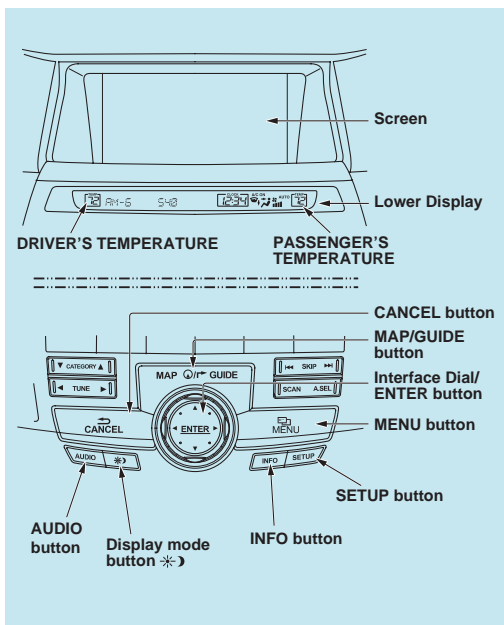

Screen: All selections and instructions are displayed on the screen. The display is not a “touch screen” – you enter information into the system either by voice or by using the Interface Dial.

Tip: Clean the screen with a soft, damp cloth, and a mild cleanser intended for eyeglasses or computer screens.

AUDIO button: Press to display the audio screen.

MAP/GUIDE button: Displays the map. When en route, switches the display between the map and guidance screens.

MENU button: Displays the “Enter a destination by” screen. When en route, displays the route options on the MENU screen.

SETUP button: Displays the Setup screen to change and personalize information in the system.

INFO button: Displays the screen for selecting Cellular Phonebook Voice Command Help, Map Legend, Calendar, Calculator, and Key to Zagat Ratings. More options are available by moving the Interface Dial to the right.

Interface Dial/ENTER button: Moves left, right, up, and down. Use to move the highlighting around the display, to scroll through lists, or to look around a displayed map. Push in to enter the selection into the system.

CANCEL button: Cancels the current screen and returns to the previous screen.

Display mode (*) button: Switches the display between Day mode, Night mode, and OFF.

Map Screen Legend

Map Orientation



"North Up"



"Heading Up"

GPS Signal Strength



: Best Reception



: Good Reception

Missing: Poor/No Reception

Vehicle Position

(Use voice command "Display the current location," or use the Interface Dial to show current location.)

Current Street

Current Map Scale

Map Scale Adjustment

(Mile or km per half-inch appears only when you zoom in or out by rotating the **Interface Dial knob**.)

NOTE:

See **Map Legend** on the **Information** screen for further explanation.

"Breadcrumbs"

Streets

Interstates or Freeways

Verified Streets

Unverified Streets

Landmark Icon - Generic



Honda Dealer



Hospital



Grocery Store



Gas Station



Hotel/Lodging



Parking Garage



Freeway Exit Information



Acura Dealer



School



Restaurant



ATM



Parking Lot



Post Office

One-Way Traffic Icon (1/20 mile only)

Map Features

: Park

: Hospital

: Shopping Mall

: Golf Course

: Airport/Stadium/Business

: Water Area

: Cemetery

: University

: Indian Reservation

NOTE:

If you move the Interface Dial over an area (map features shown above), the name is displayed on the screen.

*** Check the owner's manual for additional information and instructions.**

Using the Voice Control System

The voice control system allows for convenient, hands-free operation of navigation and selected audio and climate control system functions. For a complete list of voice commands, see the navigation system manual or press the INFO button, then select VOICE COMMAND HELP.

TALK/BACK Buttons



Ensure that you are using the NAVI TALK/BACK buttons for navigation commands, and not the HFL buttons located in front of them.

- **NAVI TALK button:** Activates the voice control system (audio system mutes). Push and release on the button, then **wait for a beep.** Give a voice

command in a clear, natural speaking voice (without pause) within 3 seconds. Otherwise, the system will prompt you to repeat your command.

Tip: A multiple beep indicates that a function is unavailable or is already set. For example, if fan speed is set to three, and you say "Fan speed three," you will hear "beep-beep-beep."

- **NAVI BACK button:** When viewing a menu screen, returns the display to the previous screen. It is enabled for navigation commands only, but can cancel an audio or climate command up to one second after the command confirmation.

General Voice Control Guidelines

The voice control microphone is located in the ceiling console. To properly control the system:

- If the system cannot recognize your command because of background noise, speak louder.
- Voice commands from the front passenger are not accepted by the system.

Optimizing Voice Control



To optimize voice recognition and hear the voice feedback:

- Avoid running the fan at maximum speeds.
- Adjust the vents so they don't blow directly at the microphone in the ceiling.
- Minimize the amount of wind noise from open windows or the sunroof.

Voice Control Assistance

- To hear the valid voice commands for any screen, simply say "Help."
- To repeat the instructions for how to use any screen, say "Repeat voice."
- While learning the commands, ensure that the nav volume and "Voice feedback" settings are set to ON. The feedback provides confirmation of your command and provides the best way to say the command.

Commonly Used Voice Commands

Display Commands 	Navigation Display Commands <i>Commands accepted on a map guidance screen</i> <ul style="list-style-type: none">• Display current location• Display north up• Display heading up• Display zoom in• Display zoom out• Display menu• Go home• Setup• Display or hide (choose one):<ul style="list-style-type: none">- ATM- Post office- Gas station- Grocery store- Restaurant	General Commands <i>Commands accepted on a menu and map guidance screens</i> <ul style="list-style-type: none">• Display map• Display (main) menu• Display information• Voice command help (The system reads and lists all of the commands, starting with Navigation General Commands.)• Help• Setup
Information 	General Information Commands <i>Commands accepted on the map guidance screen</i> <ul style="list-style-type: none">• How long to the destination? (after setting a destination)• How far to the destination? (after setting a destination)• Display destination map (after setting a destination)• Display entire route (after setting a destination)	
Audio 	Radio (AM/FM/XM) Commands <i>Commands accepted on most screens</i> <ul style="list-style-type: none">• Radio on/radio play• Radio off• Radio select AM/FM1/FM2/XM1/XM2• Radio # FM (# = frequency)• Radio seek (up/down)• Radio preset 1/2/3/4/5/6• XM channel # (# = 1–255)• XM preset (choose one: 1/2/3/4/5/6)	DVD or CD Commands <i>Commands accepted on most screens</i> <ul style="list-style-type: none">• CD play• CD play disc # (# = 1–6)• Play track # (# = 1–30)• Play next disc• Play previous disc• Track repeat• Disc repeat• Normal play

*** Check the owner's manual for additional information and instructions.**

Climate Control**Climate Control Commands***Commands accepted on most screens*

- Air conditioner on
- Air conditioner off
- Climate control off
- Climate control automatic
- Climate control fresh air
- Climate control recirculate
- Climate control defrost
- Rear defrost on
- Rear defrost off
- Fan speed 1/2/3/4/5/6/7
- Temperature # degrees (# = 57–87)
- Driver's temperature # degrees (# = 57–87)
- Passenger's temperature # degrees (# = 57–87)
- Temperature dual mode on
- Temperature dual mode off
- Temperature up/down
- Temperature max hot/cold

Find Nearest**Find Nearest Commands***Commands accepted on a map guidance screen*

- Find nearest (choose one):
 - Zagat restaurant
 - Gas station
 - Bank
 - Shopping
 - Honda dealer
 - Mexican restaurant
 - Tourist attraction
 - Movie theater
 - Camping

Tip: To plot a route to a specific destination using voice control, say "Display menu," then enter the address. See the following page for an example of this process.

Entering a Destination Using Voice Control

Note: Each time you enter a voice command, press and release the TALK button. When you hear a beep, say your command.

1. Say "display menu." The display changes to the **Enter Destination by** screen.
2. Say "address."



3. Say "city" (or "change state" if necessary).

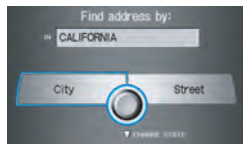

4. Say the name of the city or say "select current city."

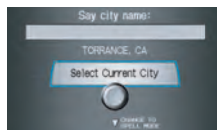

5. A list of city names appears. Say the number listed next to the desired city.
6. Say the street name. *Do not say the direction (north, south, east, or west) or type (street, avenue, etc).*
7. Say the number listed next to the name of the desired street.



8. Say the street address number as a continuous series. For example, for the address number 15200, say "one, five, two, zero, zero, done."

9. The system displays the "Calculate route to" screen. Say "OK" to display a map of the route. The plotted route appears in blue.

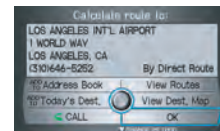

Tip: While en route, you can cancel or change your current destination or select other options by saying "display menu."



* Check the owner's manual for additional information and instructions.

Navigation/
Voice Control