



2010
Technology Reference Guide

Pilot



Information Display/MID

Information Display (models without navigation)

Consists of several displays that provide you with useful information.

Accessing Information Display

Once you start the engine, the display shows your last active display screen from the previous drive cycle.



To **toggle** between the different displays, **press** the select/reset knob repeatedly.

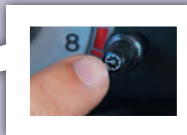

Information Displays

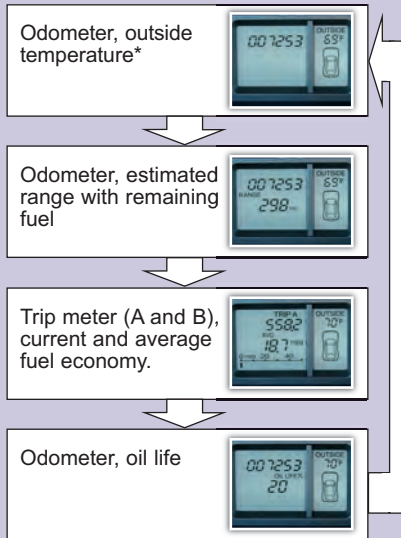

** if equipped*

2010 Pilot

Multi-Information Display (MID) (models with navigation)

Once you start the engine, the MID shows the last active display screen from the previous drive cycle.



To **toggle** between the different displays, **press** either Info button (▲/▼).



MID Main Displays

Each MID display has sub-displays, some of which can be customized.

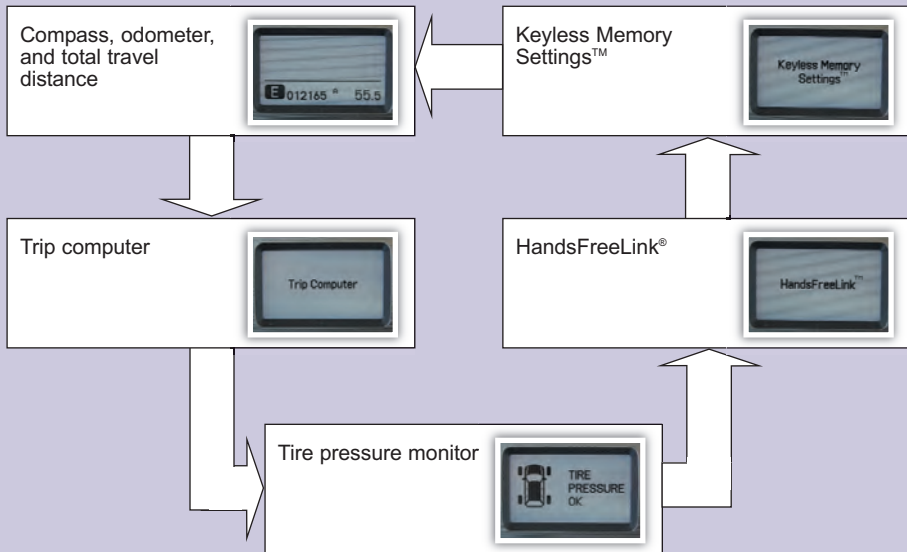

MID Sub-displays

Once a main display is selected, **press** the SEL/RESET button to access the sub-displays.

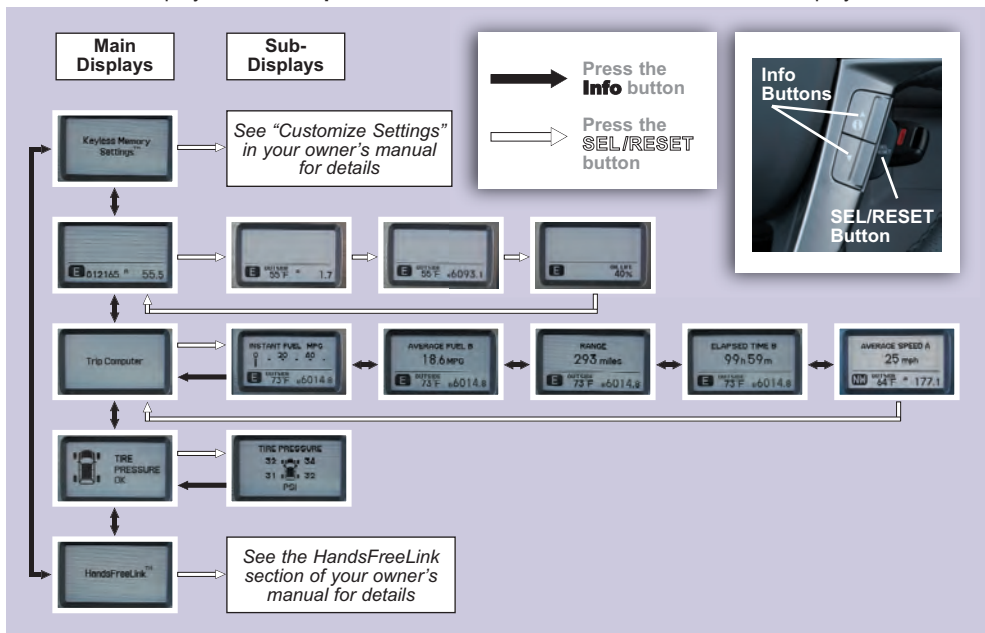

Voice Command

Using the Voice Command System

To reduce driver distraction, use voice commands for hands-free calling, navigation, audio, and climate control functions. A full list of these commands is in the navigation system manual.

HFL Talk button: Give HFL commands or answer incoming calls.

NAVI Talk button:
Give navigation, audio,
and climate control
commands.

NAVI Back button:
Cancel a command or
return to the previous
screen.

HFL Back button: End a call, go back to the previous command, or cancel an operation.



Voice Command Tips:

- Press and release the HFL or NAVI Talk button, wait for a beep, then give a command.
- For a list of available HFL commands, press and release the HFL Talk button and say "Hands-free help."
- For a list of available navigation commands, press and release the NAVI Talk button and say "Voice command help."
- Speak in a clear, natural voice.
- Reduce all background noise.
- Adjust the dashboard and side vents away from the microphone in the ceiling.
- Close the windows.

Bluetooth® HandsFreeLink® (if equipped)

Pairing Your Phone

Press and release the HFL Talk button before you give a command.

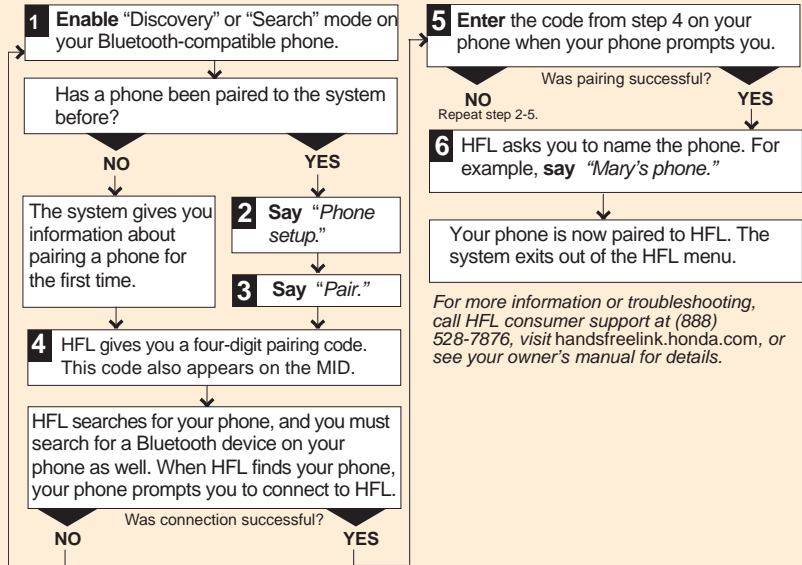

For more information or troubleshooting, call HFL consumer support at (888) 528-7876, visit handsfreelink.honda.com, or see your owner's manual for details.

Making a Call

1. **Press** the HFL Talk button.



2. **Say** "Call" or "Dial" and the desired phone number.

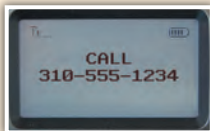

3. **Press** the HFL Talk button, and **say** "Call" or "Dial" to continue.



4. The call is connected and heard through the vehicle's speakers.



Receiving a Call

1. A notification is heard, and "INCOMING CALL" and the phone number appear on the MID.

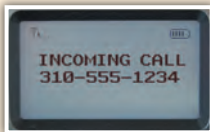

2. **Press** the HFL Talk button to accept the call.



3. **Press** the HFL Back button to end or decline the call.



Navigation (if equipped)

Entering a Destination Using Voice Commands

Press and release the NAVI Talk button before you give a command.

1 Say "Display menu."

2 Say "Address."

3 Say "City" (or "Change state" if necessary).

4 Say the name of the city you want, or say "Current city" to select the city currently shown.

5 A list of city names appears. Say the number listed next to the city you want to select.

6 Say the street name. Do not include the direction (N, S, E, W) or type (St., Ave., Blvd., etc.).

7 A list of street names appears. Say the number listed next to the street you want to select.

8 Say the entire street address number. For example, "1-2-5-0."

9 The system calculates the route and displays the "Calculate route to" screen. Say "OK" to set the route.

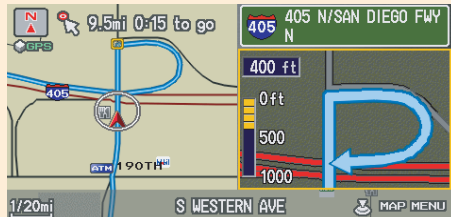

Note: Entering destinations can also be done manually with the Interface Dial from the Menu screen.

Entering a Destination Using the “Find Nearest” Command

Try these simple steps to find a nearby point of interest, such as a gas station, movie theater, restaurant, etc.

Press and release the NAVI Talk button before you give a command.

1. Say “Find nearest ATM.”



2. A list of the nearest ATMs are displayed by shortest distance to destination.

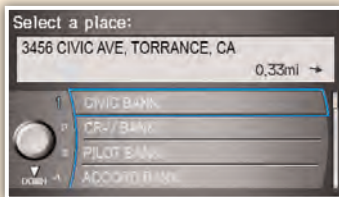

3. Say the number you want to select.

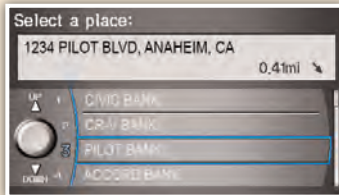

4. The system calculates the route and displays the “Calculate route to” screen.
Say “OK” to set the route.

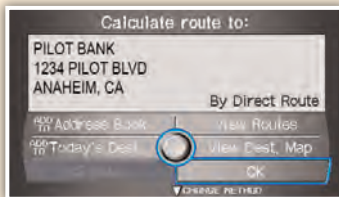

2010 Pilot

Commonly Used Voice Commands

Here are some examples of commonly used voice commands. Try some of these to familiarize yourself with the voice command system.

Press and release the NAVI Talk button before you give a command.

Look for Restaurants in Your Location

Say a command like “Display Chinese restaurants” to see restaurant icons appear on the map.



Make Audio Selections

Say a command like “Radio 97.1 FM” or “CD play track 5” to select that station or song.

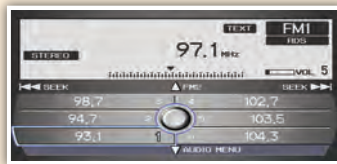

Adjust the Vehicle's Climate Setting

Say a command like “Air conditioner on” and “Fan speed 4” to adjust the setting to your liking.



Get Estimated Distance to Destination

After a destination is entered, **say** “How far to destination?” to hear the remaining distance.

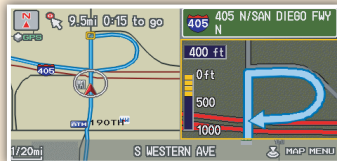

Commonly Used Voice Commands (continued)

Press and release the NAVI Talk button before you give a command.

General Commands

(Accepted on most screens to change displays)



- Display map
- Display menu
- Setup
- Information
- Display audio screen
- What time is it?

Find Place Commands

(Accepted on Map screen)

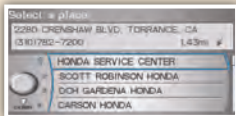

- Find nearest:
 - ATM
 - gas station
 - Mexican restaurant
 - post office
 - bank
 - Honda dealer
 - airport
 - hospital

Navigation Commands

(Accepted on Map screen after a destination is entered)



- How long/far to the destination?
- Display destination
- Display entire route

Display Commands

(Accepted on Map screen)



- Display (or hide):
 - ATM
 - gas station
 - Mexican restaurant
 - post office
- Display north up/heading up
- Zoom in/out
- Go home
- Display current location

Commonly Used Voice Commands (continued)

Press and release the NAVI Talk button before you give a command.

Audio Commands

(Accepted on most screens)



- Radio on
- Radio # FM/AM
- Radio preset 1/2/3/4/5/6
- XM channel #
- XM preset 1/2/3/4/5/6
- CD play
- CD play track/disc #
- CD skip forward/back
- Auxiliary (AUX) play

Setup Commands

(Accepted on the Setup screen)



- Brightness up/down
- Volume up/down/min/max/off
- Interface dial feedback on/off
- Guidance prompts min/max/normal

Climate Control Commands

(Accepted on most screens)



- Air conditioner on/off
- Rear defrost on/off
- Climate control recirculate/fresh air
- Fan speed up/down
- Temperature # degrees (# = 57–87)
- Temperature max hot/cold

Help Commands

(Accepted on most screens)

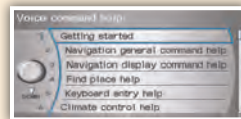

- Help (list of available commands for current screen)
- Voice command help (list of all available navigation, audio, and climate control commands)

Advanced Audio Components

Playing an iPod® or USB Flash Memory Device (models with navigation)

Some of the same controls used to operate your in-dash CD player can also operate some iPods or USB flash memory devices.

Connecting and Beginning Play

1. **Open** the center console, and **pull out** the USB adapter cable.
3. **Push** the CD/AUX button to begin playing.



2. **Connect** your USB connector to your flash drive or iPod dock connector.

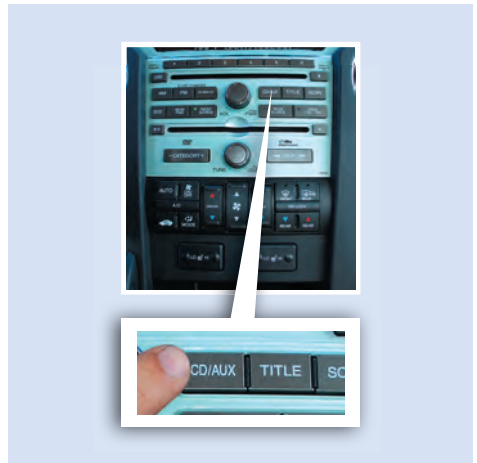

Rear Entertainment System (RES) (if equipped)

With the rear entertainment system (RES) and wireless headphones, the rear passengers can enjoy a different entertainment source than the front seat occupants.

Operating the RES from the Front Seat

1. **Press** the REAR PWR button. Rear passengers will hear audio through the wireless headphones.
2. **Press** the REAR CTRL OFF button to disable rear audio controls.
3. **Press** the REAR SOURCE button to hear what is currently playing in the rear.
4. After selecting an entertainment source for the rear passengers, **press** the FRONT SOURCE button to return to the front audio controls.



Operating the RES from the Rear Seat

1. **Press** the REAR PWR button from the front audio panel, then **press** the PWR button on the rear control panel to turn on the RES.
3. Use the (▲) (▼) (◀) (▶) buttons to navigate the menu on the display. Press the ENT button to select a function.

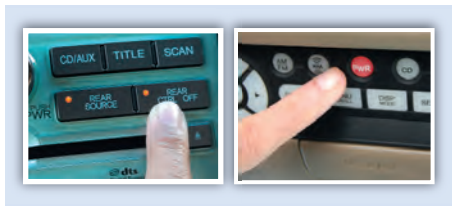

2. **Press** AM/FM, XM, CD, or DVD/AUX to make a selection.

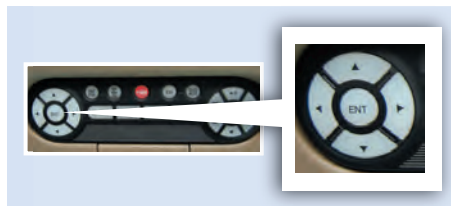
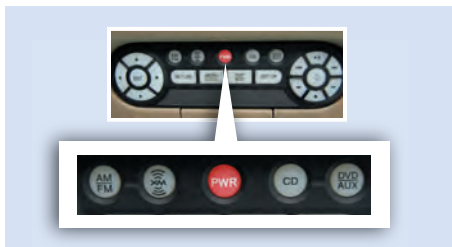

4. The rear control panel can be detached and used as a remote control. **Press** the RELEASE button to remove it from the ceiling.



2010 Pilot

Text Data Display Function (LX, EX, and EX-L)

For music CDs recorded with text data.

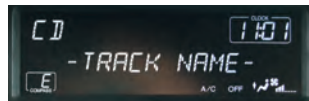

- **Press** the TITLE button to display the album, **press it again** to display the artist, and **press once more** to display the track name.
- MP3 and WMA formats also show the folder when TITLE is pressed, and the file name when pressed again.

Rearview Camera/ Parking Sensors

Rearview Camera and Monitor (EX-L and Touring models)

The display shows a view behind the vehicle.

To Turn the Camera On

1. **Shift** into Reverse (R).

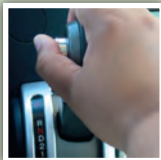

2. The rear view is shown in the display area.

EX-L models



Touring models



To Turn the Display Off

All models: **Shift** out of Reverse.

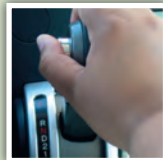

EX-L models: **Press** the monitor on/off button while in Reverse with your foot on the brake. **Press again** to turn back on.



2010 Pilot

Parking Sensor System (Touring models)

Warns you of the proximity between your vehicle and nearby surrounding objects when parking or in Reverse.

To Turn the System On and Off

Press the parking sensor button. A light appears when the system is on.



How It Works

When the system senses an object, an indicator appears in the MID and a beep sounds. As you get closer to an object, the beep rate increases.

Corner Sensors

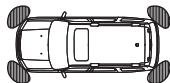

Within about 24 in. (60 cm)

Rear Center Sensors

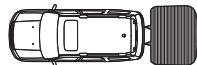

Within about 40 in. (1 m)

Corner Sensor Indicator



Rear Center Sensor Indicator



Rearview Camera/
Parking Sensors

About This Technology Reference Guide

This Technology Reference Guide has been prepared to help you get quickly acquainted with your new Honda, and to provide reference instructions on driving controls and convenience items.

However, this guide is not intended as a substitute for the Owner's Manual. For complete information on operating the vehicle safely, please refer to the Owner's Manual.

As with the Owner's Manual, this guide covers all models of the Honda Pilot. Therefore, you may find descriptions of equipment and features that are not on your particular model.

Safety Reminder

Your vehicle is equipped with airbags. Airbags do not replace your seat belts; they add to the protection offered by seat belts. Airbags can help protect you in some types of collisions, but they do not provide protection in all collisions.

Always make sure you and your passengers wear seat belts, and that young children are properly secured in a child seat or booster in the rear seat. Never place an infant seat in the front passenger's seat as the force of a deploying airbag can seriously injure an infant.

Fuel Recommendation

- Use only unleaded gasoline of 87 octane or higher.
- Some gasoline in North America contains MMT, a manganese-based fuel additive. Prolonged and consistent use of gasoline containing MMT can deteriorate your vehicle's performance, fuel economy, and the emissions control system. Always use MMT-free gasoline if alternatives exist. Failures caused by use of gasoline containing MMT may not be covered under warranty.
- For further important information on fuel and lubricants for your car and information on gasoline that does not contain MMT, contact your dealer or visit Owner Link at www.hondacars.com.

HONDA
The Power of Dreams

