



A0G02258
31S2TG00
00X31-SZT-G000

owners.honda.com (U.S.)
myhonda.ca (Canada)

2016 Honda CR-Z Owner's Guide
©2015 Honda Motor Co., Ltd. — All Rights Reserved

Printed in Japan



2016
OWNER'S GUIDE

DISCLOSURES

■ Devices That Emit Radio Waves

The following products and systems on your vehicle emit radio waves when in operation:

- Audio system
- Bluetooth® Audio
- Bluetooth® HandsFreeLink®
- Immobilizer system
- Remote transmitter
- Smart Entry system
- Tire Pressure Monitoring System

Each of the above complies with the appropriate requirements or the required standards of the FCC (Federal Communications Commission) and Industry Canada, described below:

As required by the FCC:

This device complies with Part 15 of the FCC rules. Operation is subject to the following two conditions: (1) This device may not cause harmful interference, and (2) this device must accept any interference received, including interference that may cause undesired operation.

Changes or modifications not expressly approved by the party responsible for compliance could void the user's authority to operate the equipment.

As required by Industry Canada:

This device complies with Industry Canada Standard RSS-Gen/210/251/310. Operation is subject to the following two conditions: (1) this device may not cause interference, and (2) this device must accept any interference, including interference that may cause undesired operation of the device.

■ California Perchlorate Contamination Prevention Act

The airbags, seat belt tensioners, and CR-type batteries in this vehicle may contain perchlorate materials—special handling may apply. See www.dtsc.ca.gov/hazardouswaste/perchlorate/ for more information.

■ California Proposition 65 Warning

WARNING: This product contains or emits chemicals known to the state of California to cause cancer and birth defects or other reproductive harm.

■ Event Data Recorders

This vehicle is equipped with an event data recorder (EDR). The main purpose of an EDR is to record, in certain crash or near crash-like situations, such as an air bag deployment or hitting a road obstacle, data that will assist in understanding how a vehicle's systems performed. **The EDR is designed to record data related to vehicle dynamics and safety systems for a short period of time, typically 30 seconds or less. The EDR in this vehicle is designed to record such data as:**

- **How various systems in your vehicle were operating;**
- **Whether or not the driver and passenger safety belts were buckled/fastened;**
- **How far (if at all) the driver was depressing the accelerator and/or brake pedal; and,**
- **How fast the vehicle was traveling.**

These data can help provide a better understanding of the circumstances in which crashes and injuries occur. NOTE: EDR data are recorded by your vehicle only if a non-trivial crash situation occurs; no data are recorded by the EDR under normal driving conditions and no personal data (e.g., name, gender, age, and crash location) are recorded. However, other parties, such as law enforcement, could combine the EDR data with the type of personally identifying data routinely acquired during a crash investigation.

To read data recorded by an EDR, special equipment is required, and access to the vehicle or the EDR is needed. In addition to the vehicle manufacturer, other parties such as law enforcement that have the special equipment can read the information if they have access to the vehicle or the EDR.

The data belong to the vehicle owner and may not be accessed by anyone else except as legally required or with the permission of the vehicle owner.

■ Service Diagnostic Recorders

This vehicle is equipped with service-related devices that record information about powertrain performance. The data can be used to verify emissions law requirements and/or help technicians diagnose and solve service problems. It may also be combined with data from other sources for research purposes, but it remains confidential.

INTRODUCTION

This Owner's Guide is intended to help you quickly get acquainted with your **2016 Honda CR-Z**. It provides basic information and instructions on technology and convenience features, as well as emergency procedures and how to get assistance.

This guide is for vehicles sold in the United States and Canada. It covers all CR-Z models, so you may find descriptions of features and equipment that are not in your vehicle. Images throughout this guide are from U.S. vehicles and represent features and equipment that are available on some, but not all, models.

This guide is not intended to be a substitute for the Owner's Manual. The Owner Information CD enclosed in your glove box kit includes the Owner's Manual, Navigation Manual, and vehicle and tire warranties in electronic format. This information can be viewed on a computer (PC or Mac platform) and saved or printed for your reference. You can also visit owners.honda.com (U.S.) or myhonda.ca (Canada) to view the complete and most current information.

If you are the first registered owner of your vehicle, you may request a complimentary printed copy of the Owner's Manual, Navigation Manual, or Vehicle Warranty within the first six months of vehicle purchase. To request a copy, visit owners.honda.com (U.S.) and create or log in to your account. In Canada, please request a copy from your Honda dealer.

American Honda Motor Company strives to be proactive in protecting our environment and natural resources. By using electronic delivery for a considerable portion of the information typically found in a vehicle owner's manual, we are further reducing our impact on the environment.

Honda Automobile Customer Service

Your authorized Honda dealer should be able to answer any questions you have about your vehicle. However, if you are dissatisfied with the information you receive, you can call Honda Automobile Customer Service (see page 111).

Call (800) 999-1009 (U.S.) or (888) 946-6329 (Canada)

Honda Roadside Assistance

24-hour emergency road service is available to you in the United States and Canada throughout your 3-year/36,000-mile warranty term. Services include jump starting, flat tire and lockout assistance, towing, and more (limitations apply).

Call (866) 864-5211 (U.S.) or (800) 465-7587 (Canada)

TABLE OF CONTENTS

| | | | |
|---------------------------------------|----|---|----|
| VISUAL INDEX | 1 | HondaLink™ | 43 |
| Steering Wheel and Nearby Controls... | 1 | FM/AM Radio | 44 |
| Dashboard and Other Controls | 2 | Compact Disc (CD) | 45 |
| SAFETY INFORMATION | 3 | iPod® | 46 |
| Important Safety Information | 3 | USB Flash Drive | 47 |
| Seat Belts | 5 | Bluetooth® Audio | 48 |
| Airbags..... | 8 | Pandora® | 49 |
| Child Safety | 13 | BLUETOOTH® HANDSFREELINK® | 50 |
| Safety Label Locations..... | 18 | Basic HFL Operation..... | 50 |
| Reporting Safety Defects..... | 19 | Pairing a Phone | 51 |
| INSTRUMENT PANEL | 20 | Making a Call | 52 |
| Malfunction Indicators | 20 | HondaLink® Assist..... | 53 |
| Condition Indicators | 22 | SMS Text Messaging and E-Mail* | 54 |
| On/Off Indicators | 23 | Siri® Eyes Free | 55 |
| IMA Battery Charge Level | 23 | NAVIGATION* | 56 |
| Multi-Information Display | 24 | Basic Navigation Operation | 56 |
| VEHICLE CONTROLS | 26 | Entering a Destination | 59 |
| Using the Remote Transmitter | 26 | Routing | 61 |
| Smart Entry System..... | 27 | DRIVING | 62 |
| Door Operation | 28 | Before Driving | 62 |
| Power Window Operation | 29 | Maximum Load Limit..... | 64 |
| One-Touch Turn Signal..... | 29 | Starting to Drive | 66 |
| Interior and Exterior Lights | 30 | Shifting..... | 67 |
| Wiper Operation..... | 31 | Braking | 70 |
| Adjusting the Seats | 32 | 3-Mode Drive System..... | 71 |
| Rear Cargo | 35 | Plus Sport System..... | 72 |
| Adjusting the Mirrors | 37 | Eco Assist™ System..... | 73 |
| Adjusting the Steering Wheel | 37 | Vehicle Stability Assist (VSA®), aka Electronic Stability Control (ESC) System..... | 75 |
| Climate Control System | 38 | Cruise Control | 76 |
| Seat Heaters* | 38 | LaneWatch™* | 77 |
| Setting the Clock..... | 39 | Multi-View Rear Camera..... | 78 |
| Customized Features | 39 | Refueling | 79 |
| AUDIO AND CONNECTIVITY | 40 | | |
| Basic Audio Operation..... | 40 | | |

*if equipped

VISUAL INDEX

Quickly locate items in the vehicle's interior.

Steering Wheel and Nearby Controls

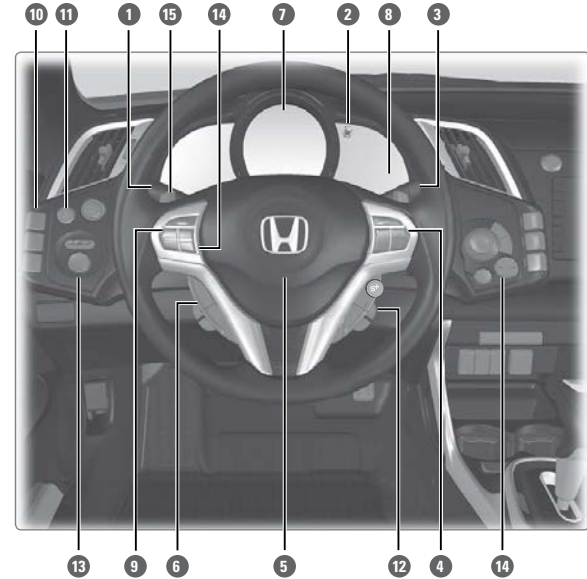

- 1 Lights/turn signals/LaneWatch button* p. 30, p. 29, p. 77
- 2 Brightness control p. 30
- 3 Wipers/washers p. 31
- 4 Cruise control buttons p. 76
- 5 Horn
- 6 Bluetooth® HandsFreeLink®/ navigation* voice recognition buttons p. 50, p. 57
- 7 Instrument panel p. 20
- 8 Multi-information display p. 24
- 9 Audio controls p. 41
- 10 3-mode drive buttons p. 71
- 11 Vehicle Stability Assist (VSA®) OFF button p. 75
- 12 Info (▲/▼) buttons p. 24
SEL/RESET button p. 24
S+ (Plus Sport) button p. 72
- 13 Door mirror controls p. 37
- 14 Climate control system p. 38
- 15 Paddle shifters* p. 68

*if equipped

*if equipped

Dashboard and Other Controls

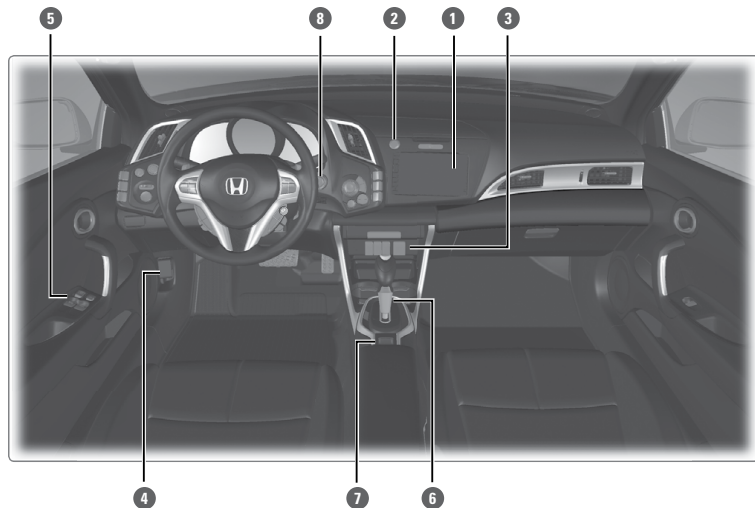

- | | |
|---|---|
| <ul style="list-style-type: none"> 1 Touchscreen p. 42 2 Hazard warning button 3 USB ports p. 40 HDMI port p. 40 Accessory power socket p. 40 4 Hood release handle p. 94 | <ul style="list-style-type: none"> 5 Power window switches p. 29 Door lock switches p. 28 6 Shift lever (CVT)* p. 67 Manual transmission* p. 69 7 Electric parking brake p. 70 8 ENGINE START/STOP button p. 66 |
|---|---|

**if equipped*

SAFETY INFORMATION

Your safety—and the safety of others—is very important, and operating this vehicle safely is an important responsibility. While we strive to help you make informed decisions about safety, it is not practical or possible to warn you about all the hazards associated with operating or maintaining your vehicle. Therefore, you must use your own good judgment.

Important Safety Information

This guide explains many of your vehicle’s safety features and how to use them. Please read this information carefully. Following the instructions below will also help to keep you and your passengers safe.

Important Safety Precautions

- Always wear your seat belt.
- Be aware of airbag hazards.
- Don’t drink and drive.
- Pay appropriate attention to the task of driving safely.
- Control your speed.
- Keep your vehicle in safe condition.

Engaging in cell phone conversation or other activities that keep you from paying close attention to the road, other vehicles, and pedestrians could lead to a crash. Remember, situations can change quickly, and only you can decide when it is safe to divert some attention away from driving.

Your vehicle is not recommended for child passengers. The National Highway Traffic Safety Administration and Transport Canada recommend that all children ages 12 and under be properly restrained in a back seat. Since this vehicle does not have a back seat, we strongly recommend that you do not carry any child who is not large enough and mature enough to ride in front.

Safety Messages

When you see the following messages throughout this guide, pay close attention.

⚠ DANGER You WILL be KILLED or SERIOUSLY HURT if you don’t follow instructions.

⚠ WARNING You CAN be KILLED or SERIOUSLY HURT if you don’t follow instructions.

⚠ CAUTION You CAN be HURT if you don’t follow instructions.

NOTICE This information is intended to help you avoid damage to your vehicle, other property, or the environment.

■ Carbon Monoxide Gas

The engine exhaust from this vehicle contains carbon monoxide, a colorless, odorless, and highly toxic gas. As long as you properly maintain your vehicle and follow the instructions set forth below, you will not accumulate dangerous levels of carbon monoxide gas in the vehicle interior.

Have the exhaust system inspected for leaks whenever:

- The exhaust system is making an unusual noise.
- The exhaust system may have been damaged.
- The vehicle is raised for an oil change.

When you operate a vehicle with the hatch open, airflow can pull exhaust gas into the interior and create a hazardous condition. If you must drive with the hatch open, open all the windows and set the climate control system as shown below.

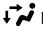
1. Select the fresh air mode.
2. Select the  mode.
3. Set the fan speed to high.
4. Set the temperature control to a comfortable setting.

Adjust the climate control system in the same manner if you sit in your parked vehicle with the engine running.

WARNING

Carbon monoxide gas is toxic. Breathing it can cause unconsciousness and even kill you.

Avoid any enclosed areas or activities that expose you to carbon monoxide.

An enclosed area such as a garage can quickly fill up with carbon monoxide gas. Do not run the engine with the garage door closed. Even when the garage door is open, drive out of the garage immediately after starting the engine.

Seat Belts

A seat belt is your best protection in all types of collisions. Airbags are designed to supplement seat belts, not replace them. So even though your vehicle is equipped with airbags, make sure you and your passengers always wear your seat belts and wear them properly.

■ Lap/Shoulder Seat Belts

Both seating positions are equipped with lap/shoulder seat belts with emergency locking retractors. In normal driving, the retractor lets you move freely while keeping some tension on the belt. During a collision or sudden stop, the retractor locks to restrain your body.

The passenger's seat belt has a lockable retractor that must be properly activated when using a forward-facing child seat, should you choose to disregard our recommendations and install one.

Both seats are equipped with automatic seat belt tensioners to enhance safety. The tensioners automatically tighten the seat belts during a moderate to severe frontal collision, sometimes even if the collision is not severe enough to inflate the front airbags.

■ Proper Use of Seat Belts

Follow these guidelines for proper use:

- All occupants should sit upright, well back in the seat, and remain in that position for the duration of the trip. Slouching and leaning reduce the effectiveness of the belt and can increase the chance of serious injury in a crash.
- Never place the shoulder part of a lap/shoulder seat belt under your arm or behind your back. This could cause very serious injuries in a crash.
- Two people should never use the same seat belt. If they do, they could be very seriously injured in a crash.
- Do not put any accessories on the seat belts. Devices intended to improve comfort or reposition the shoulder part of a seat belt can reduce the protective capability and increase the chance of serious injury in a crash.
- No one should sit in a seat with an inoperative seat belt or one that does not appear to be working correctly. Using a seat belt that is not working properly may not protect the occupant in a crash. Have a dealer check the belt as soon as possible.

WARNING

Not wearing a seat belt properly increases the chance of a serious injury or death in a crash, even though your vehicle has airbags.

Be sure you and your passenger always wear seat belts and wear them properly.

■ Seat Belt Inspection

Regularly check the condition of your seat belts as follows:

- Pull each belt out fully, and look for frays, cuts, burns, and wear.
- Check that the latches work smoothly and the belts retract easily. If a belt does not retract easily, cleaning the belt may correct the problem. Use only mild soap and warm water. Do not use bleach or cleaning solvents. Make sure the belt is completely dry before allowing it to retract.

Any belt that is not in good condition or working properly will not provide proper protection and should be replaced as soon as possible.

A belt that has been worn during a crash may not provide the same level of protection in a subsequent crash. Have your seat belts inspected by a dealer after any collision.

WARNING

Not checking or maintaining seat belts can result in serious injury or death if the seat belts do not work properly when needed.

Check your seat belts regularly and have any problem corrected as soon as possible.

■ Fastening a Seat Belt

Adjust your seat to the proper position (see page 32), and then follow the steps below.

1. Pull the seat belt out slowly.
 2. Insert the latch plate into the buckle, then tug on the belt to make sure the buckle is secure. Make sure that the belt is not twisted or caught on anything.
 3. Position the lap part of the belt as low as possible across your hips, then pull up on the shoulder part of the belt so the lap part fits snugly. This lets your strong pelvic bones take the force of a crash and reduces the chance of internal injuries.
 4. If necessary, pull up on the belt again to remove any slack, then make sure that the belt rests across the center of your chest and over your shoulder. This spreads the forces of a crash over the strongest bones in your upper body.
- To release the belt, push the red PRESS button then guide the belt by hand until it has retracted completely.

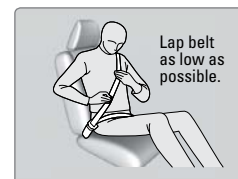
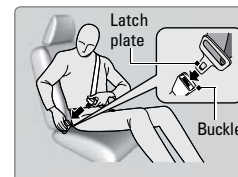

WARNING

Improperly positioning the seat belts can cause serious injury or death in a crash.

Make sure all seat belts are properly positioned before driving.

Airbags

Your vehicle is equipped with three types of airbags: front airbags, side airbags, and side curtain airbags.

■ Front Airbags (SRS)

The front SRS airbags inflate in a moderate-to-severe frontal collision to help protect the head and chest of the driver and/or passenger. They are housed in the center of the steering wheel for the driver, and in the dashboard for the passenger. Both airbags are marked **SRS AIRBAG**.

SRS (Supplemental Restraint System) indicates that the airbags are designed to supplement seat belts, not replace them. Seat belts are the occupant's primary restraint system.

■ Advanced Airbags

Your front airbags have advanced features to help reduce the likelihood of airbag-related injuries to smaller occupants.

The driver's advanced front airbag system includes a seat position sensor. If the seat is too far forward, the airbag inflates with less force, regardless of the severity of the impact.

If there is a problem with the driver's seat position sensor, the SRS indicator will come on and the airbag will inflate with full (normal) force, regardless of the driver's seating position.

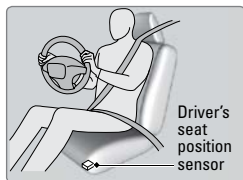

The passenger's advanced front airbag system has weight sensors. Although Honda recommends against carrying an infant or small child in the passenger seat, if the sensors detect the weight of a child (up to 65 lbs or 29 kg), the system will automatically turn off the passenger's front airbag.

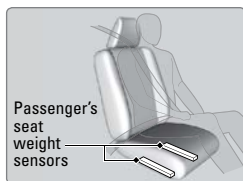

For both advanced front airbags to work properly:

- Do not spill any liquid on or under the seats.
- Do not put any object under the passenger's seat.
- Make sure any objects are positioned properly on the floor. Improperly positioned objects can interfere with the advanced airbag sensors.
- All occupants should sit upright and wear their seat belts properly.
- Do not place any cover over any part of the passenger side dashboard.

■ Side Airbags

The side airbags help protect the upper torso of the driver or a passenger during a moderate-to-severe side impact. They are housed in the outside edge of the driver's and passenger's seat-backs. Both are marked **SIDE AIRBAG**.

■ Side Curtain Airbags

Side curtain airbags help protect the heads of the driver and passenger during a moderate-to-severe side impact.

The side curtain airbags are located in the ceiling above the side windows on both sides of the vehicle.

The side curtain airbags are designed to deploy in a moderate-to-severe side impact.

To get the best protection from the side curtain airbags, occupants should wear their seat belts properly and sit upright and well back in their seats.

Do not attach any objects to the side windows or roof pillars, as they can interfere with the proper operation of the side curtain airbags.

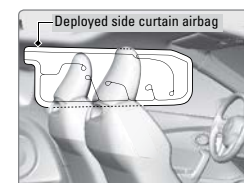

When side curtain airbags deploy in a frontal collision

One or both side curtain airbags may inflate in a moderate-to-severe angled frontal collision.

■ Airbag System Indicators

If a problem occurs in the airbag system, the SRS indicator comes on and a message appears in the multi-information display.

SRS (Supplemental Restraint System) indicator

If the indicator comes on at any other time besides vehicle start-up, or does not come on at all, have the system checked by a dealer as soon as possible. If you don't, your airbags and seat belt tensioners may not work properly when they are needed.

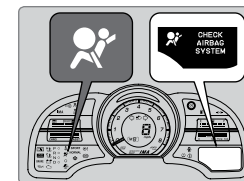

⚠ WARNING

Ignoring the SRS indicator can result in serious injury or death if the airbag systems or tensioners do not work properly.

Have your vehicle checked by a dealer as soon as possible if the SRS indicator alerts you to a possible problem.

Passenger Airbag Off indicator

The indicator comes on to alert you that the passenger's front airbag has been turned off. This occurs when the front passenger's weight sensors detect 65 lbs (29 kg) or less, the weight of an infant or small child, on the seat.

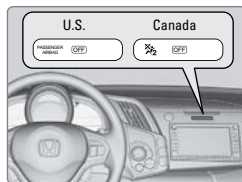

Your vehicle is not recommended for child passengers. Never put a rear-facing child seat in this vehicle.

Objects placed on the seat can also cause the indicator to come on.

If the passenger's seat is empty, the passenger's front airbag will not deploy and the indicator will not come on.

If the indicator comes on with no occupant or objects in the passenger's seat, something may be interfering with the weight sensors, such as:

- An object hanging on the seat or in the seat-back pocket.
- An object pressing against the rear of the seat-back.
- The seat or seat-back is forced back against cargo on the rear trays or floor behind it.
- An object placed under the passenger's seat.

If none of these conditions exist, have your vehicle checked by a dealer as soon as possible.

The passenger airbag off indicator may go on and off repeatedly if the total weight on the seat is near the airbag cutoff threshold.

Side Airbag Off indicator

This indicator comes on if the passenger's side airbag has been turned off because the passenger is too small to be sitting in the passenger's seat, is slouching or not sitting upright, or has leaned into the airbag's deployment path.

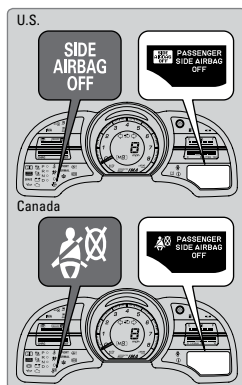

Airbag System Components

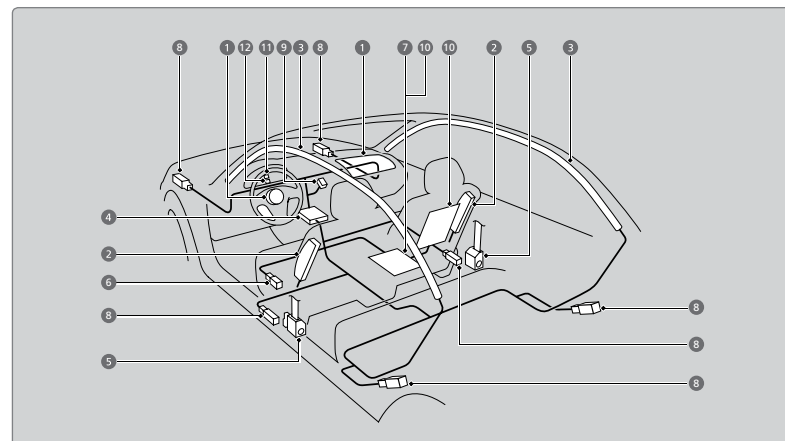

- 1 Two SRS (Supplemental Restraint System) front airbags. The driver's airbag is stored in the center of the steering wheel; the passenger's airbag is stored in the dashboard. Both are marked **SRS AIRBAG**.
- 2 Two side airbags, one for the driver and one for a passenger. The airbags are stored in the outer edges of the seat-backs. Both are marked **SIDE AIRBAG**.
- 3 Two side curtain airbags, one for each side of the vehicle. The airbags are stored in the ceiling, above the side windows. The front and rear pillars are marked **SIDE CURTAIN AIRBAG**.
- 4 An electronic control unit that continually monitors and can record information about the sensors, the airbag activators, the seat belt tensioners, and driver and passenger seat belt use when the vehicle is on.
- 5 Automatic front seat belt tensioners. The driver's and passenger's seat belts incorporate sensors that detect whether or not they are fastened.
- 6 A driver's seat position sensor. If the seat is too far forward, the airbag will inflate with less force.
- 7 Weight sensors in the passenger's seat. The passenger's airbag will be turned off if the weight on the seat is 65 lbs (29 kg) or less (the weight of an infant or small child).
- 8 Impact sensors that can detect a moderate-to-severe front or side impact.
- 9 An indicator on the dashboard that alerts you that the passenger's front airbag has been turned off.
- 10 Sensors that can detect if a child or small-statured adult is in the deployment path of the passenger's side airbag.
- 11 An indicator on the instrument panel that alerts you to a possible problem with the airbag system or seat belt tensioners.
- 12 An indicator on the instrument panel that alerts you that the passenger's side airbag has been turned off.

■ Important Facts About Your Airbags

Always wear your seat belt properly, and sit upright and as far back from the steering wheel as possible while allowing full control of the vehicle. A passenger should move their seat as far back from the dashboard as possible.

Do not place hard or sharp objects between yourself and a front airbag. Carrying hard or sharp objects on your lap, or driving with a pipe or other sharp object in your mouth, can result in injuries if your front airbag inflates.

Do not attach or place objects on the front airbag covers. Objects on the covers marked **SRS AIRBAG** could interfere with the proper operation of the airbags or be propelled inside the vehicle and hurt someone if the airbags inflate.

Do not attach accessories on or near the side airbags. They can interfere with the proper operation of the airbags, or hurt someone if an airbag inflates.

Do not attach any objects to the side windows or roof pillars. They can interfere with the proper operation of the side curtain airbags.

Do not cover or replace the front seat-back covers. This can prevent your side airbags from properly deploying during a side impact.

WARNING

An open glove box can cause serious injury to your passenger in a crash, even if the passenger is wearing the seat belt.

Always keep the glove box closed while driving.

■ Airbag Care

You do not need to, and should not, perform any maintenance on or replace any airbag system components yourself. However, you should have your vehicle inspected by a dealer in the following situations:

When the airbags have deployed

If an airbag has inflated, the control unit and other related parts must be replaced. Similarly, once an automatic seat belt tensioner has been activated, it must be replaced.

When the vehicle has been in a moderate-to-severe collision

Even if the airbags did not inflate, have your dealer inspect the following: the driver's seat position sensor, weight sensors in the passenger's seat, seat belt tensioners, and each seat belt that was worn during the crash.

Do not remove or modify a front seat without first consulting a dealer

This would likely disable the driver's seat position sensor or the weight sensors in the passenger's seat. If it is necessary to remove or modify a front seat to accommodate a person with disabilities, contact a Honda dealer. For U.S. vehicles, call Honda Automobile Customer Service at (800) 999-1009. For Canadian vehicles, call Honda Canada Customer Relations at (888) 946-6329.

Child Safety

Each year, many children are injured or killed in vehicle crashes because they are either unrestrained or not properly restrained. In fact, vehicle collisions are the number one cause of death of children ages 12 and under.

The National Highway Traffic Safety Administration and Transport Canada recommend that all children ages 12 and under be properly restrained in a rear seat. Some states or provinces/territories have laws restricting where children may ride.

To reduce the number of child deaths and injuries, every state, Canadian province and territory requires that infants and children be properly restrained when they ride in a vehicle.

Since this vehicle does not have a back seat, Honda recommends that you do not carry a child, age 12 or under, as a passenger because:

- An inflating front or side airbag can injure or kill a child sitting in the passenger's seat.
- A child in the passenger's seat is more likely to interfere with the driver's ability to safely control the vehicle.
- Statistics show that children of all sizes and ages are safer when they are properly restrained in a rear seat. Because this vehicle does not have a rear seat, we recommend that you do not carry a child age 12 or under in this vehicle.
- Any child who is too small to wear a seat belt correctly must be restrained in an approved child seat that is properly secured to the vehicle using either the lap belt portion of the lap/shoulder belt.

In addition:

- Never hold a child on your lap because it is impossible to protect them in the event of a collision.
- Never put a seat belt over yourself and a child. During a crash, the belt would likely press deep into the child and cause serious or fatal injuries.
- Never let two children use the same seat belt. Both children could be very seriously injured in a crash.
- Do not allow children to operate the doors, windows, or seat adjusters.
- Do not leave children in the vehicle unattended, especially in hot weather when the inside of the vehicle can get hot enough to kill them. They could also activate vehicle controls, causing it to move unexpectedly.

WARNING

Allowing a child to play with a seat belt or wrap one around their neck can result in serious injury or death.

Instruct children not to play with any seat belt and make sure any unused seat belt a child can reach is buckled, fully retracted, and locked.

⚠️ WARNING

Children who are unrestrained or improperly restrained can be seriously injured or killed in a crash.

Any child too small for a seat belt should be properly restrained in a child seat. A larger child should be properly restrained with a seat belt, using a booster seat if necessary.

■ Protecting Infants

An infant must be properly restrained in a rear-facing, reclining child seat until the infant reaches the seat maker's weight or height limit for the seat, and the infant is at least one year old. **Because rear-facing child seats should not be used in this vehicle, you should never carry an infant in this vehicle.**

⚠️ WARNING

Placing a rear-facing child seat in the passenger's seat can result in serious injury or death during a crash.

Never install a rear-facing child seat in this vehicle.

■ Protecting Smaller Children

If a child is at least one year old and within the weight range indicated by the child seat manufacturer, the child should be properly restrained in a firmly secured forward-facing child seat.

Since this vehicle does not have a back seat, Honda recommends that you do not carry a child, age 12 or under, as a passenger.

This is because placing a forward-facing child seat in the passenger's seat can be hazardous, even with advanced front airbags that automatically turn the passenger's front airbag off.

If you choose to ignore our warnings and transport a small child in this vehicle, be sure to move the passenger seat as far to the rear as possible, and follow the instructions and guidelines in the following pages.

⚠️ WARNING

Placing a forward-facing child seat in the passenger's seat can result in serious injury or death if the front airbag inflates.

If you must place a forward-facing child seat in the passenger's seat, move the vehicle seat as far back as possible, and properly restrain the child.

■ Selecting a Child Seat**Important considerations when selecting a child seat**

Make sure the child seat meets the following three requirements:

- The child seat is the correct type and size for the child.
- The child seat is the correct type for the seating position.
- The child seat is compliant with Federal Motor Vehicle Safety Standard 213 or Canadian Motor Vehicle Safety Standard 213.

■ Installing a Child Seat with a Lap/Shoulder Seat Belt

1. Move the passenger seat to the rearmost position.
2. Place the child seat on the passenger seat.
3. Route the seat belt through the child seat according to the seat manufacturer's instructions, and insert the latch plate into the buckle. Insert the latch plate fully until it clicks.
4. Slowly pull the shoulder part of the belt all the way out until it stops. This activates the lockable retractor.
5. Let the seat belt completely wind up into the retractor, then try to pull it out to make sure the retractor is locked. If you are able to pull the shoulder belt out, the lockable retractor is not activated. Pull the seat belt all the way out, and repeat steps 4 – 5.
6. Grab the shoulder part of the seat belt near the buckle, and pull up to remove any slack from the lap part of the belt. When doing this, place your weight on the child seat and push it into the vehicle seat.
7. Make sure the child seat is firmly secured by rocking it forward and back and side to side; little movement should be felt.

To deactivate a lockable retractor, release the buckle and allow the seat belt to wind up all the way.

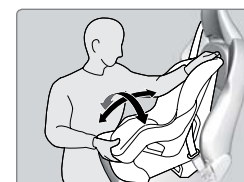

■ Adding Security with a Tether

A tether anchorage point is provided behind the passenger seat. A child seat with a tether can be installed, so long as the base of the child seat is secured using a seat belt.

1. Route the tether strap through the head restraint legs. Make sure the strap is not twisted.
2. Secure the tether strap hook onto the anchor.
3. Tighten the tether strap according to the seat manufacturer's instructions.

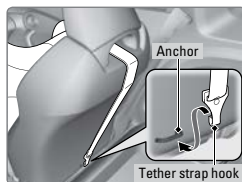
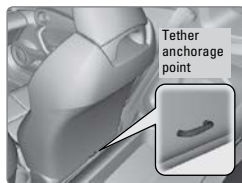

■ Protecting Larger Children

Since this vehicle does not have a back seat, Honda recommends that you do not carry a child age 12 or under as a passenger. This is because children who have outgrown child seats are also at risk of being injured or killed by an inflating passenger's front airbag. If a larger child must ride in this vehicle, the information below provides guidelines to help you decide when a given child may ride in this vehicle, and how to properly protect the child.

When a child is too big for a child seat, secure the child in the passenger's seat using the lap/shoulder seat belt.

Have the child sit upright and all the way back, then ensure the following:

- The child's knees bend comfortably over the edge of the seat.
- The shoulder belt crosses between the child's neck and arm.
- The lap part of the seat belt is as low as possible, touching the child's thighs.
- The child can stay seated for the whole trip.



If a lap/shoulder belt cannot be used properly, position the child in a booster seat in the passenger's seating position. For the child's safety, check that the child meets the booster seat manufacturer's recommendations.

Some U.S. states and Canadian provinces/territories require children to use a booster seat until they reach a given age or weight (e.g., 6 years or 60 lbs). Be sure to check current laws in the state or province/territory where you intend to drive.

⚠ WARNING

Allowing a child age 12 or under to sit in the vehicle can result in injury or death if the passenger's front airbag inflates.

If a larger child must ride in front, move the vehicle seat as far to the rear as possible, then have the child sit up properly and wear the seat belt properly, using a booster seat if needed.

Safety Label Locations

Safety labels are in the locations shown. They warn you of potential hazards that can cause serious injury or death. Read these labels carefully.

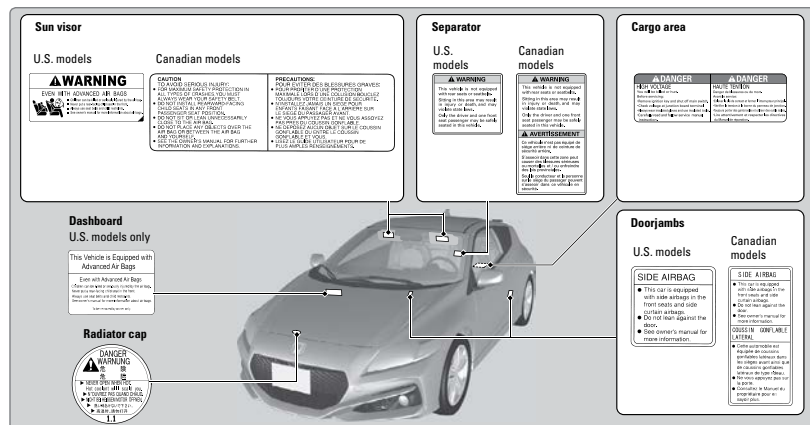

Reporting Safety Defects

In the U.S.

If you believe that your vehicle has a defect which could cause a crash or could cause injury or death, you should immediately inform the National Highway Traffic Safety Administration (NHTSA) in addition to notifying American Honda Motor Co., Inc.

If NHTSA receives similar complaints, it may open an investigation, and if it finds that a safety defect exists in a group of vehicles, it may order a recall and remedy campaign. However, NHTSA cannot become involved in individual problems between you, your dealer, or American Honda Motor Co., Inc.

To contact NHTSA, you may call the Vehicle Safety Hotline toll-free at 1-888-327-4236 (TTY: 1-800-424-9153); go to <http://www.safercar.gov>, or write to: Administrator, NHTSA, 1200 New Jersey Avenue, SE., Washington, DC 20590. You can also obtain other information about motor vehicle safety from <http://www.safercar.gov>.

In Canada

If you believe that your vehicle has a defect which could cause a crash or could cause injury or death, you should immediately inform Honda Canada, Inc., and you may also inform Transport Canada.

If Transport Canada receives similar complaints, it may open an investigation, and if it finds that a safety defect exists in a group of vehicles, it may lead to a recall and remedy campaign. However, Transport Canada cannot become involved in individual problems between you, your dealer, or Honda Canada, Inc.

To contact Transport Canada's Defect Investigations and Recalls Division, you may call 1-800-333-0510. For more information on reporting safety defects or about motor vehicle safety, go to <http://www.tc.gc.ca/roadsafety>.

INSTRUMENT PANEL

Learn about the indicators, gauges, and displays related to driving the vehicle.

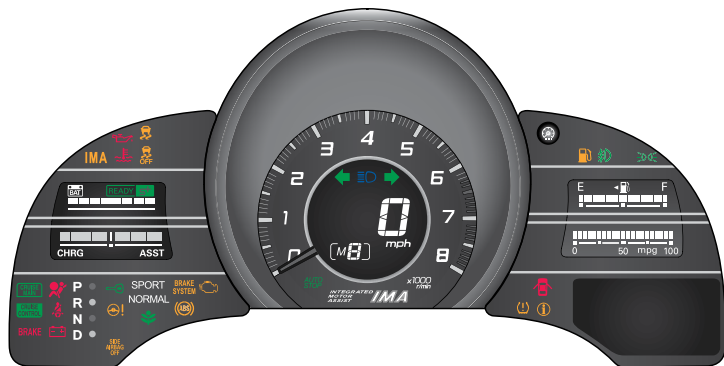

Indicators briefly appear with each engine start and then go out. Red and amber indicators are most critical. Blue and green indicators are used for general information.

Malfunction Indicators

These are the most critical indicators. If they come on and stay lit while driving or at any other time, there may be a problem. See your dealer if necessary.

Brake system

- Brake fluid is low.
- The brake system has a problem.

Press the brake pedal lightly to check pedal pressure. If normal, check the brake fluid level when you stop. If abnormal, take immediate action. If necessary, downshift the transmission to slow the vehicle using engine braking. Have your vehicle repaired immediately.

Low oil pressure

Engine oil pressure is low. Stop in a safe place. Open the hood. Check the oil level, and add oil if necessary (see page 96). If the indicator does not turn off, have your vehicle repaired immediately.

Charging system

The battery is not charging. Turn off all electrical items, but do not turn off the vehicle to prevent further battery discharge. Have your vehicle repaired immediately.

Supplemental Restraint System (SRS)

There is a problem with one of the airbag systems or seat belt tensioners.



Malfunction indicator lamp (check engine light)

The emissions control system may have a problem, or the fuel cap is loose or missing. If the indicator blinks, a misfire in the engine's cylinders is detected. Stop in a safe place, and wait for the engine to cool down.



Anti-lock Brake System (ABS)

There is a problem with the anti-lock brake system. Your vehicle still has normal braking ability, but no anti-lock function.



Tire Pressure Monitoring System (TPMS) (U.S. models only)

If the indicator blinks for one minute and then stays on, there is a problem with the system.



Vehicle Stability Assist (VSA®)

There is a problem with the VSA system or hill start assist system.



Brake system

There is a problem with a braking system component or the electric parking brake.



Electric power steering

There is a problem with the system. Stop in a safe place, and restart the vehicle.



IMA (Integrated Motor Assist)

There is a problem with the system. Avoid high speed driving and have your vehicle repaired immediately.



High temperature

The engine coolant temperature is high. Drive slowly to prevent overheating. If the indicator remains on, immediately stop the vehicle in a safe place (see page 83).



Low temperature

The engine coolant temperature is low. If the indicator remains on after the engine has reached normal operating temperature, there may be a problem with temperature sensors.

Condition Indicators

These indicators may require you to perform an action.

BRAKE Parking brake

U.S.  Release the parking brake before driving. You will hear a beep if you drive with it not fully released.

Seat belt reminder

Make sure seat belts are fastened for you and all passengers. The indicator blinks and beeps sound continuously if you or your front passenger has not fastened your seat belts when you begin driving. If the indicator remains on after seat belts are fastened, see your dealer.

Door/hatch open

A door or the hatch is open. A beep sounds if any door or the hatch is open while driving.

Low fuel

Refuel as soon as possible. If the indicator blinks, there is a problem with the fuel gauge. See your dealer.

Low tire pressure

Stop in a safe place, check tire pressures, and inflate tire(s) if necessary. If the indicator remains on after tire inflation, you need to calibrate the system (see page 85).

System message

When a condition or malfunction indicator comes on, a message also appears on the multi-information display. Check the display for more information.

Immobilizer

Your remote transmitter cannot be recognized by the vehicle. If the indicator blinks, you may not be able to start the engine. Turn the vehicle off, and then on again. If it continues to blink, there may be a problem with the system. See your dealer.

On/Off Indicators

These indicators remind you when an item is on or off.



VSA off



High beams on



VSA on (blinks)



Exterior lights on



Side airbag off



ECON mode on



CRUISE MAIN on

SPORT SPORT mode on



CRUISE CONTROL on

NORMAL NORMAL mode on



Turn signals/hazards on



AUTO STOP Auto idle stop on (blinks)



Fog lights* on



READY Plus Sport system on

IMA Battery Charge Level

The remaining battery charge level is displayed as a bar graph.

■ Electric Motor Assist

The degree to which the electric motor is assisting the engine is displayed by the ASST indicator bar.

■ Battery Charge

The degree to which the IMA battery is being charged is displayed by the CHRГ indicator bar.

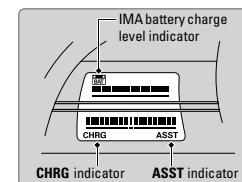

*if equipped

Multi-Information Display

Consists of several displays that provide you with useful information.

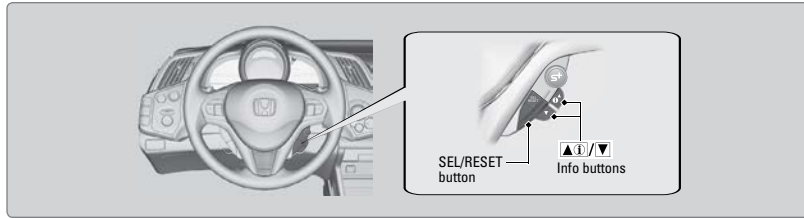

Main Displays

Press the Info (▲/▼) buttons to scroll through the main displays.

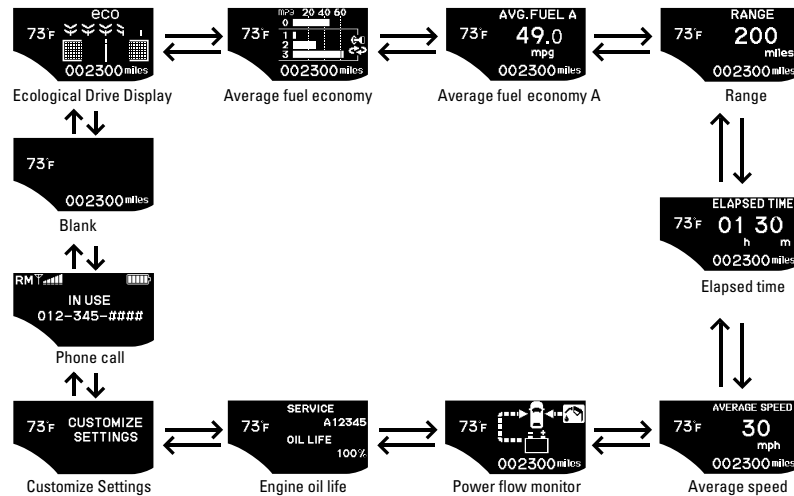

Lower Displays

Press the SEL/RESET button to scroll through the lower displays.

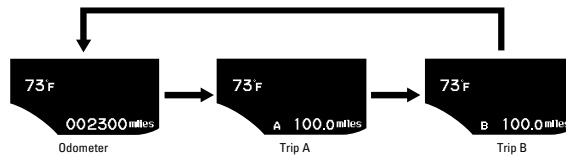

**if equipped*

Customize Settings

Use the multi-information display to customize certain features. Use the steering wheel controls to operate the menus. The vehicle must be in Park (P), or the parking brake must be applied to change settings.

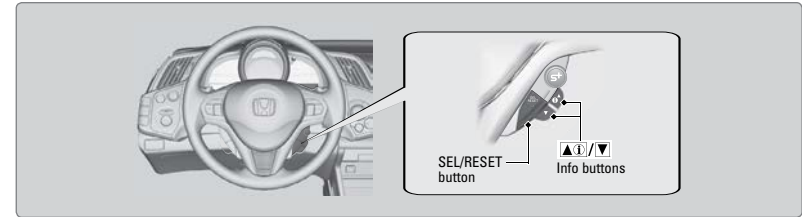

Here is an example of how to change a setting. Press the Info (▲/▼) buttons to scroll through the menu options, and the SEL/RESET button to make a selection.

1. Scroll to the CUSTOMIZE SETTINGS screen, and select it.
2. Select CHG SETTING.
3. Select METER SETUP.
4. Scroll to TRIP A RESET WITH REFUEL, and select it.
5. Scroll to ON, and select it.
6. Scroll to EXIT, and select it. Repeat until you have exited the menus.

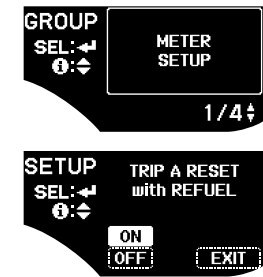

VEHICLE CONTROLS

Learn about the various controls necessary for operating and driving the vehicle.

Using the Remote Transmitter

Lock or unlock the doors and hatch.

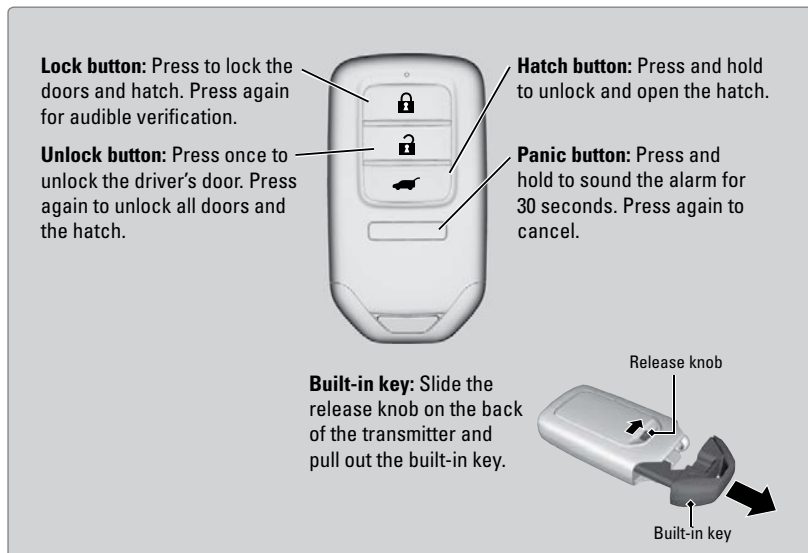

NOTICE

Leaving the key or remote transmitter in the vehicle can result in theft or accidental movement of the vehicle. Always take it with you whenever you leave the vehicle unattended.

**if equipped*

Smart Entry System

When you carry the remote transmitter (for example, in a pocket or purse) and it is outside the vehicle and within range (about 32 inches or 80 cm), you can lock or unlock the doors and hatch without handling the transmitter.

Locking/Unlocking the Doors

To lock: Press the button on the door handle when the vehicle is off to lock or unlock the driver's door. If the remote transmitter is inside the vehicle, the doors will not lock.

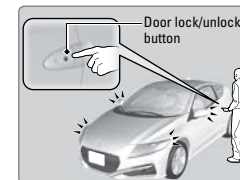

To unlock: Press and hold the button on the driver's or passenger's door to unlock both doors and the hatch.

Locking/Unlocking the Hatch

Press the lock button on the hatch to lock both doors and the hatch.

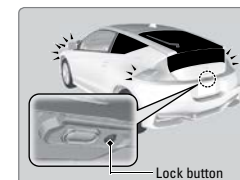

Press the hatch release button to unlock both doors and the hatch.

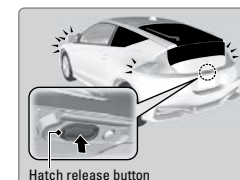

Door Operation

Use several methods to lock or unlock the doors.

■ Using the Lock Tab

To unlock: Pull the lock tab rearward. When you unlock the door using the lock tab on the driver's door, only the driver's door unlocks.

To lock: Push the lock tab forward. When you lock the door using the lock tab on the driver's door, the other door and hatch lock at the same time.

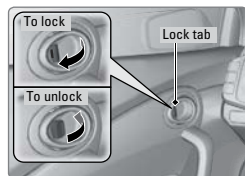

■ Using the Front Door Inner Handle

When you pull either door inner handle, the door unlocks and opens.

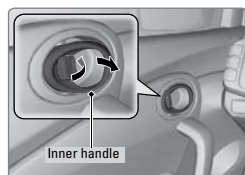

■ Using the Master Door Lock Switch

Press the master door lock switch to lock or unlock both doors and the hatch.

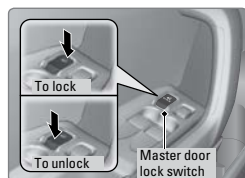

■ Hatch Operation

Press the hatch release button to unlock and open the hatch. To close the hatch, pull the hatch down using the inner handle, and push it closed from the outside.

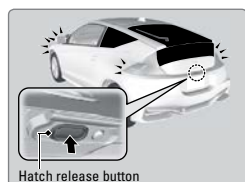

Power Window Operation

The power windows can be opened and closed when the vehicle is on by using the switches on the doors. The driver's side switches can be used to open and close both windows.

■ Automatic Operation

To open: Push the switch down firmly.

To close: Pull the switch up firmly.

The window opens or closes completely. To stop the window at any time, push or pull the switch again briefly.

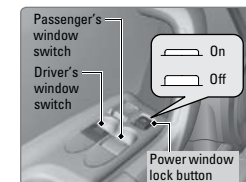

■ Manual Operation

To open: Push the switch down lightly.

To close: Pull the switch up lightly.

Release the switch when the windows reach the desired position.

■ Power Window Lock

Push in the power window lock button so only the driver's window can be operated.

⚠ WARNING

Closing a power window on someone's hands or fingers can cause serious injury.

Make sure your passengers are away from the windows before closing them.

One-Touch Turn Signal

Use this quick and convenient method to signal a lane change.

Lightly push the turn signal lever up or down for a three-blink sequence.

For a continuous signal, push the lever up or down until it locks into place.

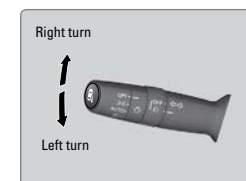

Interior and Exterior Lights

Operate interior and exterior lights when the vehicle is on or off.

Brightness Control

Adjust instrument panel brightness when the vehicle is on.

To brighten: Turn the knob to the right.

To dim: Turn the knob to the left.

A beep sounds when the brightness reaches minimum or maximum.

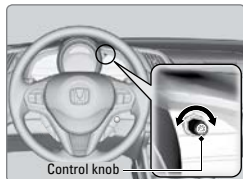

Interior Lights

Change the interior light settings using the switches on the ceiling. Each front interior map light can be turned on or off by pressing the lenses.

ON position: Interior lights remain on.

Door-activated position: Interior lights come on when either door is opened, the driver's door is unlocked, or the vehicle is turned off.

OFF position: Interior lights remain off.



Exterior Lights

Rotate the switches on the headlight lever to operate the exterior lights. Push the lever forward to turn on the high beams. Return the lever to its original position for low beams.

OFF: All exterior lights are off.

☞☞: Turn on exterior lights except headlights.

AUTO: Turn on the automatic lighting feature*. Headlights turn on or off depending on ambient brightness when the vehicle is on.

☞☞☞: Turn on all exterior lights including headlights.

☞☞☞: Turn fog lights* on or off.

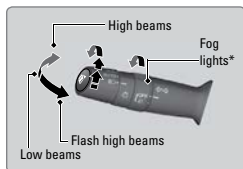

*if equipped

Wiper Operation

The windshield wipers and washers can be used when the vehicle is on.

Front Wipers

Move the wiper lever up or down to the desired position.

Rotate the intermittent time adjustment ring to adjust the wiper speed.

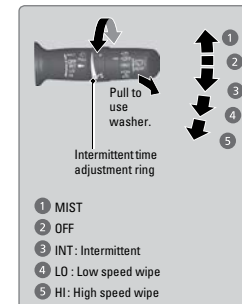

Rear Wiper

Rotate the end of the wiper lever to the desired position.

When you shift to Reverse (R) and the front wipers are activated, the rear wiper activates even if the switch is off.

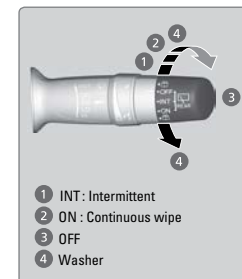

NOTICE

Do not use the wipers when the windshield is dry. The windshield will get scratched, or the rubber blades will get damaged.

In cold weather, the blades may freeze to the windshield, becoming stuck. Operating the wipers in this condition may damage the wipers. Use the defroster to warm the windshield, or manually clear the windshield of ice and snow before turning on the wipers.

Adjusting the Seats

Make seat adjustments before driving to ensure the best comfort and safety.

■ Adjusting the Front Seats

Adjust the driver's seat as far back as possible while allowing you to maintain full control of the vehicle. You should be able to sit upright and well back in the seat, adequately press the pedals without leaning forward, and grip the steering wheel comfortably. The passenger's seat should be adjusted so that it is as far back from the front airbag in the dashboard as possible.

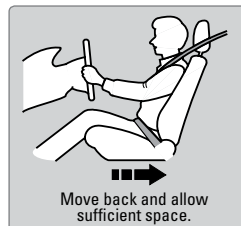

The National Highway Traffic Safety Administration and Transport Canada recommend that drivers allow at least 10 inches (25 cm) between the center of the steering wheel and the chest.

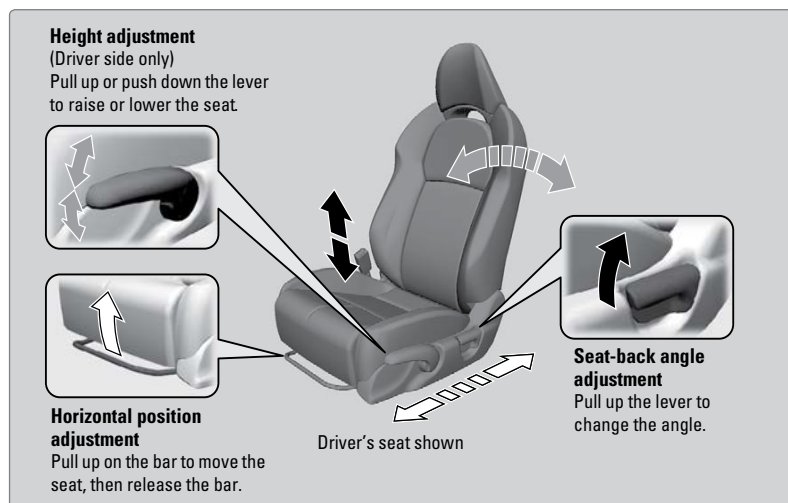

⚠ WARNING

Reclining the seat-back too far can result in serious injury or death in a crash. Adjust the seat-back to an upright position, and sit well back in the seat.

⚠ WARNING

Sitting too close to a front airbag can result in serious injury or death if the front airbags inflate.

Always sit as far back from the front airbags as possible while maintaining control of the vehicle.

⚠ WARNING

Sitting improperly or out of position can result in serious injury or death in a crash.

Always sit upright, well back in the seat, with your feet on the floor.

■ Floor Mats

Position the front seat floor mats properly, and anchor them. If they are not properly positioned, the floor mats can interfere with the front seat functions.

Do not put additional floor mats on top of the anchored mats.

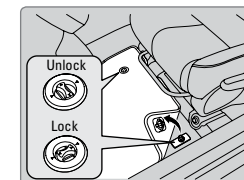

■ Head Restraints

Your vehicle is equipped with head restraints in both seating positions; however, they are non-adjustable. Head restraints are most effective for protection against whiplash and other rear-impact crash injuries. Head restraints can be removed for cleaning or repair.

The driver's and passenger's seats have active head restraints. In a rear impact, an occupant properly secured by a seat belt will be pushed against the seat-back and the head restraint will move forward. This reduces the distance between the restraint and the occupant's head, which helps reduce the likelihood of whiplash and injuries to the neck and upper spine.

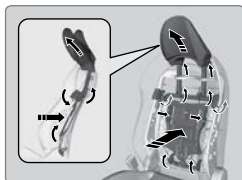

To remove a head restraint

1. Unhook the strap on the outside edge of the seat-back.
2. Pull out the strap throughout the band on the outside under edge of the head restraint.
3. Push the release button, and pull the head restraint upward.

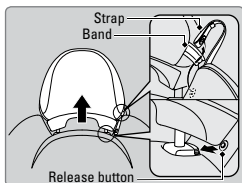

To reinstall a head restraint

1. Put the legs back in place, then slightly lower it. Do not push it down fully until it locks in place.
2. Insert the strap onto the band, then hook it to the magnet on the outside edge of the seat-back.
3. Push the head restraint down until it locks. Make sure the head restraint locks in place when you reinstall it.

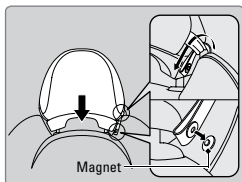

In order for the head restraint system to work properly:

- Do not hang any items on the head restraints, or from the restraint legs.
- Do not place any object between an occupant and the seat-back.
- Install each restraint in its proper location.

⚠ WARNING

Failure to reinstall, or correctly reinstall, the head restraints can result in severe injury during a crash.

Always replace the head restraints before driving.

Rear Cargo

Rear trays to store small items are located on the rear cargo console.

■ Rear Cargo Console

To access the rear cargo console, slide the seat forward by pulling up on the bar, then pull up on the seat-back adjustment lever.

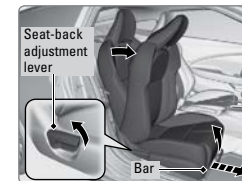

You can also pull up on the release lever on the driver's side of the seat-back to tilt the seat-back forward.



Folding down the separator creates more cargo area:

1. Remove any items from the rear trays.
2. Pull up the release handle on the top of the separator.

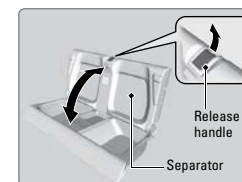

⚠ WARNING

This vehicle is not equipped with rear seats or seatbelts.

Sitting in this area may result in injury or death, and may violate state laws.

Only the driver and one passenger may be safely seated in this vehicle.

■ Cargo Cover

The cargo cover can be used to conceal your parcels and protect them from direct sunlight.

To extend the cargo cover

Pull the handle on the center edge, then clip the mounting rods in the hooks on both sides of the hatch opening.

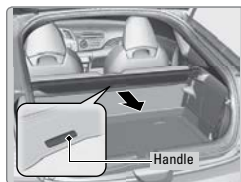

To retract the cargo cover

Slip the rods out of the hooks, then slowly roll it back until it is completely retracted.

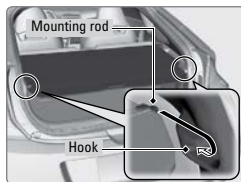

To remove the cargo cover

Push either end of the housing inward, then lift it out of its position.

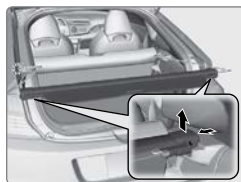

To store the cargo cover

Push one end of the unit into the hole on one side panel, then insert the other end into the hole on the other side. After storing the unit, rock it up and down to make sure it is securely placed.

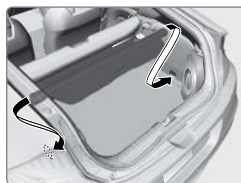

Reverse this procedure to install the housing unit in place.

To separate the cargo area into two

Pull out the cargo cover from its housing while it is stored on the cargo area floor. Clip the mounting rods in the hooks at both sides of the hatch opening.

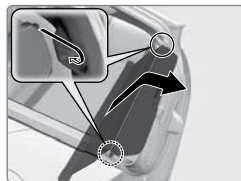

Adjusting the Mirrors

Adjust the angle of the mirrors for the best visibility when you are sitting in the correct driving position.

■ Rearview Mirror with Day/Night Positions

Manually adjust the position to reduce headlight glare from vehicles behind you. Flip the tab to switch between day and night positions.

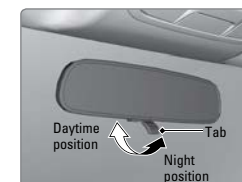

■ Power Door Mirrors

Adjust the power door mirrors when the vehicle is on.

L/R selector switch: Select the left or right mirror. After adjusting the mirror, return the switch to the center position.

Mirror position adjustment switch: Press the switch left, right, up, or down to move the mirror.

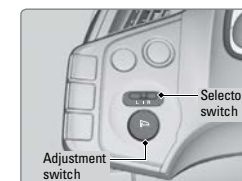

Adjusting the Steering Wheel

The steering wheel height and distance from your body can be adjusted so that you can comfortably grip the steering wheel in an appropriate driving posture.

1. Pull up the steering wheel adjustment lever.
2. Move the steering wheel up or down, and in or out.
3. Push down the steering wheel adjustment lever to lock the steering wheel in position.

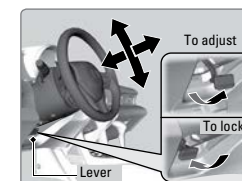

⚠ WARNING

Adjusting the steering wheel position while driving may cause you to lose control of the vehicle and be seriously injured in a crash.

Adjust the steering wheel only when the vehicle is stopped.

Climate Control System

The automatic climate control system can maintain your preferred interior temperature by selecting the proper mix of heated or cooled air and fan speed.

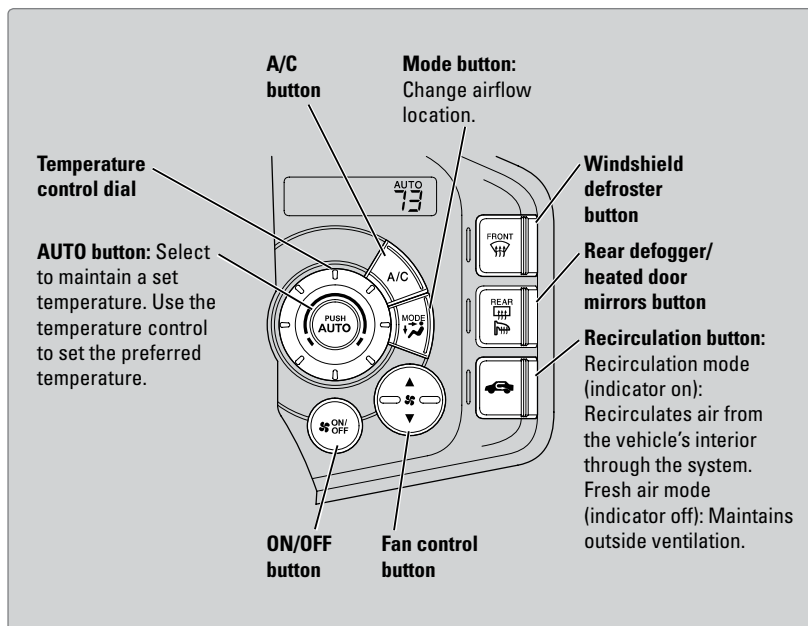

Seat Heaters*

Quickly warm the seats when the vehicle is on.

Press the switch to select the HI or LO setting. The indicator for the selected setting appears on the switch.

In the HI setting, the seat heater cycles on and off.

In the LO setting, the seat heater runs continuously and does not automatically turn off.

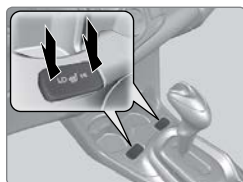

⚠ WARNING

Heat-induced burns are possible when using seat heaters.

Persons with a diminished ability to sense temperature (e.g., persons with diabetes, lower-limb nerve damage, or paralysis) or with sensitive skin should not use the seat heaters.

*if equipped

Setting the Clock

Adjust the time using the steps described below. Use the touchscreen to make selections. On vehicles with navigation, the time is automatically set using GPS signals.

1. From the HOME screen, select Settings.
2. Select Clock/Info.
3. Select Clock Adjustment.
4. Adjust the hour and minute values.
5. Select OK when complete.



Customized Features

Use the Settings menu to customize certain features when the vehicle is stopped. Use the touchscreen to make selections.

1. From the HOME screen, select Settings.
2. Select an option (Clock/Info, Audio, Bluetooth, Phone, Camera, System, or Navi*).
3. Select a setting option, and make your preferred changes.
4. Press BACK to exit the menus.

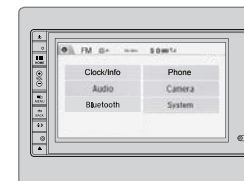

*if equipped

AUDIO AND CONNECTIVITY

Learn how to operate the vehicle's audio system.

Basic Audio Operation

Connect audio devices and operate buttons and displays for the audio system.

■ USB Ports

1. Open one of the USB covers in the front console.
2. Insert a USB flash drive or connect another audio device, such as an iPod® or iPhone®, into the USB port.

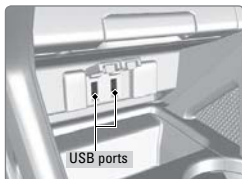

iPod and iPhone are trademarks of Apple, Inc. State, provincial, or local laws may prohibit the operation of handheld electronic devices while operating a vehicle.

■ Accessory Power Socket

Open the socket cover in the front console to use power when the vehicle is on.

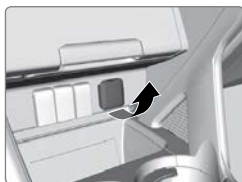

NOTICE

Do not insert an automotive type cigarette lighter element. This can overheat the power socket.

■ HDMI Port

You can play video from a compatible device while your vehicle is stopped. From the connected device, launch the video you want to display on the touchscreen. The device or video resolution must be 720p or lower to view.

1. Open the HDMI cover in the front console.
2. Insert an HDMI cable into the HDMI port.

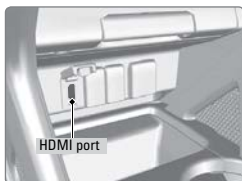

Additional cables and connectors sold separately.

■ Steering Wheel Controls

You can operate certain functions of the audio system using the steering wheel controls.

MODE button: Cycle through available audio modes.

VOL (▲/▼) buttons: Adjust audio volume.

CH (+/-) buttons: Change presets, tracks, albums, or folders.

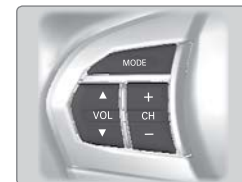

FM/AM Radio

Press (+) or (-) for the next or previous station.

Press and hold (+) or (-) for the next or previous strong station.

CD/iPod®/USB/Bluetooth® Audio

Press (+) or (-) for the next or previous track.

Press and hold (+) or (-) for the next or previous folder (CD/USB).

Pandora® (U.S. only)

Press (+) for the next song.

Press and hold (+) or (-) for the next or previous station.

■ Adjusting the Sound

Adjust various sound settings. Use the touchscreen to make selections.

1. From the HOME screen, select Settings.
2. Select Audio.
3. Select Sound.
4. Select the tabs to change the sound mode and adjust the setting.
5. Select OK when complete.

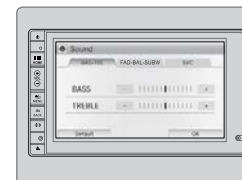

Touchscreen Operation

Use simple gestures—including touching, swiping, and scrolling—to operate certain audio functions.

Some items may be grayed out during driving to reduce the potential for distraction. You can select them when the vehicle is stopped or use voice commands*.

Wearing gloves may limit or prevent touchscreen response.

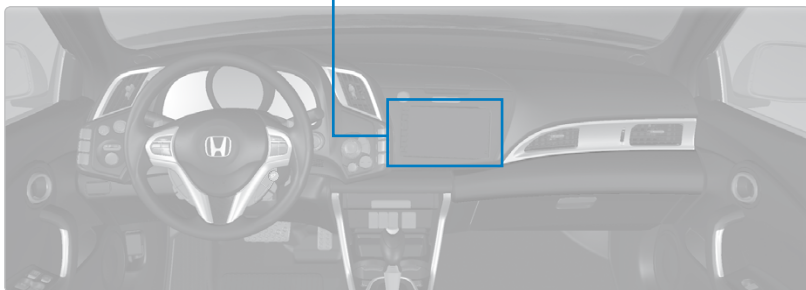
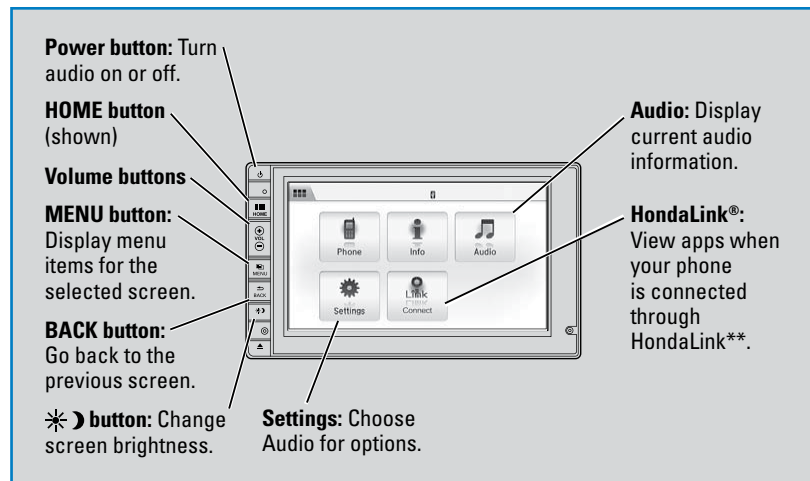

Changing Icon Order

You can change the order of the icons on the HOME screen.

1. From the HOME screen, select Settings.
2. Select System.
3. Select Home.
4. Select Home Screen Edit Order.
5. Select and hold the icon you want to move and slide it to a different position.

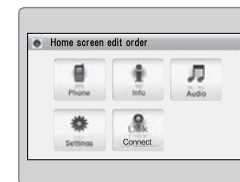

HondaLink®

You can connect a compatible smartphone to the audio system to enable integration between the smartphone's approved apps and the vehicle. This allows you to control the phone's apps through the touchscreen.

To check smartphone compatibility and connection instructions, visit handsfreelink.com (U.S.) or handsfreelink.ca (Canada).

To get more information on HondaLink features and apps, visit www.hondalink.com (U.S.) or honda.ca/handsfreelink (Canada).

*if equipped

**HondaLink can be accessed only if the app is installed on your smartphone, and the phone is connected to the system (see page 43).

FM/AM Radio

Play FM or AM radio stations.

Source: Select the FM or AM icon.

Scan: Scan for each station with a strong signal.

Tune: Change the station.

Presets: Select and hold a preset number to store the current station. Select a preset number to select a previously stored station.

Open/close: Display or hide the station list or preset list.

Seek: Search for the next or previous station with a strong signal.

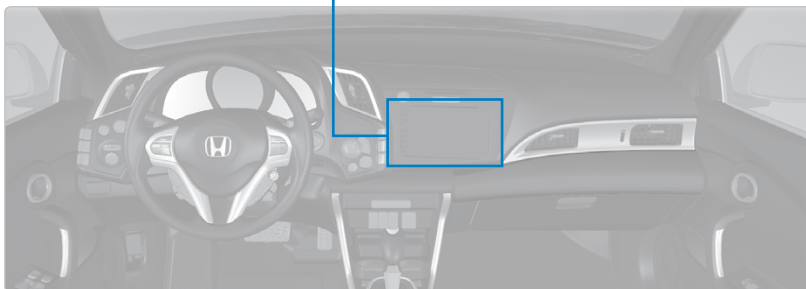

Compact Disc (CD)

The audio system supports audio CDs, CD-Rs, and CD-RWs in MP3, WMA, or AAC formats. Press the eject/close button to fold down the screen and insert a disc. Press it again to return the screen to its original position

Source: Select the CD icon.

CD eject/close button

Folder: Change the folder.

Track: Change the track.

Open/close: Display or hide the track list.

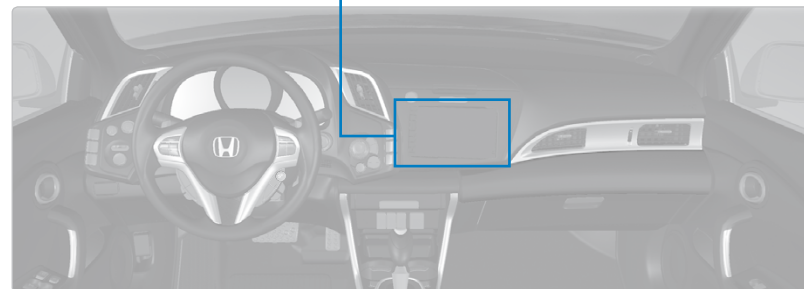

NOTICE

Do not use CDs with adhesive labels or insert a damaged CD. Inserting these types of CDs may cause them to get stuck or damage the audio unit.

TABLE OF CONTENTS

VISUAL INDEX

SAFETY INFORMATION

INSTRUMENT PANEL

VEHICLE CONTROLS

AUDIO AND CONNECTIVITY

BLUETOOTH® HANDSFREELINK®

HONDALINK®

NAVIGATION

DRIVING

HANDLING THE UNEXPECTED

MAINTENANCE

SPECIFICATIONS

CUSTOMER INFORMATION

VOICE COMMAND INDEX

INDEX

iPod®

Play and operate an iPod through the vehicle's audio system. Connect your device to the USB port (see page 40).

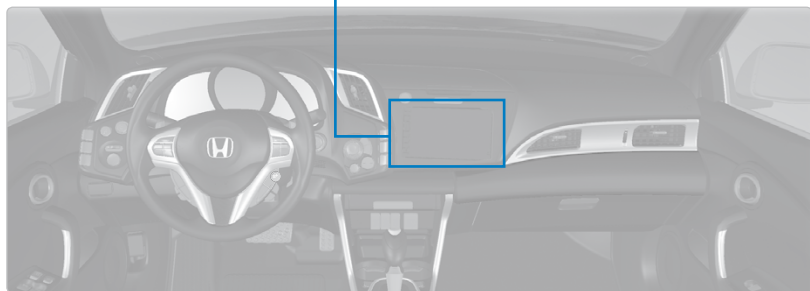
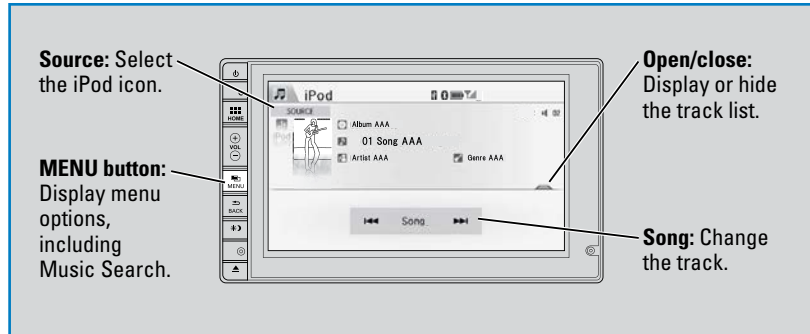

■ Searching for Music

Use the touchscreen to search for tracks stored on the iPod.

1. From the audio screen, press the MENU button.
2. Select Music Search.
3. Select a search option.
4. Select the track you want to play.

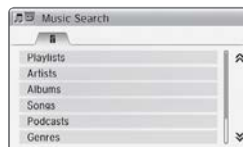

On vehicles with navigation, you can also search for and play iPod music using Song By Voice™ (see page 117).

USB Flash Drive

Play and operate a USB flash drive through the vehicle's audio system. Connect your device to the USB port (see page 40).

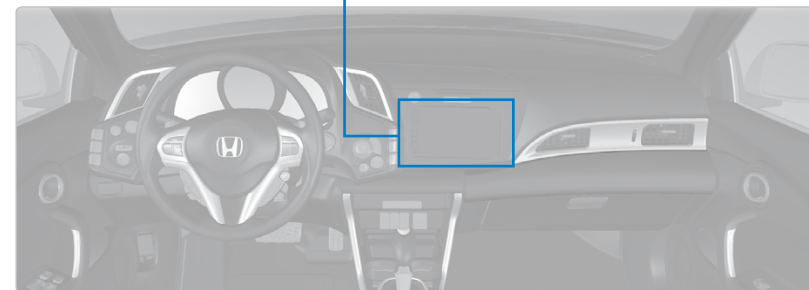
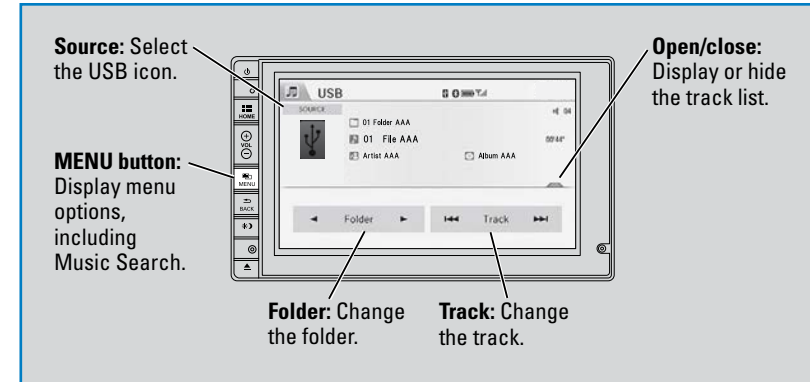

■ Searching for Music

Use the touchscreen to search for tracks stored on the USB flash drive.

1. From the audio screen, press the MENU button.
2. Select Music Search.
3. Select a folder.
4. Select the track you want to play.



On vehicles with navigation, you can also search for and play USB music using Song By Voice™ (see page 117).

Bluetooth® Audio

Play streaming or stored audio from your compatible phone through the vehicle's audio system. Visit handsfreelink.com (U.S.) or handsfreelink.ca (Canada) to check phone compatibility. Standard data rates apply with your phone service provider. Connect your phone to **Bluetooth® HandsFreeLink®** (see page 51).

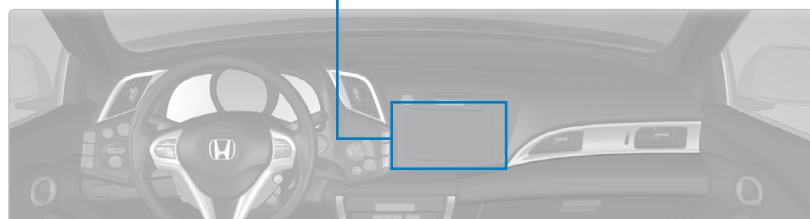
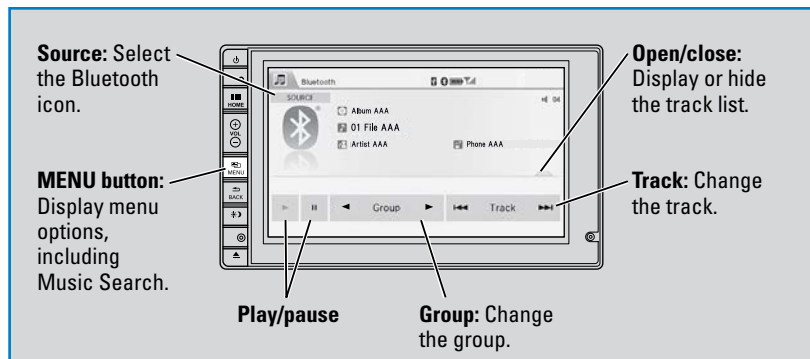

■ Searching for Music

Use the touchscreen to search for tracks stored on the device.

1. From the audio screen, press the MENU button.
2. Select Music Search.
3. Select a search category.
4. Select the track you want to play.



Notes:

- Make sure the volume on your phone is properly adjusted.
- You may need to enable additional settings on your phone for playback.
- The resume/pause function and remote audio controls are not supported on all phones.

State, provincial, or local laws may prohibit the operation of handheld electronic devices while operating a vehicle. Only launch streaming audio on your phone when it is safe to do so.

Pandora®

Play and operate Pandora from your compatible phone through the vehicle's audio system. Visit handsfreelink.com to check phone compatibility. Standard data rates apply with your phone service provider. **Available in the U.S. only.**

Connect your phone when the vehicle is stopped.

For iPhone:

- Connect via **Bluetooth® HandsFreeLink®** (see page 51) or USB port (see page 40).
- A pop-up may appear on your phone requesting you to allow access for Pandora to be launched.
- If you cannot operate Pandora through the audio system, it may be streaming through **Bluetooth® Audio**. Make sure Pandora is selected on the audio system.
- If Pandora still does not operate, try rebooting the phone and reconnecting the cable if necessary.

For other compatible smartphones:

- Connect via **Bluetooth® HandsFreeLink®** (see page 51).

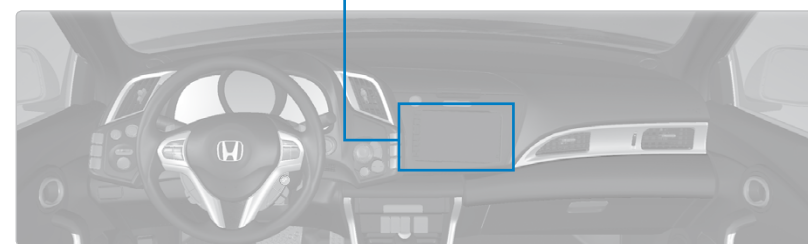
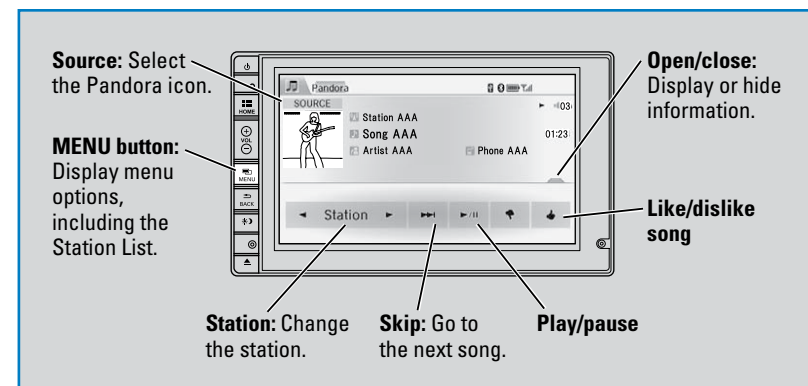

State, provincial, or local laws may prohibit the operation of handheld electronic devices while operating a vehicle. Only launch streaming audio on your phone when it is safe to do so.

BLUETOOTH® HANDSFREELINK® (HFL)

Learn how to operate the vehicle's hands-free calling system.

Basic HFL Operation

Make and receive phone calls using the vehicle's audio system, without handling your phone. Visit handsfreelink.com (U.S.) or handsfreelink.ca (Canada) to check phone compatibility.

To reduce the potential for driver distraction, certain manual functions may be inoperable or grayed out while the vehicle is moving. Stop or pull over to perform the function. Voice commands are also available.

HFL Controls

Use the controls to enter information and make selections.

Pick-Up button: Go to the Phone screen, or answer an incoming call.

Talk button: Make a call using a stored voice tag, phonebook name, or number, or say voice commands*.

Hang-Up/Back button: End or decline a call, or cancel an operation.

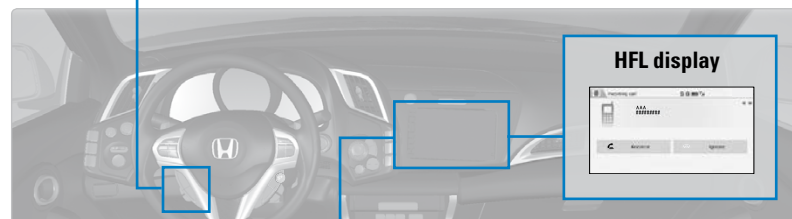

MENU button: From the phone screen, select various call options.

BACK: Go back to the previous display.

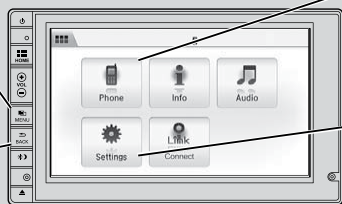

Phone: From the HOME screen, select Phone to display the Phone screen.

Settings: Select Phone from the Settings screen for phone pairing and more.

*vehicles with navigation

Talk Button Tips

For a list of available phone commands, see page 117.

- When using the Talk button, wait until you hear a beep before speaking.
- To bypass the system prompts, simply press the Talk button again to say your command.*
- When the Talk button is pressed, all available voice commands are highlighted in yellow.*
- Speak in a clear, natural voice.
- Reduce all background noise.
- Close the windows.

Pairing a Phone

To use hands-free phone and streaming audio functions, you must first pair your phone to the system. This can only be done when the vehicle is stopped. Use the touchscreen to make and enter selections.

1. From the HOME screen, select Settings.
2. Select Phone.
3. Select Bluetooth Device List.
4. Select Add Bluetooth Device.
5. Make sure your phone is in discovery mode. Select Continue.
6. The system searches for your phone. Select your phone when it appears on the list.
If your phone does not appear: Select Phone Not Found and search for HandsFreeLink from your phone. Connect to HFL.
7. The system gives you a pairing code. Compare it to the code that appears on your phone. Connect to HFL from your phone.
8. The system asks if you want to enable options:
HondaLink Assist: Select On to enable emergency collision notification (see page 53).
Automatic Phone Sync: Select On to automatically import contacts and call history from your phone.
9. Press the BACK button to exit the menu.



State, provincial, or local laws may prohibit the operation of handheld electronic devices while operating a vehicle.

*vehicles with navigation

Making a Call

You can make a call using several methods.

Dialing a Number

Enter a 10-digit phone number to call.

Using voice commands

Press the Talk button and say “Call” and the phone number. For example, “Call 3-1-0-5-5-5-1-2-3-4.” The system begins the call.



Using the touchscreen

Manual operation is limited while the vehicle is moving. Voice commands are always available.

1. From the HOME screen, select Phone.
2. Press the MENU button.
3. Select Dial.
4. Enter the phone number. Select the green phone icon to call.

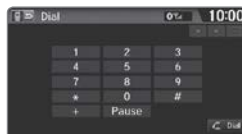

Using the Phonebook

When your phone is paired, its entire phonebook can be automatically imported to the system. Automatic Phone Sync must be turned on.

Using voice commands

Press the Talk button and say “Call” and the phonebook name and type. For example, “Call John Smith mobile.” The system begins the call.



Using the touchscreen

Manual operation is limited while the vehicle is moving. Voice commands are always available.

1. From the HOME screen, select Phone.
2. Press the MENU button.
3. Select Phonebook.
4. Scroll through the list to find the name and number you want to call, and select it to call.



Storing Speed Dial Entries

Store up to 20 numbers for quick dialing.

1. From the HOME screen, select Phone.
2. Press the MENU button.
3. Select Speed Dial, then select New Entry.
4. Select an entry method.
5. If desired, you can create a voice tag for the number. Follow the prompts.



Using Speed Dial

Make calls quickly using stored speed dial entries.

Using voice commands

Press the Talk button and say “Call” and the stored voice tag name. For example, “Call John Smith.”



Using the touchscreen

1. From the HOME screen, select Phone.
2. Scroll through the list to find the entry you want to call, and select it to call.



HondaLink® Assist

If your vehicle’s airbags deploy or if the unit detects that the vehicle is severely impacted, your vehicle automatically attempts to connect to an operator. Your phone must be paired to the system and have good cellular connection. Visit www.hondalink.com (U.S.) or honda.ca/hondalinkassist (Canada) for more information.

1. Make sure your phone is on and paired to Bluetooth® HandsFreeLink® (see page 51).
2. Select Call Now, or the system automatically connects after 10 seconds. The vehicle information and its position are sent to the operator.
3. Select Talk Now to immediately talk to the operator.
4. When the call is complete, select Hang Up or press the Hang-Up/Back button on the steering wheel.



SMS Text Messaging and E-Mail*

Receive and send messages from your paired and connected phone. Visit handsfreelink.com (U.S.) or handsfreelink.ca (Canada) to check phone compatibility. Standard message rates apply with your phone service provider. This feature is limited while the vehicle is moving.

Receiving and Responding to Messages

When you receive a new message, a pop-up appears on the touchscreen. You can view the message when the vehicle is stopped. You can also reply to it using fixed phrases or call the sender.

1. When the prompt appears, select Read.
2. The message is displayed, and the system reads it aloud.

To reply: With the message open, select Reply, and choose one of the six available responses. Select Send to send the message. You cannot create a new text message.

To call the sender: With the message open, select Dial.



Selecting an Account

If your phone has both text message and e-mail accounts, you can select only one of them at a time to be active and receive notifications.

1. From the HOME screen, select Settings.
2. Select Phone.
3. Select Select Account.
4. Select Text Message or an e-mail account.

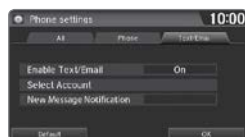

*if equipped

Siri® Eyes Free

Activate Siri through your vehicle when an iPhone® is paired to the system. Visit handsfreelink.com (U.S.) or handsfreelink.ca (Canada) to check phone compatibility.

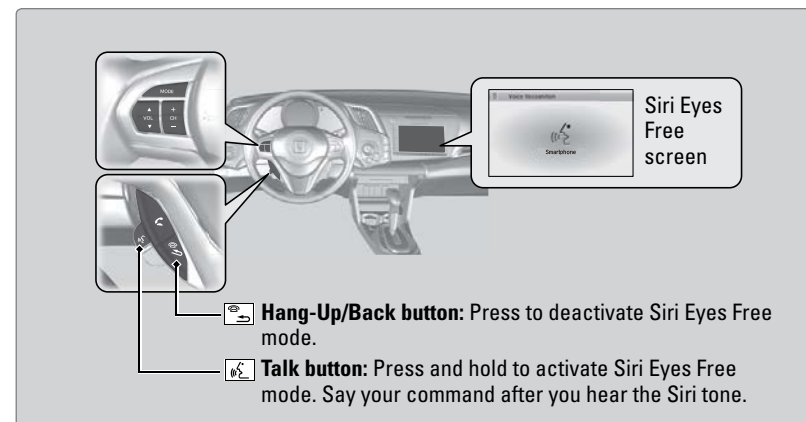

Here are some examples of Siri commands:

- | | |
|---|---|
| <i>"Call John Smith"</i> | <i>"Remind me to pick up dinner"</i> |
| <i>"Read my new text message"</i> | <i>"Set up a meeting today at 3 p.m."</i> |
| <i>"Find a nearby sushi restaurant"</i> | <i>"Play song XYZ"</i> |

Notes:

- Any requests that include visual feedback from Siri on your phone are not displayed in the vehicle.
- Certain commands rely on the iPhone's features and existing apps.
- To hear turn-by-turn directions or songs through the vehicle, set the audio source to *Bluetooth®* Audio.

Siri and iPhone are trademarks of Apple, Inc.

NAVIGATION*

Learn how to enter a destination and operate the navigation system.

Basic Navigation Operation

A real-time navigation system uses GPS and a map database to show your current location and help guide you to a desired destination. You can operate the system using voice commands or the touchscreen.

To reduce the potential for driver distraction, certain manual functions may be inoperable or grayed out while the vehicle is moving. Voice commands are always available.

Steering Wheel Controls

Use the steering wheel controls to control the system.

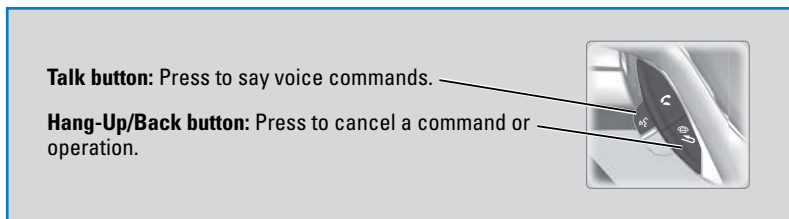

⚠ WARNING

Using the navigation system while driving can take your attention away from the road, causing a crash in which you could be seriously injured or killed. Operate system controls only when the conditions permit you to safely do so.

Navigation Display and Controls

Use the touchscreen to enter information and make selections.

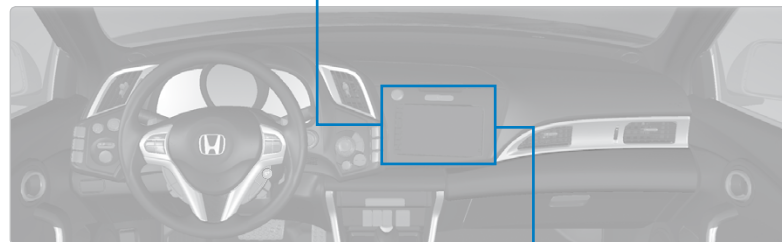
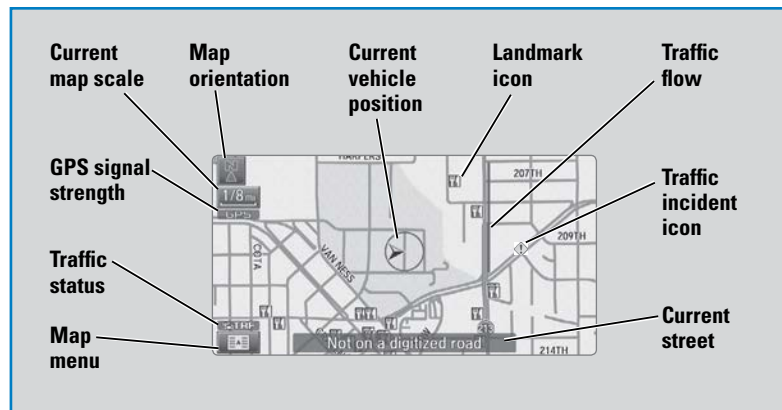

HOME button (screen shown)

MENU button: From the map screen, select various destination options.

BACK button: Go back to the previous display.

Navi: Display the map screen.

Info: Select items such as trip computer, traffic incidents, and more.

Settings: Select Navi from the Settings screen for map and navigation options.

*if equipped

Voice Prompt Volume

Adjust volume for navigation and voice command confirmation. This does not affect audio or *Bluetooth*® HandsFreeLink® volume, which is controlled by the volume buttons.

1. From the HOME screen, select Settings.
2. Select System.
3. Select Volume.
4. Adjust the level.
5. Select OK when complete.



Voice Prompt

Turn the voice feedback feature on or off.

1. From the HOME screen, select Settings.
2. Select System.
3. Select Voice Prompt.
4. Select On or Off.

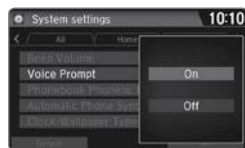

Talk Button Tips

For a full list of navigation commands, see page 113.

- When using the Talk button, wait until you hear a beep before speaking.
- To bypass the system prompts, simply press the Talk button again to say your command.
- When the Talk button is pressed, all available voice commands are highlighted in yellow.
- Speak in a clear, natural voice.
- Reduce all background noise.
- Close the windows.

Entering a Destination

Use multiple methods to enter a destination.

Home Address

Store your home address in the system so you can easily route to it.

1. From the HOME screen, select Settings.
2. Select Navigation.
3. Select Edit Go Home (1 or 2).
4. Enter the address, and select OK when complete.



When your home address is stored, you can press the Talk button and say “Go home” at any time. You can also select Go home from the navigation menu.

Street Address

Enter a street address using voice commands. Press the Talk button before saying each command.

You can also enter the address manually when the vehicle is stopped. From the map screen, press the MENU button and select Address. Follow the prompts.

U.S. models

1. From the Voice Portal screen, say “Address.”
2. The system prompts you to say the entire address. For example, say “1-2-3-4 Main Street, Los Angeles, California.”
3. The system interprets the address by state, city, street, and address number. If necessary, you may have to clarify similar matches.
4. Say “Set as destination” to set the route.

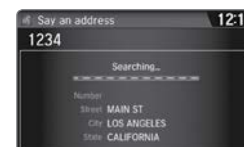
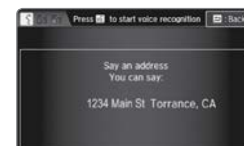

Canadian models

From the Voice Portal screen, say “Address.” Follow the prompts.

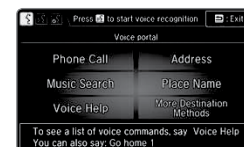

Place Name

Enter a destination or point of interest using voice commands. Press the Talk button before saying each command.

You can also enter the place name manually when the vehicle is stopped. From the map screen, press the MENU button and select Place Name. Follow the prompts.

1. From the Voice Portal screen, say "Place name."
2. Say a category, for example "ATM/Bank."
3. Say the name of the place, for example "ABC Bank."
4. The system interprets the name. If necessary, you may have to clarify similar matches.
5. Say "Set as destination" to set the route.

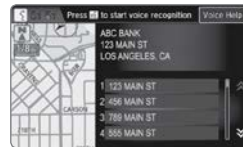

Find Nearest Place

Enter a destination by category and distance using voice commands. Press the Talk button before saying each command.

1. Say "Find nearest" and a place. For example, "Find nearest ATM."
2. A list of the nearest places in your area is displayed by shortest distance to destination.
3. Say the number next to the destination you want to select.
4. Say "Set as destination" to set the route.



Routing

After a destination is set, you can alter or cancel your route.

Map Legend

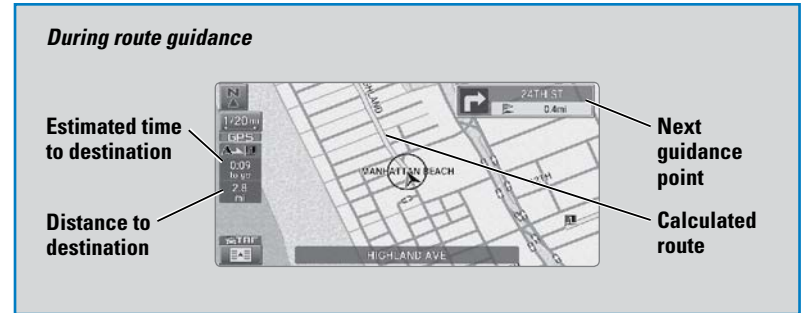

Taking a Detour

You can calculate a detour route manually if you encounter a road closure.

1. When en route, press the MENU button from the map screen.
2. Select Detour. The system attempts to calculate a new route by avoiding the next 5 miles (8 km) while on a freeway or 1 mile (1 km) while on a surface street.



Traffic

View traffic flow, incidents, and construction in major metro areas. You can also route around congestion or incidents using voice commands. Press the Talk button before saying each command. **Available on U.S. models only.**

1. When en route, say "Display traffic incidents." A list of incidents on your route appears.
2. Say the number of the incident you want to avoid.
3. Say "Avoid" and the incident list returns.
4. Say "Recalculate route" to set the new route.



Canceling Your Route

You can cancel your route at any time.

1. When en route, press the MENU button from the map screen.
2. Select Cancel Route. The route is cleared and the map screen returns. You can also press the Talk button and say "Cancel route."

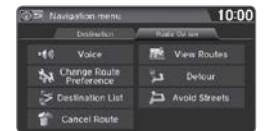

DRIVING

Learn about preparation for driving, as well as other features.

Before Driving

Check the following items before you begin driving.

■ Exterior Checks

- Make sure there are no obstructions on the windows, door mirrors, exterior lights, or other parts of the vehicle.
- Remove any frost, snow, or ice.
- Make sure the hood is securely closed.
- Heat from the engine and exhaust can ignite flammable materials left under the hood, causing a fire. If you've parked your vehicle for an extended period, inspect and remove any debris that may have collected, such as dried grass and leaves that have fallen or have been carried in for use as a nest by a small animal. Also check under the hood for leftover flammable materials after you or someone else has performed maintenance on your vehicle.
- Make sure the tires are in good condition.
- Make sure there are no people or objects behind or around the vehicle.

NOTICE

If the doors are frozen shut, use warm water around the door edges to melt any ice. Do not try to force them open, as this can damage the rubber trim around the doors. When done, wipe dry to avoid further freezing.

■ Interior Checks

- Store or secure all items on board properly.
- Do not pile items in the cargo area higher than the seat-back height.
- Do not place anything in the front seat footwells. Make sure to secure the floor mats.
- If you have any animals on board, do not let them move freely around in the vehicle.
- Securely close and lock both doors and the hatch.
- Adjust your seating position, mirrors, and steering wheel properly.
- Make sure items placed on the floor behind the seats cannot roll under the seats.
- Everyone in the vehicle must fasten their seat belt.
- Make sure that the indicators in the instrument panel come on when you start the vehicle, and go off soon after.

In addition:

- During the first 600 miles (1,000 km) of operation, avoid sudden acceleration or full throttle operation so as not to damage the engine or powertrain.
- Avoid hard braking for the first 200 miles (300 km). You should also follow this when the brake pads are replaced.

⚠ WARNING

Improper accessories or modifications can affect your vehicle's handling, and stability, and performance, and cause a crash in which you can be seriously hurt or killed.

Follow all instructions in the vehicle owner's guide regarding accessories and modifications.

Maximum Load Limit

Carrying too much cargo or improperly storing it can affect your vehicle's handling, stability, stopping distance, and tires, and make it unsafe.

The maximum load for your vehicle is 450 lbs (204 kg). See the Tire and Loading Information label on the driver's doorjamb.

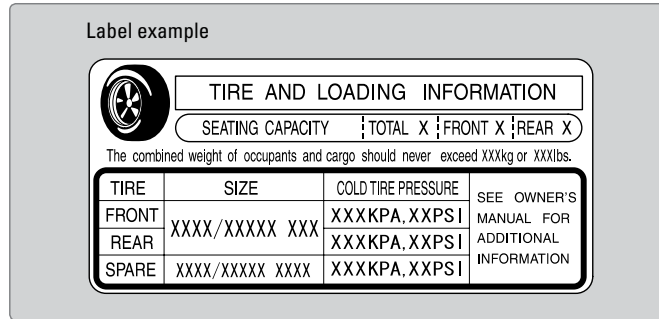

This figure includes the total weight of all occupants, cargo, and accessories, and the tongue load if you are towing a trailer. Below are the steps for determining the correct load limit:

1. Locate the statement "The combined weight of occupants and cargo should never exceed XXX kg or XXX lbs." on your vehicle's placard.
2. Determine the combined weight of the driver and passengers that will be riding in your vehicle.
3. Subtract the combined weight of the driver and passengers from XXX kg or XXX lbs.
4. The resulting figure equals the available amount of cargo and luggage load capacity. For example, if the "XXX" amount equals 1,400 lbs. and there will be five 150 lb. passengers in your vehicle, the amount of available cargo and luggage load capacity is 650 lbs. (1,400 - 750 (5 x 150) = 650 lbs.)
5. Determine the combined weight of luggage and cargo being loaded on the vehicle. That weight may not safely exceed the available cargo and luggage load capacity calculated in step 4.
6. If your vehicle will be towing a trailer, load from your trailer will be transferred to your vehicle. Consult this manual to determine how this reduces the available cargo and luggage load capacity of your vehicle.

In addition, the total weight of the vehicle, all occupants, accessories, cargo, and trailer tongue load must not exceed the Gross Vehicle Weight Rating (GVWR) or the Gross Axle Weight Rating (GAWR). Both are on a label on the driver's doorjamb.

Load limits example

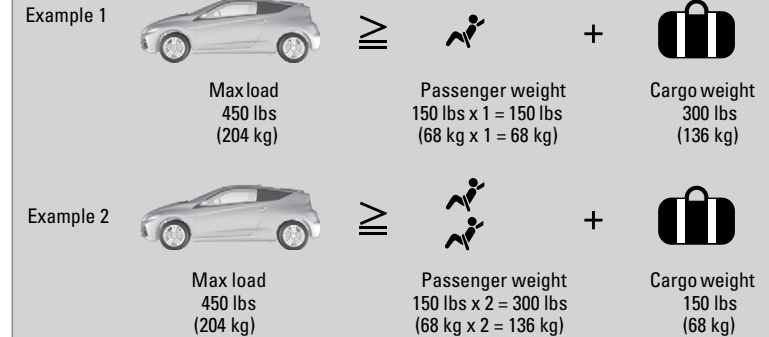

WARNING

Overloading or improper loading can affect handling and stability and cause a crash in which you can be hurt or killed.

Follow all load limits and other loading guidelines in this guide.

The headlight aim on your vehicle was set by the factory, and does not need to be adjusted. However, if you regularly carry heavy items in the cargo area, have the aiming readjusted at your dealer or by a qualified technician.

Your vehicle is not designed to tow a trailer. Attempting to do so can void your warranties.

Starting to Drive

Turn on the vehicle and start the engine to begin driving.

■ Before Starting the Engine

Continuously variable transmission (CVT)

Check that the shift lever is in Park (P), then press the brake pedal. Keep your foot firmly on the brake pedal when starting the engine.

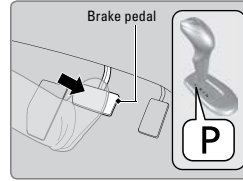

Manual transmission

Check that the shift lever is in Neutral (N). Press the brake pedal with your right foot, and press the clutch pedal all the way down with your left foot. Keep your foot firmly on the brake pedal when starting the engine.

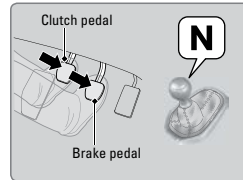

The engine is harder to start in cold weather and in thinner air found at altitudes above 8,000 feet (2,400 m). When starting the engine in cold weather, turn off all electrical accessories such as the lights, climate control system, and rear defogger in order to reduce battery drain.

■ Changing the Power Mode

Use the ENGINE START/STOP button to cycle through power modes or start the engine.

Accessory or On mode: Press ENGINE START/STOP once without pressing the brake pedal for Accessory mode. Press it again for On mode.

Starting the engine: Press and hold the brake pedal (and the clutch for manual transmission), then press ENGINE START/STOP. Keep your foot firmly on the brake pedal when starting the engine.

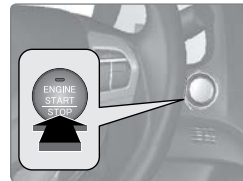

Turning the vehicle off: Shift to Park (P) (or apply the parking brake for manual transmission), then press ENGINE START/STOP. If you press the button and the shift lever is not in Park (P), the vehicle goes into Accessory mode.

Shifting

Change the shift position based on your driving needs.

■ Continuously Variable Transmission (CVT)*

Park (P): Used for parking or starting/stopping the engine. Press the brake pedal, then press the release button to shift.

Reverse (R): Used for reversing.

Neutral (N): Used for idling.

Drive (D): Used for normal driving or using the paddle shifters.

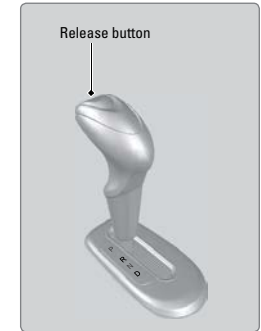

NOTICE

When you change the shift lever from D to R and vice versa, come to a complete stop and keep the brake pedal pressed. Operating the shift lever before the vehicle has come to a complete standstill can damage the transmission.

Do not operate the shift lever while pressing the accelerator pedal. You could damage the transmission.

*if equipped

■ Paddle Shifters*

Use the paddle shifters to change gears without removing your hands from the steering wheel.

(-) paddle shifter:
Pull to shift down to a lower gear.

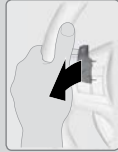

(+) paddle shifter:
Pull to shift up to a higher gear.



Recommended shift points

| Shift up | Normal acceleration |
|----------|---------------------|
| 1 to 2 | 15 mph (24 km/h) |
| 2 to 3 | 25 mph (40 km/h) |
| 3 to 4 | 40 mph (64 km/h) |
| 4 to 5 | 47 mph (76 km/h) |
| 5 to 6 | 52 mph (84 km/h) |
| 6 to 7 | 57 mph (92 km/h) |

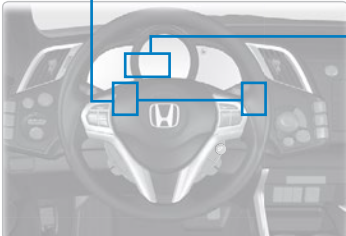

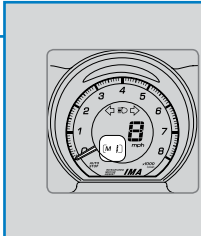

M indicator/gear position indicator

When driving in ECON or NORMAL mode: The vehicle goes into manual shift mode temporarily, and the gear number appears in the shift indicator. When you start traveling at a constant speed or accelerate, manual shift mode automatically switches off, and the gear number goes off.

When driving in SPORT mode: The vehicle goes into manual shift mode, and the M indicator and gear number appear in the shift indicator. If the vehicle speed increases and the engine speed approaches the tachometer's red zone, the transmission automatically shifts up. As the vehicle speed slows down, the transmission automatically shifts down accordingly. When the vehicle comes to a stop, it automatically shifts down into 1st gear.

You can cancel manual shift mode by pressing any of the three driving mode buttons, or by pulling the (+) paddle shifter for a few seconds.

L mode operation: Use L mode when you want to increase engine braking to maximum when in manual shift mode, when going up or down hills, or when the IMA battery is low. Pull and hold both paddle shifters (+) and (-) at the same time. The L indicator is displayed in the shift indicator. To cancel this mode, pull and hold both paddle shifters again, or press any of the three driving mode buttons. The L indicator goes off.

*if equipped

■ Manual Transmission*

Fully press the clutch pedal to operate the shift lever and change gears.

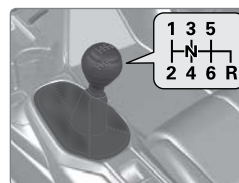

Recommended shift points

| Shift up | Normal acceleration |
|------------|---------------------|
| 1st to 2nd | 15 mph (24 km/h) |
| 2nd to 3rd | 25 mph (40 km/h) |
| 3rd to 4th | 40 mph (64 km/h) |
| 4th to 5th | 47 mph (76 km/h) |
| 5th to 6th | 52 mph (84 km/h) |

Shift indicators

Indicates when a gear change is appropriate to maintain the most fuel-efficient driving style while driving in ECON or NORMAL mode.

Shift up indicator: Comes on when shifting up is recommended.

Shift down indicator: Comes on when shifting down is recommended.

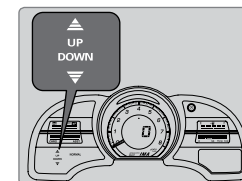

NOTICE

Do not shift to Reverse (R) before the vehicle comes to a complete stop. This can damage the transmission.

NOTICE

Before downshifting, make sure the engine will not go into the tachometer's red zone. This can severely damage your engine.

*if equipped

Braking

Slow down or stop your vehicle, and keep it from moving when parked.

■ Foot Brake

Press the brake pedal to slow down or stop your vehicle from moving.

■ Brake Assist System

During hard or emergency braking, the system increases braking force. The brake pedal may move slightly or make a noise; this is normal. Continue to hold the brake pedal firmly down.

■ Anti-Lock Brake System (ABS)

During hard or emergency braking, the system rapidly pumps the brakes to prevent wheel lockup and help you maintain steering control. The brake pedal may pulsate slightly during ABS operation; this is normal. Do not pump the brake pedal, and continue to hold it firmly down.

NOTICE

The ABS may not function correctly if you use an incorrect tire type and size.

■ Electric Parking Brake

Keep your vehicle from moving while parked using a simple switch.

To apply: Pull up the switch. The parking brake indicator appears in the instrument panel.

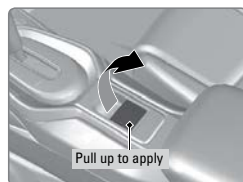

To release: Press the brake pedal and make sure your seat belt is fastened. Press the switch down to release.

You can also lightly press the accelerator pedal (and release the clutch pedal for manual transmission) if your seat belt is fastened, the vehicle is on, and the shift lever is in Drive (D) or Reverse (R) (or a gear is engaged for manual transmission).

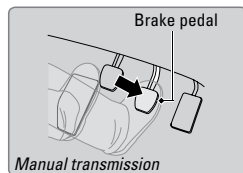
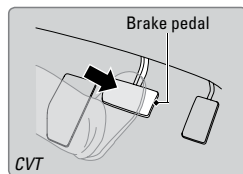

3-Mode Drive System

Change the drive mode based on your needs and the conditions.

Press the desired mode button. The corresponding mode indicator comes on in the instrument panel, and the mode icon appears briefly on the multi-information display.

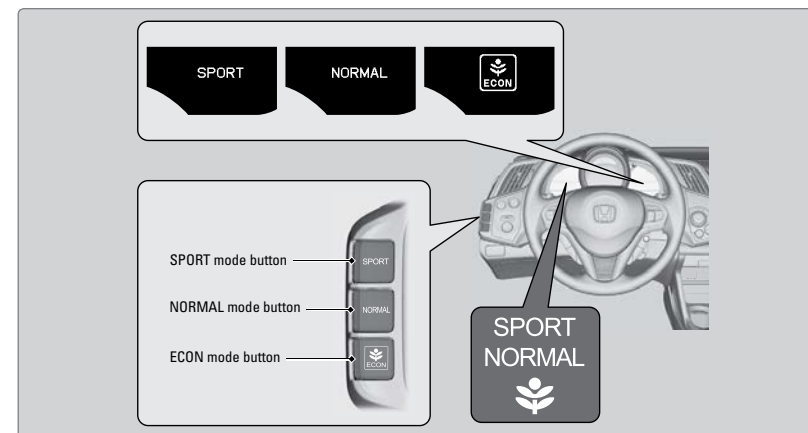

SPORT mode: Increases engine performance and handling. Suitable for driving in hilly or mountainous terrain.

NORMAL mode: Balances driving performance and fuel economy. Best for most driving situations. This is the default drive mode at vehicle start-up.

ECON mode: Maximizes fuel economy. Provides longer Auto Idle Stop operating time when the climate control system is in use. See page 73 for more information.

Plus Sport System

Helps the vehicle momentarily accelerate with more engine and electric motor assist power. This system can be used in any driving mode (SPORT, NORMAL, or ECON).

When the vehicle speed is over 19 mph (30 km/h) and the IMA battery charge level indicator shows more than four segments:

READY S+ The Plus Sport System indicator comes on.

Press the **S+** (Plus Sport) button on the steering wheel. The Plus Sport indicator blinks. The system stands by ready to be activated.

Depress the accelerator pedal. Only the Plus Sport indicator blinks. The Plus Sport READY indicator goes off. The system is in operation.

To cancel the Plus Sport System, release the accelerator pedal for more than 5 seconds, press the Plus Sport button again, or press the brake or clutch pedal.

Eco Assist™ System

Can help improve fuel economy by adjusting the performance of the engine, transmission, climate control system, and cruise control. Press the ECON mode button to turn the system on or off (see page 71).

Ambient Meter

Color-coded bars change based on your driving style and brake or accelerator pedal operation.

Green: Fuel efficient driving

Blue-green: Moderate acceleration/deceleration

Blue: Aggressive acceleration/deceleration

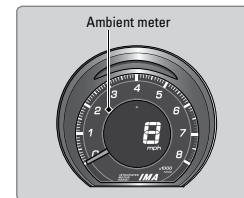

Power Flow Monitor

Monitors engine and electric motor power flow and whether the system is assisting the engine or charging the battery. Press the Info (▲/▼) button on the steering wheel to scroll to the screen.

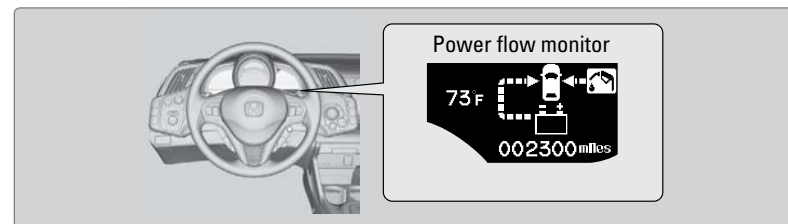

Here are some examples of screens:

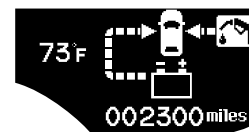

Power is supplied with the engine and the electric motor is assisting the engine.

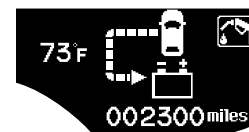

The electric motor is charging the IMA battery.

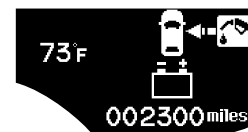

Power is supplied by the engine.

Ecological Drive Display

Monitors the fuel efficiency of your driving style in real time. Press the Info (▲/▼) button on the steering wheel to scroll to the screen.

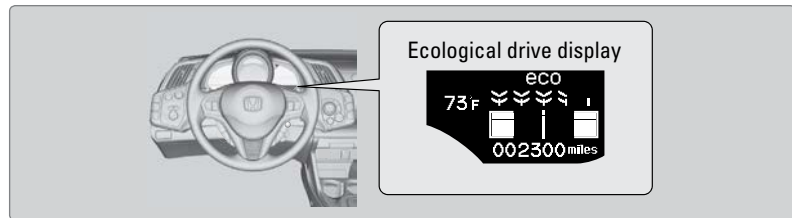

Real-time score

Your driving "score" is shown as leaves, which accumulate or diminish based on your driving style and its impact on fuel economy.

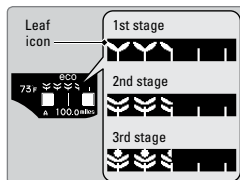

When you turn the vehicle off, your drive cycle and lifetime score are displayed.

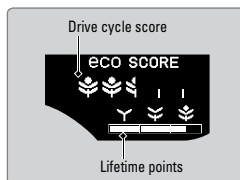

Eco drive bar

The bar extends based on your driving style. The more aggressive your acceleration or deceleration is, the farther the bar extends from the center. Keep the bar near the center line for more fuel efficient driving.

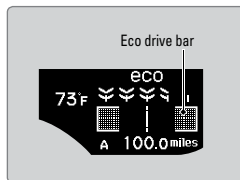

Auto Idle Stop

Shuts the engine off at a stop in order to maximize fuel efficiency.

When the shift lever is in Drive (D) and the brake pedal is pressed (or the clutch pedal is pressed and the shift lever is in Neutral (N) for manual transmission), the engine shuts off. The Auto Stop indicator blinks.

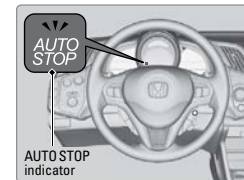

The engine restarts when the brake pedal is released (or the clutch pedal is pressed and the shift lever is moved out of Neutral (N) for manual transmission).

Idle stop occurrence and duration vary depending on certain conditions, including sudden braking, climate control operation, IMA battery level, and outside temperature.

Vehicle Stability Assist (VSA®), aka Electronic Stability Control (ESC) System

Helps to stabilize the vehicle during cornering if the vehicle turns more or less than what was intended. It assists in maintaining traction on slippery surfaces by regulating engine output and selectively applying the brakes.

Turning VSA On or Off

VSA is turned on every time you start the engine, even if you previously turned it off. If you turn VSA off, your vehicle has normal braking and cornering ability, but not VSA traction and stability.

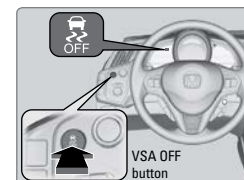

Press and hold the VSA OFF button until you hear a beep to turn VSA on or off. The VSA OFF indicator appears when the system is off.

When VSA is turned off, traction control stops functioning, which may make it easier when trying to free your vehicle if it is stuck in mud or snow.

Cruise Control

Maintain a constant vehicle speed without having to keep your foot on the accelerator pedal. Use cruise control on freeways or open roads where you can travel at a constant speed with little acceleration or deceleration.

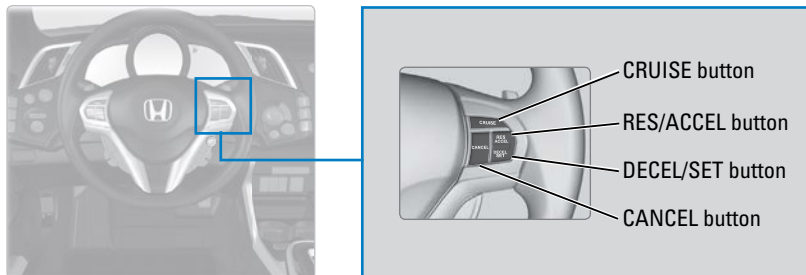

■ Activating and Setting the Vehicle Speed

1. Press the CRUISE button. The CRUISE MAIN indicator appears.
2. Accelerate to the desired speed (above 25 mph/40 km/h). Take your foot off the pedal and press the DECEL/SET button to set the speed. The CRUISE CONTROL indicator appears.



■ Adjusting the Vehicle Speed

Press the RES/ACCEL button to increase speed, or the DECEL/SET button to decrease speed.

Each time you press the button, the vehicle speed is increased or decreased by about 1 mph (1.6 km/h). If you keep the button pressed, the vehicle speed increases or decreases until you release it.

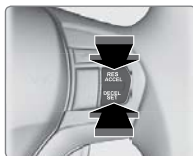

■ Canceling Cruise Control

Press the CANCEL button or the brake pedal. The CRUISE CONTROL indicator goes off.

After cruise control has been canceled, you can still resume the prior set speed by pressing RES/+ while driving at a speed of at least 25 mph (40 km/h).

Press the CRUISE button to turn the system off.



⚠ WARNING

Improper use of cruise control can lead to a crash.

Use cruise control only when traveling on open highways in good weather.

LaneWatch™*

Check the passenger-side rear areas in the upper display when the right turn signal is activated.

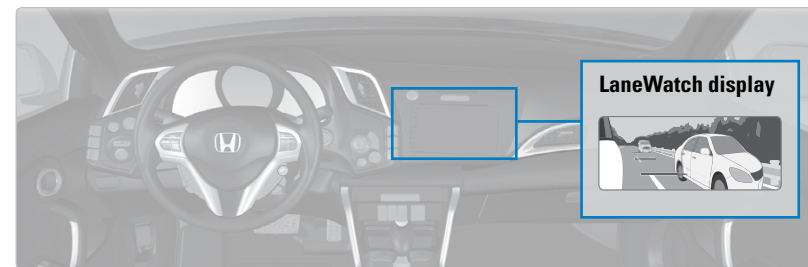

■ Activating LaneWatch

Activate the right turn signal. The LaneWatch display appears. Check the display for blind spots, and visually confirm that it is safe to change lanes.

You can also press the LaneWatch button on the end of the turn signal switch to view a constant real-time display. Press it again to turn the display off.

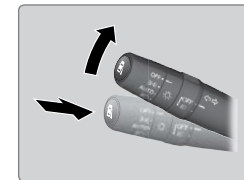

■ Changing Settings

Customize the display and how and when the display appears.

1. From the HOME screen, select Settings.
2. Select Camera.
3. Select LaneWatch.
4. Select an option and make the preferred changes.
5. Press the BACK button to exit the menu.



Important Safety Reminder

Like all assistance systems, LaneWatch has limitations. Over-reliance on the system may result in a collision.

⚠ WARNING

Failure to visually confirm that it is safe to change lanes before doing so may result in a crash and serious injury or death.

Do not rely only on LaneWatch while driving. Always look in your mirrors, to either side of your vehicle, and behind you for other vehicles before changing lanes.

*if equipped

Multi-View Rear Camera

When you shift into Reverse (R), a real-time image of the area behind your vehicle is shown in the display, along with helpful parking guidelines.

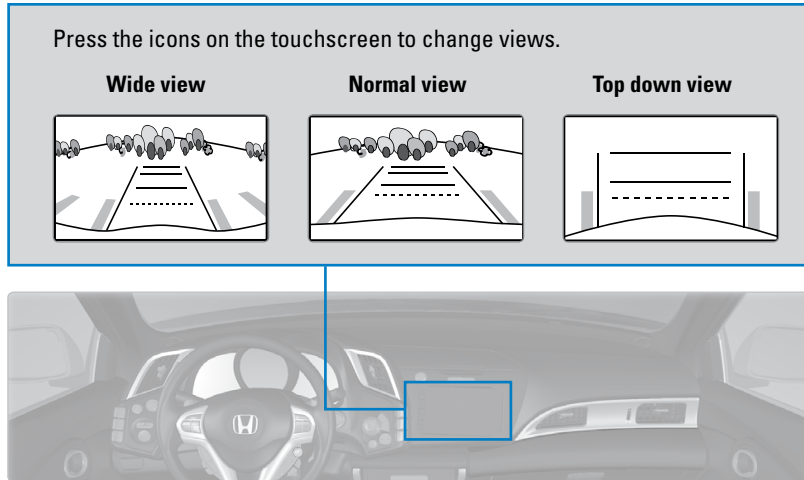

Changing Camera Settings

Turn the guidelines on or off.

1. From the HOME screen, select Settings.
2. Select Camera.
3. Select Rear Camera.
4. Select one of the options.

Fixed Guideline: Guidelines appear when you shift into Reverse. Select On or Off.

Dynamic Guideline: Guidelines move as you turn the steering wheel. Select On or Off.

5. Press the BACK button to exit the menu.



The rear camera view is restricted. You cannot see the corner ends of the bumper or what is underneath the bumper. Its unique lens also makes objects appear closer or farther than they actually are.

Visually confirm that it is safe to drive before backing up. Certain conditions (such as weather, lighting, and high temperatures) may also restrict the rear view. Do not rely on the rearview display, which does not give you all information about conditions at the rear of your vehicle.

Refueling

Use the proper fuel and refueling procedure to ensure the best performance and safety of your vehicle.

Fuel Information

Use of unleaded gasoline of 87 octane or higher is recommended.

- Honda recommends TOP TIER Detergent Gasoline where available.
- Do NOT use gasoline containing more than 15% ethanol.
- Do NOT use gasoline containing methanol.
- Do NOT use gasoline containing MMT.

NOTICE

We recommend quality gasoline containing detergent additives that help prevent fuel system and engine deposits. In addition, in order to maintain good performance, fuel economy, and emissions control, we strongly recommend the use of gasoline that does NOT contain harmful manganese-based fuel additives such as MMT, if such gasoline is available.

How to Refuel

1. The fuel fill door is located at the left rear of the vehicle. Park next to the service pump that is most accessible.
2. Turn off the engine.
3. Press the area indicated by the arrow to release the fuel fill door. You will hear a click.
4. Turn the fuel fill cap slowly to open. Place the fuel fill cap in the holder.
5. Insert the filler nozzle fully. When the tank is full, the fuel nozzle clicks off automatically.
6. Replace the fuel fill cap. Tighten it until you hear at least one click. Close the fuel fill door.

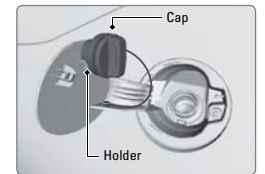
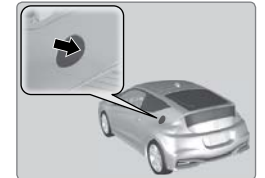

WARNING

Gasoline is highly flammable and explosive. You can be burned or seriously injured when handling fuel.

- Stop the engine, and keep heat, sparks, and flame away.
- Handle fuel only outdoors.
- Wipe up spills immediately.

HANDLING THE UNEXPECTED

Learn about what to do in critical or emergency situations.

Smart Entry Remote Battery Strength

If the battery life in your remote transmitter is weak, follow the below steps to start the engine.

1. Touch the back of the remote transmitter to the ENGINE START/STOP button while the indicator is flashing.
2. With the brake pedal pressed (and the clutch pedal for manual transmission), press the ENGINE START/STOP button within 10 seconds.

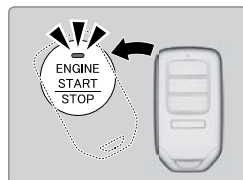

Shift Lever Does Not Move*

Follow the procedure below if you cannot move the shift lever out of Park (P).

1. Set the parking brake.
2. Remove the built-in key from the remote transmitter.
3. Wrap a cloth around the tip of a small flat-tip screwdriver. Put it into the shift lock release slot as shown in the image, and remove the cover.
4. Insert the key into the shift release lock.
5. While pushing the key down, press the shift lever release button and place the shift lever into Neutral (N). The lock is now released. Have the shift lever checked by a dealer as soon as possible.

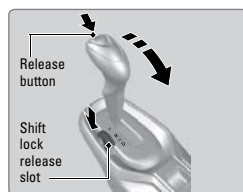

*if equipped

Jump Starting

Turn off the power to electric devices, such as audio and lights. Turn off the engine, then open the hood.

1. Open the fuse box cover on your vehicle's 12-volt battery positive (+) terminal.

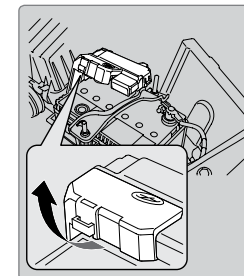

2. Connect the first jumper cable to your vehicle's battery (+) terminal.
3. Connect the other end of the first jumper cable to the booster battery (+) terminal. Use a 12-volt booster battery only.
4. Connect the second jumper cable to the booster battery (-) terminal.
5. Connect the other end of the second jumper cable to the grounding strap as shown. Do not connect this jumper cable to any other part.
6. If your vehicle is connected to another vehicle, start the assisting vehicle's engine and increase its rpm slightly.
7. Attempt to start your vehicle's engine. If it turns over slowly, make sure that the jumper cables have good metal-to-metal contact.

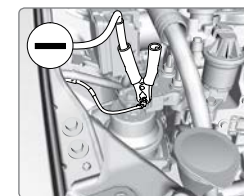
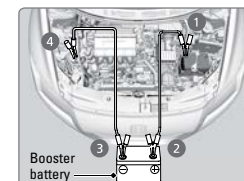

WARNING: Battery posts, terminals, and related accessories contain lead and lead compounds. **Wash your hands after handling.**

WARNING

A battery can explode if you do not follow the correct procedure, seriously injuring anyone nearby.
Keep all sparks, open flames, and smoking materials away from the battery.

■ After the Engine Starts

Once your vehicle's engine has started, remove the jumper cables in the following order:

1. Disconnect the jumper cable from your vehicle's ground.
2. Disconnect the other end of the jumper cable from the booster battery (-) terminal.
3. Disconnect the jumper cable from your vehicle's battery (+) terminal.
4. Disconnect the other end of the jumper cable from the booster battery (+) terminal. Close the fuse box cover on your vehicle's battery (+) terminal.
5. Have your vehicle inspected by a nearby service station or a dealer.

Overheating

If the high temperature indicator comes on, the engine suddenly loses power, or steam or spray comes out from under the hood, your engine is overheating.

1. Immediately park the vehicle in a safe place. Turn off all accessories and turn on the hazard warning lights.
2. *If steam or spray is not present:* Keep the engine running and open the hood.

If steam or spray is present: Turn off the engine and wait until it subsides. Then, open the hood.

3. Check that the cooling fan is operating and stop the engine once the high temperature indicator goes off. If the cooling fan is not operating, immediately stop the engine.
4. Once the engine has cooled down, inspect the coolant level and check the cooling system components for leaks. If the coolant level in the reserve tank is low, add coolant until it reaches the MAX mark. If there is no coolant in the reserve tank, make sure the radiator is cool, then cover the radiator cap with a heavy cloth and open the cap. If necessary, add coolant up to the base of the filler neck, and put the cap back on.

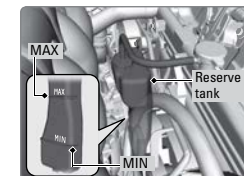

Once the engine has cooled sufficiently, restart it and check the high temperature indicator. If the indicator is off, resume driving. If it stays on, contact a dealer for repairs.

⚠ WARNING

Steam and spray from an overheated engine can seriously scald you.
Do not open the hood if steam is coming out.

⚠ WARNING

Removing the radiator cap while the engine is hot can cause the coolant to spray out, seriously scalding you.
Always let the engine and radiator cool down before removing the radiator cap.

NOTICE

Continuing to drive with the temperature gauge needle at the H mark may damage the engine.

Emergency Engine Stop

The ENGINE START/STOP button may be used to stop the engine due to an emergency situation even while driving. If you must stop the engine, choose one of the following operations:

- Press and hold the ENGINE START/STOP button for two seconds, or
- Firmly press the ENGINE START/STOP button two times.

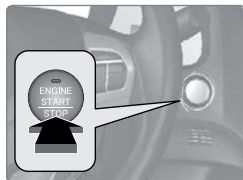

The steering wheel will not lock. Because turning off the engine also disables the power assist the engine provides to the steering and braking systems, it will require significantly more physical effort and time to steer and slow the vehicle. Downshift gears and use both feet on the brake pedal, if necessary, to slow the vehicle and stop immediately in a safe place.

Do not press the button while driving unless it is absolutely necessary for the engine to be switched off.

Emergency Towing

Call a professional towing service if you need to tow your vehicle.

Flat bed equipment: The operator loads your vehicle on the back of a truck. **This is the best way to transport your vehicle.**

Wheel lift equipment: The tow truck uses two pivoting arms that go under the front tires and lift them off the ground. The rear tires remain on the ground. **This is an acceptable way to tow your vehicle.**

NOTICE

Trying to lift or tow your vehicle by the bumpers will cause serious damage. The bumpers are not designed to support the vehicle's weight.

Improper towing such as towing behind a motorhome or other motor vehicle can damage the transmission.

Tire Pressure Monitoring System (TPMS)

Monitors the tire pressure while you are driving. **Available on U.S. models only.**

If your vehicle's tire pressure becomes significantly low, the low tire pressure indicator comes on and a message appears in the multi-information display.

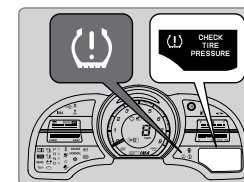

Stop your vehicle in a safe place. Check the tire pressure and adjust the pressure to the specified level. The specified tire pressure is on a label on the driver's doorjamb.

■ TPMS Calibration

Any time you inflate, change, or rotate one of more of the tires, you need to recalibrate the system.

Use the Info (▲/▼) and SEL/RESET buttons on the steering wheel to control the multi-information display (see page 24).

1. Scroll to CUSTOMIZE SETTINGS, and select it.
2. Select TPMS CALIBRATION.
3. Scroll to CALIBRATE, and select it. Calibration begins.

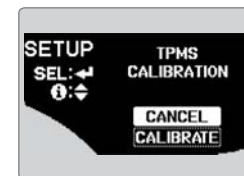

The calibration process requires approximately 30 minutes of cumulative driving at speeds between 30–60 mph (48–97 km/h). The process finishes automatically.

NOTICE

Driving on an extremely underinflated tire can cause it to overheat. An overheated tire can fail. Always inflate your tires to the specified pressure.

■ Tire Pressure Monitoring System (TPMS)—Required Federal Explanation

Each tire, including the spare (if provided), should be checked monthly when cold and inflated to the inflation pressure recommended by the vehicle manufacturer on the vehicle placard or tire inflation pressure label.

(If your vehicle has tires of a different size than the size indicated on the vehicle placard or tire inflation pressure label, you should determine the proper tire inflation pressure for those tires.)

As an added safety feature, your vehicle has been equipped with a tire pressure monitoring system (TPMS) that illuminates a low tire pressure telltale when one or more of your tires is significantly under-inflated.



Accordingly, when the low tire pressure telltale illuminates, you should stop and check your tires as soon as possible, and inflate them to the proper pressure.

Driving on a significantly under-inflated tire causes the tire to overheat and can lead to tire failure. Under-inflation also reduces fuel efficiency and tire tread life, and may affect the vehicle's handling and stopping ability.

Please note that the TPMS is not a substitute for proper tire maintenance, and it is the driver's responsibility to maintain correct tire pressure, even if under-inflation has not reached the level to trigger illumination of the TPMS low tire pressure telltale.

Your vehicle has also been equipped with a TPMS malfunction indicator to indicate when the system is not operating properly. The TPMS malfunction indicator is combined with the low tire pressure telltale. When the system detects a malfunction, the telltale will flash for approximately one minute and then remain continuously illuminated. This sequence will continue upon subsequent vehicle start-ups as long as the malfunction exists.

When the malfunction indicator is illuminated, the system may not be able to detect or signal low tire pressure as intended.

TPMS malfunctions may occur for a variety of reasons, including the installation of replacement or alternate tires or wheels on the vehicle that prevent the TPMS from functioning properly.

Always check the TPMS malfunction telltale after replacing one or more tires or wheels on your vehicle to ensure that the replacement or alternate tires and wheels allow the TPMS to continue to function properly.

Tire Repair Kit

If a tire has a small puncture, you can use the tire repair kit to temporarily repair it. The puncture must be smaller than 3/16-inch (4 mm) and not in the tire sidewall. Go to a dealer to have the full-size tire permanently repaired or replaced. This vehicle is not equipped with a spare tire.

■ Before Repairing the Tire

1. Park the vehicle on a firm, level, non-slippery surface.
2. Move the shift lever to Park (P) for CVT models or Reverse (R) for manual transmission models. Apply the parking brake.
3. Turn on the hazard warning lights, and turn off the vehicle.

■ Getting Ready to Repair the Tire

1. Pull the strap and take the kit out of the case.
2. Place the kit upright on flat ground near the punctured tire and away from traffic. Do not place the kit on its side.
3. Follow the instructions in the kit to repair the tire.

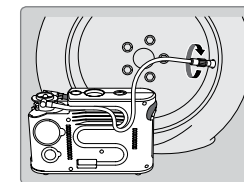
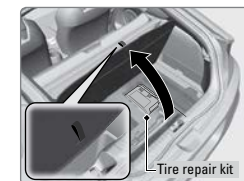

NOTICE

Do not use a puncture-repairing agent other than the one provided in the kit that came with your vehicle. If a different agent is used, you may permanently damage the tire pressure sensor.

Do not operate the temporary tire repair kit compressor for more than 15 minutes. The accessory power socket and compressor can overheat and become permanently damaged.

⚠ WARNING

Running the engine with the vehicle in an enclosed or even partly enclosed area can cause a rapid build-up of toxic carbon monoxide.

Breathing this colorless, odorless gas can cause unconsciousness and even death. Only run the engine to power the air compressor with the vehicle outdoors.

Fuse Locations

If any electrical devices are not working, turn the vehicle off and check to see if any applicable fuse is blown. Fuse locations are shown on the fuse box cover. Locate the fuse in question by the fuse number and box cover number. Replacement of engine compartment fuses should be done by a dealer.

Interior Fuse Boxes

Type A

Located under the driver's side dashboard.

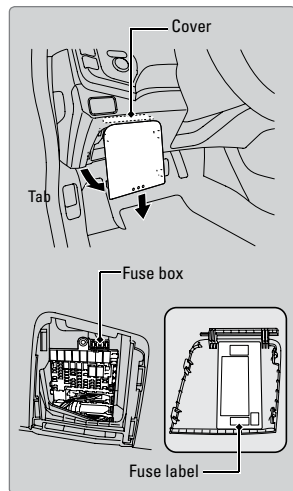

| | Circuit Protected | Amps |
|----|--------------------|---------|
| a | TAIL GATE LOCK | 10 A |
| b | - | - |
| c | BACK UP | 10 A |
| d | STRD | 7.5 A |
| 1 | DOOR LOCK | 20 A |
| 2 | - | - |
| 3 | SMART | 10 A |
| 4 | R SIDE DOOR UNLOCK | 10 A |
| 5 | L SIDE DOOR UNLOCK | (10 A) |
| 6 | DR DOOR UNLOCK | (10 A) |
| 7 | - | - |
| 8 | DR P/W | 20 A |
| 9 | DAY LIGHT | (7.5 A) |
| 10 | AS P/W | 20 A |
| 11 | - | - |
| 12 | R SIDE DOOR LOCK | 10 A |
| 13 | L SIDE DOOR LOCK | 10 A |
| 14 | - | - |

| | Circuit Protected | Amps |
|----|-------------------|---------|
| 15 | H/L HI R | 10 A |
| 16 | - | - |
| 17 | DBW | 15 A |
| 18 | MG CLUTCH | 7.5 A |
| 19 | HEATED SEAT | (15 A) |
| 20 | IMA2 | 15 A |
| 21 | IMA1 | 7.5 A |
| 22 | WASHER | 15 A |
| 23 | RR WIPER | 10 A |
| 24 | A/C | 7.5 A |
| 25 | DAY LIGHT | (7.5 A) |
| 26 | FR WIPER | 7.5 A |
| 27 | ABS/VSA | 7.5 A |
| 28 | SRS | 10 A |
| 29 | H/L HI L | 10 A |
| 30 | IG IMA | 10 A |
| 31 | P/W | 10 A |
| 32 | FUEL PUMP | 15 A |
| 33 | SRS | 7.5 A |
| 34 | METER | 7.5 A |
| 35 | BACK LIGHT | 10 A |
| 36 | FR ACC SOCKET | 20 A |
| 37 | ACC | 7.5 A |
| 38 | - | - |
| 39 | RR WIPER | 7.5 A |
| 40 | - | - |
| 41 | - | - |
| 42 | - | - |

*if equipped

Type B

Located under the driver's side dashboard.

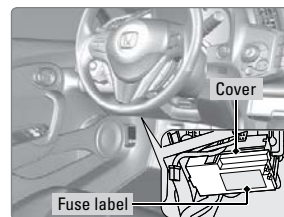

| | Circuit Protected | Amps |
|---|-------------------|------|
| 1 | RR DEF | 30 A |
| | IG MAIN | 30 A |
| | FB MAIN2 | 50 A |
| | FB MAIN3 | 40 A |
| | FB MAIN1 | 30 A |
| | - | 40 A |
| 2 | EPB L | 30 A |
| | EPB R | 30 A |
| | IG MAIN2 | 30 A |
| | - | 40 A |
| | COND FAN | 30 A |
| | MAIN FAN | 30 A |

Type C

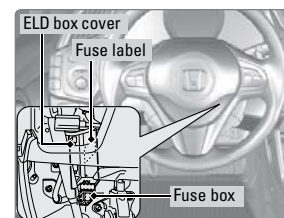

| | Circuit Protected | Amps |
|----|-------------------|--|
| 3 | WIPER | 30 A |
| 4 | STARTER | 30 A |
| 5 | BACK UP MAIN | 15 A |
| 6 | FR FOG | (20 A) |
| 7 | IGP | 15 A |
| 8 | SMALL | 10 A |
| 9 | H/L LO MAIN | 20 A ^{*1} 30 A ^{*2} |
| 10 | AUDIO AMP | (20 A) |
| 11 | HTR | 30 A |
| 12 | - | - |
| 13 | - | - |
| 14 | - | - |
| 15 | H/MIRROR | (10 A) |

*1: Models with halogen bulb low beam headlights

*2: Models with discharge headlights

| | Circuit Protected | Amps |
|---|-------------------|--|
| 1 | H/L LO L | 10 A ^{*1} 15 A ^{*2} |
| 2 | H/L LO R | 10 A ^{*1} 15 A ^{*2} |
| 3 | VSA FSR | 30 A |
| 4 | LAF | 10 A |
| 5 | IG COIL | 15 A |
| 6 | IGPS | 7.5 A |

*1: Models with halogen bulb low beam headlights

*2: Models with discharge headlights

*if equipped

■ Inspecting and Changing Fuses

1. Turn the vehicle off, including all lights and accessories.
2. Check the fuses on the battery in the engine compartment. If the fuse is blown, have it replaced by a dealer.
3. Inspect the small fuses in the engine compartment and the vehicle interior.

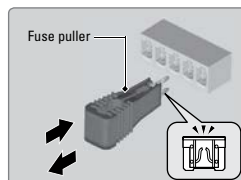
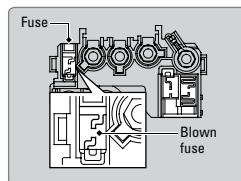

If there is a burned-out fuse, remove it with the fuse puller and replace it with a new one.

NOTICE

Replacing a fuse with one that has a higher rating greatly increases the chances of damaging the electrical system.

MAINTENANCE

Learn about basic maintenance that you can perform on the vehicle yourself, as well as information about how to best maintain the vehicle.

Safety Precautions

Some of the most important safety precautions are listed below; however, we cannot warn you of every conceivable hazard that can arise in performing maintenance. Only you can decide whether or not you should perform a given task.

■ Maintenance Safety

- To reduce the possibility of fire or explosion, keep cigarettes, sparks, and flames away from the battery and all fuel-related parts.
- Never leave rags, towels, or other flammable objects under the hood.
- To clean parts, use a commercially available degreaser or parts cleaner, not gasoline.
- Wear eye protection and protective clothing when working with the battery or compressed air.
- Do not run the engine in confined spaces where carbon monoxide gas can accumulate.

■ Vehicle Safety

- The vehicle must be stationary, and parked on level ground with the parking brake set and the engine off.
- Be aware that hot parts can burn you.
- Be aware that moving parts can injure you.
- Do not touch the IMA battery and wiring (orange).

⚠ WARNING

Improperly maintaining this vehicle or failing to correct a problem before driving can cause a crash in which you can be seriously hurt or killed.

Always follow the inspection and maintenance recommendations according to the schedules in this guide.

⚠ WARNING

Failure to properly follow maintenance instructions and precautions can cause you to be seriously hurt or killed.

Always follow the procedures and precautions in this guide.

Maintenance Minder™

When maintenance is due, the Maintenance Minder indicator comes on and a message appears on the display every time you turn the vehicle on. Press either Info (▲/▼) button on the steering wheel to change displays.

See the service code table on page 93 to check which items need maintenance based on the main and sub items shown in the display.

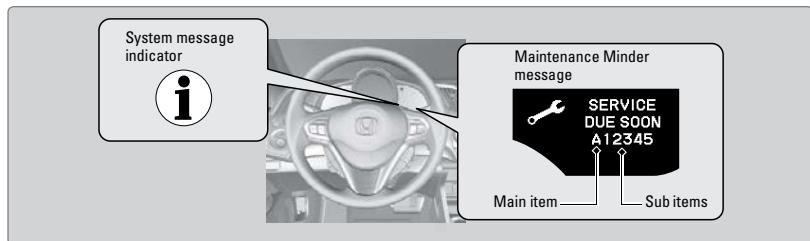

- Independent of the Maintenance Minder information, replace the brake fluid every 3 years.
- Inspect idle speed every 160,000 miles (256,000 km).
- Adjust the valves during services A, B, 1, 2, or 3 if they are noisy.

U.S. models

Maintenance, replacement, or repair of emissions control devices and systems may be done by any automotive repair establishment or individuals using parts that are certified to EPA standards.

According to state and federal regulations, failure to perform maintenance on the maintenance main items marked with # will not void your emissions warranties. However, all maintenance services should be performed in accordance with the intervals indicated by the multi-information display.

■ Maintenance Minder Service Codes

These codes indicate what services are due on your vehicle.

| CODE | Maintenance Main Items |
|------|--|
| A | Replace engine oil *1 |
| B | Replace engine oil *1 and oil filter Inspect front and rear brakes Check parking brake adjustment Inspect tie rod ends, steering gearbox, and boots Inspect suspension components Inspect driveshaft boots Inspect brake hoses and lines (Including ABS/VSA) Inspect all fluid levels and condition of fluids Inspect exhaust system # Inspect fuel lines and connections # Check expiration date for Tire Repair Kit bottle |
| CODE | Maintenance Sub Items |
| 1 | Rotate tires |
| 2 | Replace air cleaner element *2 Replace dust and pollen filter *3 Inspect drive belt |
| 3 | Replace transmission fluid |
| 4 | Replace spark plugs Inspect valve clearance |
| 5 | Replace engine coolant |

*1: If a message SERVICE does not appear more than 12 months after the display is reset, change the engine oil every year.

*2: If you drive primarily in dusty conditions, replace the air cleaner element every 15,000 miles (24,000 km).

*3: If you drive primarily in urban areas that have high concentrations of soot in the air from industry and diesel-powered vehicles, replace the dust and pollen filter every 15,000 miles (24,000 km).

#: See information on maintenance and emissions warranty.

TABLE OF CONTENTS

VISUAL INDEX

SAFETY INFORMATION

INSTRUMENT PANEL

VEHICLE CONTROLS

AUDIO AND CONNECTIVITY

BLUETOOTH® HANDSFREELINK®

HONDALINK®

NAVIGATION

DRIVING

HANDLING THE UNEXPECTED

MAINTENANCE

SPECIFICATIONS

CUSTOMER INFORMATION

VOICE COMMAND INDEX

INDEX

Under the Hood

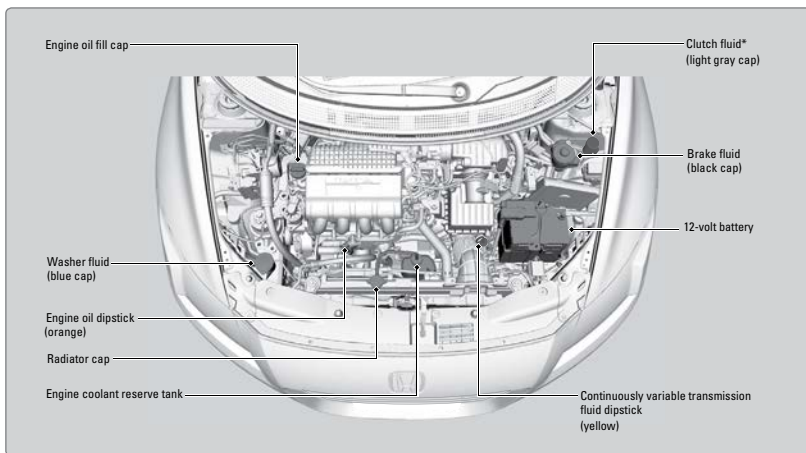

Opening the Hood

1. Park the vehicle on a level surface, and set the parking brake.
2. Pull the hood release handle under the lower left corner of the dashboard.
3. Slide the hood latch lever in the center of the hood to release the lock mechanism, and open the hood.
4. Remove the support rod from the clamp using the grip. Mount the support rod in the hood.

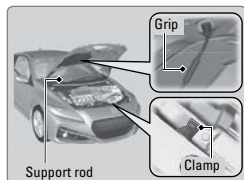
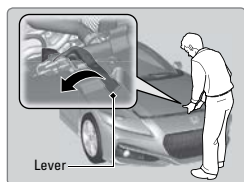
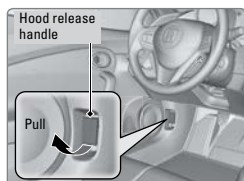

When closing, remove the support rod, and stow it in the clamp, then gently lower the hood. Remove your hand at a height of approximately 12 inches (30 cm) and let the hood close.

NOTICE

Do not open the hood when the wiper arms are raised. The hood will strike the wipers, and may damage either the hood or the wipers.

Engine Oil

Park the vehicle on level ground, and wait approximately three minutes after turning the engine off before you check the oil.

Checking the Oil

1. Remove the dipstick (orange).
2. Wipe the dipstick with a clean cloth or paper towel.
3. Insert the dipstick back all the way into its hole.
4. Remove the dipstick again, and check the level. It should be between the upper and lower marks. Add oil if necessary.

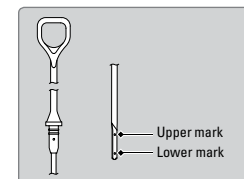
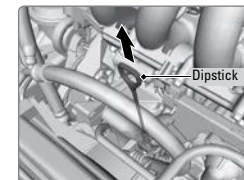

Recommended Engine Oil

- Honda Genuine Motor Oil
- Premium-grade 0W-20 detergent oil with an API Certification Seal on the container

This seal indicates the oil is energy conserving and that it meets the American Petroleum Institute's latest requirements.



Use Honda Genuine Motor Oil or another commercial engine oil of suitable viscosity for the ambient temperature as shown.

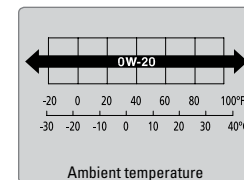

You may also use synthetic motor oil if it is labeled with the API Certification Seal and is of the specified viscosity grade.

■ Adding Oil

1. Unscrew and remove the engine oil fill cap.
2. Add oil slowly.
3. Reinstall the engine oil fill cap, and tighten it securely.
4. Wait for three minutes and recheck the engine oil dipstick.

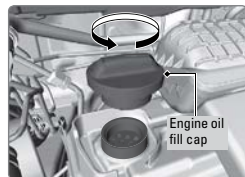

NOTICE

Do not fill the engine oil above the upper mark. Overfilling the engine oil can result in leaks and engine damage.

■ Resetting the Engine Oil Life

If you change or replace the vehicle's engine oil yourself, you must reset the engine oil life. Use the Info (▲/▼) and SEL/RESET buttons on the steering wheel to control the multi-information display (see page 24).

1. Press the Info (▲/▼) button until the oil life screen is displayed.
2. Press and hold the SEL/RESET button for 10 seconds, or until the oil life reset mode appears.
3. Scroll to RESET and select it. The maintenance codes disappear and the engine oil life display returns to 100%.

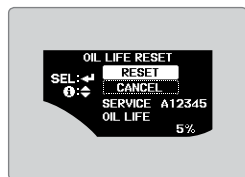

NOTICE

Failure to reset the engine oil life after a maintenance service results in the system showing incorrect maintenance intervals, which can lead to serious mechanical problems.

Engine Coolant

Park the vehicle on level ground. Check the reserve tank and the coolant level in the radiator. **Use Honda Long Life Antifreeze/Coolant Type 2.**

■ Checking the Reserve Tank

1. Check the amount of coolant in the reserve tank.
2. If the coolant level is below the MIN mark, add the specified coolant until it reaches the MAX mark.
3. Inspect the cooling system for leaks.

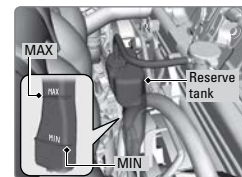

■ Adding Coolant

1. Make sure the engine and radiator are cool.
2. Turn the radiator cap counterclockwise and relieve any pressure in the coolant system. Do not push the cap down when turning.
3. Push down and turn the radiator cap counterclockwise to remove it.
4. The coolant level should be up to the base of the filler neck. Add coolant if it is low.
5. Put the radiator cap back on, and tighten it fully.
6. Pour coolant into the reserve tank until it reaches the MAX mark. Put the cap back on the reserve tank.

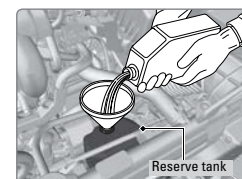
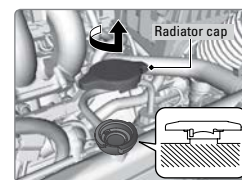

⚠ WARNING

Removing the radiator cap while the engine is hot can cause the coolant to spray out, seriously scalding you. Always let the engine and radiator cool down before removing the radiator cap.

NOTICE

Pour the fluid slowly and carefully so you do not spill any. Clean up any spills immediately; they can damage components in the engine compartment.

NOTICE

If temperatures consistently below -22°F (-30°C) are expected, the coolant mixture should be changed to a higher concentration. Consult a dealer for more information.

TABLE OF CONTENTS
VISUAL INDEX
SAFETY INFORMATION
INSTRUMENT PANEL
VEHICLE CONTROLS
AUDIO AND CONNECTIVITY
BLUETOOTH® HANDSFREELINK®
HONDALINK®

NAVIGATION
DRIVING
HANDLING THE UNEXPECTED
MAINTENANCE
SPECIFICATIONS
CUSTOMER INFORMATION
VOICE COMMAND INDEX
INDEX

Brake/Clutch* Fluid

The fluid level should be between the MIN and MAX marks on the side of the reservoir. **Use Honda Heavy Duty Brake Fluid DOT 3.**

Pour the fluid carefully.

If the fluid level is at or below the MIN mark, have a dealer inspect for leaks, an excessively worn clutch plate*, or worn brake pads as soon as possible.

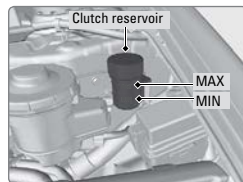
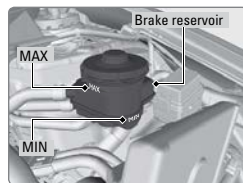

NOTICE

Brake fluid marked DOT 5 is not compatible with your vehicle's braking system and can cause extensive damage.

Window Washer Fluid

Check the amount of window washer fluid using the washer fluid level gauge on the cap. If the washer fluid level is low, fill the washer reservoir. Pour the washer fluid carefully. Do not overflow the reservoir.

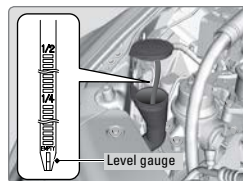

Canadian models

If the washer fluid level is low, a message appears on the multi-information display.

NOTICE

Do not use engine antifreeze or a vinegar/water solution in the windshield washer reservoir. Antifreeze can damage your vehicle's paint. A vinegar/water solution can damage the windshield washer pump.

**if equipped*

Checking the Battery

Check the battery condition monthly. Look at the test indicator window and check the terminals for corrosion.

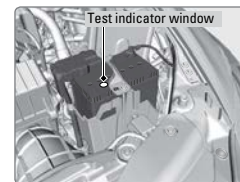

For jump starting, see page 81.

WARNING

The battery gives off explosive hydrogen gas during normal operation. A spark or flame can cause the battery to explode with enough force to kill or seriously hurt you. When conducting any battery maintenance, wear protective clothing and a face shield, or have a skilled technician do it.

WARNING: Battery posts, terminals, and related accessories contain lead and lead compounds. **Wash your hands after handling.**

TABLE OF CONTENTS
VISUAL INDEX
SAFETY INFORMATION
INSTRUMENT PANEL
VEHICLE CONTROLS
AUDIO AND CONNECTIVITY
BLUETOOTH® HANDSFREELINK®
HONDALINK®

NAVIGATION
DRIVING
HANDLING THE UNEXPECTED
MAINTENANCE
SPECIFICATIONS
CUSTOMER INFORMATION
VOICE COMMAND INDEX
INDEX

Changing Wiper Blades

If the wiper blades leave streaks across the windshield, try cleaning them first with a paper towel or soft cloth and wiper fluid. If the wiper blade rubber has deteriorated, you should change the wiper blades.

■ Changing the Front Wiper Blade Rubber

1. Lift the driver side wiper arm first, then the passenger side.

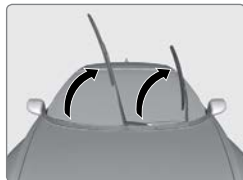

2. Push the lock tab up.
3. Slide the blade holder from the wiper arm.

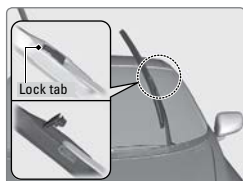

4. Slide the wiper blade out from its holder by pulling from the end of the blade having the molded-in stopper block.

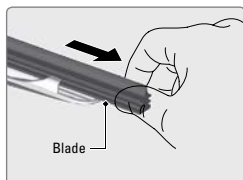

5. Remove the retainers from the old rubber blade, and mount to a new rubber blade. Correctly align the rubber protrusion and the retainer grooves.

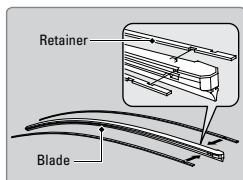

6. Pull the new wiper blade onto the holder from the end not having the stopper block. The tabs on the holder should fit in the indents of the wiper blade.

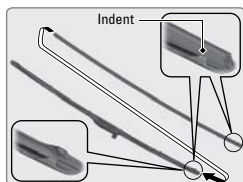

7. Slide the wiper holder onto the wiper arm, then push down the lock tab.
8. Lower the passenger side wiper arm first, then the driver side.

NOTICE

Avoid dropping the wiper arm, as it may damage the windshield.

■ Changing the Rear Wiper Blade Rubber

1. Lift the wiper arm off the window.
2. Slide the blade holder from the wiper arm by pushing the lock tab while pulling the holder toward the base of the wiper arm.

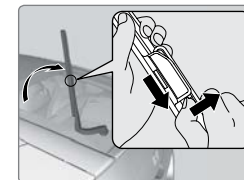

3. Slide the wiper blade out from its holder by pulling from the end of the blade having the molded-in stopper.

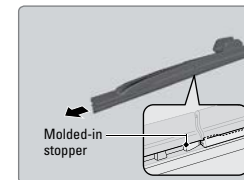

4. Remove the retainer from the wiper blade and mount it to a new rubber blade.

5. Slide the new wiper blade onto the holder. Make sure it is engaged correctly, then install the wiper blade assembly onto the wiper arm.

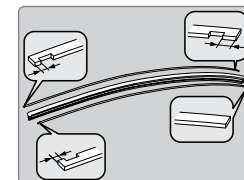

Tire Information

To safely operate your vehicle, your tires must be of the proper type and size, in good condition with adequate tread, and properly inflated.

Inflation Guidelines

- Properly inflated tires provide the best combination of handling, tread life, and comfort. Refer to the driver's doorjamb label or the specifications (see page 109) for the specified pressure.
- Underinflated tires wear unevenly, adversely affect handling and fuel economy, and are more likely to fail from overheating.
- Overinflated tires make your vehicle ride harshly, are more prone to road hazards, and wear unevenly.
- Every day before you drive, look at each of the tires. If one looks lower than the others, check the pressure with a tire gauge.
- Measure the air pressure when tires are cold. This means the vehicle has been parked for at least 3 hours, or driven less than 1 mile (1.6 km). If necessary, add or release air until the specified pressure is reached, and then calibrate the system (see page 85). If checked when hot, tire pressure can be as much as 4–6 psi (30–40 kPa, 0.3–0.5 kgf/cm²) higher than checked when cold.
- At least once a month or before long trips, use a gauge to measure the pressure in all tires, including the spare. Even tires in good condition can lose 1–2 psi (10–20 kPa, 0.1–0.2 kgf/cm²) per month.

Inspection Guidelines

Every time you inflate the tires, check for the following:

- Any damage to tires, including bumps, bulges, cuts, splits, or cracks in the side or tread. Remove any foreign objects and inspect for air leaks. Replace tires if you see fabric or cord.
- Uneven or excessive tread wear. Have a dealer check the wheel alignment.
- Cracks or other damage around the valve stems.

Wear Indicators

The groove where the wear indicator is located is 1/16 inch (1.6 mm) shallower than elsewhere on the tire. If the tread has worn so low that the indicator is exposed, replace the tire. **Worn out tires have poor traction on wet roads.**

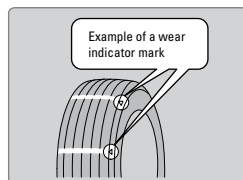

⚠️ WARNING

Using tires that are excessively worn or improperly inflated can cause a crash in which you can be seriously hurt or killed. Follow all instructions in this owner's manual regarding tire inflation and maintenance.

Tire and Loading Information Label

The label attached to the driver's doorjamb provides necessary tire and loading information.

| TIRE | SIZE | COLD TIRE PRESSURE | SEE OWNER'S MANUAL FOR ADDITIONAL INFORMATION |
|-------|----------------|--------------------|---|
| FRONT | XXXX/XXXXX XXX | XXXKPA, XXPSI | |
| REAR | XXXX/XXXXX XXX | XXXKPA, XXPSI | |
| SPARE | XXXX/XXXXX XXX | XXXKPA, XXPSI | |

SEATING CAPACITY: TOTAL X FRONT X REAR X
The combined weight of occupants and cargo should never exceed XXXkg or XXXlbs.

Tire and Wheel Replacement

Replace your tires with radials of the same size, load range, speed rating, and maximum cold tire pressure rating (as shown on the tire's sidewall). Using tires of a different size or construction can cause certain vehicle systems to work incorrectly. It is best to replace all four tires at the same time. If that isn't possible, replace the front or rear tires in pairs.

If you change or replace a wheel, make sure that the wheel's specifications match those of the original wheels.

⚠️ WARNING

Installing improper tires on your vehicle can affect handling and stability. This can cause a crash in which you can be seriously hurt or killed. Always use the size and type of tires recommended in the Owner's Manual.

Tire Service Life

The life of your tires is dependent on many factors, including driving habits, road conditions, vehicle loading, inflation pressure, maintenance history, speed, and environmental conditions (even when the tires are not in use).

In addition to regular inspections and inflation pressure maintenance, it is recommended that you have annual inspections performed once the tires reach five years old. All tires, including the spare, should be removed from service after 10 years from the date of manufacture, regardless of their condition or state of wear.

Winter Tires

If driving on snowy or frozen roads, mount all season tires marked “M+S”, snow tires, or tire chains; reduce speed; and maintain sufficient distance between vehicles when driving. For winter tires, select the size and load ranges that are the same as the original tires, and mount them to all four wheels.

Tire Chains

Because your vehicle has limited tire clearance, we strongly recommend using the following chains:

Models with P195/55 R16 tires: Cable-type: SCC Radial Chain SC1030

Models with 205/45 R17 tires: Do not install tire chains.

Install tire chains on the front tires only. Mount chains as tightly as you can, and make sure that they do not touch the brake lines or suspension.

NOTICE

Traction devices that are the wrong size or improperly installed can damage your vehicle’s brake lines, suspension, body, and wheels. Stop driving if they are hitting any part of the vehicle.

WARNING

Using the wrong chains, or not properly installing chains, can damage the brake lines and cause a crash in which you can be seriously injured or killed.

Follow all instructions in this guide regarding the selection and use of tire chains.

Tire Labeling

The tires that came on your vehicle have a number of markings. Those you should be aware of are described below.

Here is an example of what each marking means:

P195/55R16 86V

- P: vehicle type (P indicates passenger vehicle)
- 195: tire width in millimeters
- 55: aspect ratio (tire section height as a percentage of its width)
- R: tire construction code (radial)
- 16: rim diameter in inches
- 86: load index (code indicating maximum load tire can carry)
- H: speed symbol (code indicating maximum speed rating)

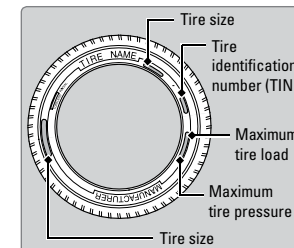

Tire Identification Number (TIN)

The tire identification number (TIN) is a group of numbers and letters that look like the example below. TIN is located on the sidewall of the tire.

DOT B97R FW6X 2209

DOT: This indicates that the tire meets all requirements of the U.S. Department of Transportation.

B97R: Manufacturer’s identification mark

FW6X: Tire type code

22 09: Date of Transportation

Year

Week

Glossary of Tire Terminology

Cold Tire Pressure – The tire air pressure when the vehicle has been parked for at least three hours or driven less than 1 mile (1.6 km).

Load Rating – The maximum load that a tire is rated to carry for a given inflation pressure.

Maximum Inflation Pressure – The maximum tire air pressure that the tire can hold.

Maximum Load Rating – The load rating for a tire at the maximum permissible inflation pressure for that tire.

Recommended Inflation Pressure – The cold tire inflation pressure recommended by the manufacturer.

Treadwear Indicators (TWI) – The projections within the principal grooves designed to give a visual indication of the degrees of wear of the tread.

TABLE OF CONTENTS

VISUAL INDEX

SAFETY INFORMATION

INSTRUMENT PANEL

VEHICLE CONTROLS

AUDIO AND CONNECTIVITY

BLUETOOTH® HANDSFREELINK®

HONDALINK®

NAVIGATION

DRIVING

HANDLING THE UNEXPECTED

MAINTENANCE

SPECIFICATIONS

CUSTOMER INFORMATION

VOICE COMMAND INDEX

INDEX

DOT Tire Quality Grading

The tires on your vehicle meet all U.S. Federal Safety Requirements. All tires are also graded for treadwear, traction, and temperature performance according to Department of Transportation (DOT) standards. The following explains these gradings.

■ Uniform Tire Quality Grading

Quality grades can be found where applicable on the tire sidewall between tread shoulder and maximum section width.

For example:

Treadwear 200

Traction AA

Temperature A

All passenger car tires must conform to Federal Safety Requirements in addition to these grades.

■ Treadwear

The treadwear grade is a comparative rating based on the wear rate of the tire when tested under controlled conditions on a specified government test course. For example, a tire graded 150 would wear one and one-half (1 1/2) times as well on the government course as a tire graded 100. The relative performance of tires depends upon the actual conditions of their use, however, and may depart significantly from the norm due to variations in driving habits, service practices, and differences in road characteristics and climate.

■ Traction

The traction grades, from highest to lowest, are AA, A, B, and C. Those grades represent the tire's ability to stop on wet pavement as measured under controlled conditions on specified government test surfaces of asphalt and concrete. A tire marked C may have poor traction performance.

WARNING: The traction grade assigned to this tire is based on straight-ahead braking traction tests, and does not include acceleration, cornering, hydroplaning, or peak traction characteristics.

■ Temperature

The temperature grades are A (the highest), B, and C, representing the tire's resistance to the generation of heat and its ability to dissipate heat when tested under controlled conditions on a specified indoor laboratory test wheel. Sustained high temperature can cause the material of the tire to degenerate and reduce tire life, and excessive temperature can lead to sudden tire failure. The grade C corresponds to a level of performance which all passenger car tires must meet under the Federal Motor Vehicle Safety Standard No. 109. Grades B and A represent higher levels of performance on the laboratory test wheel than the minimum required by law.

WARNING: The temperature grade for this tire is established for a tire that is properly inflated and not overloaded. Excessive speed, underinflation, or excessive loading, either separately or in combination, can cause heat buildup and possible tire failure.

Testing of Readiness Codes

Your vehicle has “readiness codes” as part of the onboard self-diagnostic system. Some states refer to these codes as a test to see if your vehicle’s emissions components are working properly. The codes may not be read if you go through the emissions testing just after the battery has gone dead or been disconnected.

To check if they are set, turn the vehicle on without starting the engine. The malfunction indicator lamp will come on for several seconds. If it goes off, the readiness codes are set. If it blinks five times, the readiness codes are not set.

If you are required to have your vehicle emissions tested before the readiness codes are set, prepare the vehicle for retesting by doing the following:

1. Fill the gas tank to approximately 3/4 full.
2. Park the vehicle and leave the engine off for 6 hours or more.
3. Make sure the ambient temperature is between 40°F and 95°F (4°C and 35°C).
4. Start the engine without touching the accelerator pedal, and let it idle for 20 seconds.
5. Keep the vehicle in Park (P) or Neutral (manual transmission). Increase the engine speed to 2,000 rpm, and hold it there for about 3 minutes.
6. Let the engine idle with your foot off the accelerator for 20 seconds.
7. Select a nearby, lightly traveled major highway where you can maintain a speed of 50 to 60 mph (80 to 97 km/h) for at least 20 minutes. Drive on the highway with the vehicle in Drive (D) or 5th gear (manual transmission). Do not use cruise control. When traffic allows, drive for 90 seconds without using the accelerator pedal. (Vehicle speed may vary slightly; this is OK.) If you cannot do this for a continuous 90 seconds because of traffic conditions, drive for at least 30 seconds, then repeat two more times (for a total of 90 seconds).
8. Drive in city/suburban traffic for at least 10 minutes. When traffic conditions allow, let the vehicle coast for several seconds without using the accelerator pedal or the brake pedal.
9. Park the vehicle and leave the engine off for 30 minutes.

The readiness codes are erased when the battery is disconnected, and set again only after several days of driving under a variety of conditions.

If an emissions testing facility determines that the readiness codes are not set, you may be requested to return at a later date to complete the test, or see your dealer.

SPECIFICATIONS

Vehicle

| | |
|----------------------------------|--|
| Model | CR-Z |
| No. of Passengers: | |
| Front | 2 |
| Rear | - |
| Total | 2 |
| Weights: | |
| Gross Vehicle Weight Rating | U.S.: 3,263 lbs (1,480 kg) Canada: 1,480 kg |
| Gross Axle Weight Rating (Front) | U.S.: 1,819 lbs (825 kg) Canada: 825 kg |
| Gross Axle Weight Rating (Rear) | U.S.: 1,455 lbs (660 kg) Canada: 660 kg |
| Air Conditioning: | |
| Refrigerant Type | HFC-134a (R-134a) |
| Charge Quantity | 15.8 – 17.6 oz (450 – 500 g) |
| Lubricant Type | SP-10 |

Fluids

Engine Oil

| | |
|-------------|--|
| Recommended | -Genuine Honda Motor Oil 0W-20 |
| | -API Premium-grade 0W-20 detergent oil |
| Capacity | Change including filter |
| | 3.6 US qt (3.4 L) 3.8 US qt (3.6 L) |

Engine Coolant

| | |
|-----------------|---|
| Specified Ratio | Honda Long Life Antifreeze/Coolant Type2 50/50 with distilled water |
| Capacity | 1.17 US gal (4.42 L) ^{*1} |
| | 1.15 US gal (4.35 L) ^{*2} (change including the remaining 0.116 US gal (0.44 L) in the reserve tank) |

*1: Manual transmission models
*2: Continuously variable transmission models

Brake/Clutch* Fluid

| | |
|-----------|------------------------------------|
| Specified | Honda Heavy Duty Brake Fluid DOT 3 |
|-----------|------------------------------------|

Continuously Variable Transmission Fluid

| | |
|-----------|--|
| Specified | Honda Continuously Variable Transmission Fluid |
| Capacity | Change 3.0 US qt (2.8 L) |

Manual Transmission Fluid

| | |
|-----------|---------------------------------------|
| Specified | Honda Manual Transmission Fluid (MTF) |
| Capacity | Change 1.5 US qt (1.4 L) |

Washer Fluid

| | |
|---------------|--|
| Tank Capacity | U.S.: 2.6 US qt (2.5 L) Canada: 5.12 US qt (4.85 L) |
|---------------|--|

Light Bulbs

| | |
|--|--|
| Headlights (Low Beam) | 35W (D4S) ^{*1} 55W (H11) ^{*2} |
| Headlights (High Beam) | 60W (HB3) |
| Fog Lights* | 35W (H8) |
| Front Turn Signal/Parking/Side Marker Lights | 28W/8W |
| Parking/Daytime Running* Light | LED |
| Rear Side Marker Lights | 3CP |
| Brake/Taillights | LED |
| Side Turn Signal Lights (on Door Mirrors) | LED |
| Back-Up Lights | 16W |
| Rear Turn Signal Lights | 21W (Amber) |
| High-Mount Brake Lights | LED |
| License Plate Light | 5W |
| Cargo Area Light | 5W |
| Interior Lights | |
| Front | 8W |
| Rear | 3.4W |
| Vanity Mirror Lights* 2W | |
| Glove Box Light | 1.4W |
| Courtesy Lights | 2CP (3.8W) |

*1: Vehicle with discharge headlights
*2: Vehicle with halogen bulb low beam headlights

Engine and Fuel

Engine

| | |
|--------------|-----------------------------------|
| Displacement | 91 cu-in (1,497 cm ³) |
| Spark Plugs | NGK D1FR6D13 DENSO DK20PR-D13 |

Fuel

| | |
|--------------------|---|
| Type | Unleaded gasoline, Pump octane number of 87 or higher |
| Fuel Tank Capacity | 10.6 US gal (40 L) |

Tires

| | | |
|---------|---|---|
| Regular | Size | P195/55R16 86V 205/45R17 84V ^{*1} |
| | Pressure (psi (kPa) [kgf/cm ²]) | Front 30 (210 [2.1]) |
| | | Rear 32 (220 [2.2]) ^{*2} |
| | Wheel Size | Regular 16 x 6J 17 x 6.5J ^{*1} |

*1: Optional on Canadian models
*2: 205/45R17 tires

*if equipped

CUSTOMER INFORMATION

Learn about information specific to you as a Honda customer and how to get help.

Frequently Asked Questions/Troubleshooting

Below are some frequently asked questions and troubleshooting items that you may have about the vehicle.

- Q:** *Why doesn't the vehicle start when I press the ENGINE START/STOP button?*
- A:** The brake pedal must be pressed to start the engine.
- Q:** *What is the AUTO* setting on my headlight lever?*
- A:** When in the AUTO position, the vehicle's exterior lights will automatically turn on or off depending on the ambient lighting.
- Q:** *After my battery was disconnected or went dead, the audio system is asking for a code. Where do I find this?*
- A:** In most cases, you do not need to enter a code. Turn on the vehicle and the audio system, and press and hold the power button until the system reactivates.
- Q:** *Why can't I operate Pandora® through the audio system?*
- A:** Audio may be streaming through Bluetooth® Audio. Make sure Pandora mode is selected and the phone cable is properly connected to the USB adapter. Some phones may prompt you to "Allow" a connection.
- Q:** *Is my phone compatible with Bluetooth features?*
- A:** Visit handsfreelink.com (U.S.) or handsfreelink.ca (Canada) to check phone compatibility for Bluetooth® Audio, Bluetooth® HandsFreeLink®, and SMS text messaging.
- Q:** *Every time I press the Talk button, the system gives me voice prompts. Can I turn these off?**
- A:** From the HOME screen, select Settings. Select System, then select Voice Prompt. Select Off.
- Q:** *Why can't I select an item using the or touchscreen?*
- A:** To prevent driver distraction, certain items are limited or inoperable while the vehicle is moving. Use voice commands or pull over to select the items.
- Q:** *Where can I find the vehicle identification number (VIN)?*
- A:** Check the label on the driver's doorjamb.

*if equipped

Contact Us

Honda dealer personnel are trained professionals. They should be able to answer all your questions. If you encounter a problem that your dealership does not solve to your satisfaction, please discuss it with the dealership's service manager or general manager. If you are dissatisfied with the decision made by the dealership's management, contact Honda Automobile Customer Service.

U.S. owners

American Honda Motor Co., Inc.
Honda Automobile Customer Service
1919 Torrance Blvd.
Mail Stop 500-2N-7A
Torrance, CA 90501-2746
Tel: (800) 999-1009

In Puerto Rico and the U.S. Virgin Islands

Bella International
P.O. Box 190816
San Juan, PR 00919-0816
Tel: (787) 620-7546

Canadian owners

Honda Canada, Inc.
Customer Relations
180 Honda Blvd.
Markham, ON
L6C 0H9
Tel: (888) 946-6329
Fax: (877) 939-0909
e-mail: honda_cr@ch.honda.com

When you call or write, please give us the following information:

- Vehicle Identification Number
- Date of purchase
- Odometer reading of your vehicle
- Your name, address, and telephone number
- A detailed description of the problem
- Name of the dealer who sold the vehicle to you

Honda Roadside Assistance

24-hour emergency road service is available to you in the United States and Canada throughout your 3-year/36,000-mile warranty term. Services include jump starting, flat tire and lockout assistance, towing, and more (limitations apply).

Call (866) 864-5211 (U.S.) or (800) 465-7587 (Canada).

Warranty Coverages

Below is a brief summary of the warranties covering your new vehicle.

New Vehicle Limited Warranty: Covers your new vehicle, except for the emissions control system and accessories, against defects in materials and workmanship.

Emissions Control Systems Defects Warranty and Emissions Performance Warranty: Covers your vehicle's emissions control systems. Time, mileage, and coverage are conditional.

Seat Belt Limited Warranty: Covers seat belts that fail to function properly.

Rust Perforation Limited Warranty: Covers all exterior body panels that rust through from the inside.

Accessory Limited Warranty: Covers Honda accessories.

Replacement Parts Limited Warranty: Covers all Honda replacement parts against defects in materials and workmanship.

Replacement Battery Limited Warranty: Provides prorated coverage for a replacement battery purchased from a Honda dealer.

Replacement Muffler Lifetime Limited Warranty: Covers a replacement muffler for the duration of the ownership.

Restrictions and exclusions apply to all these warranties. See the Warranty Manual on the Owner Information CD or at owners.honda.com (U.S.) or myhonda.ca (Canada) for complete descriptions of each warranty, including time, mileage, and other conditional limitations.

Your vehicle's original tires are covered by their manufacturer. Tire warranty information can be found on the Owner Information CD or at owners.honda.com (U.S.) or myhonda.ca (Canada).

VOICE COMMAND INDEX

Learn about all available voice commands to help you operate the vehicle. Available on vehicles with navigation.

Press the Talk button before you say a command. To view a list of available commands in the vehicle, say "Voice help." Select a category to hear the commands read aloud.

Global Commands

The system accepts these commands on any screen.

- Voice help
- Display menu
- Display setting
- Display navigation
- Display information
- Display audio
- Display phone
- Display clock
- Display voice portal
- Display home
- Trip computer
- Back/Cancel
- What is today's date?
- What time is it?

Navigation Commands

The system accepts these commands on the map/guidance screen.

General Commands

- Address
- Place name*
- Display map
- Display navigation
- Go home 1 (or 2)

Map Display Commands

- Display current location
- Display/Hide (specify icon type):
 - ATM
 - gas station
 - restaurant
 - post office
 - grocery store
 - lodging (hotel, motel)
 - parking garage
 - parking lot
 - school
 - hospital
 - freeway exit information
 - traffic*
 - traffic speeds*
 - traffic icons*
- Display north up
- Display heading up
- Display 3D map
- Display zoom in
- Display zoom out

*U.S. models only

■ **Navigation Commands (continued)**

Find Place Commands

- Find nearest (specify place):
 - Fuel and auto
 - Honda dealers
 - Gas station
 - Auto parts & electronics
 - Auto repair & maintenance
 - Car wash & detailing
 - Motorcycle dealers
 - Other car dealerships
 - Roadside assistance
 - ATM
 - Bank
 - Check cashing
 - Currency exchange
 - Community
 - Business
 - City hall
 - Civic center
 - Convention center
 - Court house
 - Higher education
 - Library
 - Post office
 - School
 - Emergency room
 - Hospital
 - Police station
 - Veterinarian
 - Lodging
 - Bed & breakfast
 - Hotel
 - Resort
 - Recreation
 - Amusement park
 - Golf course
 - Historical monument
 - Marina
 - Movie theater
 - Museum
 - Park
 - Performing arts
 - Sports complex
 - Tourist attraction
 - Restaurant
 - American restaurant
 - Californian restaurant
 - Chinese restaurant
 - Coffee shop
 - Continental restaurant
 - Fast food
 - French restaurant
 - German restaurant
 - Greek restaurant
 - Indian restaurant
 - Italian restaurant
 - Japanese restaurant
 - Korean restaurant
 - Mexican restaurant
 - Pizza
 - Seafood restaurant
 - Thai restaurant
 - Vegetarian restaurant
 - Vietnamese restaurant
 - Other restaurant
 - Shopping
 - Shopping area
 - Accessory store
 - Book store
 - Clothing store
 - Grocery store
 - Home improvement store
 - Mall
 - Office supply store
 - Pharmacy
 - Pet food store
 - Sewing store
 - Shoe store
 - Sporting goods store
 - Toy store
 - Travel center
 - Airport

- Automobile club
- Bus station
- Camping
- Commuter rail station
- Ferry terminal
- Named place
- Park & ride
- Parking garage
- Parking lot
- Rental car agency
- Rest area
- Ski area
- Tourist information
- Train station
- Travel agency
- Truck stop

Route Commands

The system accepts these commands when a route is set.

- How long to the destination?
- How far to the destination?
- Display destination map
- Display entire route
- Cancel route
- Repeat guidance
- Route menu

■ **Climate Control Commands****

The system accepts these commands on most screens. **Available on Canadian models only.**

- Climate control automatic (maintains selected temperature)
- Climate control on*
- Climate control off*
- Air conditioner on*
- Air conditioner off*
- Rear defrost on*
- Rear defrost off*
- Climate control fresh air
- Climate control recirculate
- Climate control vent
- Climate control bi-level (vent and floor)
- Climate control floor
- Climate control floor and defrost
- Fan speed up
- Fan speed down
- Fan speed # (#: 1 to 7)
- Temperature # degrees (#: 57 to 87°F / 15 to 29°C)
- Temperature up
- Temperature down
- Driver temperature up
- Driver temperature down
- Temperature max heat
- Temperature max cool

**These commands toggle the function on and off, so the command may not match your intended action.
**if equipped*

■ Audio Commands

The system accepts these commands on most screens. Audio volume levels cannot be controlled using voice commands.

FM/AM Radio Commands

- Audio on*
- Audio off*
- Radio on*
- Radio off*
- Radio select FM
- Radio select AM
- Radio tune to # FM (#: frequency, e.g., 95.5)
- Radio tune to # AM (#: frequency, e.g., 1020)
- Radio seek up
- Radio seek down
- Radio next station
- Radio preset # (#: 1 to 12)
- Radio FM preset # (#: 1 to 12)
- Radio AM preset # (#: 1 to 6)
- Radio scan*

iPod® Commands

- Music search
- iPod play
- iPod play track # (#: 1-30)
- iPod skip forward
- iPod skip back
- iPod track shuffle*
- iPod album shuffle*
- iPod track repeat*
- iPod normal play

Disc Commands

- Disc play
- Disc play track # (#: 1 to 30)
- Disc skip forward
- Disc skip back
- Disc track random*
- Disc track repeat*
- Disc track scan*
- Disc folder up
- Disc folder down
- Disc folder random*
- Disc folder repeat*
- Disc folder scan*
- Disc normal play

USB Commands

- Music search
- USB play
- USB play track # (#: 1 to 30)
- USB skip forward
- USB skip back
- USB track random*
- USB track repeat*
- USB track scan*
- USB folder up
- USB folder down
- USB folder random*
- USB folder repeat*
- USB folder scan*
- USB normal play

*These commands toggle the function on and off, so the command may not match your intended action.

■ Audio Commands (continued)

Song By Voice™ Commands

Available for iPod and USB music search.

- Music search
- What am I listening to?
- Who am I listening to?
- Who is this?
- Who's playing?
- What's playing?
- What album is this?
- Play artist (name)
- Play track/song (name)
- Play album (name)
- Play genre/category (name)
- Play playlist (name)
- Play composer (name)
- List artist (name)
- List album (name)
- List genre/category (name)
- List playlist (name)
- List composer (name)

■ Phone Commands

The system accepts these commands on most screens.

- Phone call
- Dial/call by name
- Dial/call by number
- Call (phone number or name)

■ Info Commands

The system accepts these commands on most screens.

- Trip computer
- Display clock
- Display traffic list**
- Display wallpaper
- Display traffic on my route**

Pandora® Commands**

- Pandora play*
- Pandora skip forward
- Pandora (station name)
- Pandora station up
- Pandora station down
- Pandora pause*
- Pandora resume*
- Pandora like this song
- Pandora dislike this song

Bluetooth® Audio Commands

- Bluetooth audio play
- Bluetooth audio skip forward
- Bluetooth audio skip back
- Bluetooth audio pause
- Bluetooth audio resume
- Bluetooth audio group up
- Bluetooth audio group down

Commands may not work on some phones or devices.

*These commands toggle the function on and off, so the command may not match your intended action.

**U.S. models only

■ On-screen Commands

The system accepts these commands on any screen where applicable. All available commands are highlighted in yellow when you press the Talk button.

- Next (or previous)
- Up (or down)
- Right (or left)
- Return
- OK (excluding Startup Confirmation screen)
- Delete

INDEX

| | | | |
|--|--------|--|--------|
| 3-Mode Drive System..... | 71 | Carbon Monoxide Gas..... | 4 |
| ABS | 21, 70 | Cargo Area | 35 |
| Accessory Power Socket..... | 40 | Cargo Cover | 36 |
| Airbags | 8 | Changing Wiper Blades..... | 100 |
| Advanced Airbags | 8 | Charging system..... | 20 |
| Airbag Care | 12 | Child Safety..... | 13 |
| Airbag System Components..... | 11 | Child Seat | 15 |
| Airbag System Indicators..... | 9 | Climate Control Commands..... | 115 |
| Front Airbags (SRS)..... | 8 | Climate Control System..... | 38 |
| Passenger Airbag Off Indicator..... | 10 | Clock | 39 |
| Side Airbag Off indicator..... | 10 | Compact Disc (CD)..... | 45 |
| Side Airbags..... | 9 | Compact Disc (CD) Commands..... | 116 |
| Side Curtain Airbags..... | 9 | Condition Indicators | 22 |
| Supplemental Restraint System (SRS) Indicator..... | 9 | Contact Us..... | 111 |
| Ambient Meter..... | 73 | Continuously Variable Transmission (CVT) ... | 67 |
| Anti-Lock Brake System (ABS)..... | 21, 70 | Cruise control | 23, 76 |
| Audio Commands | 116 | Customer Information..... | 110 |
| Audio Operation | 40 | Customize Settings | 25, 39 |
| Accessory Power Socket | 40 | Dashboard and Other Controls..... | 2 |
| Bluetooth® Audio | 48 | Destination | 59 |
| Compact Disc (CD)..... | 45 | Detour | 61 |
| FM/AM Radio..... | 44 | Dialing a Number | 52 |
| HDMI Port..... | 40 | Door/hatch open | 22 |
| HondaLink® | 43 | Door Mirrors | 37 |
| iPod® | 46 | Door Operation | 27, 28 |
| Pandora® | 49 | DOT Tire Quality Grading | 106 |
| Sound..... | 41 | Driving | 62 |
| Steering Wheel Controls..... | 41 | 3-Mode Drive System..... | 71 |
| Touchscreen Operation | 42 | Braking..... | 70 |
| USB Flash Drive..... | 47 | Cruise Control..... | 76 |
| USB Port | 40 | Eco Assist™ System..... | 73 |
| Auto idle stop..... | 23, 75 | ENGINE START/STOP button | 66 |
| Battery | 99 | LaneWatch™ | 77 |
| Battery Charge | 23 | Maximum Load Limit..... | 64 |
| Bluetooth® Audio | 48 | Multi-View Rear Camera | 78 |
| Bluetooth® Audio Commands | 117 | Paddle Shifters | 68 |
| Bluetooth® HandsFreeLink® (HFL)..... | 50 | Plus Sport System..... | 72 |
| E-Mail..... | 54 | Power Mode | 66 |
| HFL Controls..... | 50 | Refueling..... | 79 |
| HondaLink® Assist | 53 | Shifting..... | 67 |
| Making a Call..... | 52 | Starting the Engine | 66 |
| Pairing a Phone | 51 | Vehicle Stability Assist (VSA®) | 75 |
| Phonebook | 52 | Eco Assist™ System..... | 73 |
| Siri® Eyes Free | 55 | Ecological Drive Display..... | 74 |
| SMS Text Messaging | 54 | ECON mode..... | 23, 71 |
| Speed Dial..... | 53 | Electric Motor Assist..... | 23 |
| Talk Button Tips | 51 | Electric Parking Brake..... | 70 |
| Brake Assist System..... | 70 | Electric power steering..... | 21 |
| Brake/Clutch Fluid..... | 98 | Electronic Stability Control (ESC)..... | 75 |
| Brake system | 20, 21 | E-Mail | 54 |
| Braking | 70 | Emergency Engine Stop..... | 84 |
| Brightness Control..... | 30 | Emergency Towing | 84 |
| | | Engine and Fuel..... | 109 |

Engine Coolant.....97
 Engine Oil.....95
 ENGINE START/STOP button66
 Exterior lights.....23, 30
 Fastening a Seat Belt7
 Find Nearest Place60
 Find Place Commands.....114
 Floor Mats33
 Fluids109
 FM/AM Radio.....44
 FM/AM Radio Commands.....116
 Fog lights23, 30
 Foot Brake.....70
 Frequently Asked Questions110
 Front Airbags (SRS).....8
 Front Door Inner Handle28
 Front Wipers31
 Fuel Information79
 Fuse Locations.....88
 Hatch27, 28
 Hazards23
 HDMI Port.....40
 Head Restraints.....34
 High beams23
 High temperature.....21
 Home Address.....59
 HondaLink®.....43
 HondaLink® Assist53
 Honda Roadside Assistance.....112
 Hood94
 IMA Battery Charge Level.....23
 IMA (Integrated Motor Assist).....21
 Immobilizer.....22
 Info Commands.....117
 Information Display.....24
 Instrument Panel.....20
 Interior Lights.....30
 iPod®46
 iPod® Commands116
 Jump Starting81
 LaneWatch™.....77
 Lap/Shoulder Seat Belts.....5
 Light Bulbs.....109
 Lights30
 Lock Tab.....28
 Low fuel22
 Low oil pressure.....20
 Low temperature.....21
 Low tire pressure.....22
 Maintenance.....91
 Battery99
 Brake/Clutch Fluid.....98
 Engine Coolant.....97
 Engine Oil.....95
 Maintenance Minder™.....92
 Safety Precautions91
 Service Codes.....93
 Under the Hood94
 Window Washer Fluid.....98
 Wiper Blades100
 Making a Call52
 Malfunction indicator lamp21
 Malfunction Indicators.....20
 Manual Transmission.....69
 Map Display Commands.....113
 Map Legend61
 Master Door Lock Switch.....28
 Maximum Load Limit.....64
 Mirrors37
 Multi-Information Display.....24
 Multi-View Rear Camera78
 Navigation56
 Detour61
 Display and Controls.....57
 Entering a Destination.....59
 Find Nearest Place60
 Home Address.....59
 Map Legend61
 Place Name.....60
 Routing.....61
 Steering Wheel Controls.....56
 Street Address.....59
 Talk Button Tips58
 Traffic61
 Voice Prompt.....58
 Navigation Commands.....113
 NORMAL mode.....23, 71
 One-Touch Turn Signal.....29
 On/Off Indicators.....23
 On-screen Commands.....118
 Opening the Hood94
 Overheating.....83
 Paddle Shifters68
 Pairing a Phone.....51
 Pandora®.....49
 Pandora® Commands.....117
 Parking brake.....22, 70
 Passenger Airbag Off Indicator.....10
 Phone51
 Phonebook52
 Phone Commands.....117
 Place Name.....60
 Plus Sport system23, 72
 Power Door Mirrors.....37
 Power Flow Monitor73
 Power Mode66
 Power Windows.....29
 Radio44
 Readiness Codes.....108
 Rear Camera78

Rear Cargo35
 Rearview Mirror37
 Rear Wiper31
 Refueling.....79
 Remote Battery Strength.....80
 Remote Transmitter26
 Reporting Safety Defects.....19
 Roadside Assistance.....112
 Route Commands.....115
 Routing61
 Safety Information3
 Carbon Monoxide Gas.....4
 Child Safety13
 Reporting Safety Defects.....19
 Safety Label Locations.....18
 Safety Messages3
 Seat Belts5
 Fastening a Seat Belt7
 Lap/Shoulder Seat Belts.....5
 Seat Belt Inspection.....6
 Seat belt reminder22
 Seat Heaters38
 Seats32
 Service Codes.....93
 Settings25, 39
 Setting the Clock.....39
 Shifting67
 Shift Lever Does Not Move80
 Side airbag off10, 23
 Side Airbags.....9
 Side Curtain Airbags.....9
 Siri® Eyes Free.....55
 Smart Entry System27
 SMS Text Messaging54
 Song By Voice™ Commands.....117
 Sound41
 Specifications.....109
 Speed Dial.....53
 SPORT mode23, 71
 Starting the Engine66
 Steering Wheel.....37
 Steering Wheel and Nearby Controls1
 Steering Wheel Controls.....41, 56
 Street Address.....59
 Supplemental Restraint System (SRS)9, 20
 System message22
 Talk button.....50, 56
 Talk Button Tips51, 58
 Text Messaging54
 Tire Information102
 DOT Tire Quality Grading106
 Inflation Guidelines.....102
 Tire and Loading Information Label103
 Tire and Wheel Replacement.....103
 Tire Chains.....104
 Tire Identification Number (TIN).....105
 Tire Labeling.....105
 Tire Service Life.....104
 Tire Terminology.....105
 Wear Indicators102
 Winter Tires.....104
 Tire Pressure Monitoring System (TPMS)21, 85
 Tire Repair Kit87
 Tires109
 Touchscreen Operation42
 Towing84
 Traffic61
 Troubleshooting.....110
 Turn Signal23, 29
 Under the Hood94
 USB Commands.....116
 USB Flash Drive.....47
 USB Port.....40
 Vehicle109
 Vehicle Controls.....26
 Vehicle Stability Assist (VSA®)21, 23, 75
 Visual Index.....1
 Voice Command Index113
 Voice Prompt58
 Warranty Coverages112
 Wear Indicators102
 Window Washer Fluid.....98
 Windows.....29
 Winter Tires.....104
 Wiper Blades.....100
 Wiper Operation.....31

TABLE OF CONTENTS

VISUAL INDEX

SAFETY INFORMATION

INSTRUMENT PANEL

VEHICLE CONTROLS

AUDIO AND CONNECTIVITY

BLUETOOTH® HANDSFREELINK®

HONDALINK®

NAVIGATION

DRIVING

HANDLING THE UNEXPECTED

MAINTENANCE

SPECIFICATIONS

CUSTOMER INFORMATION

VOICE COMMAND INDEX

INDEX