

Fuses

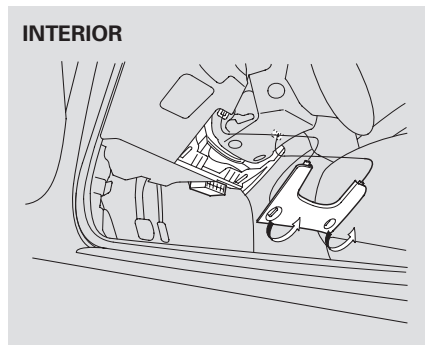

The vehicle's fuses are located in two fuse boxes. The interior fuse box is underneath the steering column.

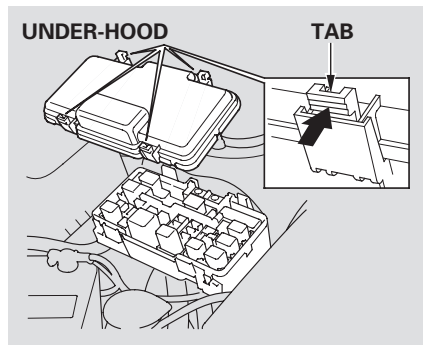

The under-hood fuse box is in the engine compartment next to the battery.

Checking and Replacing Fuses

If something electrical in your vehicle stops working, the first thing you should check for is a blown fuse. Determine from the chart on pages [223](#) and [224](#), or the diagram on the fuse box lid, which fuse or fuses control that device. Check those fuses first, but check all the fuses before deciding that a blown fuse is the cause. Replace any blown fuses, and check if the device works.

1. Turn the ignition switch to the LOCK (0) position. Make sure the headlights and all other accessories are off.
2. Remove the cover from the fuse box.

FUSE

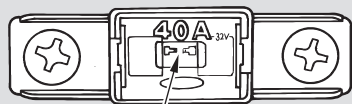

BLOWN

3. Check each of the large fuses in the under-hood fuse box by looking through the top at the wire inside. Removing these fuses requires a Phillips-head screwdriver.

4. Check the smaller fuses in the under-hood fuse box and all the fuses in the interior fuse box by pulling out each fuse with the fuse puller provided in the interior fuse box.

BLOWN

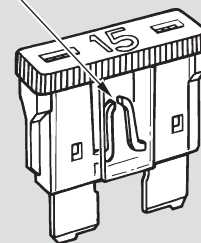

5. Look for a blown wire inside the fuse. If it is blown, replace it with one of the spare fuses of the same rating or lower.

CONTINUED

Fuses

If you cannot drive the vehicle without fixing the problem, and you do not have a spare fuse, take a fuse of the same rating or a lower rating from one of the other circuits. Make sure you can do without that circuit temporarily (such as the accessory power socket or radio).

If you replace the blown fuse with a spare fuse that has a lower rating, it might blow out again. This does not indicate anything wrong. Replace the fuse with one of the correct rating as soon as you can.

NOTICE

Replacing a fuse with one that has a higher rating greatly increases the chances of damaging the electrical system. If you do not have a replacement fuse with the proper rating for the circuit, install one with a lower rating.

6. If the replacement fuse of the same rating blows in a short time, there is probably a serious electrical problem with your vehicle. Leave the blown fuse in that circuit, and have your vehicle checked by a qualified mechanic.

If the driver's power window fuse is removed, the AUTO function of the driver's window will be disabled. To reset the AUTO function, see page [78](#) .

If the radio fuse is removed, the audio system will disable itself. The next time you turn on the radio you will see "Code" in the frequency display. Use the preset buttons to enter the five-digit code (see page [125](#)).

Fuse Locations

INTERIOR FUSE BOX

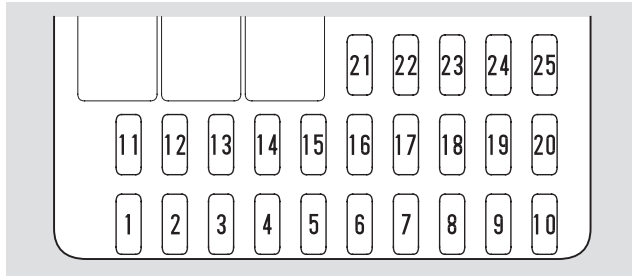

No.	Amps.	Circuits Protected
1	15A	Ignition Coil
2	20A	Laf Heater
3	10A	Daytime Running Lights* ¹ Rear Accessory Power Socket* ²
4	10A	ACG (IG)
5	—	Not Used
6	7.5A	Power Window Relay
7	20A	Moonroof
8	7.5A	Radio
9	10A	Rear Wiper
10	7.5A	Gauge panel
11	7.5A	ABS

No.	Amps.	Circuits Protected
12	7.5A	Daytime Running Lights* ¹
13	10A	SRS
14	10A	Power Mirror
15	20A	Bass Speaker* ³
16	20A	Heated Seats* ¹
17	15A	Fuel Pump
18	15A	Accessory Power Socket
19	7.5A	Turn Signal
20	20A	Front Wiper
21	—	Not Used
22	20A	Front Passenger's Power Window
23	20A	Driver's Power Window
24	—	Not Used
25	—	Not Used

*1 : Canadian models only

*2 : U. S. models only

*3 : Type-S only

CONTINUED